

UP TO 5,800 SF OF RETAIL AVAILABLE FOR LEASE



100-104  
S ROBERTSON  
BOULEVARD

JAY LUCHS

Vice Chairman

310-407-6585

[jay.luchs@nrmk.com](mailto:jay.luchs@nrmk.com)

CA RE Lic. #01260345

[JAYLUCHS.COM](http://JAYLUCHS.COM)

**NEWMARK**





## ADDRESS

100-104 S Robertson Boulevard  
Los Angeles, CA 90048

## USE

Retail

## SIZE

100 S Robertson: ±3,150 SF  
104 S Robertson: ±2,650 SF  
**Total: ±5,800 SF**

## RENT

Available upon Request

## PARKING

Two hours free parking in public parking structure directly across the street (334 free parking spaces available)



# 100 S ROBERTSON BOULEVARD

## HIGHLIGHTS

Approximately 20' on Robertson  
Blvd and 104' on Alden Dr

Modern design

Marble features

High-ceilings

Track and accent lighting

Large window displays







104  
S ROBERTSON  
BOULEVARD

## HIGHLIGHTS

Approximately 40 feet of frontage on Robertson Boulevard

Modern design

Marble features

High-ceilings

Track and accent lighting



# FLOOR PLAN

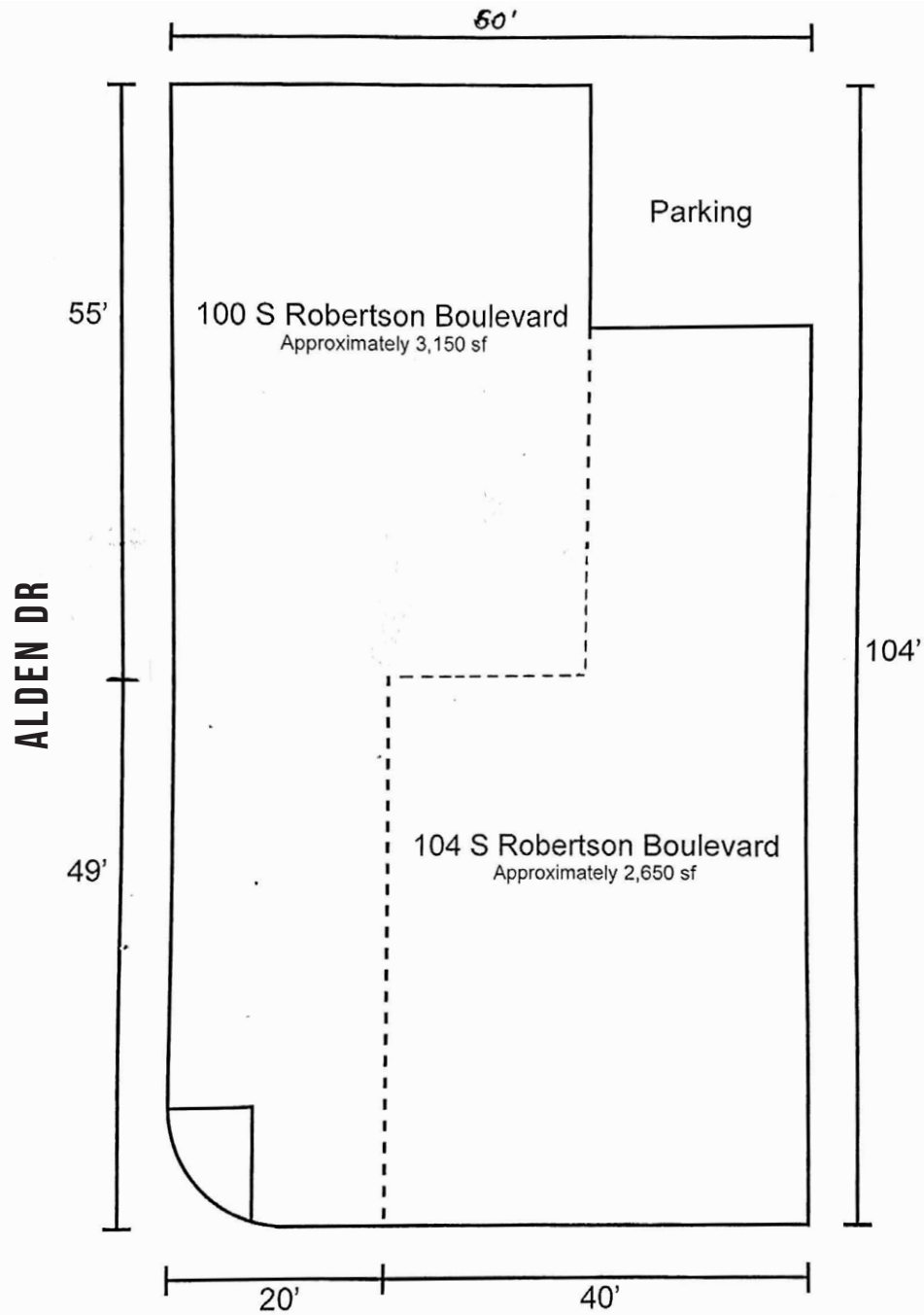

**ROBERTSON BLVD**

Not drawn to scale. All dimensions are approximate

Christol Farms

Classic Airforms

KOHLER

JANUS et Cie

eggsmann

ANN SACKS

ligne rosset

Hästens

ULLA JOHNSON

B&B ITALIA

Knoll



Curve RH

Worldwide Production Agency  
Visionnaire

Herman Miller  
BANG & OLUFSEN  
COUP DETAT

MedMen

BAR

NICOLE SASSAMAN

Pearline  
Shima (coming soon)  
Northern Wide Plank

Crane Salon  
Novacolor Italian Finishes  
Indigo Seas

Case  
LDV On Robertson  
76 Gasoline

Robertson Plaza  
THE HENRY  
BOXUNION  
Sushi Tama  
Bibo Ergo Sum  
Garayan  
Sherie Wagner International  
BLUE BOTTLE COFFEE

100-104 S ROBERTSON BOULEVARD

CEDARS-SINAL

SOFITEL  
HOTELS & RESORTS

Parking 4e

BEVERLY CENTER

SAN VICENTE BLVD

Manpuku Japanese BBQ

The Phoenix Bar & Restaurant

Toca Madera

HARBOUR

Minotti

rochebobois

LUMINAIRE

Poliform

Molteni & C  
Dada  
Cassina  
JAMES PERSE  
Robertson House  
DUXIANA

TECHNOGYM



Stave Mesh  
kitson Kids

ALDEN DR



Offices  
KLEIN  
ESTATES & PARKERS



kitson

Youthfill MD



Public Parking

future Sushi Nakazawa  
"Jiro Dreams of Sushi" Chef  
Daisuke Nakazawa restaurant  
opening at 145 S Robertson Blvd

GEORGETOWN CUPCAKE

bulthaup

W 3RD ST



ALFRED  
COFFEE & KITCHEN

Mama Por-Dios

A.O.C.

Locanda Veneta

The 3rd Stop

Nonna's Empanadas

BURTON WY

Il Cielo

The information contained herein has been obtained from sources deemed reliable but has not been verified and no guarantee, warranty or representation, either express or implied, is made with respect to such information. Terms of sale or lease and availability are subject to change or withdrawal without notice.

JAY LUCHS

Vice Chairman

310-407-6585

jay.luchs@nrmk.com

CA RE Lic. #01260345

JAYLUCHS.COM

NEWMARK