

29,711 SF

CLASS A OFFICE

AVAILABLE FOR SUBLEASE



111

OYSTER POINT
BOULEVARD
SOUTH SAN FRANCISCO, CA

CBRE



PROPERTY DETAILS



Available Space: 29,711 SF



Building Size: 115,466 SF



Parking: 2.79 / 1,000 SF



Plug & play office with premier finishes and furniture included



Conference rooms (7), private offices (13), huddle rooms (9), open office space, kitchen & break room



FTE Count: 141



Full Amenity Package: Gym, food service, bowling alley, conference center and retail (Foundry & Lux, Starbucks, Guapas, Nick the Greek, Orangetheory)



LED: 12/31/2027



FLOOR PLAN

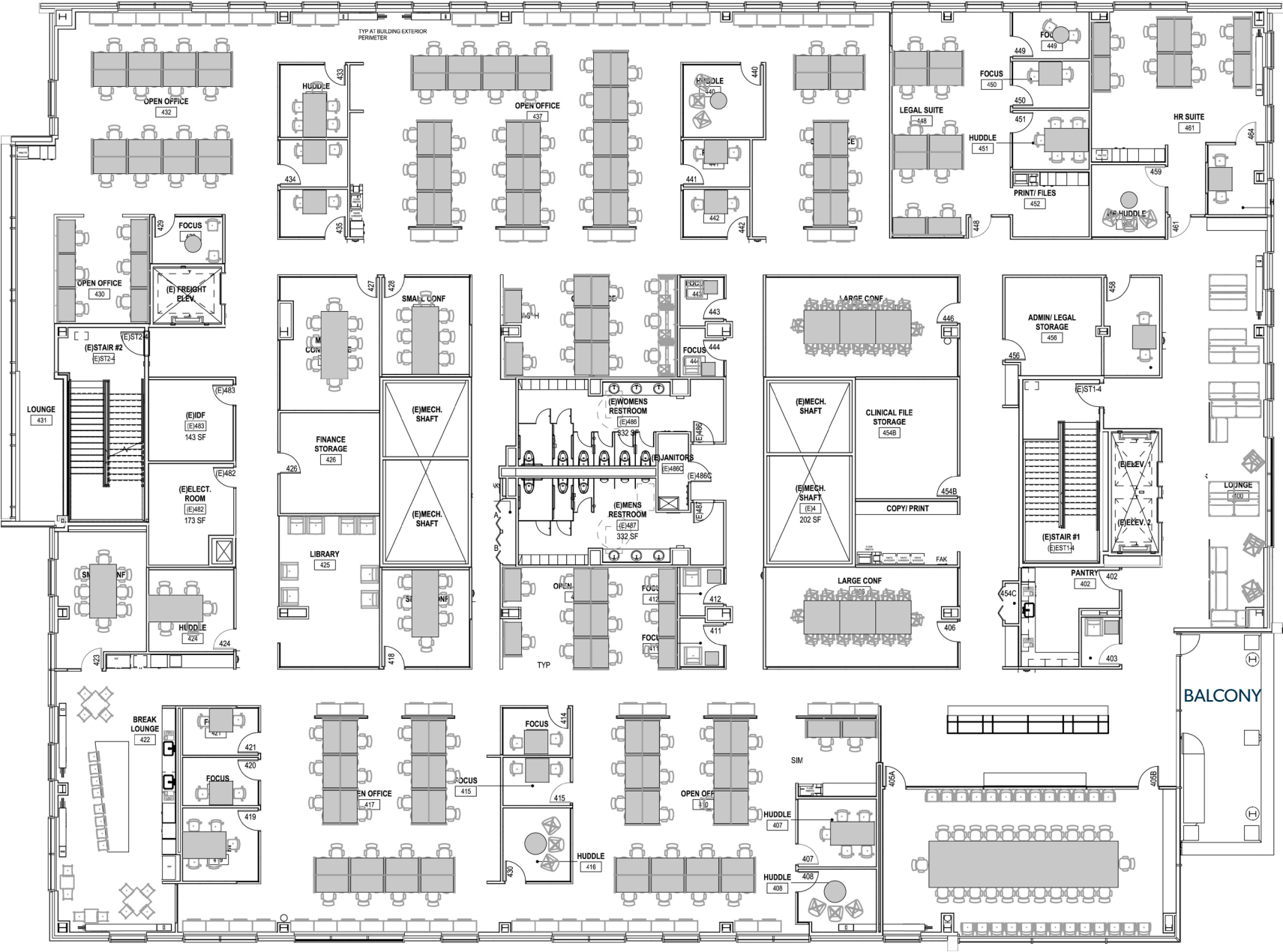

PROPERTY PHOTOS





Common area cafe & bar

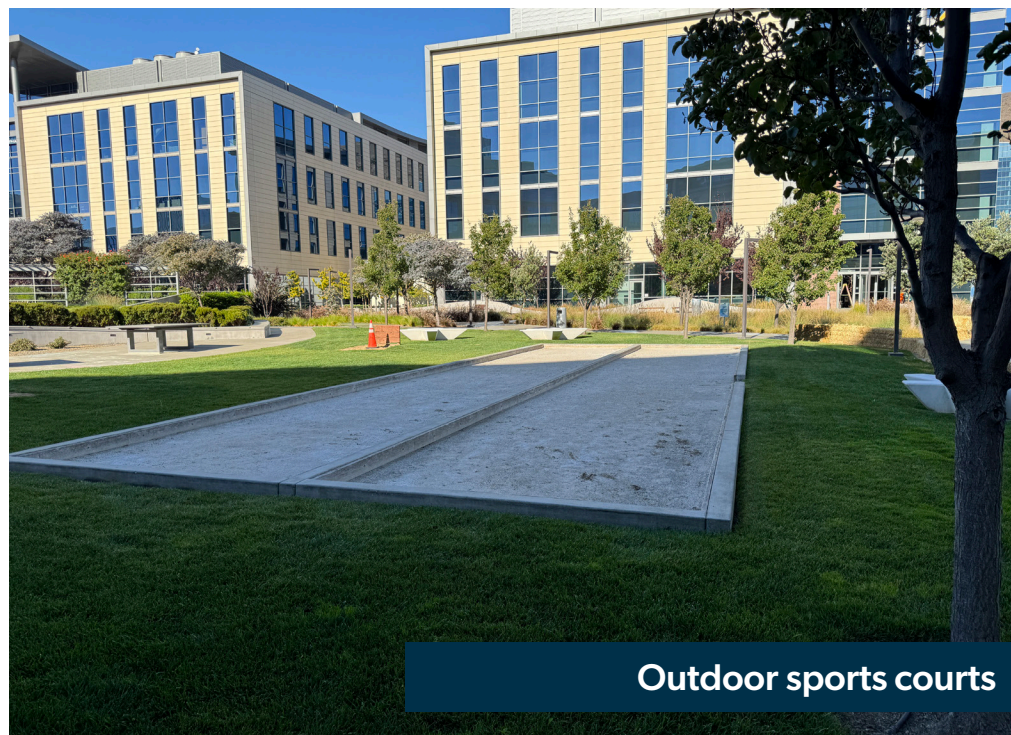

Outdoor sports courts



Outdoor picnic tables



Onsite retail

111

OYSTER POINT BOULEVARD

SOUTH SAN FRANCISCO, CA

CONTACT US

GREGG DOMANICO

Vice Chairman
+1 415 215 5218
gregg.domanico@cbre.com
Lic. 00996779

BRIAN BESWICK

Executive Vice President
+1 650 464 9995
brian.beswick@cbre.com
Lic. 01034738

SAI DOMANICO

Senior Vice President
+1 650 302 2688
sai.domanico@cbre.com
Lic. 02044845

© 2025 CBRE, Inc. All rights reserved. This information has been obtained from sources believed reliable, but has not been verified for accuracy or completeness. You should conduct a careful, independent investigation of the property and verify all information. Any reliance on this information is solely at your own risk. CBRE and the CBRE logo are service marks of CBRE, Inc. All other marks displayed on this document are the property of their respective owners, and the use of such logos does not imply any affiliation with or endorsement of CBRE. Photos herein are the property of their respective owners. Use of these images without the express written consent of the owner is prohibited.

CBRE

