

Bayshore Gardens

2907-2909 W Bay to Bay Blvd. Tampa, FL 33629



By the Numbers

(1-MILE)

WALK SCORE

73

MEDIAN AGE

45

EDUCATIONAL ATTAINMENT

74%

AVERAGE HH INCOME

\$191,386

POPULATION

14,293

TOTAL GLA OWNED (SF)

82,805



Welcome to *Bayshore Gardens*

This charming corner of South Tampa offers the vibe of a big city amid suburban seclusion, with residential streets rubbing shoulders with Tampa's top spots for shopping, dining, and nightlife.

- Sitting approximately three miles southwest of downtown Tampa on the banks of Hillsborough Bay, Bayshore Gardens is one of the most affluent residential neighborhoods in the Tampa MSA
- Last restaurant space remaining totaling 2,028 SF
- Adjacent to the new Ritz Carlton residents and surrounded by dense residential with a medium home price of \$1.5M
- Overall A+ Niche rating, ranking highest in the family and health and fitness categories
- Bayshore Boulevard, the neighborhood's namesake, boasts one of the country's longest sidewalks and panoramic views of Hillsborough Bay
- Join Barcelona Wine Bar, O-KU Sushi, Maru Rooftop Bar (all coming soon) and Counter Culture

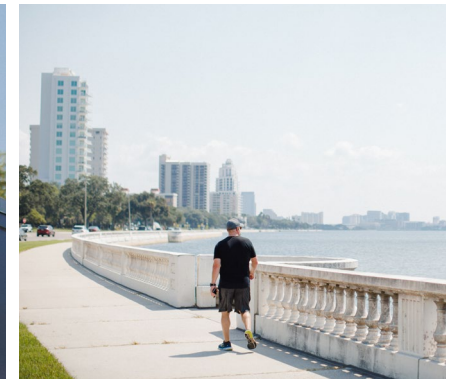

Our Location

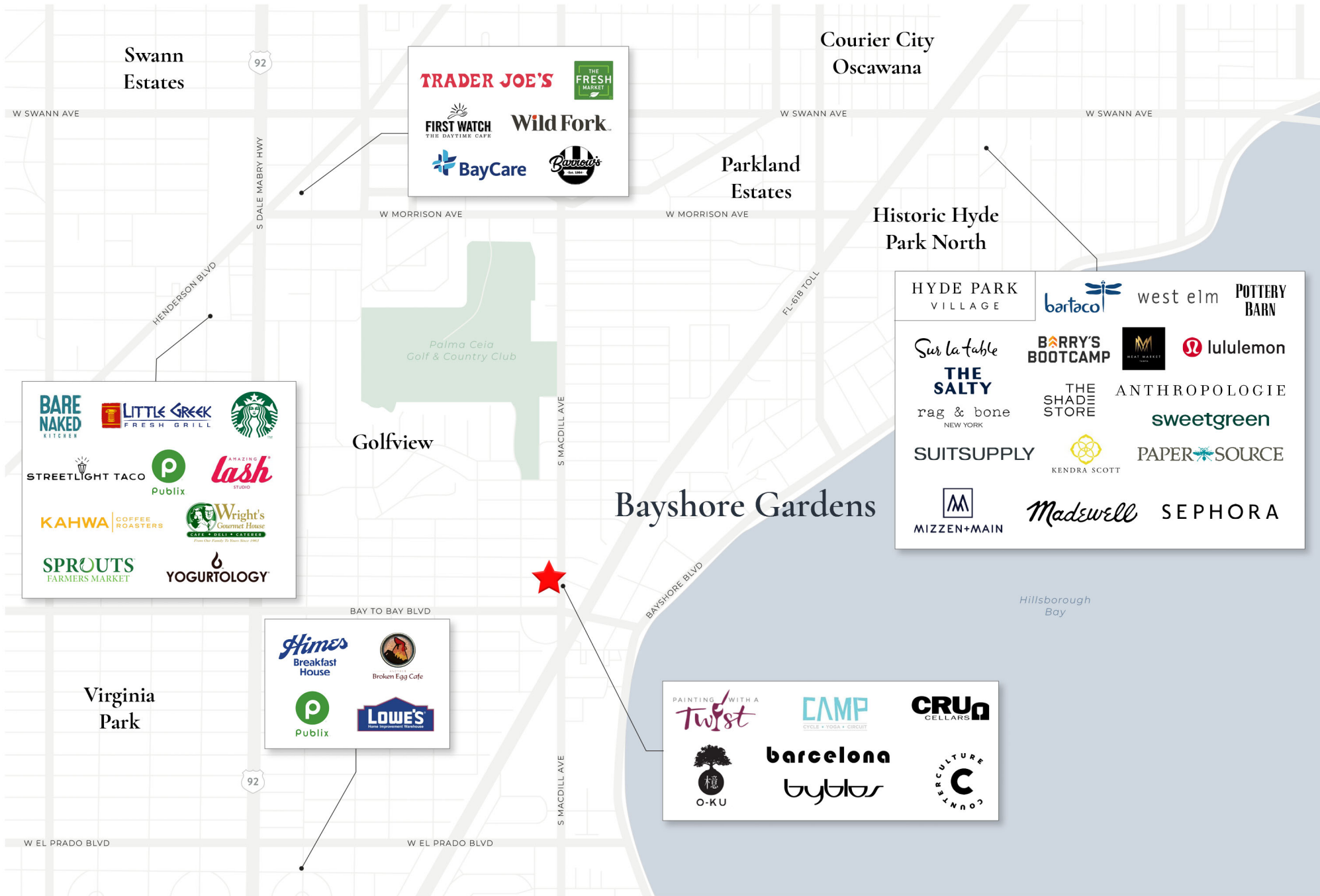

BAYSHORE GARDENS CONCEPTUAL RENDERINGS



RETAIL

Bayshore Gardens Site Plan

2907 & 2909 W BAY TO BAY BLVD

Tampa, FL 33629

AVAILABLE

LEASED

PATIO

LEVEL 6 (ROOFTOP)



2909

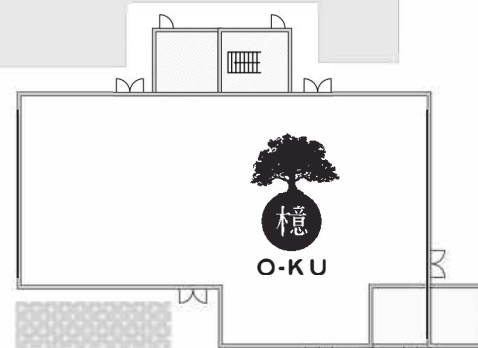

W BAY TO BAY BLVD

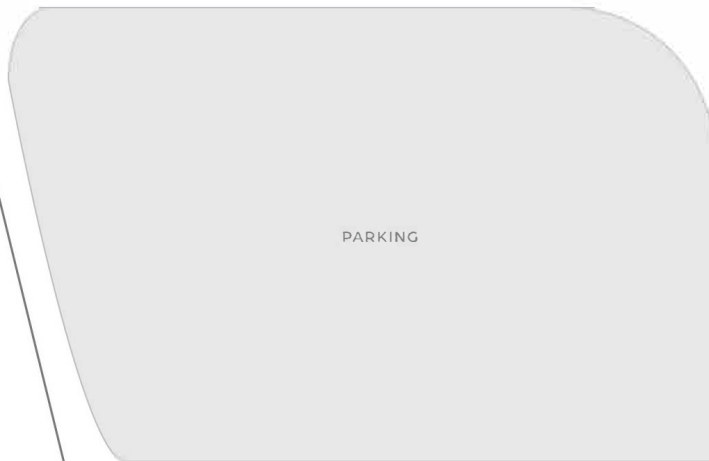

UNIT A103
2,028 SF



2907

S YSABELLA AVE



Get In Touch



Erica Waltermire
Executive Vice President
813 605 4471
erica.waltermire@colliers.com