

99-1295 Waiua Place

Aiea, HI 96701



For Lease

Ground Floor | Industrial Warehouse



Property Description

99-1295 Waiua Place

This turnkey, well-maintained warehouse space offers a flexible layout and exceptional features. The property includes a main warehouse section, office, a versatile mixed-use room, and two bathrooms. The property also features two separate roll-up doors, a spacious loading zone, and ample parking with one stall per 1,000 SF.

Space Features:

- Mens and Women's restroom in space
 - Office with water stubbed out
 - Parking: 1:1,000 SF on premises.
- (Additional Parking available on MTM basis.)





Property Info

Address: 99-1295 Waiua Place 1-B, Aiea, HI 96701

Price: \$1.30/SF/Mo

CAM: \$0.89/SF/Mo

Space Size: 8,128 SF

Lot Size: 1.25 AC

Zoning: 1-2



PROPERTY PHOTOS



LOCATION

Strategically located with excellent connectivity to major highways and transportation hubs, it ensures easy logistics and supply chain operations. The area boasts well-developed infrastructure, diverse industries, and abundant support services, creating a dynamic industrial environment. Competitive leasing and operational costs, along with government incentives, make it cost-effective. Additionally, the proximity to residential zones provides a steady supply of skilled labor. With scalable facilities, robust safety measures, and opportunities for networking and collaboration, Halawa Industrial Area is an ideal location for businesses seeking growth and efficiency.



PROPERTY FLOOR PLAN

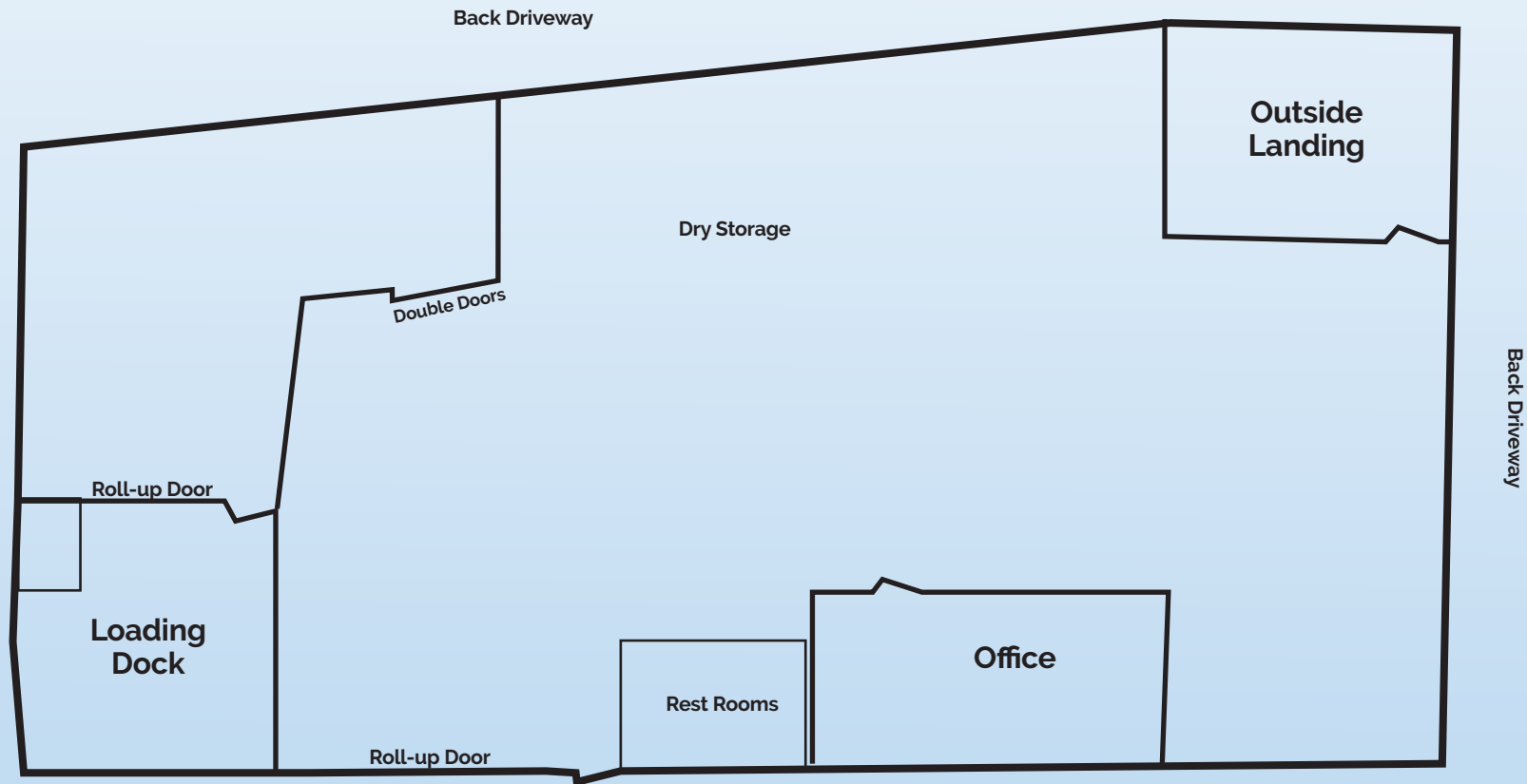

LET'S CONNECT

Keane Omaye-Backman | Lic. RS-76415
email: Keane@pacificpropertygrouphawaii.com
phone: (808) 292-6861

Wyatt Santilena | Lic. RS-87287
email: Wyatt@pacificpropertygrouphawaii.com
phone: (808) 421-8556

Peter Grossman | Lic. RS-68843
email: Peter@pacificpropertygrouphawaii.com
phone: (808) 282-0086