

For Lease

Flex Industrial Warehouse with Yard Space

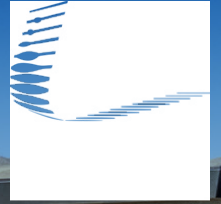

235-245 Washington St.
Reno, NV 89503

Casey Prostinak
Vice President
775.813.2866
cprostinak@logicCRE.com
S.0177148.LLC

Landon Gonzalez
Vice President
775.741.6397
lgonzalez@logicCRE.com
S.0179599.LLC

Kami Kaba
Associate
805.459.1236
kkaba@logicCRE.com
S.0197606

Listing Snapshot



\$1.15 PSF NNN*
Lease Rate



± 4,750 SF
Available Square Footage



± 4,750 SF
Fenced Yard Space

Property Highlights

- Freestanding flex building
- Fenced yard space
- Two (2) grade doors
- Central location in downtown Reno
- 200 Amp, 240V, 1-phase power

*NNN Lease Rate excludes: NNN expenses - estimated at \$0.15 PSF/Mo., utilities, telecommunications, maintenance and repair of Premises. To be further detailed in Lease.

Demographics

	1-mile	3-mile	5-mile
2024 Population	20,730	135,028	237,063
2024 Average Household Income	\$80,612	\$87,973	\$97,325
2024 Total Households	10,792	58,528	98,911



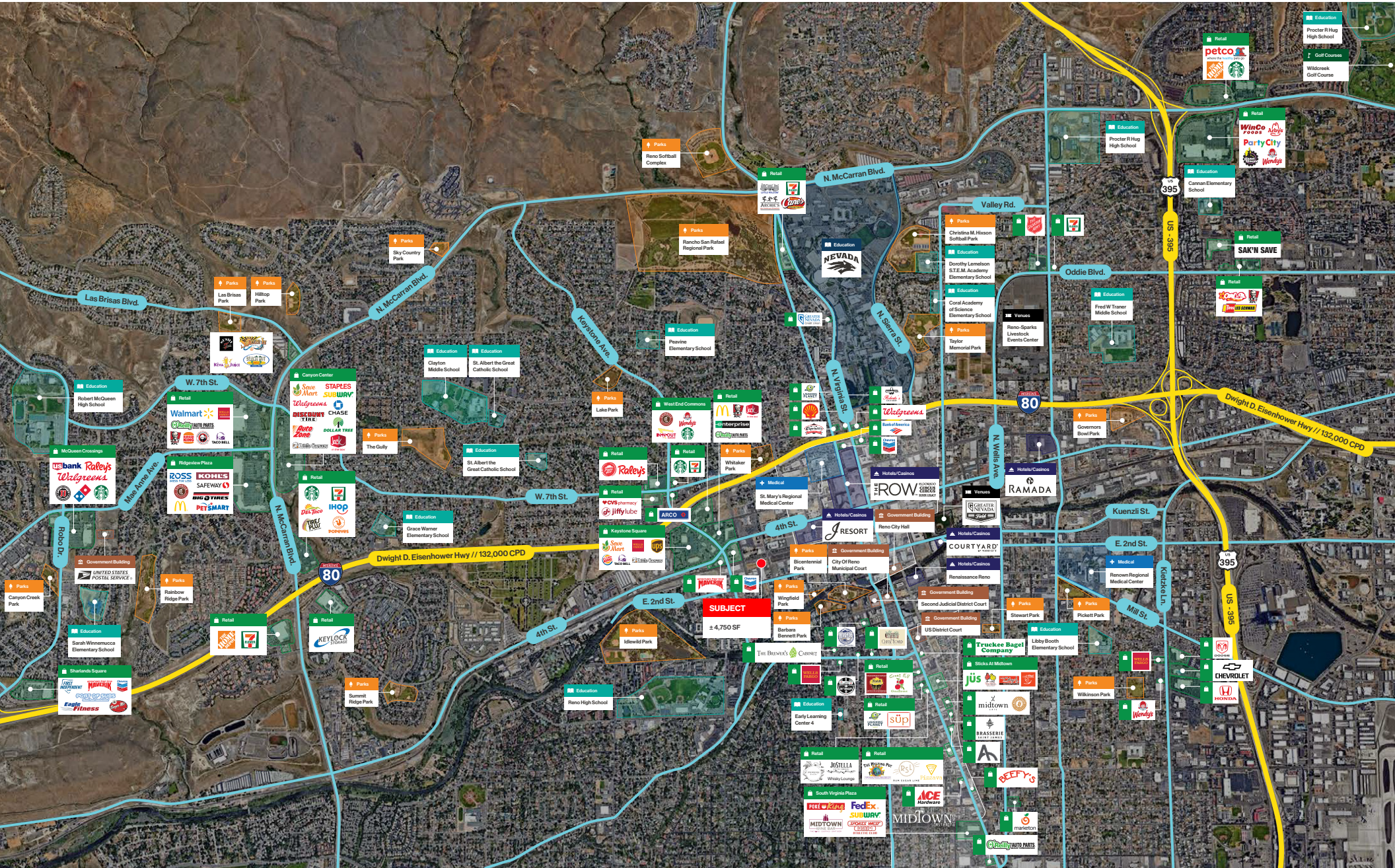

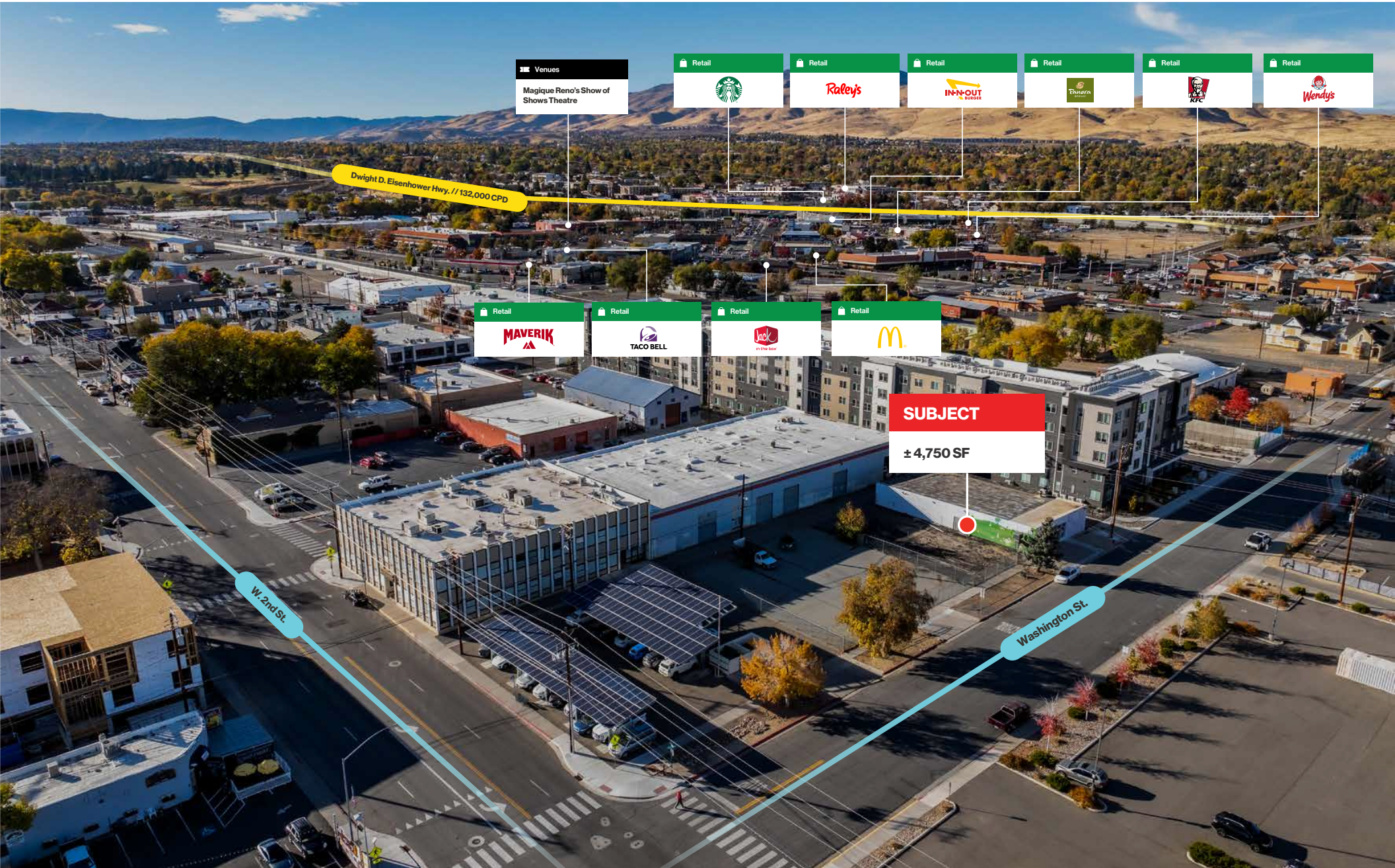

Venues
Magique Reno's Show of Shows Theatre

Retail

Retail

Retail

Retail

Retail

Retail

Dwight D. Eisenhower Hwy. // 132,000 CPD

Retail

Retail

Retail

Retail



SUBJECT
± 4,750 SF

W. 2nd St.

Washington St.

Floor Plan

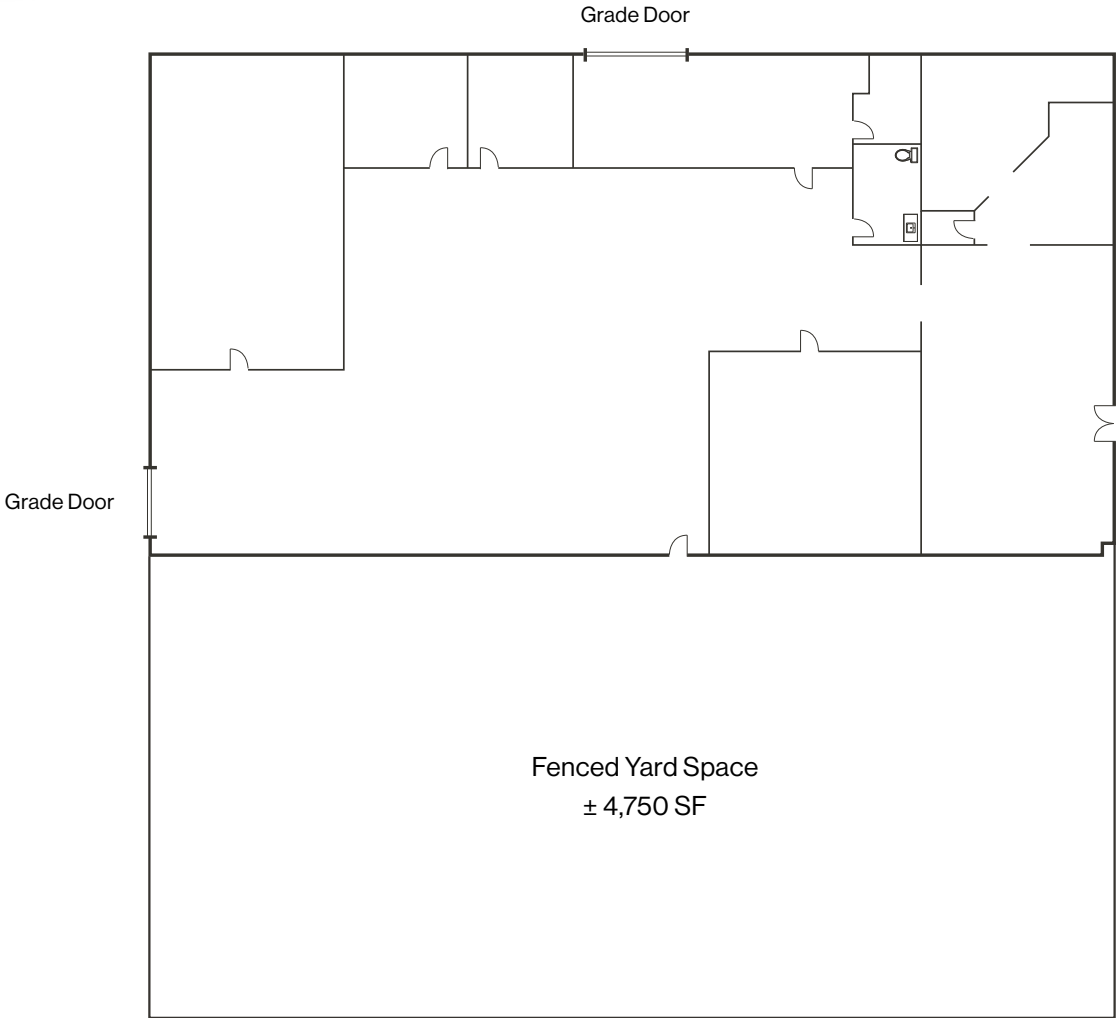
[Click for a Virtual Tour](#) 



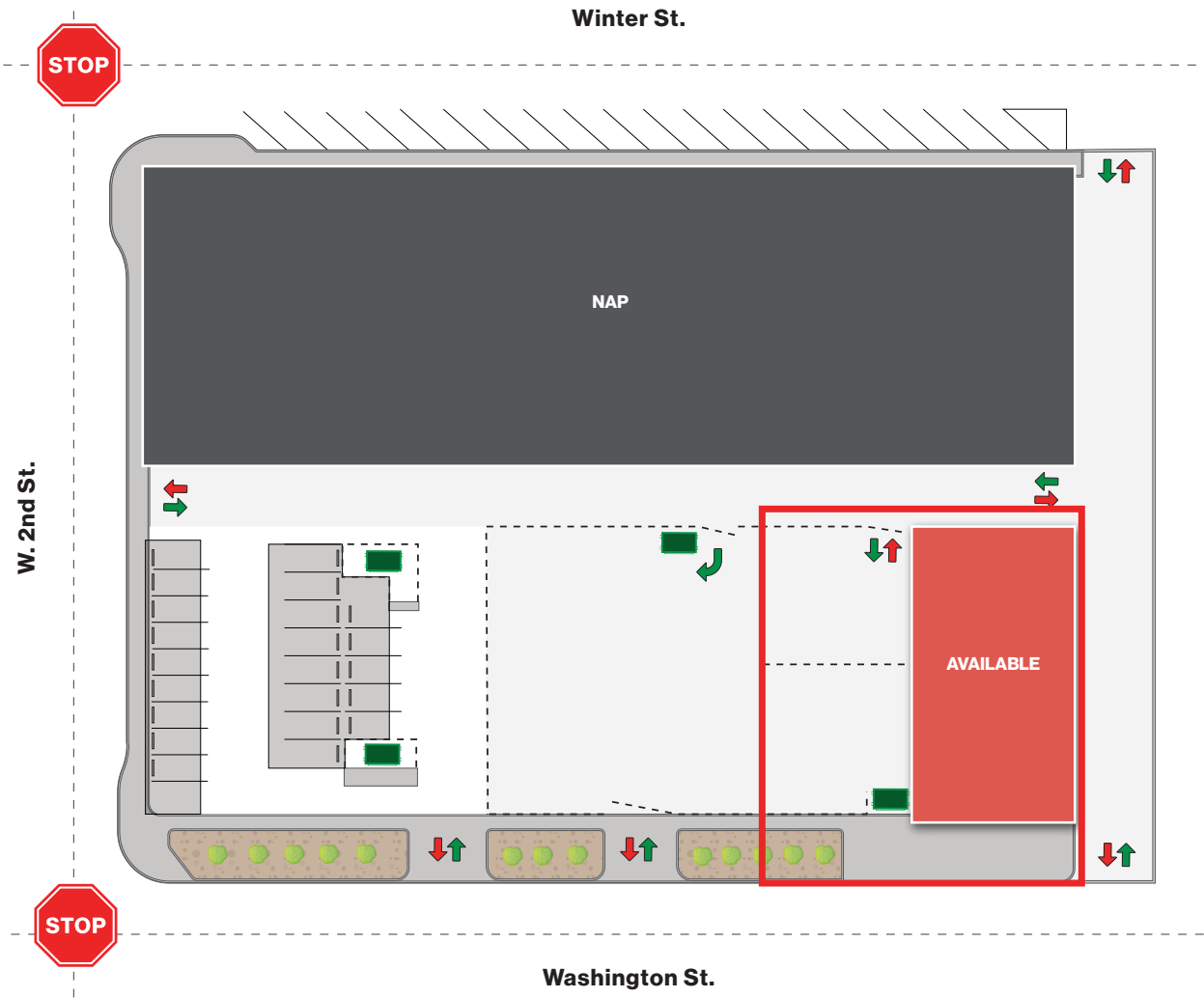

Property Photos



LOGIC Commercial Real Estate

Specializing in Brokerage and Receivership Services



Join our email list and
connect with us on LinkedIn

The information herein was obtained from sources deemed reliable; however LOGIC Commercial Real Estate makes no guarantees, warranties or representation as to the completeness or accuracy thereof.

For inquiries please reach out to our team.

Casey Prostinak

Vice President
775.813.2866
cprostinak@logicCRE.com
S.0177148.LLC

Landon Gonzalez

Vice President
775.741.6397
lgonzalez@logicCRE.com
S.0179599.LLC

Kami Kaba

Associate
805.459.1236
kkaba@logicCRE.com
S.0197606