

Lower Floor - "New Tenant"
- +/- 12,665/SF of WH
- to share "Loading Dock" & "drive-in"

- allow right of passage for loading

Top Platform - "Existing Tenant"
- +/- 2000 ofc / +/-2000 WH floor
- to share "Loading Dock" & "drive-in"
- allow right of passage for loading

Shared Drive-In

Shared Loading Dock



Shared Loading Dock



Shared Drive-In

Lower Floor - "New Tenant"
- to share loading dock & drive-in and allow right of passage for both parties

Top Platform - "Existing Tenant"
- to share loading dock & drive-in and allow right of passage for both parties



29315 Clayton - Floor Plan

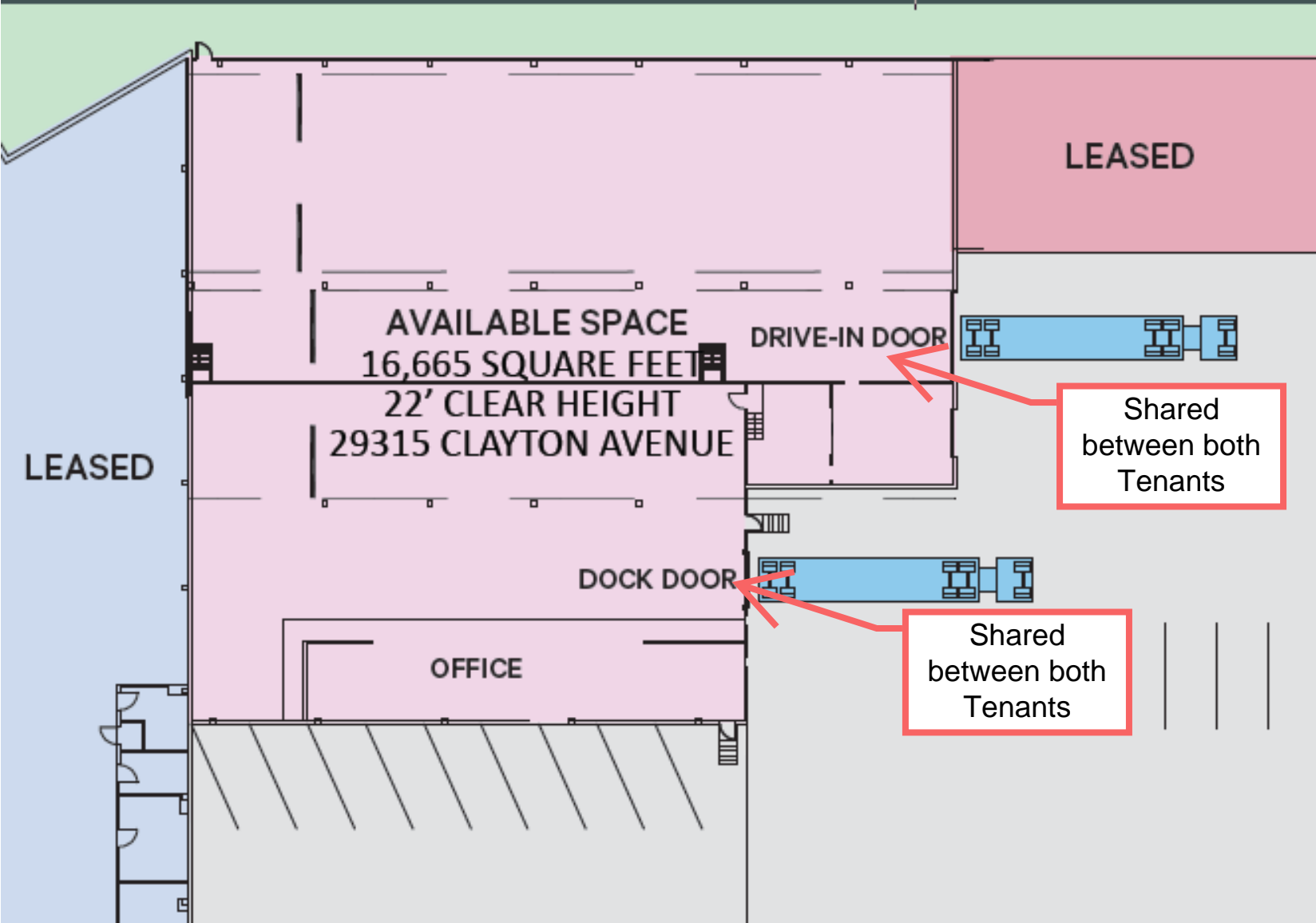

Site Plan

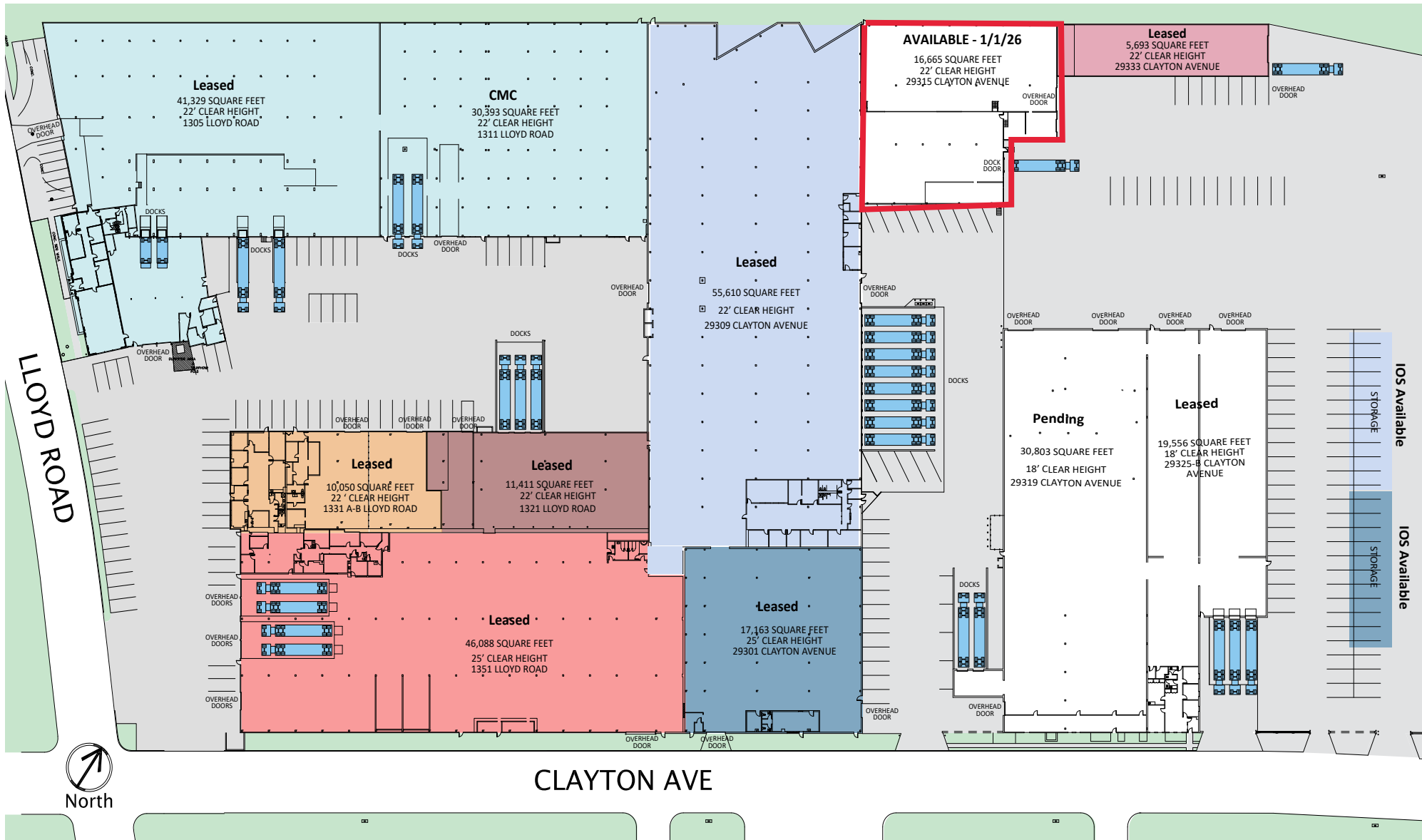

North

CLAYTON AVE

LLOYD ROAD