



RETAIL
SPACES
**FOR
LEASE**



800 N ALAMEDA ST | LOS ANGELES, CALIFORNIA



WHERE LOS ANGELES BEGINS



JOIN THE **LEGACY**



JOIN THE VIBRANT heartbeat of downtown Los Angeles at Union Station, the largest railroad passenger terminal in the Western U.S. With thousands of daily visitors, it offers unparalleled foot traffic. As a hub for Amtrak, Metrolink, and Metro, it

connects to major attractions like The Broad and Walt Disney Concert Hall. Leasing here means aligning your brand with a rich history while embracing a modern retail environment. Don't miss the chance to be part of this iconic destination!



MERGING HERITAGE AND FORWARD-THINKING MODERNISM

AN ICONIC LANDMARK, the Station serves as a vibrant symbol of Downtown connecting the historic fabric of the past to the present through arts, culture, transit and community. Conceived on a grand scale, Los Angeles Union Station is the largest railroad passenger terminal in the Western United States and is often regarded as “the last of the great train stations.”



Build your brand here and be a part of Los Angeles history.

Monumental Gateway
to Los Angeles



THE LOS ANGELES UNION STATION, completed in 1939, is the largest railroad passenger terminal in the Western United States. Designed by the architectural team of John and Donald Parkinson, the Station boasts a unique combination of Spanish Colonial, Mission Revival, and Art Deco styles, which has come to be known as Mission Moderne. While it thrived during World War II, the rise of cars and planes led to declining passenger numbers. Nevertheless, Union Station remains an iconic and historic part of LA's transportation scene. Designated a Los Angeles Historic-Cultural Monument in 1972 and listed in national and state registers, it represents the spirit of the California dream and a vibrant arts and culture destination.



LAST OF THE GREAT TRAIN STATIONS



MAIN TERMINAL

THE MAIN TERMINAL, completed in 1939, is a 161,000-square-foot reinforced concrete structure featuring an H-shaped plan. Its main north-south axis includes the Northwest Office, Ticket Concourse, Clock Tower, Main Arcade, and the former Fred Harvey restaurant, with arcades at each end. Perpendicular to this axis are the Waiting Room and North and South patios. The design showcases a blend of Spanish Colonial and Mission Revival styles, accented by Art Deco elements, highlighted by a 127-foot clock tower, clay tile roofs, and decorative wrought iron grilles. Subterranean parking and basements are also part of the facility.

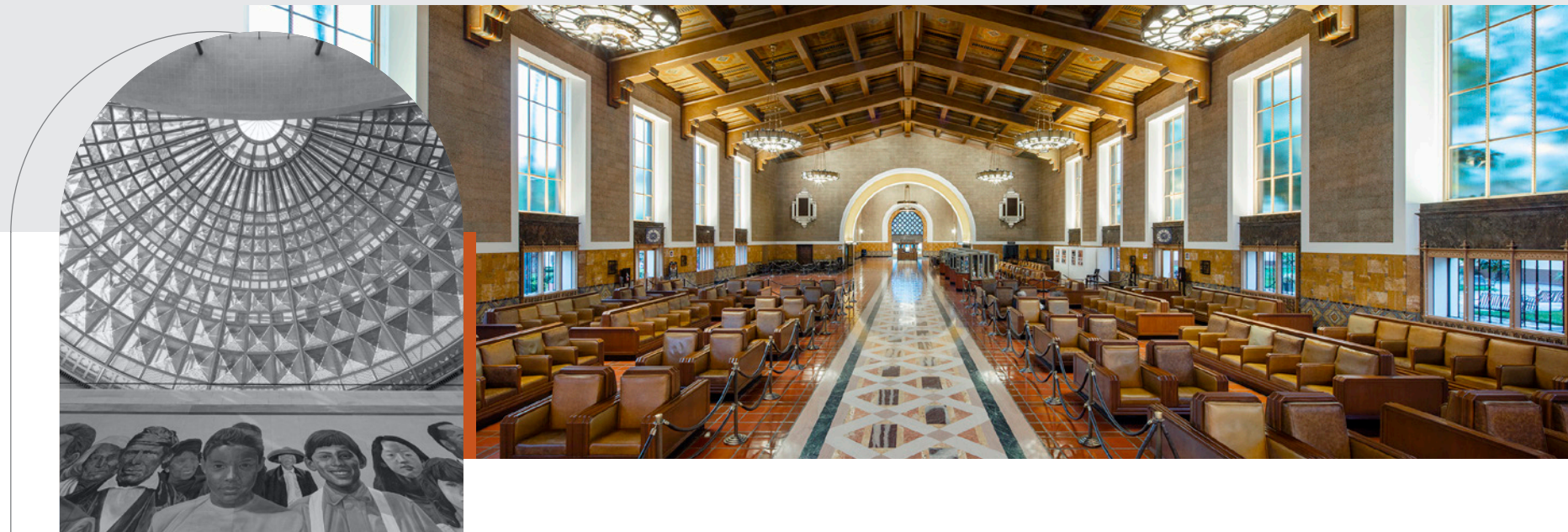

AVAILABLE | FH-101 ±10,266 SF





UNION STATION EAST is a part of the broader Union Station complex. It encompasses the eastern section of the station and serves as a hub for various transit services, including Amtrak and Metrolink trains. The area has seen significant development and revitalization efforts, aimed at enhancing connectivity and improving passenger experiences.



UNION STATION EAST

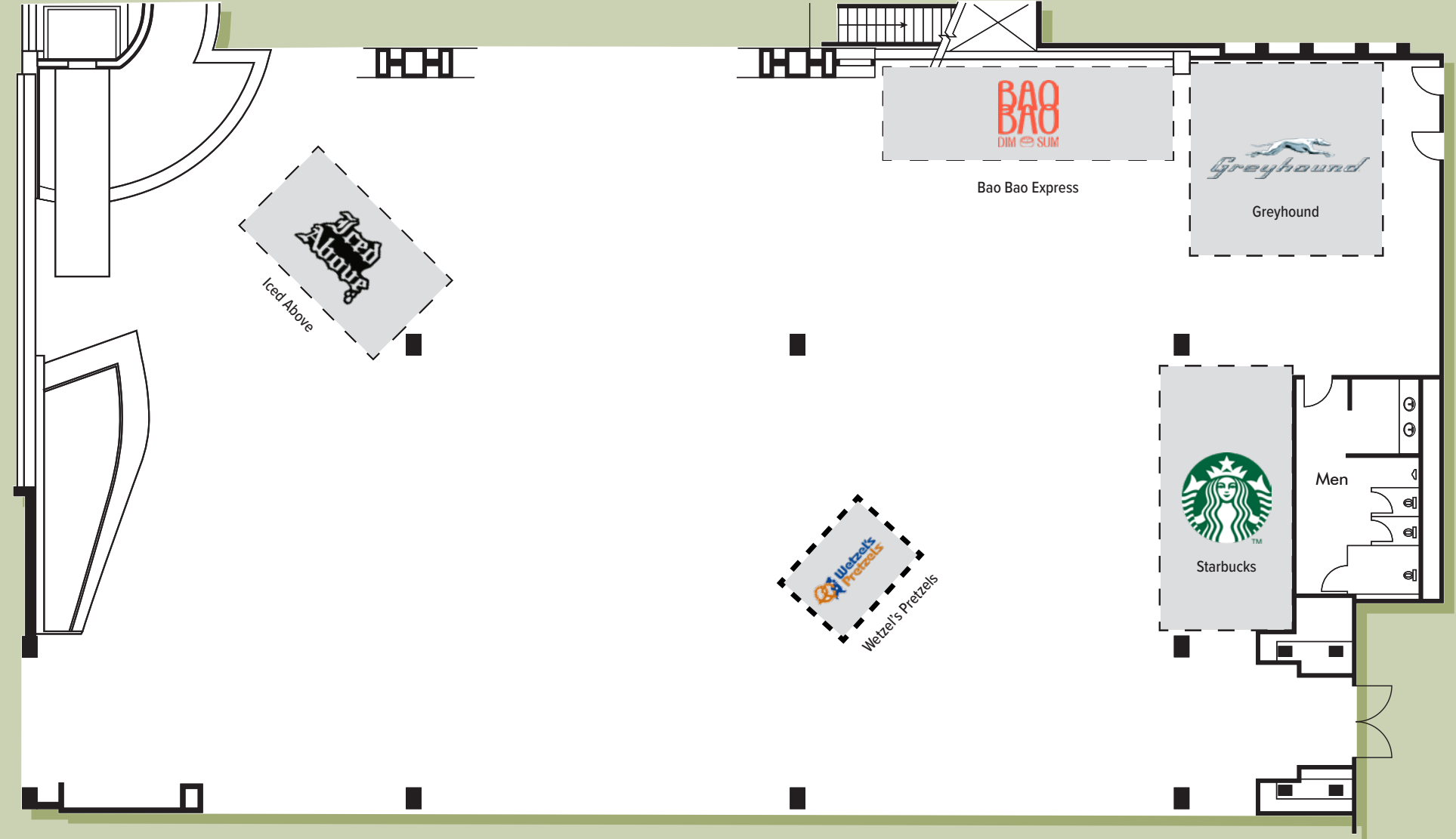

Union Station East

UNION STATION EAST

UNION STATION EAST features a modern design by McClaren/Vasques, which seamlessly connects Union Station to the Patsaouras Transit Plaza. This area is not only a transit hub but also a cultural highlight, showcasing several extraordinary pieces of Metro Art. A standout feature is the impressive 87-foot-high etched glass ceiling, which beautifully mimics patterns found throughout the Station, enhancing the aesthetic experience for visitors and passengers alike. This blend of functionality and artistic expression reinforces Union Station’s role as a vibrant gateway to Los Angeles.

AVAILABLE | RETAIL 7 ±500 – 700 SF
 RETAIL 8 ±500 – 700 SF

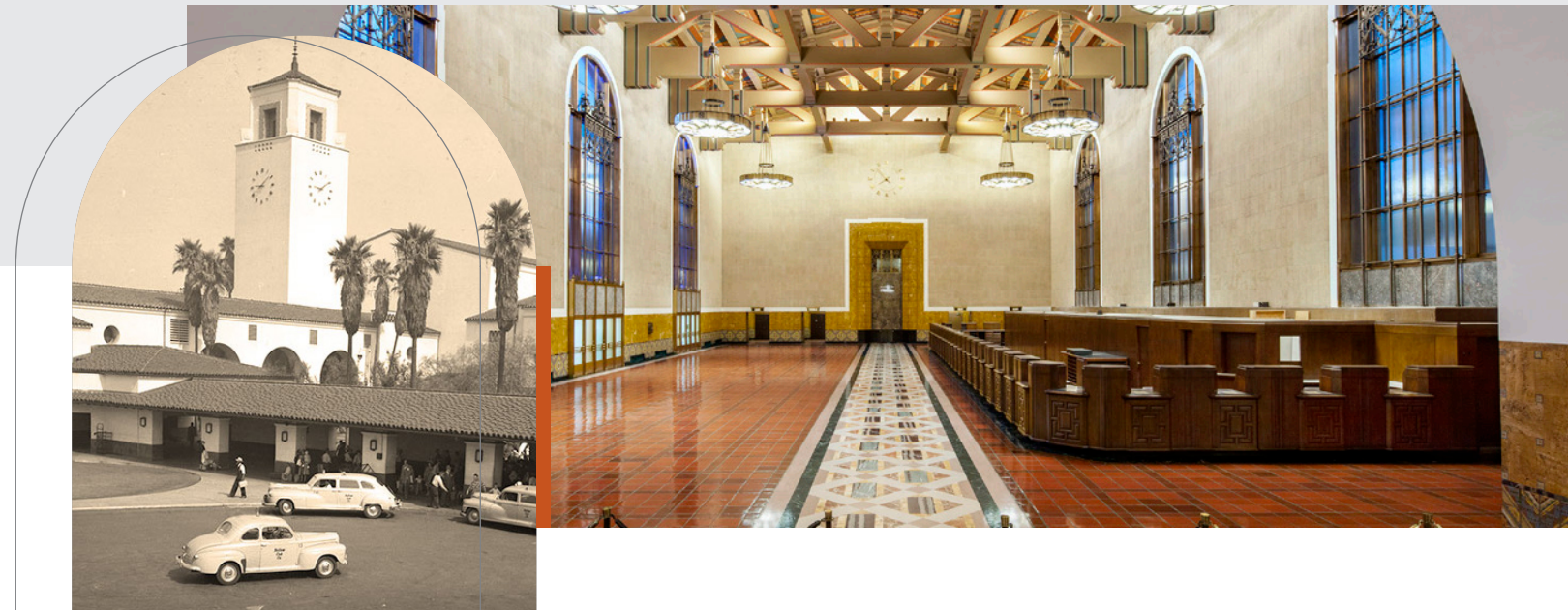
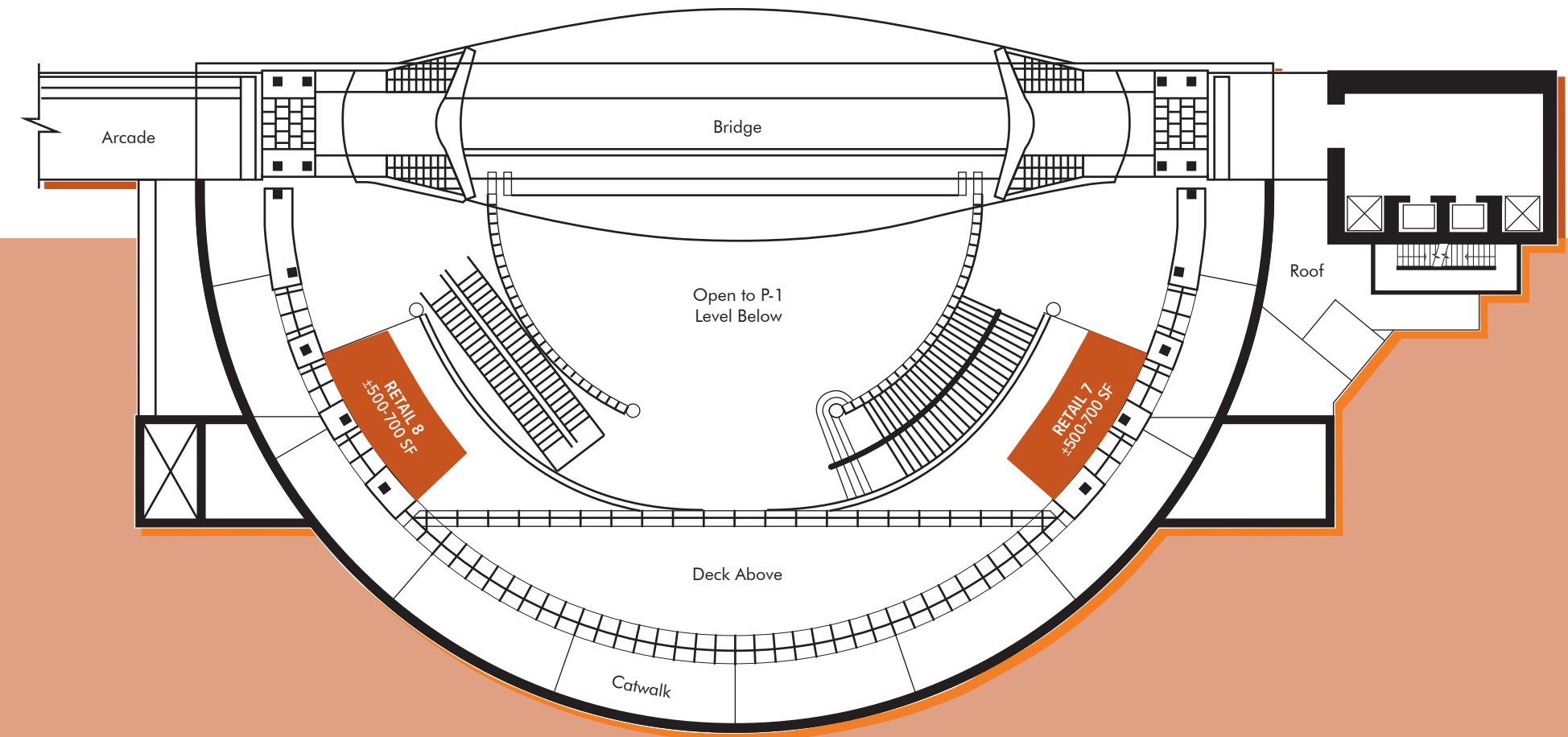

PASSENGER CONCOURSE

THE SPACE HOUSES ticketing, eateries and leads into the main Passageway to the train arrivals and departures. In terms of its design, the concourse's polychromatic palette aligns with the decorative color scheme found throughout the Station. The flooring is comprised of integrally colored red, gray, tan, yellow, orange and black concrete tiles while the ceiling is supported by columns featuring flared capitals at the top and multi-colored glazed tile at the base.

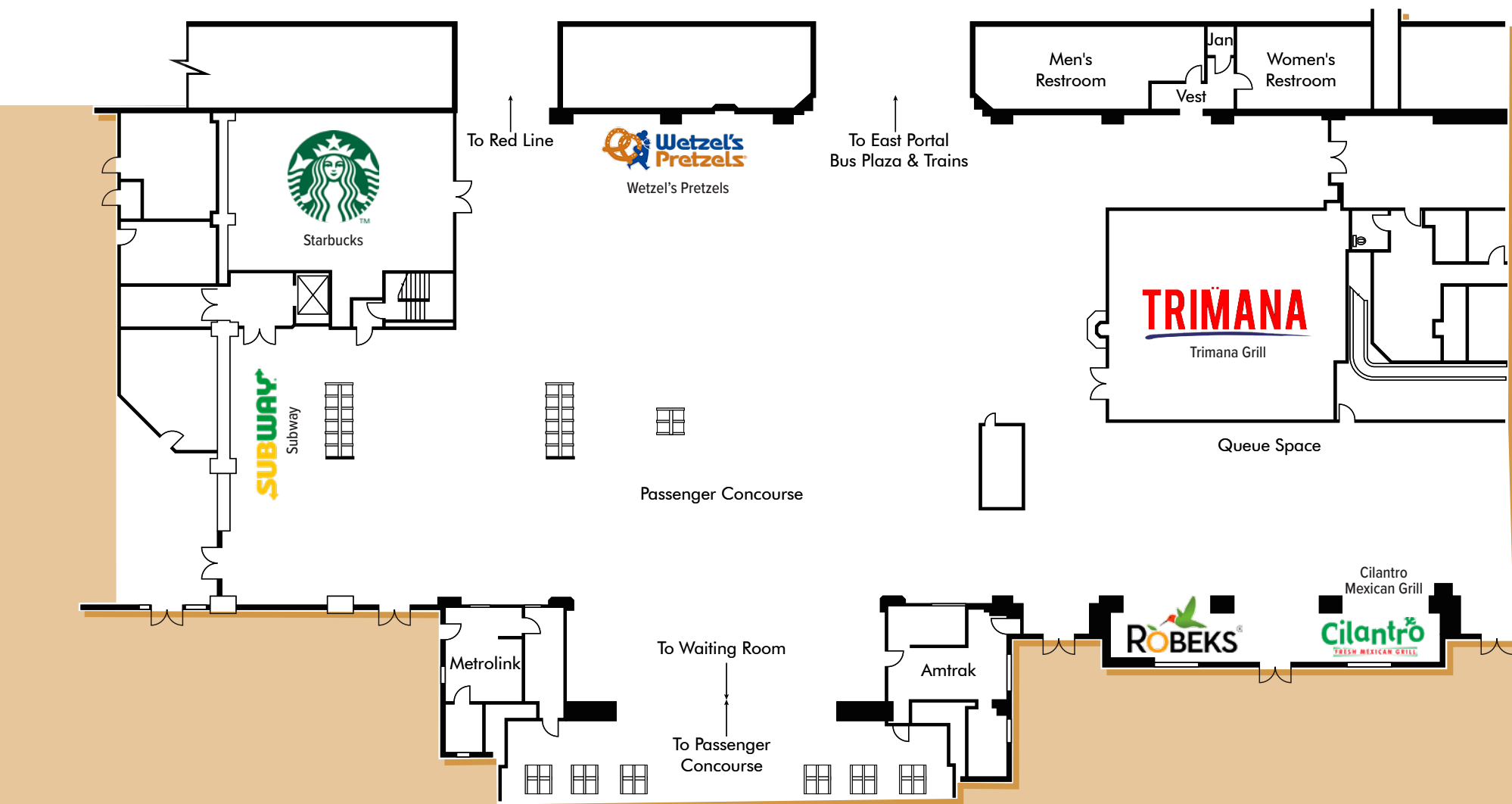

DISCOVER THE DETAILS

OVER
\$2 BILLION
IN EXPANSIONS
AND UPGRADES
IN PROGRESS

EAST
PORTAL
VENUES
±60 – ±700 SF

60K
DAILY
VISITORS

880
ARRIVAL/
DEPARTURES
DAILY
(LIGHT AND
HEAVY RAIL)

22M
VISITORS
ANNUALLY

For many travelers, Union Station was a first impression of the Los Angeles and, in some cases, the American West

Metro has shown a commitment to the careful stewardship of this architectural icon through a series of projects that preserve and restore the historic terminal, while also adapting the facility to ever-evolving uses without compromising its historic character.

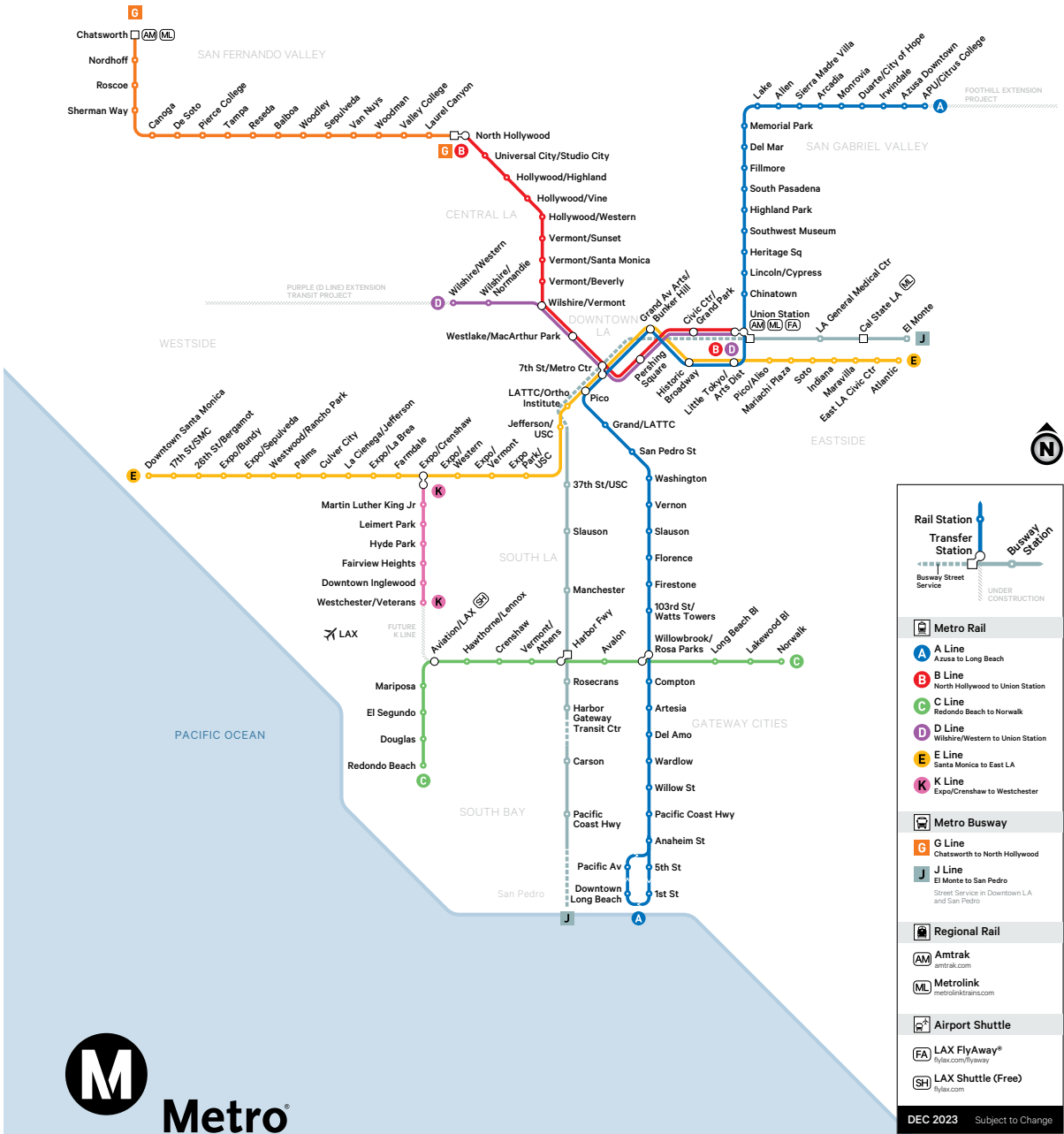

Metro



KEEP MOVING

TODAY, THE STATION has evolved into a vibrant transportation center in the heart of Los Angeles serving thousands of passengers daily. It is the primary regional hub for Amtrak and Metrolink's commuter train service and is a transfer point for **Metro's Red, Purple and Gold Lines**. Linked to the Patsaouras Transit Plaza, it offers essential transit connections to destinations throughout Los Angeles.





CALL +1 213 613 3272

DERRICK MOORE

Senior Vice President
Lic. 01029938
derrick.moore@cbre.com

DIANDRA DILLON

Sales Assistant
Lic. 02210049
diandra.dillon@cbre.com

SHIHO TAKEI MOORE

Associate
Lic. 02224981
shiho.moore@cbre.com

© 2024 CBRE, Inc. All rights reserved. This information has been obtained from sources believed reliable but has not been verified for accuracy or completeness. You should conduct a careful, independent investigation of the property and verify all information. Any reliance on this information is solely at your own risk. CBRE and the CBRE logo are service marks of CBRE, Inc. All other marks displayed on this document are the property of their respective owners, and the use of such logos does not imply any affiliation with or endorsement of CBRE. Photos herein are the property of their respective owners. Use of these images without the express written consent of the owner is prohibited.