

TREE IDENTIFICATION AND DENDROLOGY

TREE #	TREE ID	COMMON NAME	TREE ID	BOTANICAL NAME	DBH	VITALITY/CONDITION	SAVE/REMOVE
1		BLACK MULBERRY	MORUS NIGRA		15"	FAIR CONDITION/POOR FORM	REMOVE
2		AMERICAN HOLLY	ILEX OPACA		7"	GOOD CONDITION	REMOVE
3		SWEETGUM	LIQUIDAMBAR STYRACIFLUA		12"	GOOD CONDITION	SAVE
4		SWEETGUM	LIQUIDAMBAR STYRACIFLUA		17"	GOOD CONDITION	SAVE
5		SWEETGUM	LIQUIDAMBAR STYRACIFLUA		16"	GOOD CONDITION	SAVE
6		SUGAR MAPLE	ACER SACCHARUM		16"	GOOD CONDITION	SAVE
7		SUGAR MAPLE	ACER SACCHARUM		12"	GOOD CONDITION	SAVE
8		BLACK LOCUST	ROBINIA PSEUDACACIA		16"	FAIR CONDITION/POOR FORM	SAVE
9		SWEETGUM	LIQUIDAMBAR STYRACIFLUA		24"	GOOD CONDITION	REMOVE
10		SWEETGUM	LIQUIDAMBAR STYRACIFLUA		20"	FAIR CONDITION	REMOVE

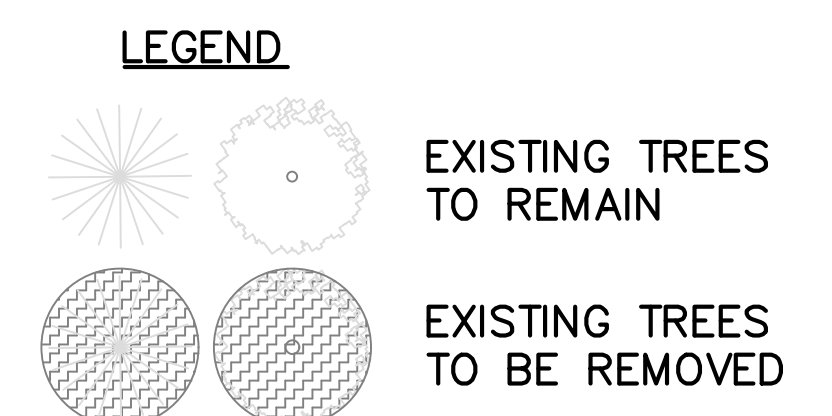

SOIL LOG TP-1
SPOT GRADE ELEV.=18.9 FT

DEPTH (ft.) SOIL DESCRIPTION

0" TO 10" 10YR 3/3 DARK BROWN TOPSOIL, OVERGROWN LAWN AT SURFACE, MANY FINE ROOTS TO 6", CLEAR BOUNDARY

10" TO 19" 10YR 5/2 GRAYISH BROWN SANDY LOAM, SOME SILT, SUBANGULAR STRUCTURE, MED. GRAIN SIZE, LOOSE FRIABLE CONSISTENCY, DRY, CLEAR BOUNDARY

19" TO 78" 5YR 4/3 REDDISH BROWN SANDY LOAM, LITTLE SILT, SUBANGULAR STRUCTURE, MED. GRAIN SIZE, LOOSE FRIABLE CONSISTENCY, DRY, CLEAR BOUNDARY

78" TO 120" 10YR 6/4 LT YELLOWISH BROWN SAND, SOME SILT, LITTLE PEA GRAVEL, SUBANGULAR STRUCTURE, SMALL GRAIN SIZE, FRIABLE CONSISTENCY, MOIST AT 8'-0"

END OF EXCAVATION AT 10'-0"
NO WATER ENCOUNTERED - ESTIMATED DEPTH TO SHWT 8'-6"

SOIL LOG TP-2
SPOT GRADE ELEV.=17.6 FT

DEPTH (ft.) SOIL DESCRIPTION

0" TO 12" 10YR 3/3 DARK BROWN TOPSOIL, OVERGROWN LAWN AND DEBRIS AT SURFACE, CLEAR BOUNDARY

12" TO 55" 10YR 5/2 GRAYISH BROWN SANDY LOAM, SOME SILT, SUBANGULAR STRUCTURE, MED. GRAIN SIZE, LOOSE FRIABLE CONSISTENCY, DRY, CLEAR BOUNDARY

55" TO 98" 10YR 6/4 LT YELLOWISH BROWN SAND, SOME SILT, SUBANGULAR STRUCTURE, SMALL GRAIN SIZE, FRIABLE CONSISTENCY, MOIST AT 8'-0"
MEASURED PERMEABILITY = K5 (>20 IN/HR)

END OF EXCAVATION AT 8'-2"
NO WATER ENCOUNTERED - ESTIMATED DEPTH TO SHWT 8'-6"

SOIL LOG TP-3
SPOT GRADE ELEV.=18.8 FT

DEPTH (ft.) SOIL DESCRIPTION

0" TO 12" 10YR 3/3 DARK BROWN TOPSOIL, OVER LEAF LITTER AT SURFACE, SOME FINE ROOTS TO 8", CLEAR BOUNDARY

12" TO 63" 10YR 5/2 GRAYISH BROWN SANDY LOAM, SOME SILT, SUBANGULAR STRUCTURE, MED. GRAIN SIZE, LOOSE FRIABLE CONSISTENCY, DRY, CLEAR BOUNDARY

63" TO 99" 10YR 5/4 GRAYISH BROWN SILTY SAND, LITTLE CLAY, SUBANGULAR STRUCTURE, SMALL GRAIN SIZE, FRIABLE CONSISTENCY, MOIST AT 8'-0"
MEASURED PERMEABILITY = K2 (0.2 TO 2 IN/HR)

END OF EXCAVATION AT 8'-3"
NO WATER ENCOUNTERED - ESTIMATED DEPTH TO SHWT 8'-6"



5	6-01-24	REV. FOR TOWNSHIP LAND USE BOARD - RESOLUTION COMPLIANCE	ARS
4	12-01-23	REV. FOR TOWNSHIP LAND USE BOARD - RESOLUTION COMPLIANCE	ARS
3	7-22-22	REV. PER TOWNSHIP ENGINEER'S 11-23-21 PROJECT REVIEW	ARS
2	10-01-21	REV. PER TOWNSHIP ENGINEER'S 6-30-21 COMPLETENESS REVIEW	ARS
1	3-01-21	UPDATE FOR TOWNSHIP LAND USE BOARD SUBMISSION	ARS
No.	DATE	REVISION	BY

EASTERN CIVIL ENGINEERING, LLC
CIVIL ENGINEERING - SURVEYING & MAPPING - LAND USE PLANNING - SITE DESIGN
31 GRAND TOUR, HIGHLANDS NJ 07732 PHONE: 732.872.7736

BOUNDARY AND TOPOGRAPHIC SURVEY MAP FOR

MICHAEL MARGARELLA
BLOCK 47 LOTS 2, 3, 5 & 6
TAX MAP SHEET No. 15

HAZLET TOWNSHIP, MONMOUTH COUNTY, NEW JERSEY

ANDREW R. STOCKTON
PROFESSIONAL ENGINEER & LAND SURVEYOR
NEW JERSEY LIC. NO. 35405

DATE:	SCALE:	DESIGN BY:	PROJECT NO.:	SHEET NO.:
9-29-20	1" = 20'	ARS	2001813	3 of 9