

347

GEARY STREET

SAN FRANCISCO | CA

4,500 - 7,572 SF Ground
5,100 SF Basement

Large kitchen with two
Type I hoods

Generous seating capacity
with an open floor plan

The hotel has been catering to
locals and international guests
for decades

Ideal for supporting a
commissary or facilitating large
private dining experiences

UNION SQUARE
RESTAURANT OPPORTUNITY

PRIME LOCATION PERFECT PLATE

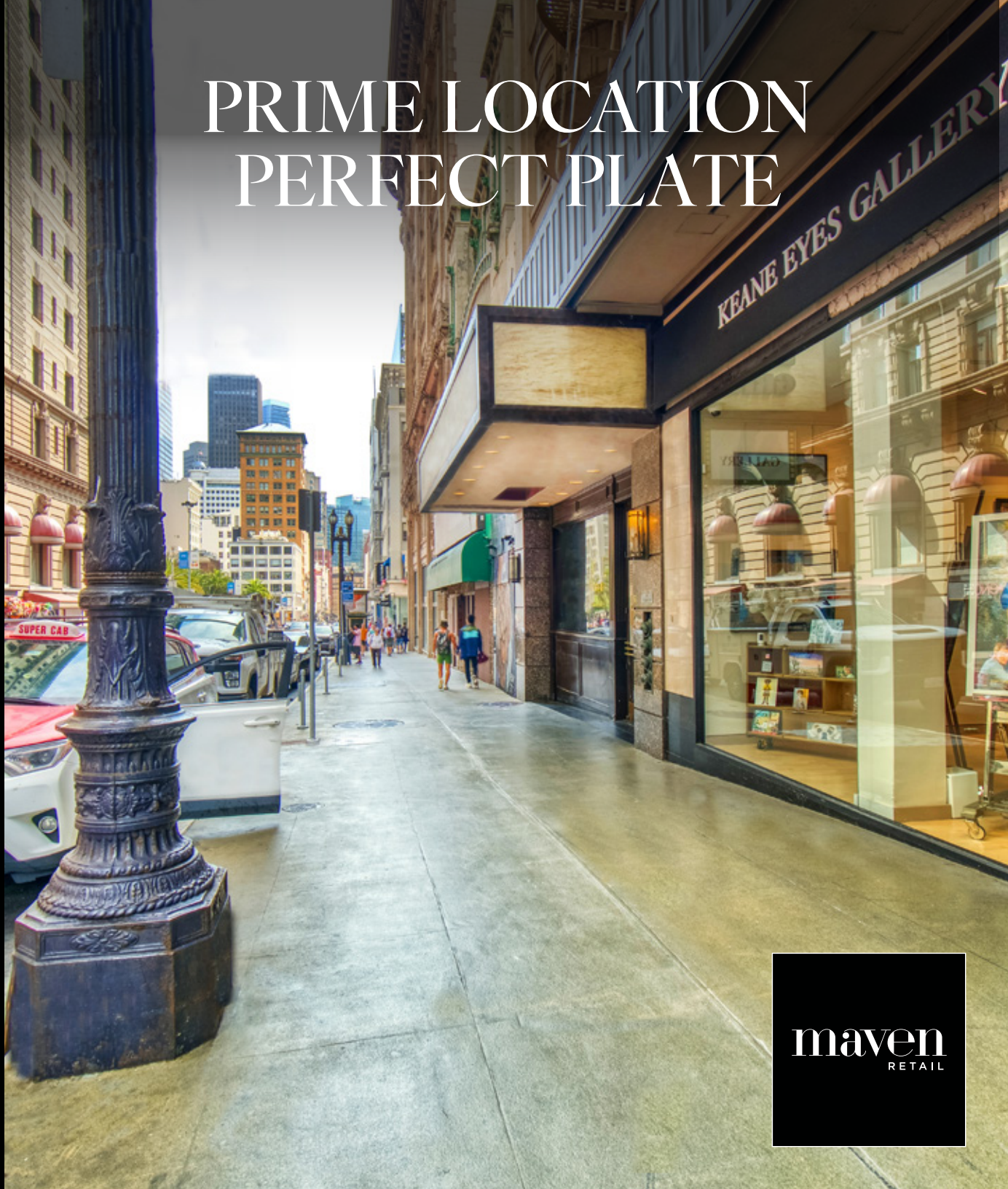

maven
RETAIL

347 GEARY STREET

Restaurant Highlights

- **Restaurant-ready** with a large kitchen, which features two Type I hoods, restrooms, and a bar ready to serve up delicious meals on day one
- The building owner is a dedicated local **landlord with a profound commitment** to the long-term prosperity of Downtown San Francisco
- **Generous seating capacity** with an open floor plan that is versatile enough to accommodate various concepts including restaurants, bars offering food service, and entertainment venues, perfect for special events
- The space **exudes charming old-world ambiance** with an ample basement available that is ideal for supporting a commissary or facilitating large private dining experiences.
- In close proximity to **major hotels, arts and entertainment venues**, public transportation, and parking
- The Handlery Family is willing to get creative and work face-to-face with an operator to structure **a lease** that is **mutually acceptable and lucrative** for both parties
- **Nearby neighbors** include Corzetti, Neiman Marcus, Kin Khao, Curran Theater, Saks Fifth Avenue, American Conservatory Theater, and more





347

GEARY STREET

San Francisco

Step into a coveted opportunity to revitalize a well-known dining destination within Handlery Union Square Hotel, strategically located in the epicenter of San Francisco's Union Square and known for catering to locals and international guests for decades. The property is within proximity to the world-famous Powell Street Cable Car, multiple art, live theater and entertainment venues, public transportation, and parking. It is surrounded by world-class boutiques, unique shops, top-tier dining, posh hospitality, and many iconic sites for Bay Area locals and visitors alike. There are a multitude of nearby hotels, providing great traffic and an ideal situation for any new culinary venture.









FLOOR PLAN

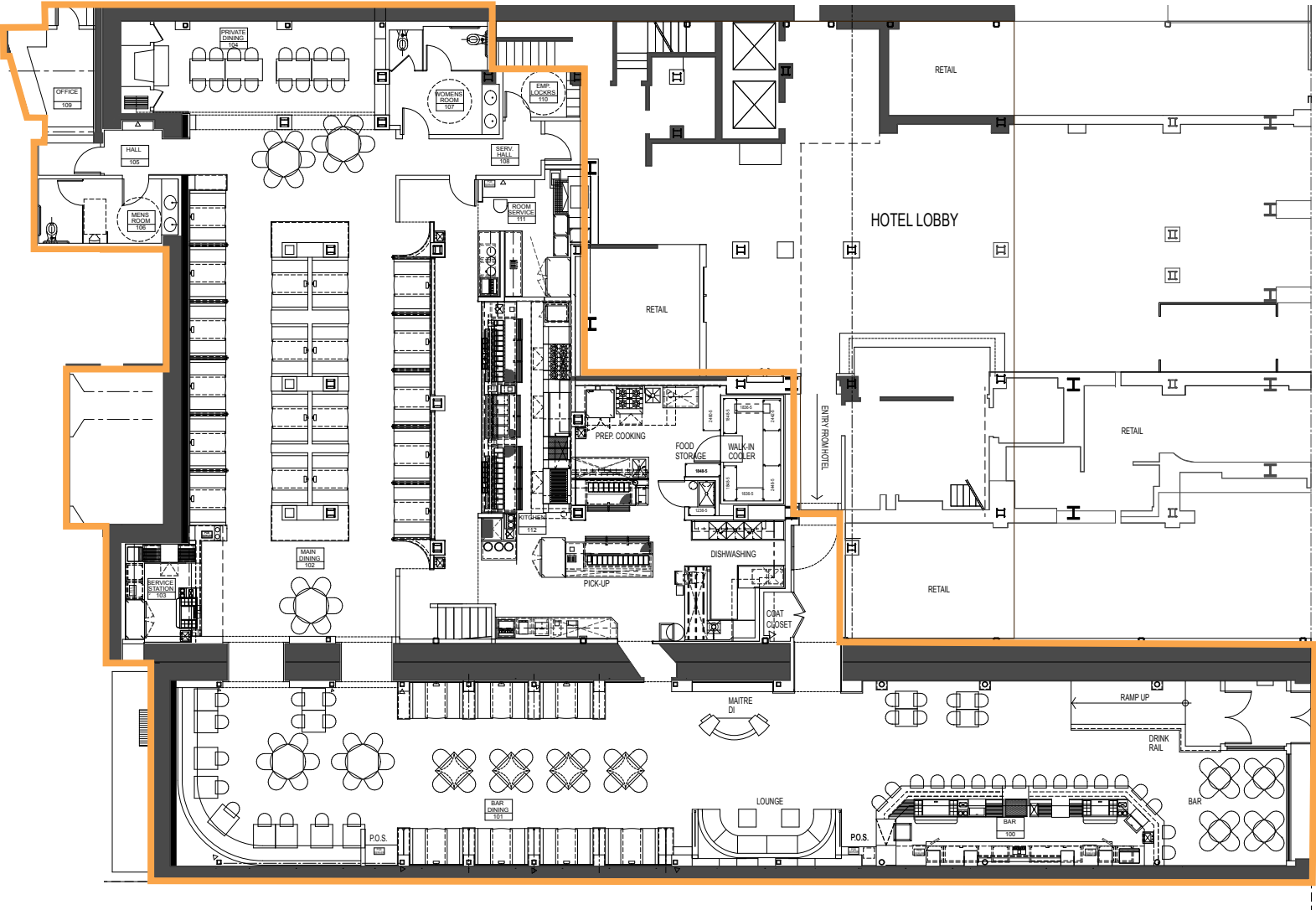

Neighborhood



WALK SCORE

93

TRANSIT SCORE

100

BIKE SCORE

95



CORZETTI



NEIMAN MARCUS



ACT



BRUNELLO CUCINELLI



MACY'S



KIN KHAO



APPLE STORE



THE CURRAN THEATRE



SONS AND DAUGHTERS



LOUIS VUITTON



AUGUST HALL



YSL



HANDLERY UNION SQUARE HOTEL



THE WESTIN ST. FRANCIS



NINTENDO



maven
RETAIL

CONTACT

PAMELA MENDELSON

office 415.404.6650
pam@mavenproperties.com
DRE #00953050

CATHERINE MEUNIER

office 415.462.7679
catherine@mavenproperties.com
DRE #01843732

GLORIA NORDBAKK

office 415.225.0626
gloria@mavenproperties.com
DRE #02207407

SAGE MIRSKY

office 907.821.1049
sage@mavenproperties.com
DRE #02238781

HALLIE FORMAN

office 415.426.7808
hallie@mavenproperties.com
DRE #02252563

NOTICE: This information has been secured from sources we believe to be reliable but we make no representations, warranties, express or implied, as to the accuracy of the information. Listing broker has been given enough information to provide only a preliminary interest in the property. The materials are not to be considered fact. The information contained herein is not a substitute for thorough due diligence investigation. References to square footage, zoning, use, or age are approximate. Please contact the San Francisco Planning Department to verify zoning at (415) 558-6378, as neither broker or landlord represent that this space is suitable for your use. Tenant or Buyer must verify the information at their own expense and bears all the risk for any inaccuracies. By receiving these materials you are agreeing to the disclaimers set forth herein. DRE#01878802

466 Green Street Suite #203 | San Francisco, CA 94133

415-781-7700 | www.mavenproperties.com