

New Construction Retail Available

Cobb's Corner Across From Village Shoppes

106-123 Sharon St., Stoughton, MA

1,350 SF Next to Jersey Mike's



Highlights

- Space Available Next to Jersey Mike's
- Now Open - Jersey Mike's and Dunkin' Donuts
- Immediately Across From : Shaw's, McDonalds, Five Guys, Marshalls, Dunkin, Starbucks, Mobil, Rockey's Ace Hardware, Chase Bank, and more
- High Visibility
- 27 Surface Parking Spaces
- Public Water Sewer, and Natural Gas On-site
- Heavy Traffic - Washington St: 20,000+ ADT

Cobb's Corner

106-123 Sharon St. | Stoughton, MA



2024 Demographics	2 Miles	3 Miles	5 Miles
Estimated Population	27,610	51,731	118,429
Estimated Households	11,284	20,122	45,289
Estimated Average Household Income	\$150,153	\$155,759	\$154,141

Contact

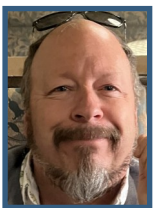

Bobby Burke

508-479-5294

bobby.acreco@gmail.com

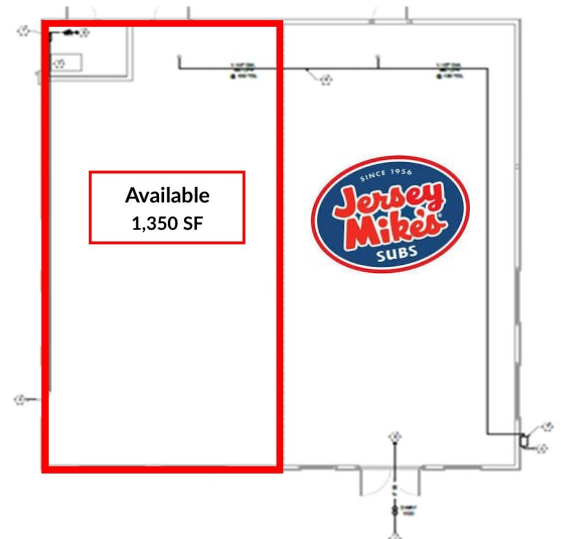

American Commercial Real Estate

50 Ledgeview Way #2415, Wrentham, Massachusetts 02093
 Tel: (508) 735-6378 | E-mail: dusty@acreco.com | www.acreco.com