

FOR LEASE

# SUCCASUNNA RETAIL CENTER

274 ROUTE 10 WEST  
SUCCASUNNA, NJ

NEWMARK  
ASSOCIATES

PRIME  
RETAIL  
SPACE





# PROPERTY OVERVIEW & SPACE DETAILS

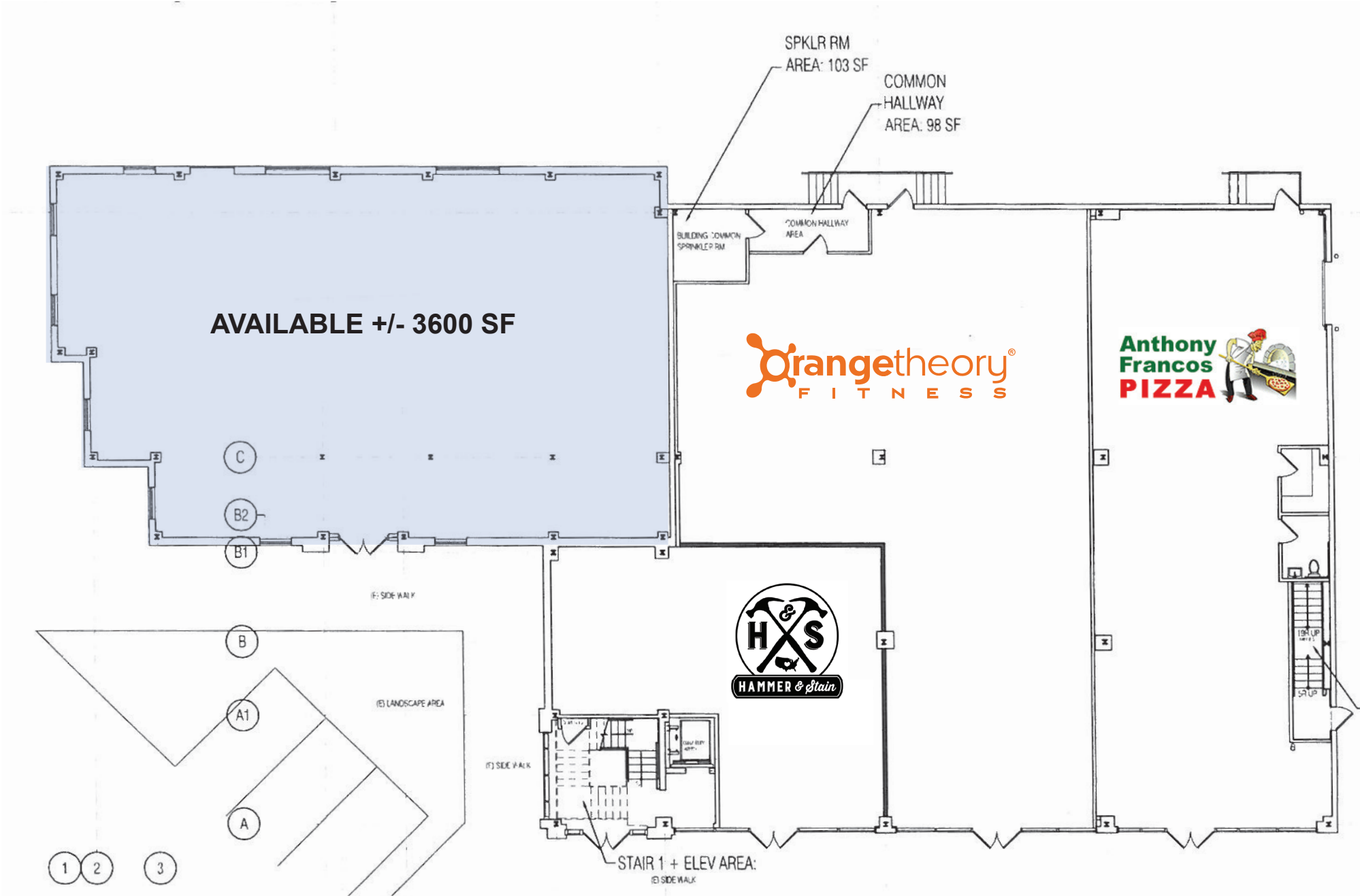

Floor Plan Not Drawn to Scale.

## PROPERTY OVERVIEW

- Approx. 20,000 sf Multi-Tenanted Neighborhood Strip Center
- Located at Signalized Route 10 U-turn at Main St.—  
Over 35,000 cars daily
- Building/Marquee/Monument/Drive-Thru Signage
- Abundant Parking
- Zoning: B-2
- Located within Western Morris County 's Retail Hub at  
Roxbury Mall & Ledgewood Commons
- Close Proximity to Route 46/80/287

## AVAILABLE SPACE

- Approx. 3600 sf; Former Bank
- Shell Space with Existing Infrastructure
- End Cap Unit; Lots of Windows
- 14ft Ceilings; Fully Sprinklered
- Dedicated Parking Spaces at Entrance
- Two (2) Drive-Thru Lanes







MARKET AERIAL



For more information contact:

**HELENE ELBAUM**

C: 201.320.3430

O: 973.884.4444 ext. 26

[helbaum@newmarkrealestate.com](mailto:helbaum@newmarkrealestate.com)

