



MAITLAND CITY CENTRE  
RESIDENCES • SHOPS • OFFICES



# MAITLAND CITY CENTRE



**SERENITY LORENZ**

Senior Leasing Manager

[serenity@acrefl.com](mailto:serenity@acrefl.com)

(904) 887-3302

**SANDI BARGFREDE**

Managing Partner

[sandi@acrefl.com](mailto:sandi@acrefl.com)

(407) 491-8149



**FOLLOW US, WE'RE VERY SOCIAL!**



LICENSED REAL ESTATE BROKER



# MAITLAND CITY CENTRE

Highly visible & prominent new mixed-use center in the Heart of Maitland - one of Central FL's most affluent communities.



## 1,157 SF 2ND GENERATION RESTAURANT SPACE AVAILABLE FOR LEASE

-  • 220 High-End Apartments on Site
- 24 Live-Work Units on Site
-  • More than 2,400 Multi-Family Units within a 5-Min. Walk
- Just a 5-Min Walk to Sunrail Station

With **220 apartment homes, 24 live-work units, and 32,516 SF of retail & restaurant space**, Maitland City Centre is an exclusive community-drive, mixed-use project situated across from City Hall & Independence Park. Maitland City Centre's tenant mix and on-site habitation builds community and provides a true destination for locals and visitors alike - to **work, reside, gather, and dine**.



# LOCATION

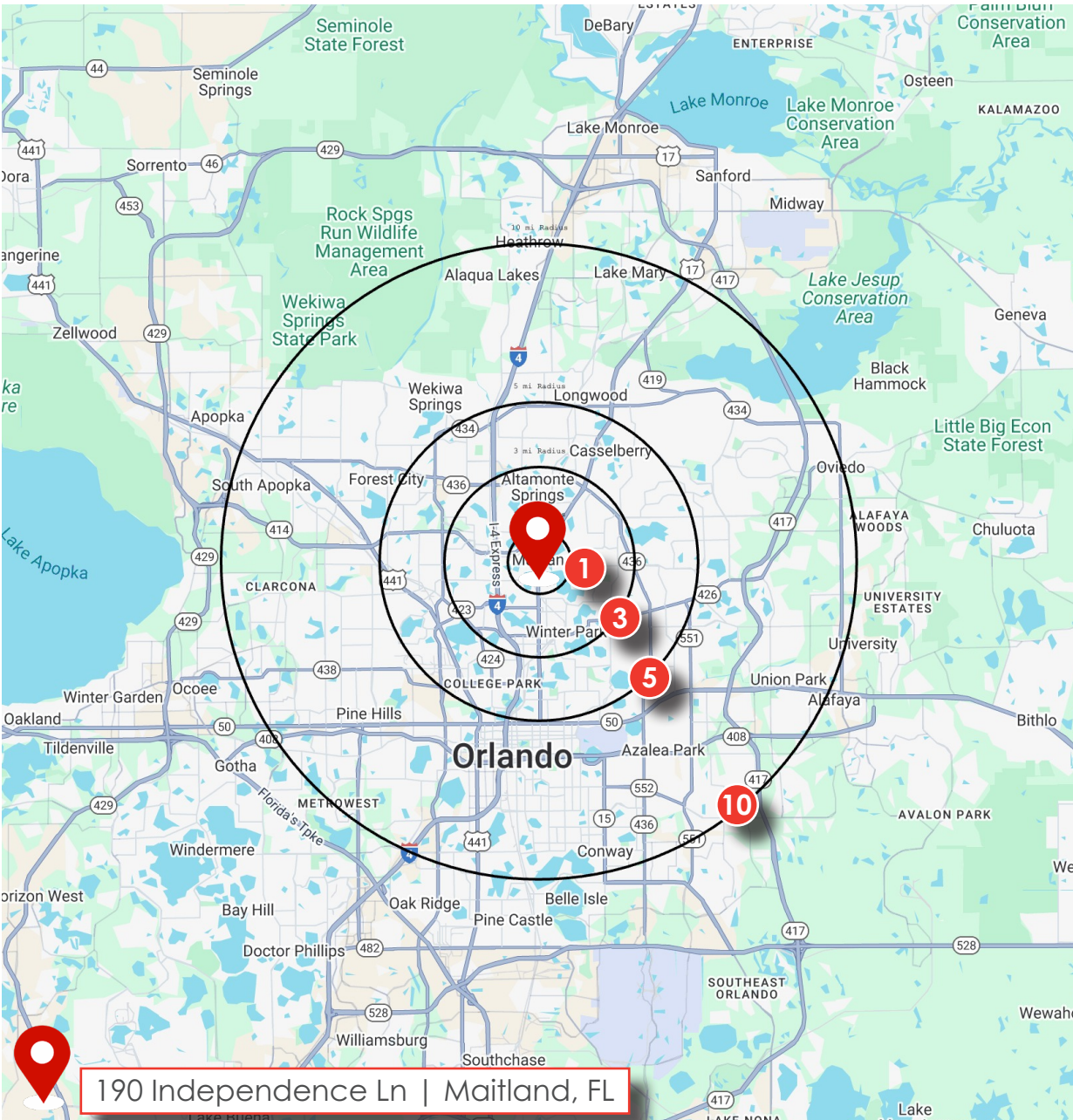

## POPULATION



1 MI	10,005
3 MI	102,489
5 MI	286,453
10 MI	1.01 M

## AVG HH INCOME



1 MI	\$159,953
3 MI	\$122,874
5 MI	\$120,923
10 MI	\$109,314

## MEDIAN AGE



1 MI	42.3
3 MI	39.6
5 MI	38.8
10 MI	37.7

## DAYTIME POPULATION



1 MI	11,863
3 MI	86,335
5 MI	240,120
10 MI	836,850

## BUSINESSES



1 MI	1,511
3 MI	12,845
5 MI	29,723
10 MI	78,908

## EMPLOYEES



1 MI	9,420
3 MI	12,845
5 MI	29,723
10 MI	78,908



# PROJECT PLAN

## ADDRESS

190 Independence Lane  
Maitland, FL 32751

## RETAIL

33,572 SF GLA

## TENANT LINEUP

- Starbucks Coffee
- Cookit Prepared Foods
- Brewlondo
- Houndstooth Sauce Co.
- Boku Sushi & Grill
- Fleet Feet
- F45 Fitness
- Salons by JC
- 100% Chiropractic
- Woof Gang
- Young Chefs Academy
- Turci Pasta
- Kelly's Ice Cream
- Parea Greek Taverna

## PARKING

182 On-Site (5.6/1,000)  
239 Walkable Public Spaces  
585 After-Hours/Valet

## TRAFFIC

Horatio Ave E: 31,500 AADT  
US-17: 47,000 AADT

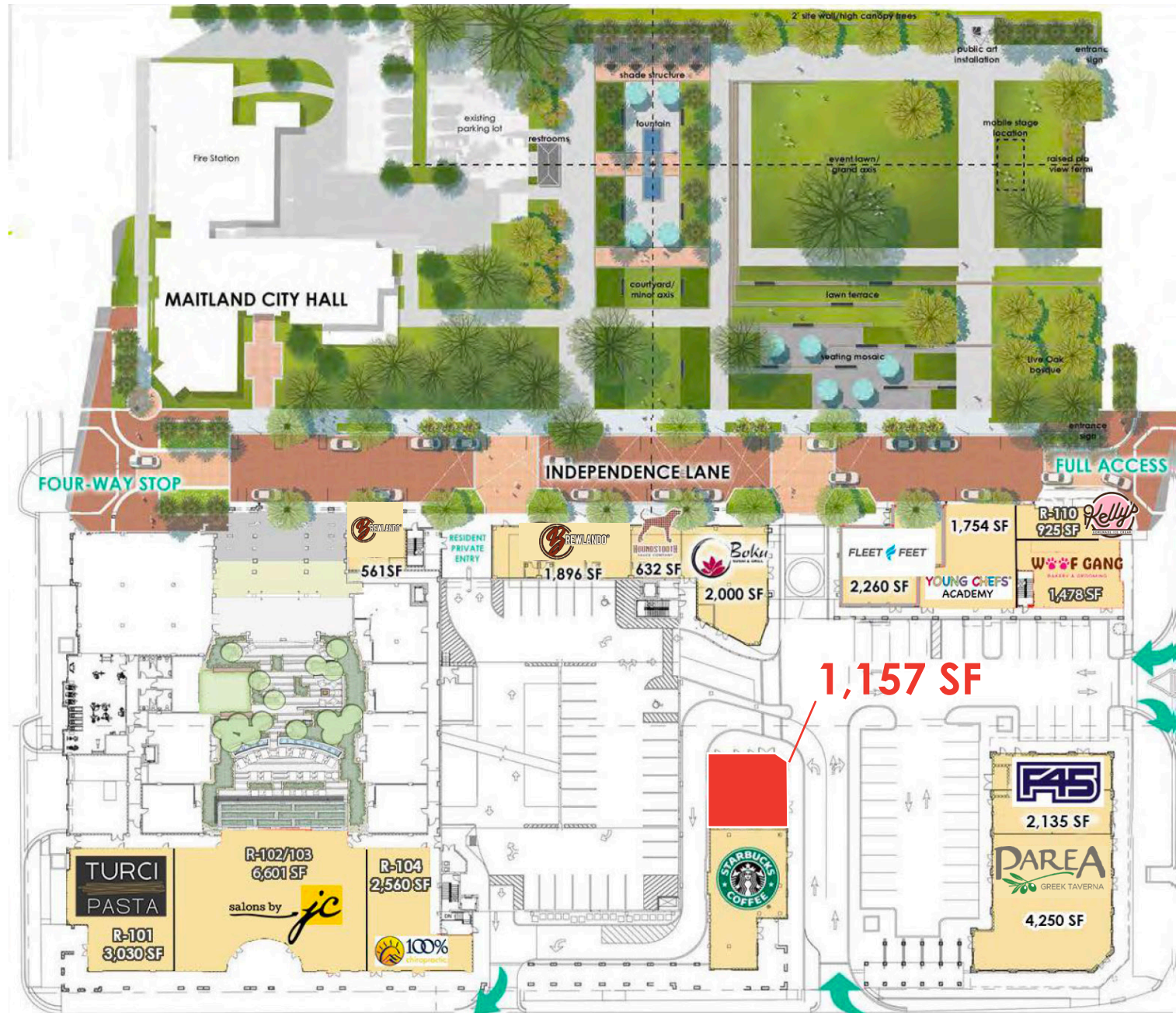



# SITE PLAN





# TENANT LINEUP





# PARKING

Walkable Public Parking	CURRENT PARKING-FUTURE PUBLIC PARK	After-Hours Parking
-------------------------	------------------------------------	---------------------

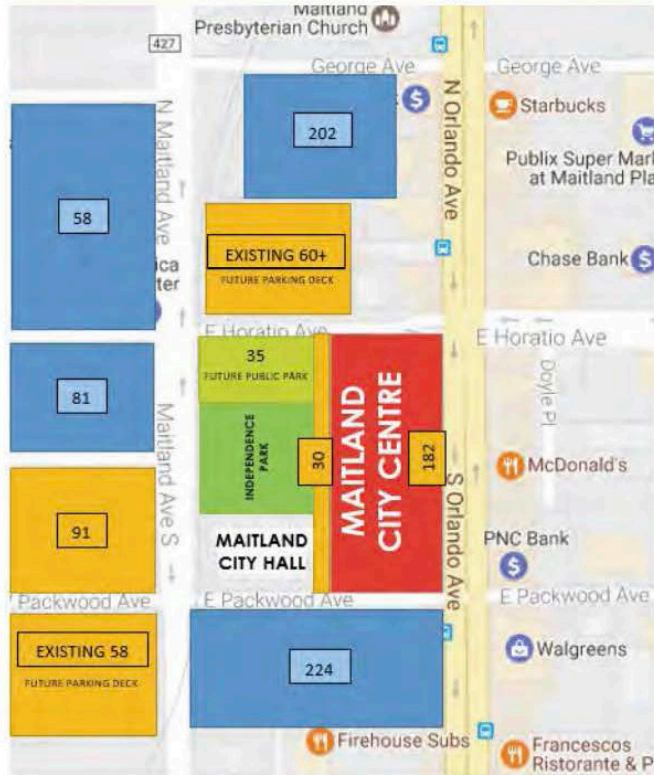

## WALKABLE PUBLIC PARKING

239 Public Daytime + 565 After Hours Spaces

**804 Offsite Public Parking Spaces**

## Commercial Parking Deck Levels

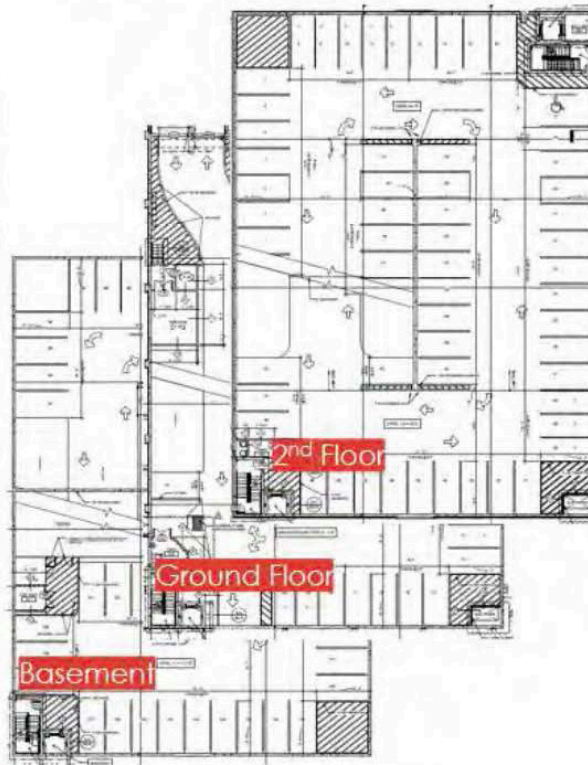

Basement - 52 spaces  
 Ground Floor - 35 spaces  
 2nd Floor - 57 spaces  
 Total: 144 spaces

## Surface Parking



## ON-SITE PARKING

38 Surface Spaces  
 144 Parking Deck Spaces

**182 Onsite Parking Spaces**

(32,516 GLA)  
**5.6/1000 parking ratio**



# RETAIL OVERVIEW

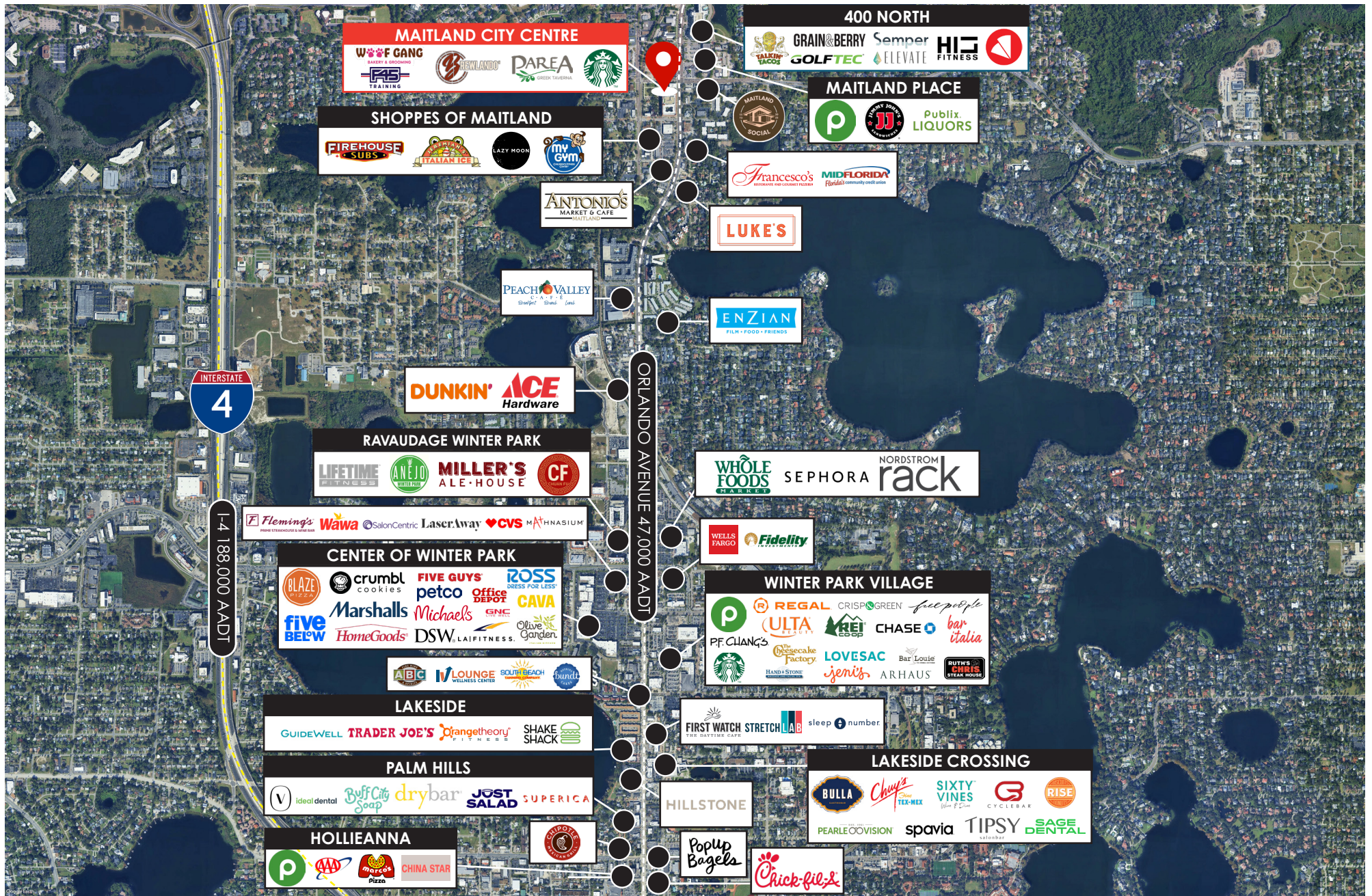



# SURROUNDING RESIDENTIAL

#	PROJECT	UNITS
1	MAITLAND STATION	293
2	UPTOWN MAITLAND	98
3	MAITLAND SQUARE	22
4	400 NORTH	300
5	<b>MAITLAND CITY CENTRE</b>	<b>244</b>
6	THE Q APARTMENTS	130
7	MOORINGS ON LAKE MAITLAND	86
8	LAKE LILY APARTMENTS	450
9	MAITLAND HARBOR	58
10	LAKE MAITLAND TERRACE APTS	240
11	MAITLAND SHORES	200+
12	MAITLAND HOUSE	28
13	GEM LAKE APARTMENTS	247
14	TOWN TRELAGO APARTMENTS	350

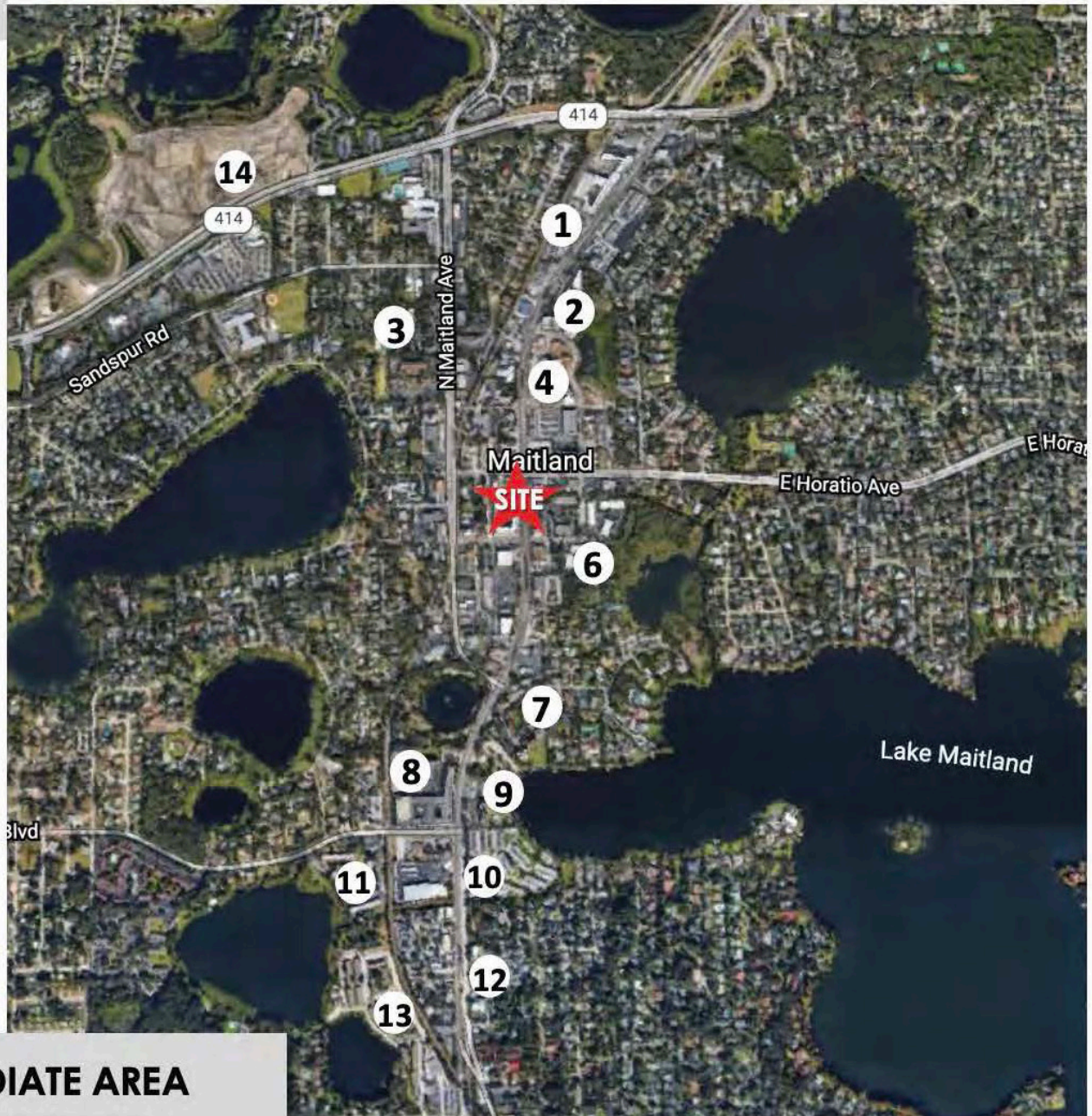

**2,376+ UNITS IN IMMEDIATE AREA**



# DAYTIME POPULATION STUDY

- With **8,351,029 SF** of office space and over 24,000 daytime employees and corporate expense accounts, Maitland Center is Orlando's largest office market outside of Downtown Orlando and tourist areas.
- **Maitland City Centre is the closest retail/restaurant destination for Maitland Center.** Less than three miles from three major daytime population hubs, MCC is centrally located to cater to Winter Park, Maitland and Altamonte's daytime population.
- Local traffic patterns in Altamonte show that **employees from Florida Hospital Altamonte will have an easier time getting to MCC** than to retail and restaurants within the Altamonte market.

- 1 MAITLAND CENTER - 24,000 DAYTIME POP.
- 2 PARK AVENUE - 21,000 DAYTIME POP.
- 3 FLORIDA HOSPITAL ALTAMONTE - 18,000 DAYTIME POP.

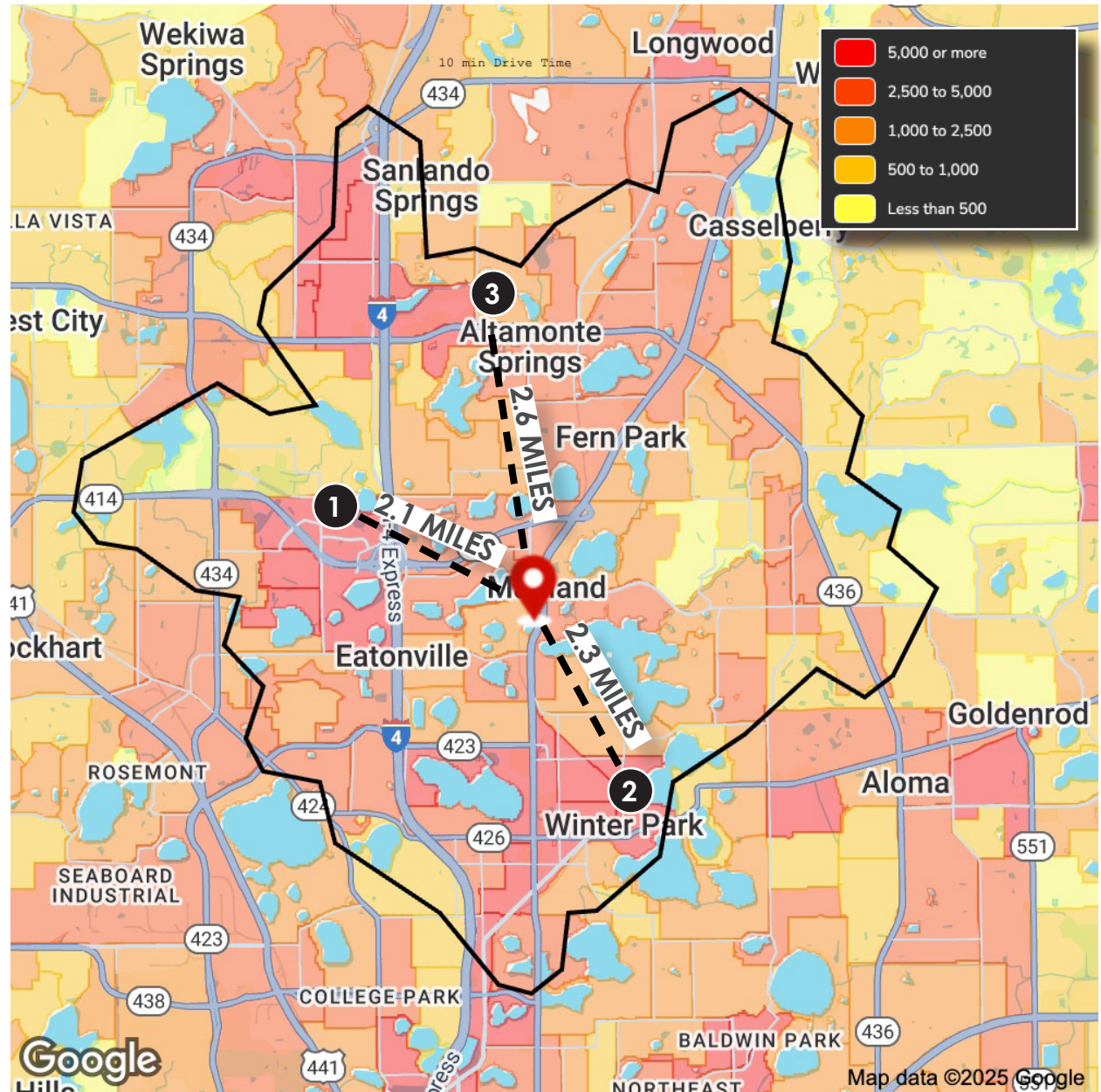





LICENSED REAL ESTATE BROKER

## SERENITY LORENZ

*Senior Leasing Manager*

[serenity@acrefl.com](mailto:serenity@acrefl.com)

(904) 887-3302

## SANDI BARGFREDE

*Managing Partner*

[sandi@acrefl.com](mailto:sandi@acrefl.com)

(407) 491-8149

CEN

This presentation is provided for informational purposes only and does not constitute legal, financial, or investment advice. It is intended solely to provide general information about the properties and services offered by ACRE Commercial, its affiliates, partners, and subsidiaries. All information contained herein is obtained from sources deemed reliable; however, we make no representations or warranties, express or implied, regarding the accuracy, completeness, or reliability of any information provided. Prospective buyers, sellers, landlords, tenants, investors, or other parties should conduct their own due diligence and consult with appropriate professionals (including legal, financial, and real estate advisors) before making any decisions or entering into any agreements. ©2025. All rights reserved.