



# FOR LEASE

## ±2,687 SF FULLY CONDITIONED WAREHOUSE

310 Business Parkway, Suite E  
Greer, SC 29651



LEE & ASSOCIATES  
GREENVILLE/SPARTANBURG

**Jordan Skellie, SIOR**  
EVP/Principal  
864.238.2188  
jskellie@lee-associates.com

**Andrew Harrill, CCIM**  
Senior Vice President  
864.607.7223  
aharrill@lee-associates.com

Interactive PDF



**864.704.1040**  
LeeUpstate.com

### PRICING/RATE:

**\$13.00/SF  
(NNN)**

- Located at Highway 101 Business Park
- ±1.0 Mile from BMW
- ±2,487 SF of Warehouse Space
- ±200 SF Office Space



**DOCK DOORS**  
One (1) 10 x 10



**MAJOR ACCESS**  
Less than ±1.0 miles  
from I-85



**OFFICE**  
Two (2) Private  
Offices and one (1)  
Restroom



**CLEAR HEIGHT**  
15'09" to 17'08"

# PROPERTY OVERVIEW & PHOTOS

PROPERTY NAME	310 Business Pkwy, Suite E
TYPE	Industrial
TOTAL AVAILABLE SF	±2,687 SF
TAX MAP #	5-29-00-169.02
COUNTY	Spartanburg
CITY LIMITS	No
ZONING	Unzoned
YEAR BUILT	2001
WAREHOUSE SF	±2,487 SF
OFFICE SF	±200 SF
CEILING HEIGHT	15'09" to 17'08"
DRIVE-IN DOORS	One (1) 10 x 10
POWER	3 Phase - 208Y/120 Volts
SPECIAL FEATURES	Paved





# LOCATION OVERVIEW

- 1 BMW Manufacturing
- 2 Swift Transportation Greer Terminal
- 3 Old Dominion Freight Line
- 4 Ballews Aluminum Products
- 5 US LUMBER
- 6 Central Transport
- 7 MW Components Greer



Click Here to View  
the Interactive Map

Interactive PDF

201 W. McBee Ave, Suite 400, Greenville, SC 29601  
320 E. Main Street, Suite 430, Spartanburg, SC 29302  
**LeeUpstate.com | 864.704.1040**



# SITE PLAN

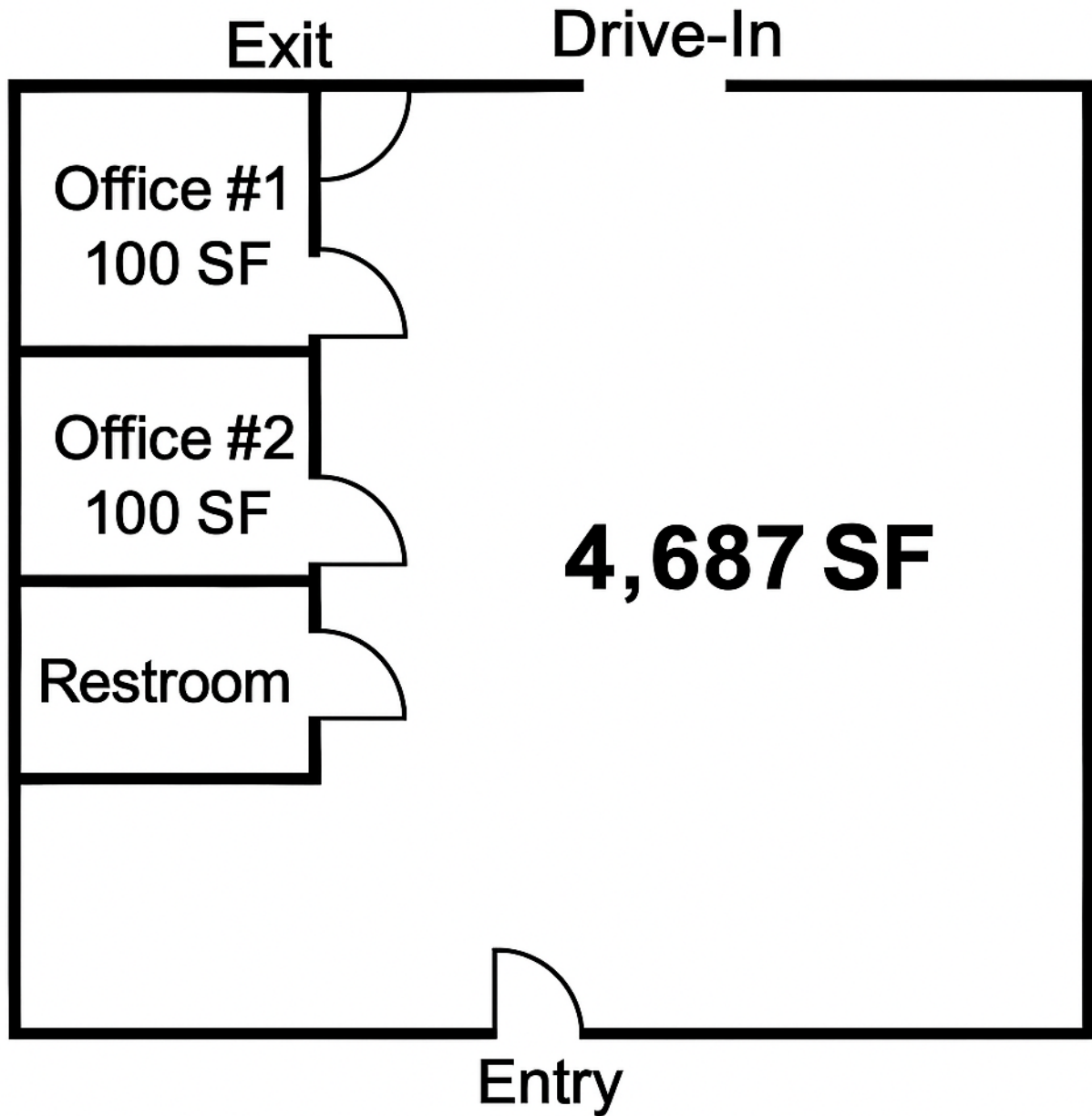





Interactive PDF 

# LEARN MORE CALL TODAY



LEE & ASSOCIATES  
GREENVILLE/SPARTANBURG

**864.704.1040**  
**LeeUpstate.com**

#### **GREENVILLE OFFICE**

201 W. McBee Ave, Suite 400  
Greenville, SC 29601

#### **SPARTANBURG OFFICE**

320 E. Main Street, Suite 430  
Spartanburg, SC 29302

All information furnished regarding the properties and information in this packet is from sources deemed reliable, but no warranty or representation is made to the accuracy thereof and same is submitted to errors, omissions, change of price, rental or other conditions prior to sale, lease or financing or withdrawal without notice. No liability of any kind is to be imposed on the broker herein.



#### **Jordan Skellie, SIOR**

EVP/Principal  
864.238.2188  
jskellie@lee-associates.com



#### **Andrew Harrill, CCIM**

Senior Vice President  
864.607.7223  
aharrill@lee-associates.com