

FOR SALE

**3955 BROADWAY PL
LOS ANGELES, CA 90037**

**±10,200 SF
INDUSTRIAL BUILDING**



For more information, please contact:

Daniel Park

(213) 446-0396

Danielpark777@hotmail.com

DRE# 01227056

PARK INDUSTRIAL
SPECIALIZING IN INDUSTRIAL REAL ESTATE SERVICES

Park Industrial Realty
800 McGarry St, 5th Floor
Los Angeles, CA 90021
Corporation DRE# 01983713

Building SF:	10,200 SF	• Freestanding industrial building just south of Downtown Los Angeles
Land SF:	13,068 SF	
Year Built:	1968	• Close proximity to USC and the LA Memorial Coliseum
Clear Height:	16'	• 400 amps of heavy electrical power suitable for industrial operations
Power:	400a, 240v, 3p, 4w	
Loading:	1 GL	• Secure fenced and gated on-site parking
# Parking:	10	• Ground level loading for easy access and logistics
Zoning:	M1	• Convenient freeway access with nearby on/off ramps
Sale Price:	\$2,400,000 (\$235.29/SF)	

All information has been furnished from sources which we deem reliable, but for which we assume no liability. All measurements are approximate. Broker/Owner do not warrant its accuracy. Buyer/Lessee must verify all information.

5122 | 44
SCALE 1" = 60'

1996

ZOBELEIN'S MAIN
STREET TRACT
M.B. 6-133

ZOBELEIN'S MAIN
STREET TRACT
M.B. 5-162

CODE
6658

FOR PREV. ASSM'T. SEE:
5111-28

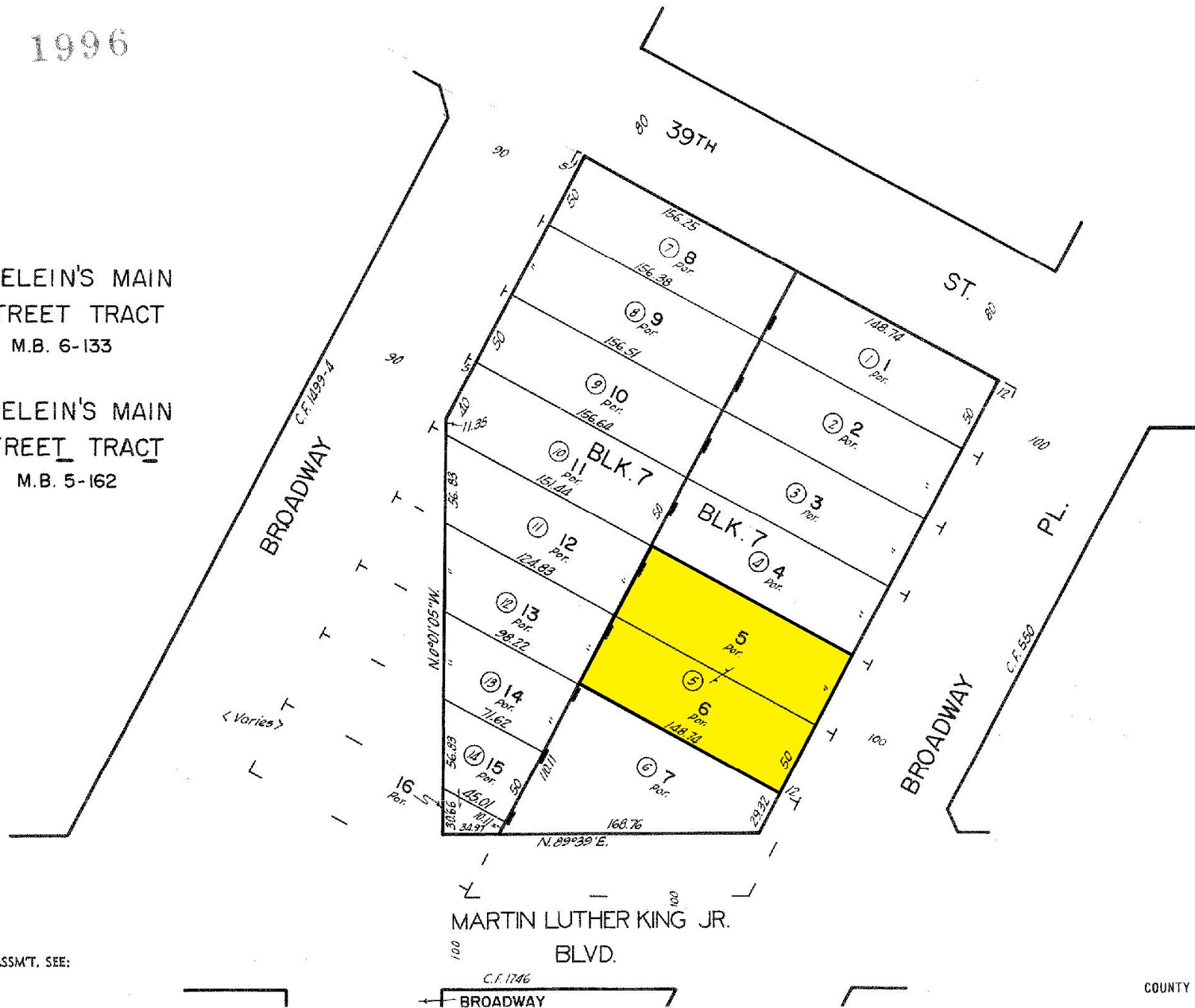

FOR SALE | ±10,200 SF Industrial Building

3955 Broadway Place

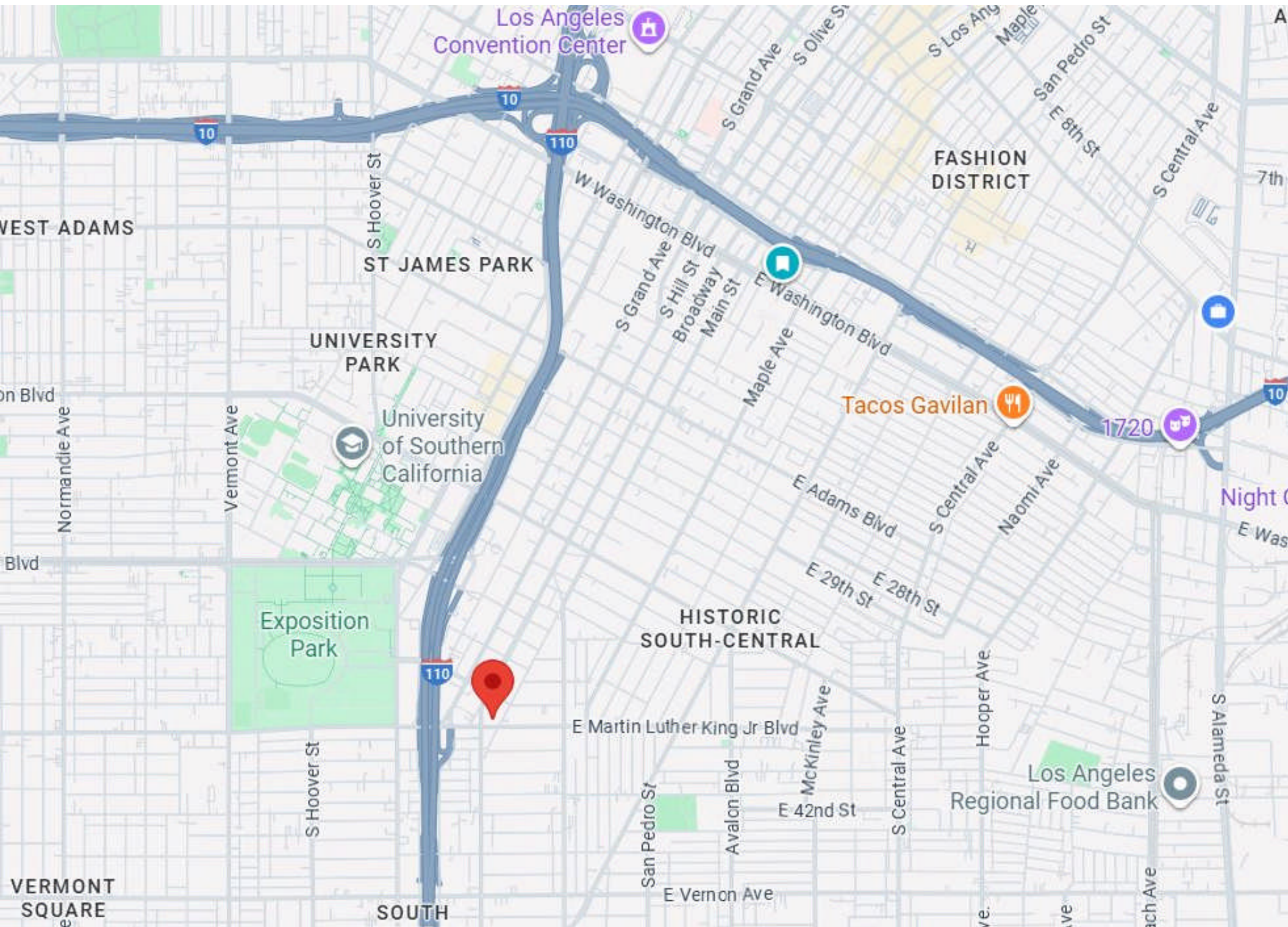

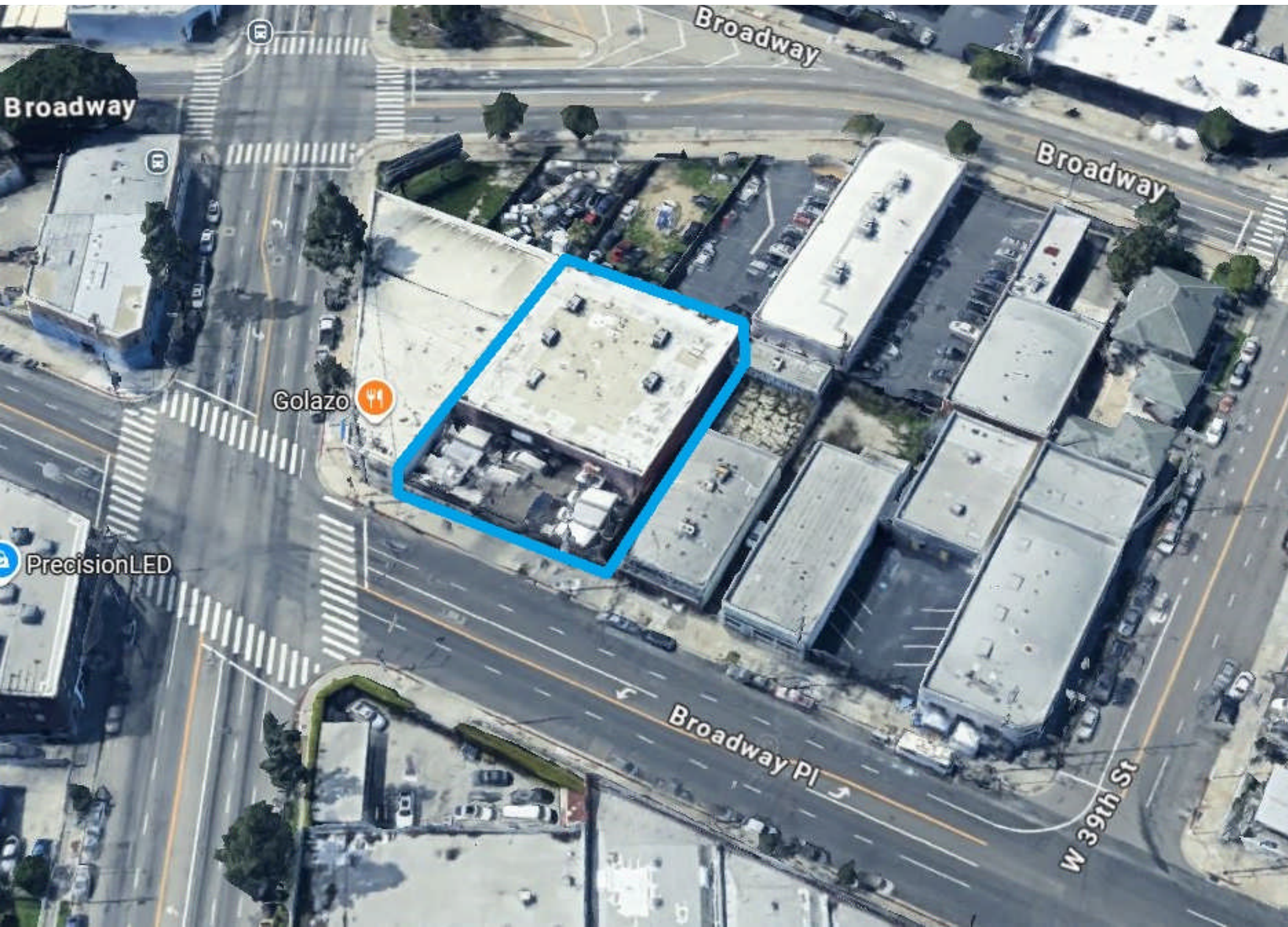

FOR SALE | ±10,200 SF Industrial Building

3955 Broadway Place

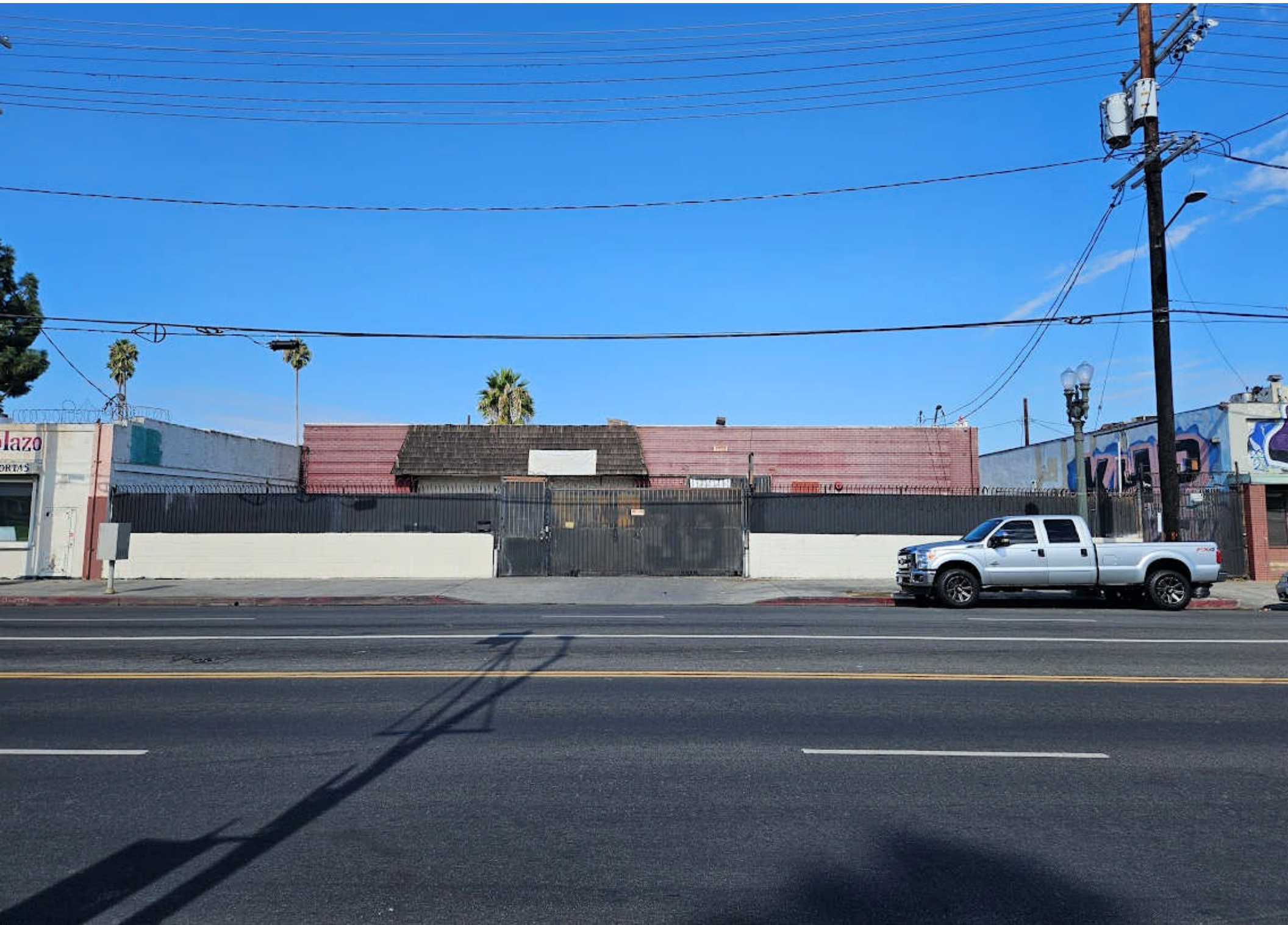

FOR SALE | ±10,200 SF Industrial Building

3955 Broadway Place

