

# Commercial Office Park I & II

4610-4704 West Commercial Drive  
North Little Rock, AR

## CONTACT US

**Justin Bentley, CCIM, SIOR**  
+1 501 850 0739  
[justin.bentley@ar.colliers.com](mailto:justin.bentley@ar.colliers.com)

**Claire Huchingson**  
Property Management  
+1 501 372 6161  
[claire.huchingson@ar.colliers.com](mailto:claire.huchingson@ar.colliers.com)

**Nathan Monan**  
+1 501 850 0710  
[nathan.monan@ar.colliers.com](mailto:nathan.monan@ar.colliers.com)

**Colliers | Arkansas**  
1 Allied Drive | Suite 1500  
Little Rock, AR 72202  
P: +1 501 372 6161

**Colliers**



# Property **features**

## Office Space for Lease

- Lot size: 1.22 acres
- Building size: 10,187 SF
- Lease rate: \$16.50/SF, NNN
- Estimated NNN: \$1.16/SF
- LED: October 2032
- Ample parking available
- Commercial Office Park signage available with West Commercial Drive frontage
- Turn key therapy or daycare facility
- Eight ADA compliant restrooms
- Located near popular retail corridor
- Easy access to Interstate 57
- Traffic count: approximately 1,200 vehicles per day on West Commercial Drive and 18,000 vehicles per day along Warden Road



## Area Demographics



### Estimated Population (2025)

1 Mile	3 Mile	5 Mile
8,175	77,757	138,208



### Estimated Households (2025)

1 Mile	3 Mile	5 Mile
3,796	36,021	61,970



### Est. Avg Household Income (2025)

1 Mile	3 Mile	5 Mile
\$78,820	\$108,519	\$114,040

## CONTACT US

**Justin Bentley, CCIM, SIOR**  
+1 501 850 0739  
justin.bentley@ar.colliers.com

**Nathan Monan**  
+1 501 850 0710  
nathan.monan@ar.colliers.com

**Claire Huchingson**  
Property Management  
+1 501 372 6161  
claire.huchingson@ar.colliers.com

**Colliers | Arkansas**  
1 Allied Drive, Suite 1500  
Little Rock, AR 72202  
P: +1 501 372 6161  
F: +1 501 372 0671

# Property photos



4610 W COMMERCIAL DRIVE, STE. A-D  
NORTH LITTLE ROCK, AR 72116

10,000 SQFT

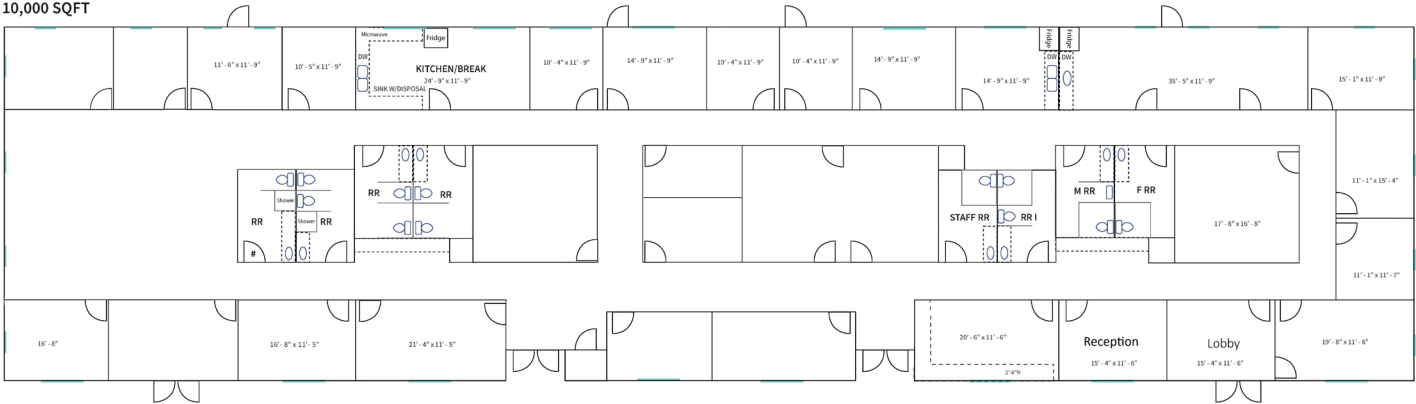



# Property map







# Commercial Office Park I & II

4610-4704 WEST COMMERCIAL DRIVE  
NORTH LITTLE ROCK, AR

## Contact us:

**Justin Bentley, CCIM, SIOR**  
+1 501 850 0739  
[justin.bentley@ar.colliers.com](mailto:justin.bentley@ar.colliers.com)

**Nathan Monan**  
+1 501 850 0710  
[nathan.monan@ar.colliers.com](mailto:nathan.monan@ar.colliers.com)

**Claire Huchingson**  
Property Management  
+1 501 372 6161  
[claire.huchingson@ar.colliers.com](mailto:claire.huchingson@ar.colliers.com)

This document has been prepared by Colliers International for advertising and general information only. Colliers International makes no guarantees, representations or warranties of any kind, expressed or implied, regarding the information including, but not limited to, warranties of content, accuracy and reliability. Any interested party should undertake their own inquiries as to the accuracy of the information. Colliers International excludes unequivocally all inferred or implied terms, conditions and warranties arising out of this document and excludes all liability for loss and damages arising there from. This publication is the copyrighted property of Colliers International and/or its licensor(s). ©2021. All rights reserved.

**Colliers | Arkansas**  
1 Allied Drive | Suite 1500  
Little Rock, AR 72202  
P: +1 501 372 6161

