



For Lease | 2,029 SF Retail / Office / Medical Suite

Victoria Gardens Lane Pad Building

12499 Victoria Gardens Lane | Rancho Cucamonga, CA 91739

Property Highlights

- Outparcel to Victoria Gardens (16M Shopper Visits Annually)
- Visibility from 1-15 Off-Ramp; I-15 has 179,000 CPD
- 3-Mile Radius: 110K Pop. & Avg. HH Income of \$115K
- Tenant is allowed advertising access to proprietary Victoria Gardens media
- 2,029 SF Suite available immediately (Formerly Home101)
- Freeway adjacent end cap, highly visible signage



OAKS
COMMERCIAL
REAL ESTATE

Fred G. Encinas, Broker Lic. # 00582260
909 609 4675
fred@oakscre.com

Cathleen Rose Lic. #00655838
909 636 9999
cathleen@roseretail.com

Site Plan

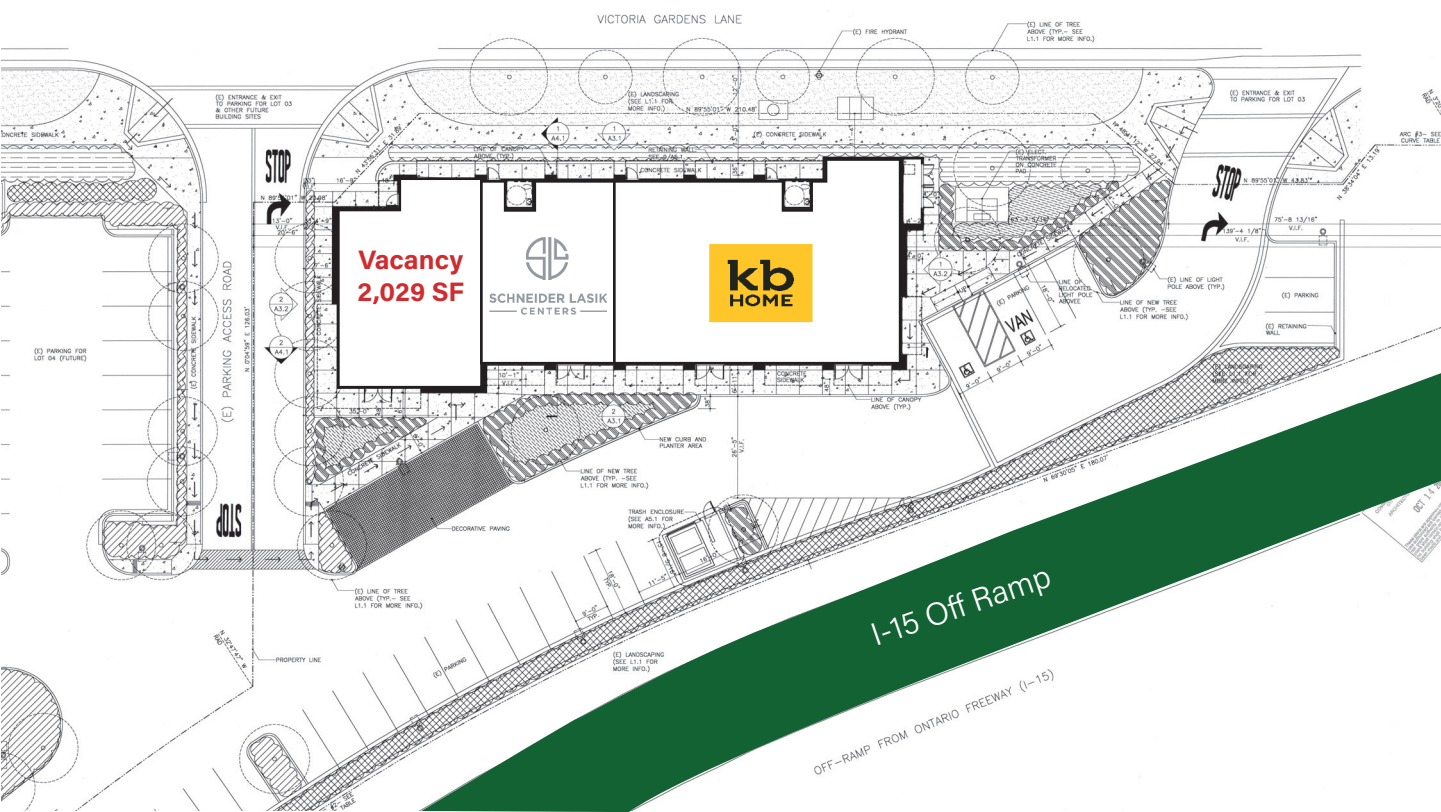

Location

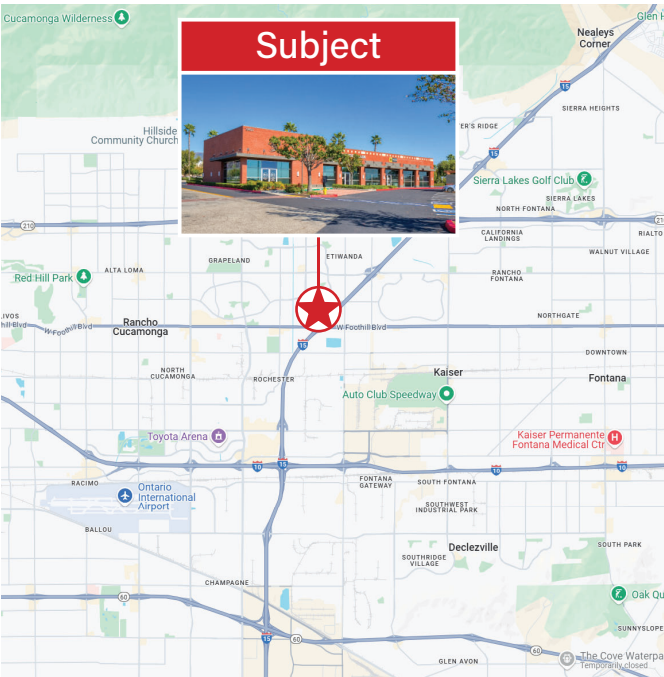

Information herein has been obtained from sources deemed reliable, however its accuracy cannot be guaranteed. The user is required to conduct their own due diligence and verification. Copyright © 2025.

Tenant Roster

Suite	Tenant	Size
101	VACANT	2,029
102	Schneider Lasik Center	1,500
103	KB Home Design Studio	4,105

Traffic Counts

1-15 Freeway at Foothill	203,000 CPD
Foothill Blvd at I-15 Fwy	63,059 CPD

Demographics

	1 Mile	2 Miles	3 Miles
Total Population	15,020	59,208	107,869
Average HH Income	\$134,722	\$128,543	\$122,648
Median Age	35.5	36.5	36.6



OAKS
COMMERCIAL
REAL ESTATE

Fred G. Encinas, Broker Lic. # 00582260
909 609 4675
fred@oakscre.com

Cathleen Rose Lic. #00655838
909 636 9999
cathleen@roseretail.com

VICTORIA GARDENS

(More Than 16 Million Visitors Annually)

Subject

Victoria Gardens Ln

I-15 Off-Ramp

INTERSTATE
CALIFORNIA
15

Pacific Electric Trail

Baseline Rd

Day Creek Blvd

Foothill Blvd

Subject



OAKS
COMMERCIAL
REAL ESTATE

Fred G. Encinas, Broker Lic. # 00582260
909 609 4675
fred@oakscre.com

Cathleen Rose Lic. #00655838
909 636 9999
cathleen@roseretail.com