



 **JLL** SEE A BRIGHTER WAY

For sublease

2nd generation retail space available in The District at Prairie Trail in Ankeny, Iowa

Furniture not included.

Availability: 2,179 RSF

Lease rate: \$20.00/RSF NNN

1631 SW Main Street | Suite 104
Ankeny, Iowa 50023

Property overview

Available space: Suite 104 | 2,179 RSF

Lease rate: \$20.00/RSF NNN

Est. OPEX: \$13.11/RSF

- Positioned at the center of it all, The District is home to retail boutiques, dining and entertainment venues, civic uses, and more.
- Prairie Trail a 1,031-acre planned community built on the tradition of Iowa's greatest neighborhoods in Ankeny, Iowa.
- Ankeny, Iowa is the 10th fastest growing city in the United States by U.S. Census Bureau

Contact broker for
additional information

jll.com/des-moines

Meredith Young
Vice President
meredith.young@jll.com
+1 515 419 2963

Marcus R. Pitts, CCIM, SIOR
Senior Managing Director
marcus.pitts@jll.com
+1 515 556 4727

Property photos



Floor plan

**For marketing purposes only.*

Availability:

- Suite 104 - 2,179 RSF (sublease)

Lease rate: \$20.00/RSF NNN

Est. OPEX: \$13.11/RSF

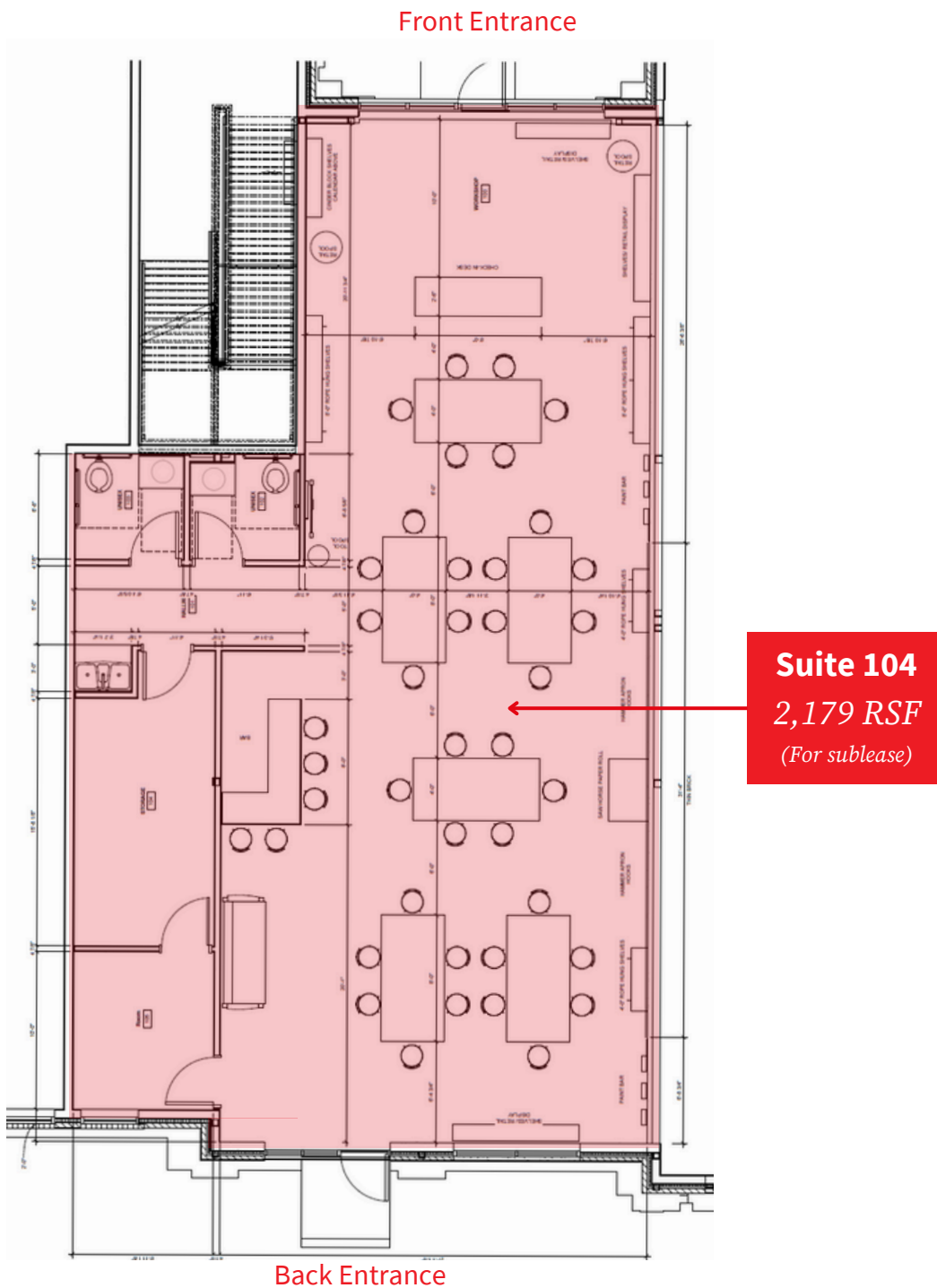

For sublease

1631 SW Main Street - Suite 104 | Ankeny, Iowa 50023



Prairie Trail is a 1,031-acre urbanism community located in the heart of Ankeny, Iowa. Featuring single-and-multi-family residences, numerous retail boutiques, restaurants, entertainment venues, office users and 200+ acres of public parks, trails and open green spaces.

**Contact broker for
additional information**

jll.com/des-moines

Meredith Young

Vice President
meredith.young@jll.com
+1 515 419 2963

Marcus R. Pitts, CCIM, SIOR

Senior Managing Director
marcus.pitts@jll.com
+1 515 556 4727