

LANDMARK CENTER

400 SUNRISE ROSEVILLE
CALIFORNIA



CHRIS SCHWARZE
+1 916 288 4803
chris.schwarze@cushwake.com
LIC #01291261



400 Capitol Mall, Suite 1800
Sacramento, California 95814
main +1 916 288 4800
cushmanwakefield.com

LANDMARK CENTER

400 SUNRISE ROSEVILLE
CALIFORNIA



LEASE RATE:

\$2.15 psf Fully Serviced



LOCATION:

Directly off Hwy 80 with a signalized vehicle entrance to the property.



PARKING:

4.0/1,000 SF



SIGNAGE:

Multiple signage options available



AMENITIES:

Convenient distance to numerous restaurants, shopping, hotels and medical offices.



TENANT IMPROVEMENTS:

Built to Suit (subject to mutually agreeable plan)



OWNERSHIP:

Strong, local ownership

CHRIS SCHWARZE

+1 916 288 4803
chris.schwarze@cushwake.com
LIC #01291261



400 Capitol Mall, Suite 1800
Sacramento, California 95814
main +1 916 288 4800
cushmanwakefield.com

LANDMARK CENTER

400 SUNRISE ROSEVILLE
CALIFORNIA

FIRST FLOOR | ±4,651 RSF

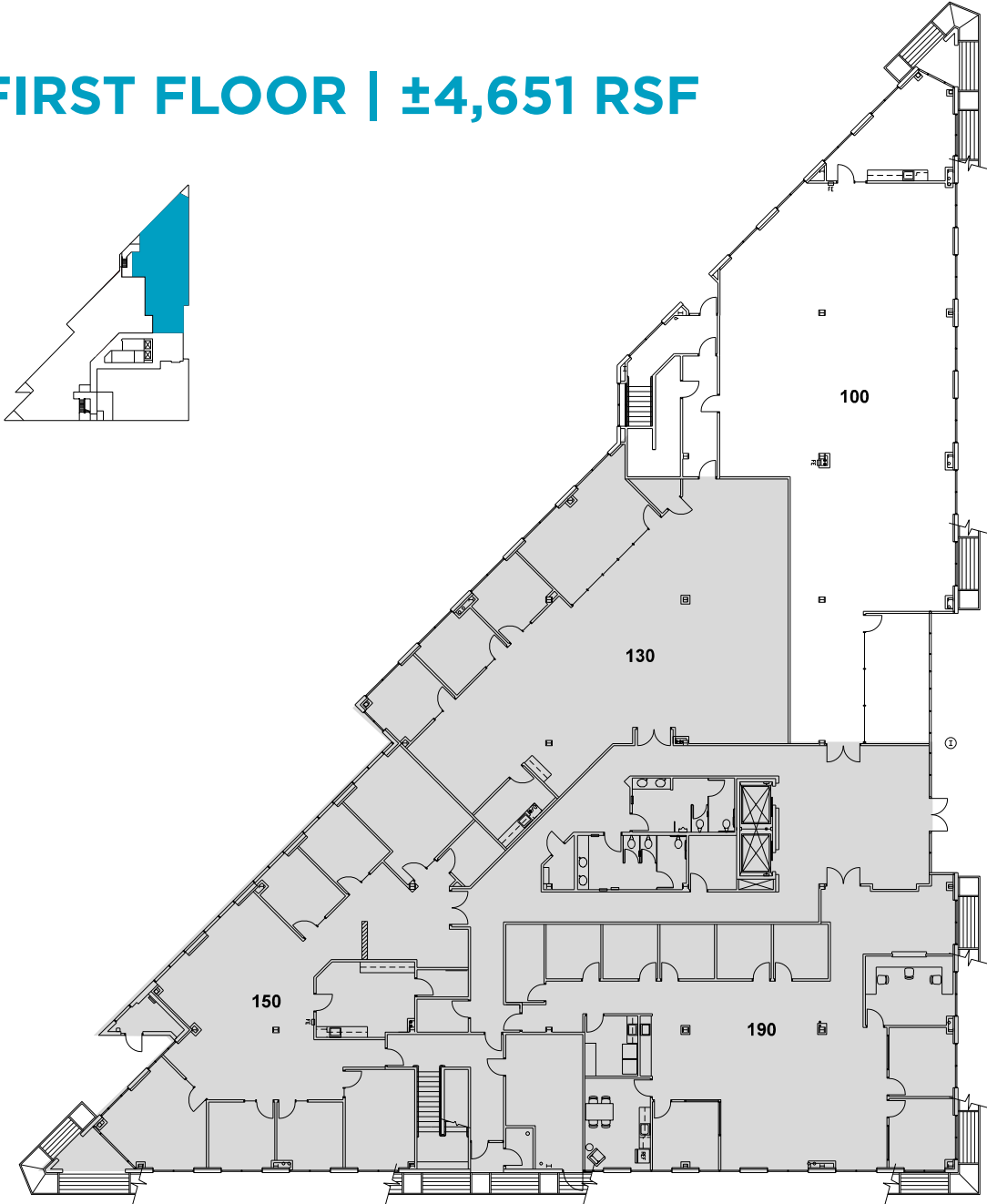

CHRIS SCHWARZE
+1 916 288 4803
chris.schwarze@cushmanwakefield.com
LIC #01291261



400 Capitol Mall, Suite 1800
Sacramento, California 95814
main +1 916 288 4800
cushmanwakefield.com

LANDMARK CENTER

400 SUNRISE ROSEVILLE
CALIFORNIA

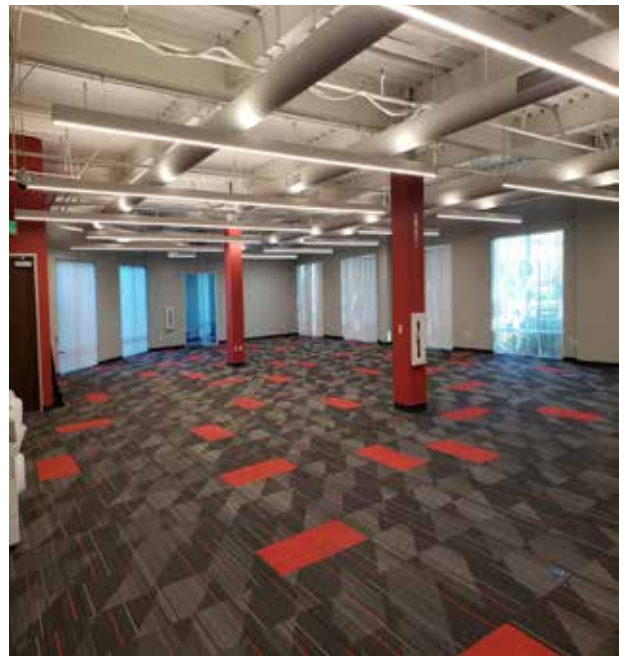

CHRIS SCHWARZE
+1 916 288 4803
chris.schwarze@cushwake.com
LIC #01291261



400 Capitol Mall, Suite 1800
Sacramento, California 95814
main +1 916 288 4800
cushmanwakefield.com

LANDMARK CENTER

400 SUNRISE ROSEVILLE
CALIFORNIA

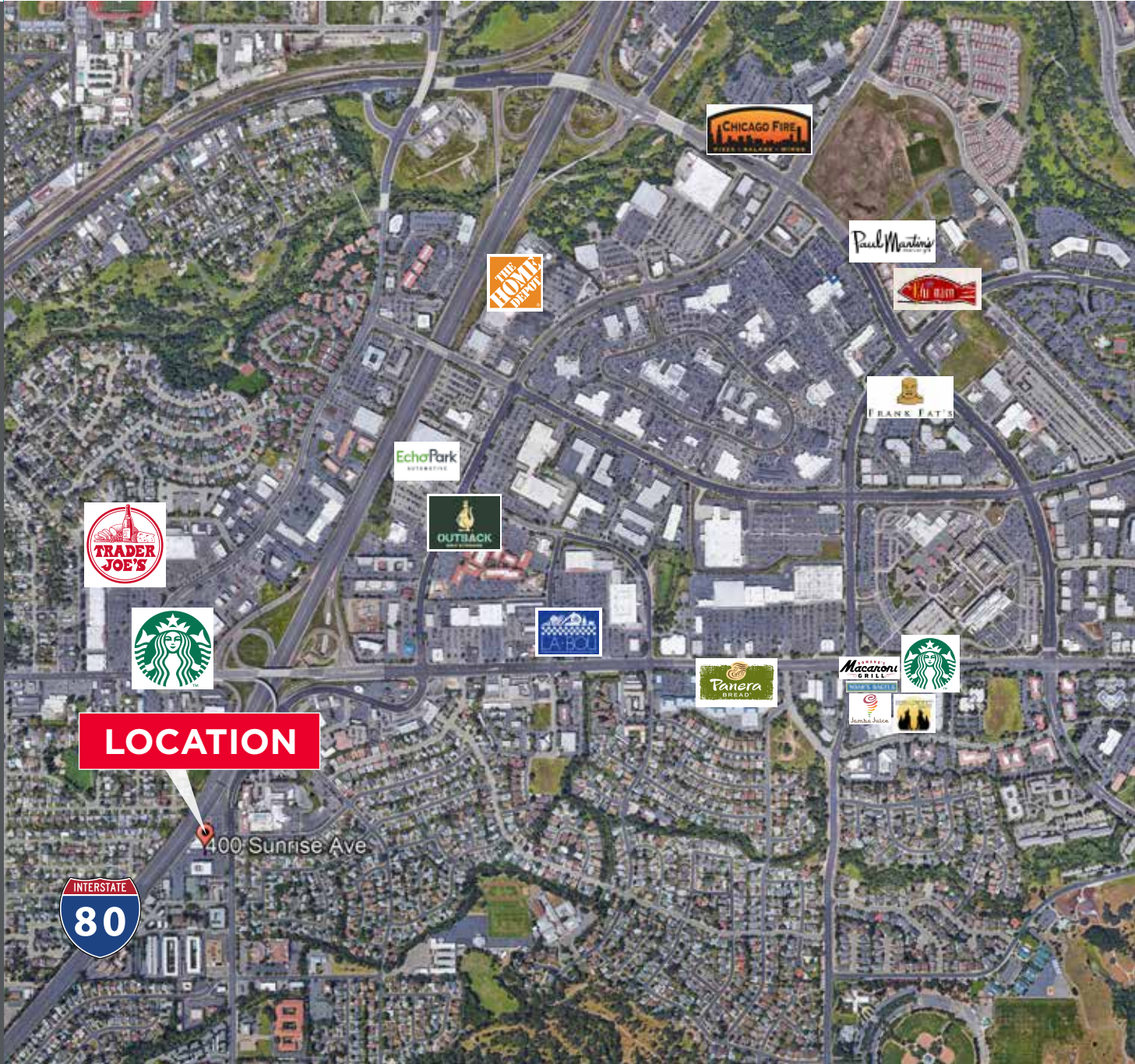

CHRIS SCHWARZE
+1 916 288 4803
chris.schwarze@cushwake.com
LIC #01291261

CUSHMAN & WAKEFIELD
400 Capitol Mall, Suite 1800
Sacramento, California 95814
main +1 916 288 4800
cushmanwakefield.com

[View Site Specific COVID-19 Prevention Plan](#)

Cushman & Wakefield Copyright 2015. No warranty or representation, express or implied, is made to the accuracy or completeness of the information contained herein, and same is submitted subject to errors, omissions, change of price, rental or other conditions, withdrawal without notice, and to any special listing conditions imposed by the property owner(s). As applicable, we make no representation as to the condition of the property (or properties) in question.