

1324-1346 RANKIN STREET  
TROY, MICHIGAN

INDUSTRIAL FOR SUBLEASE  
22,400 Square Feet Available



**SIGNATURE  
ASSOCIATES**  
KNOW SIGNATURE | KNOW RESULTS

## TROY INDUSTRIAL PARK



### PROPERTY FEATURES

- 22,400 square foot warehouse available
- 18' clear height
- Short-term warehouse space with (2) truckwells and (3) 12x14 grade level doors
- Zoned light industrial
- 240 volts, possible 480 volts power
- Heavy parking
- Lease Rate: \$6.00/sq.ft. Gross

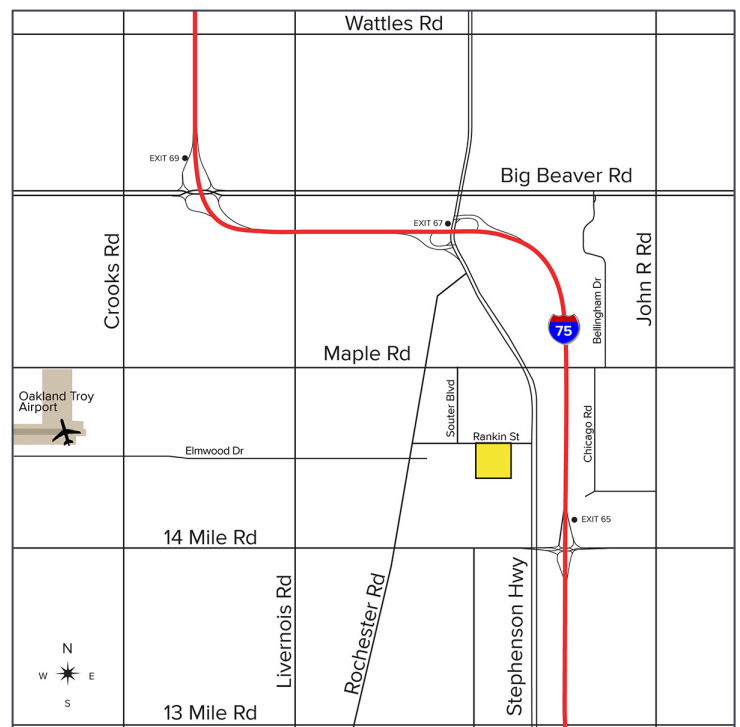

For more information, please contact:

**KRIS PAWLOWSKI**  
(248) 359 3801  
kpawlowski@signatureassociates.com

**SIGNATURE ASSOCIATES**  
One Towne Square, Suite 1200  
Southfield, MI 48076  
www.signatureassociates.com

Information is subject to verification and no liability for errors or omissions is assumed. Price is subject to change and listing withdrawal.

# 1324-1346 Rankin Street - Troy, Michigan

## Industrial For Sublease

22,400  
Square Feet  
AVAILABLE

### Interior Photo



For more information, please contact:

**KRIS PAWLOWSKI**  
(248) 359 3801  
[kpawlowski@signatureassociates.com](mailto:kpawlowski@signatureassociates.com)

**SIGNATURE ASSOCIATES**  
One Towne Square, Suite 1200  
Southfield, MI 48076  
[www.signatureassociates.com](http://www.signatureassociates.com)

Information is subject to verification and no liability for errors or omissions is assumed. Price is subject to change and listing withdrawal.

# 1324-1346 Rankin Street - Troy, Michigan

## Industrial For Sublease

22,400  
Square Feet  
AVAILABLE

### Site Plan

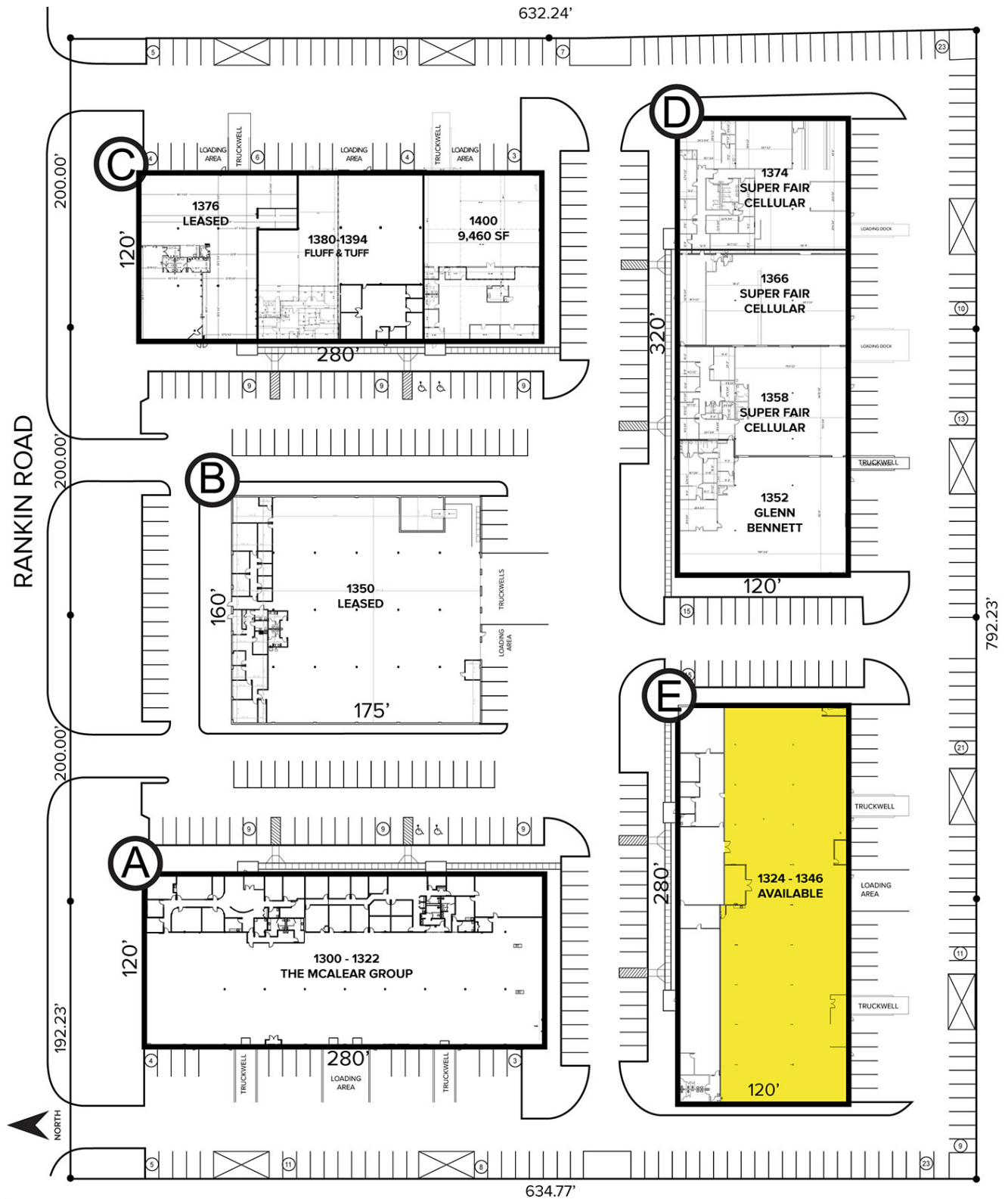

For more information, please contact:

**KRIS PAWLOWSKI**  
(248) 359 3801  
kpawlowski@signatureassociates.com

**SIGNATURE ASSOCIATES**  
One Towne Square, Suite 1200  
Southfield, MI 48076  
www.signatureassociates.com

# 1324-1346 Rankin Street - Troy, Michigan

## Industrial For Sublease

22,400  
Square Feet  
AVAILABLE

### Floor Plan

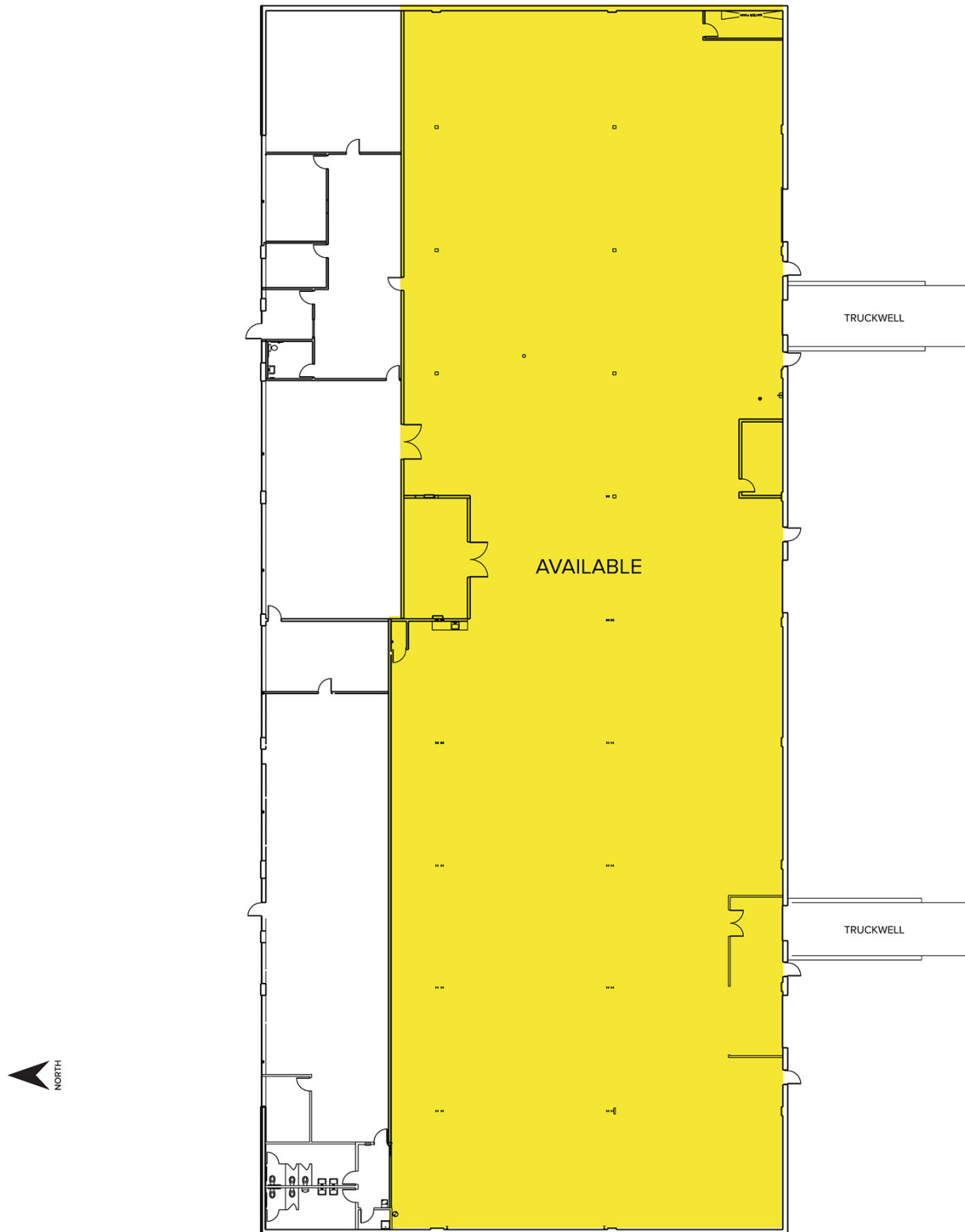

For more information, please contact:

**KRIS PAWLOWSKI**  
(248) 359 3801  
kpawlowski@signatureassociates.com

**SIGNATURE ASSOCIATES**  
One Towne Square, Suite 1200  
Southfield, MI 48076  
www.signatureassociates.com

Information is subject to verification and no liability for errors or omissions is assumed. Price is subject to change and listing withdrawal.

# 1324-1346 Rankin Street - Troy, Michigan

## Industrial For Sublease

22,400  
Square Feet  
AVAILABLE

Aerial



For more information, please contact:

**KRIS PAWLOWSKI**  
(248) 359 3801  
kpawlowski@signatureassociates.com

**SIGNATURE ASSOCIATES**  
One Towne Square, Suite 1200  
Southfield, MI 48076  
www.signatureassociates.com

Information is subject to verification and no liability for errors or omissions is assumed. Price is subject to change and listing withdrawal.