

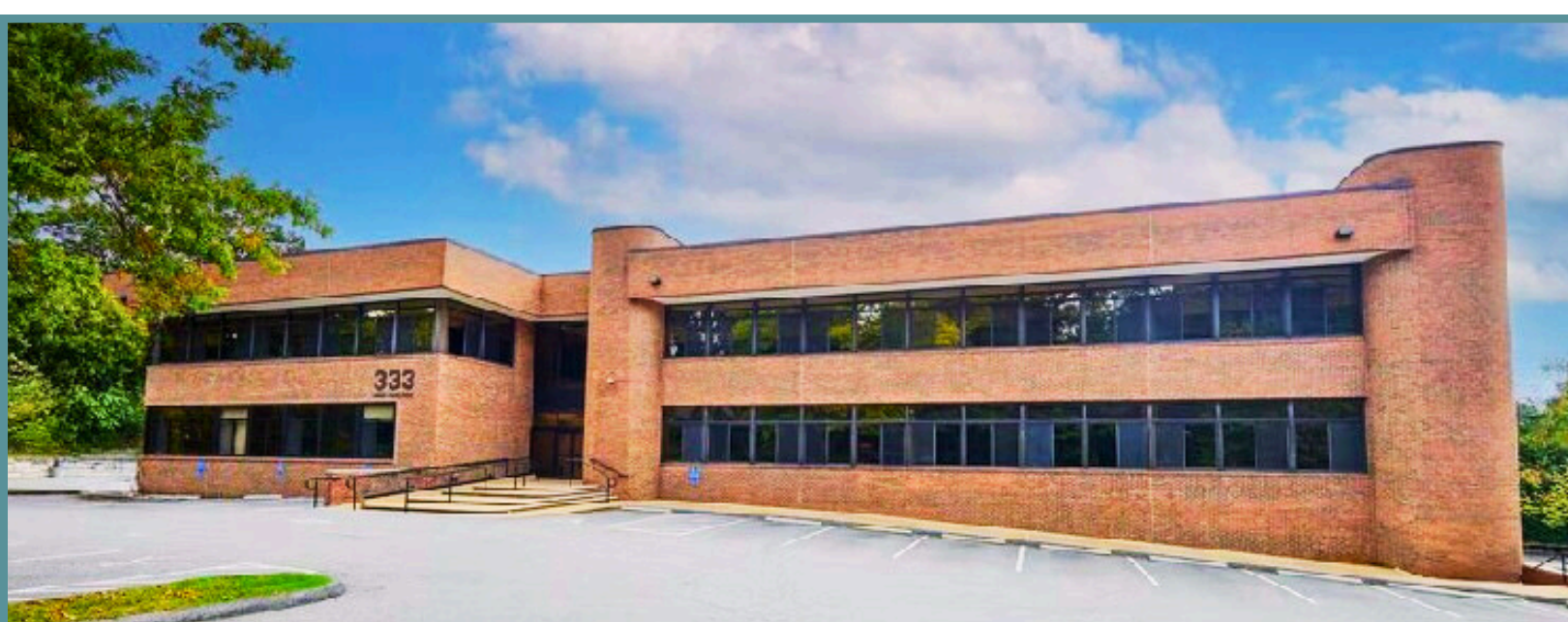

# 333 Post Road West

## WESTPORT CONNECTICUT



### PREMIER MEDICAL ARTS BUILDING

- Tremendous Signage/Branding Opportunity
- 200 Linear Frontage on Post Road/Route 1
- Gracious Entrance with Large Accessible Ramp
- Blood Draw and X-ray available onsite
- Ample Parking
- On US1 with easy access to I-951, The Merritt Parkway, Metro-North and Ct Transit
- Close proximity to downtown Westport

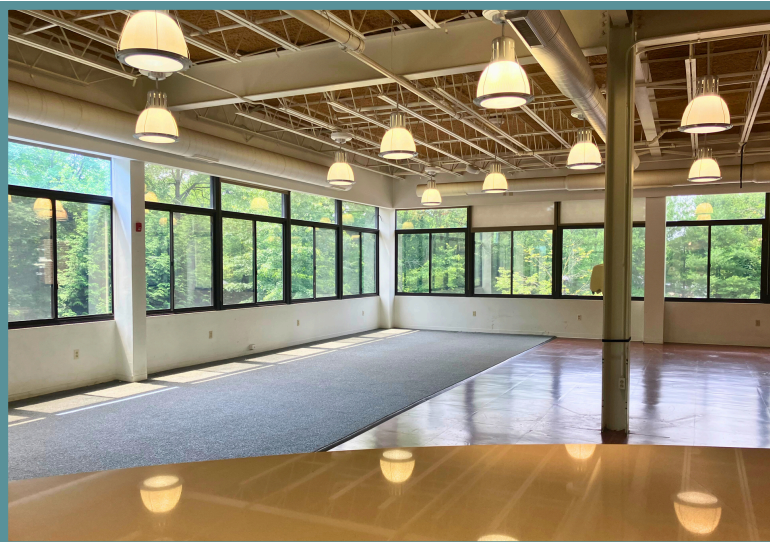

### MEDICAL OFFICE FOR LEASE

4,768 SF

- Open Floor Plan with High Ceilings
- Built to Suit
- Ground Floor Suite Off the Lobby
- Continuous Large Windows
- Heated Walkways
- Excellent Building Maintenance
- Men and Woman's Lockers Showers/Restrooms
- State of the Art ADA Accomodations

[SCohen@GothamRealtyNYC.com](mailto:SCohen@GothamRealtyNYC.com) 203-984-0387



# 333 Post Road West

## WESTPORT CONNECTICUT

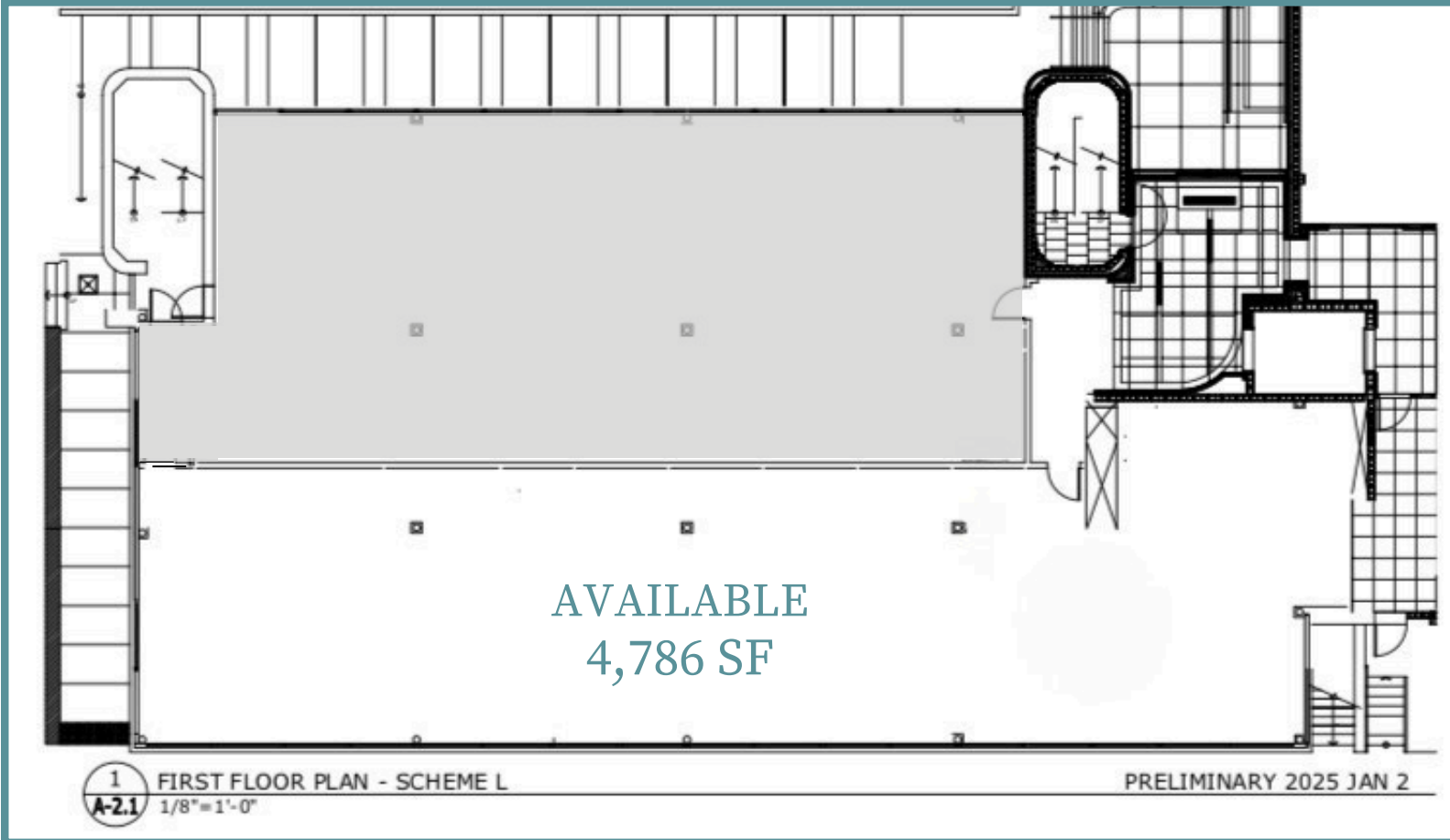

### DEMOGRAPHIC INFORMATION WESTPORT CONNECTICUT

- Current population: 27,470
- 98% of residence have health insurance
- 76% of population has BA degree or higher
- Average home value \$1.325 million, 300% higher than state average
- Median household income \$242,868
- Westport has invested \$44 million in capital projects in the past 4 years
- CT #1 college preparatory public school
- CT #3 district for athletics

<https://www.westportct.gov/government/state-federal-government/census-2020>

