



2525 S Wabash Avenue Chicago, IL

***For Sale or Lease
15,000 SF Available Immediately***

Colin Green, SIOR

Senior Vice President
+1 312 334 7202
colin.s.green@cbre.com

John Marks

Senior Associate
+1 312 334 7204
john.marks@cbre.com

Larry Goldwasser, SIOR

Executive Vice President
+1 312 334 7201
larry.goldwasser@cbre.com

Property Features

Total Building Size	15,000 SF
Site Size	16,553 SF
Office SF	±2,500 SF
Ceiling Height	12' - 13' clear
Loading	3 drive in doors
Car Parking	6 - 8 cars
Zoning	M1 - 3
Ward/Alderman	3rd - Alderman Pat Dowell
2024 Taxes	±3.07/PSF (estimate)
Asking Lease Rate	Subject to offer
Asking Sale Price	\$1,950,000

Highlights

- 1 block to Michigan Ave retail and McCormick Place
- Floor drains with triple catch basin in place
- Easily divisible for investor or user/investor
- Off street parking
- Short walk to CTA trains
- Potential to add loading dock
- Ideal for last-mile distribution, downtown services, catering, or event services



2525 S Wabash Avenue, Chicago

Colin Green, SIOR

Senior Vice President
+1 312 334 7202
colin.s.green@cbre.com

John Marks

Senior Associate
+1 312 334 7204
john.marks@cbre.com

Larry Goldwasser, SIOR

Executive Vice President
+1 312 334 7201
larry.goldwasser@cbre.com

CBRE

Property Images

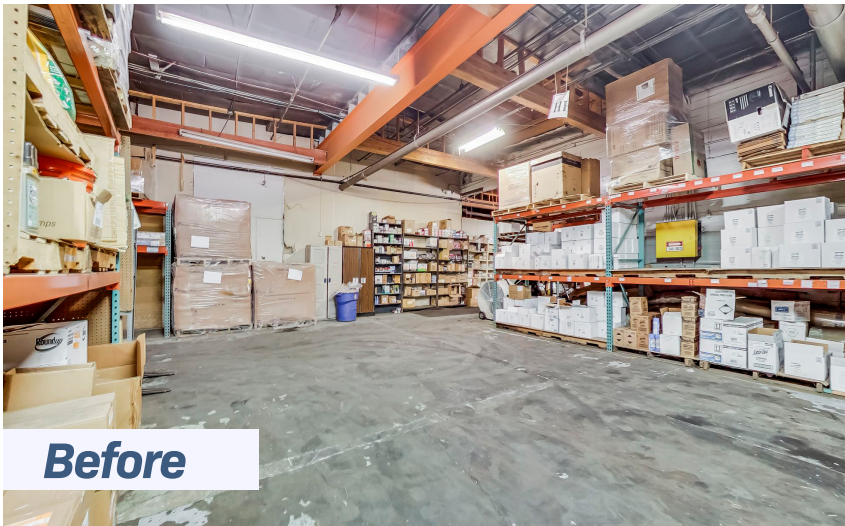

Colin Green, SIOR

Senior Vice President
+1 312 334 7202
colin.s.green@cbre.com

John Marks

Senior Associate
+1 312 334 7204
john.marks@cbre.com

Larry Goldwasser, SIOR

Executive Vice President
+1 312 334 7201
larry.goldwasser@cbre.com

2525 S Wabash Avenue, Chicago

CBRE

Floor Plan

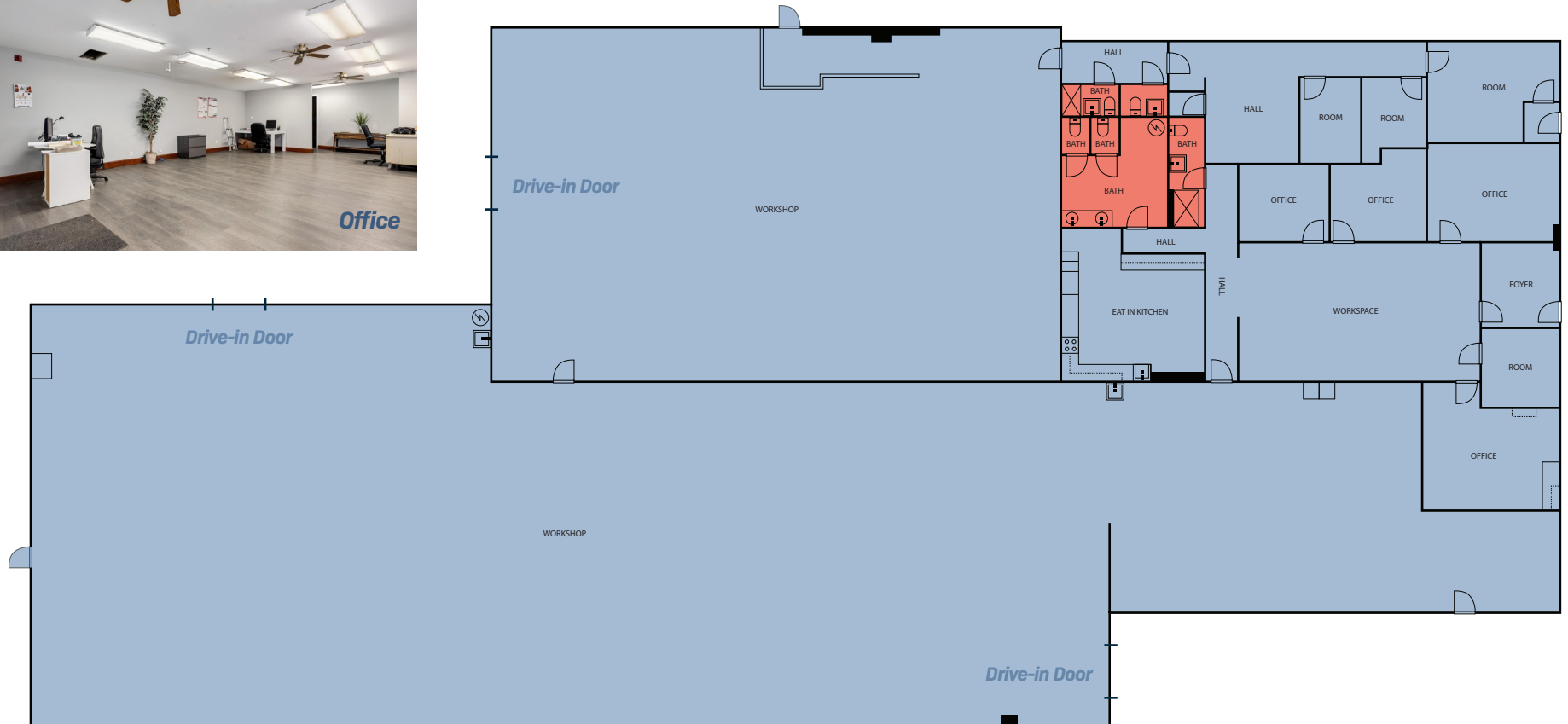

Easily Divisible

Colin Green, SIOR

Senior Vice President
+1 312 334 7202
colin.s.green@cbre.com

John Marks

Senior Associate
+1 312 334 7204
john.marks@cbre.com

Larry Goldwasser, SIOR

Executive Vice President
+1 312 334 7201
larry.goldwasser@cbre.com

2525 S Wabash Avenue, Chicago

CBRE

Access/Public Transportation Map



**Easy Access to I-55, Downtown Chicago
& Public Transportation Options**

Colin Green, SIOR

Senior Vice President
+1 312 334 7202
colin.s.green@cbre.com

John Marks

Senior Associate
+1 312 334 7204
john.marks@cbre.com

Larry Goldwasser, SIOR

Executive Vice President
+1 312 334 7201
larry.goldwasser@cbre.com

2525 S Wabash Avenue, Chicago

CBRE

Local Amenities



Restaurants



2525 S Wabash Avenue, Chicago

Colin Green, SIOR

Senior Vice President
+1 312 334 7202
colin.s.green@cbre.com

John Marks

Senior Associate
+1 312 334 7204
john.marks@cbre.com

Larry Goldwasser, SIOR

Executive Vice President
+1 312 334 7201
larry.goldwasser@cbre.com

CBRE

An aerial photograph of a city block in Chicago. A large, rectangular building with a bright red roof is the central focus. To its left is a multi-story brick building. To its right is a white-roofed industrial-style building. In the foreground, there is a parking lot with several trees. In the background, a multi-lane highway with traffic is visible, along with other city buildings and greenery.

2525 S Wabash Ave Chicago, IL

2525 S Wabash Avenue, Chicago

***For More Information
Please Contact***

Colin Green, SIOR

Senior Vice President
+1 312 334 7202
colin.s.green@cbre.com

John Marks

Senior Associate
+1 312 334 7204
john.marks@cbre.com

Larry Goldwasser, SIOR

Executive Vice President
+1 312 334 7201
larry.goldwasser@cbre.com

CBRE, Inc

*321 N Clark Street
Suite 3400
Chicago, IL 60654*

CBRE

©2025 CBRE, Inc. All rights reserved. This information has been obtained from sources believed reliable, but has not been verified for accuracy or completeness. You should conduct a careful, independent investigation of the property and verify all information. Any reliance on this information is solely at your own risk. CBRE and the CBRE logo are service marks of CBRE, Inc. All other marks displayed on this document are the property of their respective owners, and the use of such logos does not imply any affiliation with or endorsement of CBRE. Photos herein are the property of their respective owners. Use of these images without the express written consent of the owner is prohibited. PMStudio_April2022