

**ALOE**  
FRUIT MARKET

212.222.5722  
**RETAIL  
FOR LEASE**

CAPRICORN  
RETAIL ADVISORS



11+ Foot Ceiling Heights  
86+ Feet of Wraparound Signage  
±1,835 SF of Interior Space

CAPRICORN  
RETAIL ADVISORS



**CAPRICORN**  
RETAIL ADVISORS

**150 Union Avenue  
Brooklyn NY**



# 150 UNION AVENUE

## Brooklyn, NY



Located in the heart of  
**South Williamsburg** on Union Ave,  
between Middleton Street and Lynch  
Street, this is a unique retail opportunity  
in a dense residential neighborhood with  
under-served retail demand.

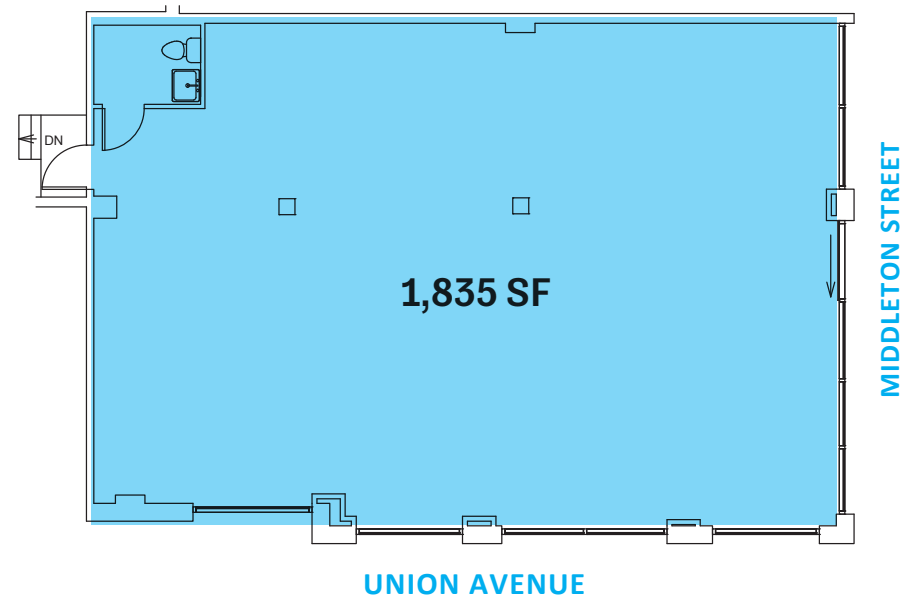

#### PREMISES:

Retail Space +/- 1,835 sf

#### CEILING HEIGHT:

11+ feet

#### FRONTAGE:

Approximately 86+ ft  
of wraparound frontage

#### HIGHLIGHTS:

- Excellent frontage along Union Avenue and Middleton Street, close to the Broadway Triangle; perfect for non vented food users and all kinds of retail or service concepts.
- Adjacent to the booming Larimer Street Subway Station and a two minute walk to the Broadway G Train and a six minute walk to the Flushing Avenue G Train.
- Surrounded by many successful regional and national tenants, including, Food Bazaar Brooklyn Harvest Market, Walgreens, and popular Brooklyn staples like Williamsburg Pizza, the Flats BK and Bushwick Grind.
- Located at the base of 103,000 sf mixed - use building with 130 residential units.

**Andrew Schulman**

E: [aschulman@capricornre.com](mailto:aschulman@capricornre.com)

C: (917) 685-8478

**Ryan Schimel**

E: [rschimel@capricornre.com](mailto:rschimel@capricornre.com)

C: (818) 516-3472

**Capricorn Retail Advisors**

424 Madison Avenue, 5th Fl  
New York, NY 10017

# 150 UNION AVENUE

Brooklyn, NY



CAPRICORN  
RETAIL ADVISORS

## DEMOGRAPHICS:



**213,034**

Population  
Within 1 - Mile  
Radius



**32 Years**

Average  
Population  
Age



**\$74,965**

Average HHI  
Within 1-Mile  
Radius



**6,111**

Total Businesses  
Within 1- Mile  
Radius



**21.85%**

Population  
Growth  
Since 2010



**\$1.6 bn**

Annual Spending  
Within 1-Mile  
Radius

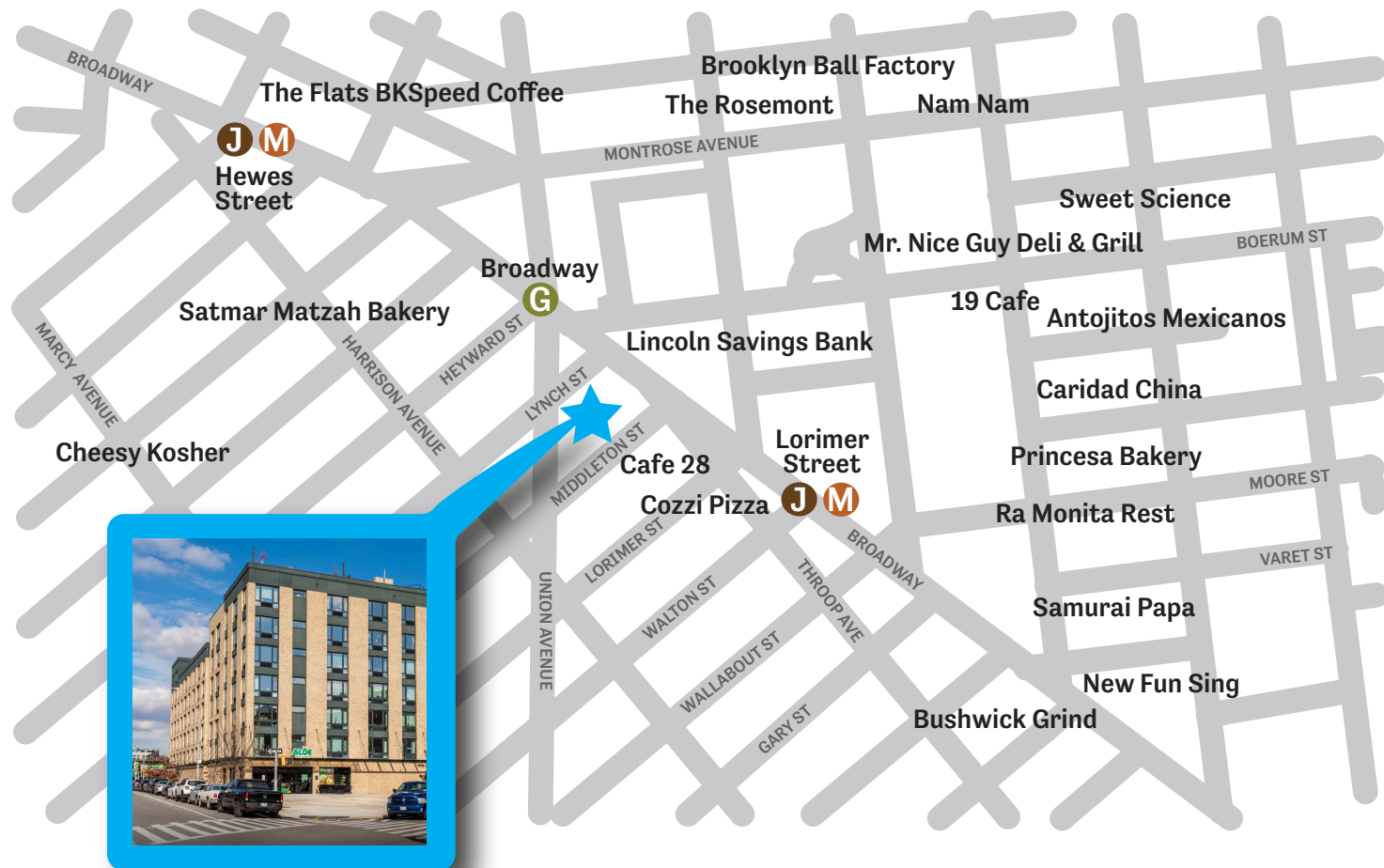

Andrew Schulman

E: [aschulman@capricornre.com](mailto:aschulman@capricornre.com)

C: (917) 685-8478

Ryan Schimel

E: [rschimel@capricornre.com](mailto:rschimel@capricornre.com)

C: (818) 516-3472

Capricorn Retail Advisors

424 Madison Avenue, 5th Fl

New York, NY 10017