

# FOR LEASE

4210 WILL ROGERS PKWY, SUITE B, OKLAHOMA CITY, OK 73108



**HORIZON**  
COMMERCIAL REAL ESTATE

**David Portman, CCIM**  
**Principal**

**405.850.1107**  
**[Horizoncreek.com](http://Horizoncreek.com)**





# PROPERTY INFORMATION

**\$6.50/psf + NNN**

PROPERTY TYPE	INDUSTRIAL
AVAILABLE SF	36,587 SF
CLEAR HEIGHT	24'
ZONING	I-2
YEAR BUILT	1977



INDUSTRIAL SUITE AVAILABLE FOR LEASE!



INCLUDES 2,901 SF OF OFFICE SPACE



FEATURES 4 DOCK DOORS (9'X10') & 1 DRIVE-IN RAMP (9'X11')



AMPLE PARKING WITH DEEP TRUCK COURT



AVAILABLE UTILITIES INCLUDE OGE, ONG, & CITY OF OKLAHOMA CITY WATER CONNECTIONS



IDEAL SPACE FOR WAREHOUSE AND DISTRIBUTION



CONVENIENT ACCESS TO INTERSTATES I-40 & I-44

ALTHOUGH THE INFORMATION HAS BEEN OBTAINED FROM TRUSTWORTHY SOURCES, HORIZON CRE MAKES NO GUARANTEES, ASSURANCES, OR WARRANTIES ABOUT THE COMPLETENESS OR ACCURACY OF THE DATA. THIS PROPERTY IS BEING PRESENTED WITH THE POSSIBILITY OF ERRORS AND OMISSIONS. MODIFICATIONS MAY OCCUR THAT ALTER THE FACTS OF THIS PRESENTATION WITHOUT NOTICE.

**HORIZON**  
COMMERCIAL REAL ESTATE

**David Portman, CCIM**  
**Principal**

**405.850.1107**  
**Horizoncreek.com**





**HORIZON**  
COMMERCIAL REAL ESTATE

**David Portman, CCIM**  
**Principal**

**405.850.1107**  
**[Horizoncreek.com](http://Horizoncreek.com)**





**HORIZON**  
COMMERCIAL REAL ESTATE

**David Portman, CCIM**  
**Principal**

**405.850.1107**  
**[Horizoncreek.com](http://Horizoncreek.com)**



4210 Will Rogers Pkwy, Oklahoma City, OK 73108  
SUITE B

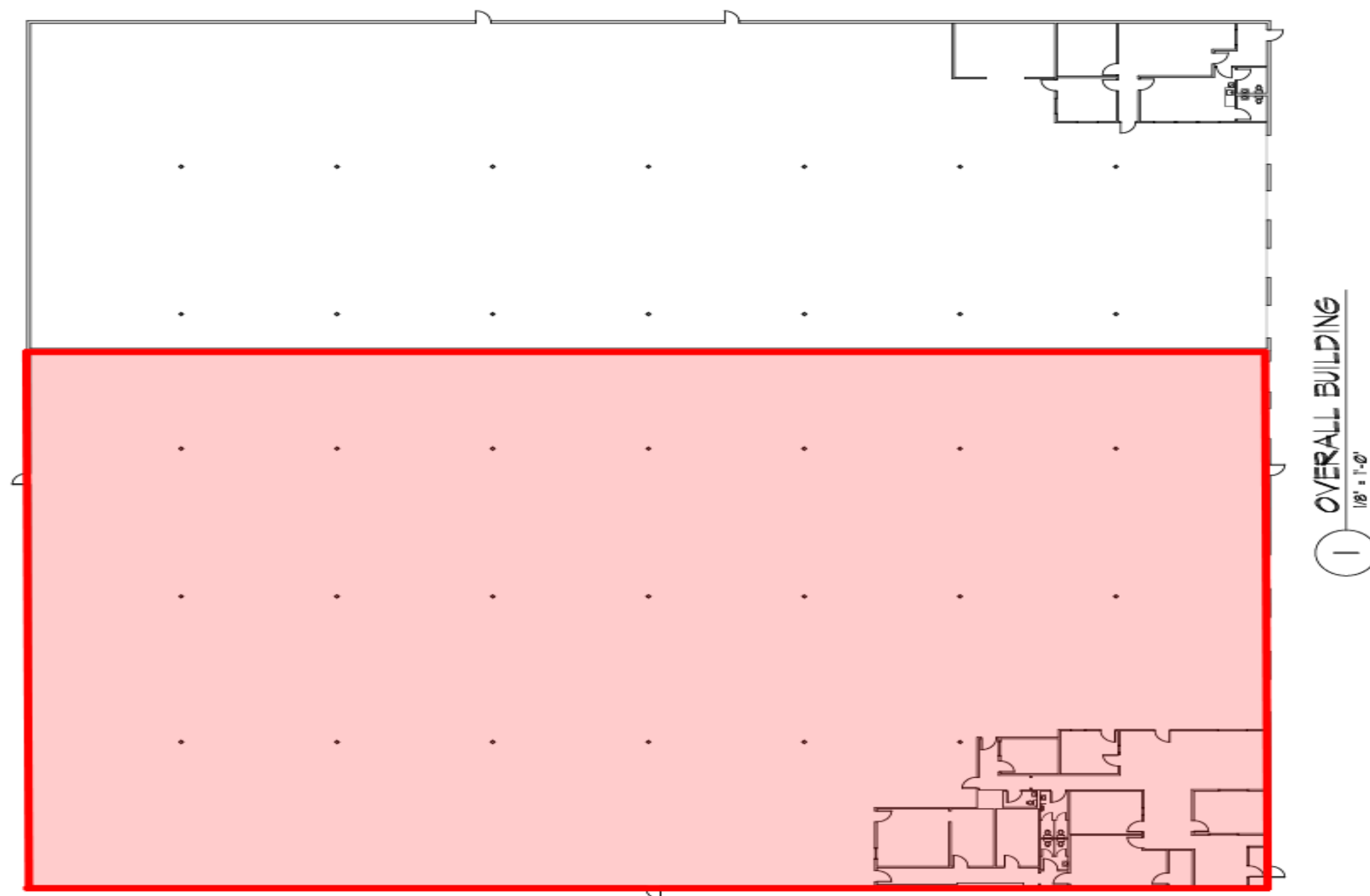

4210 Will Rogers Pkwy, Oklahoma City, OK 73108  
SUITE B

