

FOR LEASE

FREESTANDING BUILDING



AVAILABLE:
CAN BUILD UP TO ±7,000 SF PAD BUILDING
SINGLE TENANT OR MULTI-TENANT PAD

NWC 25TH ST & WESTERN AVE

1660 WEST 25TH STREET
SAN PEDRO, CA

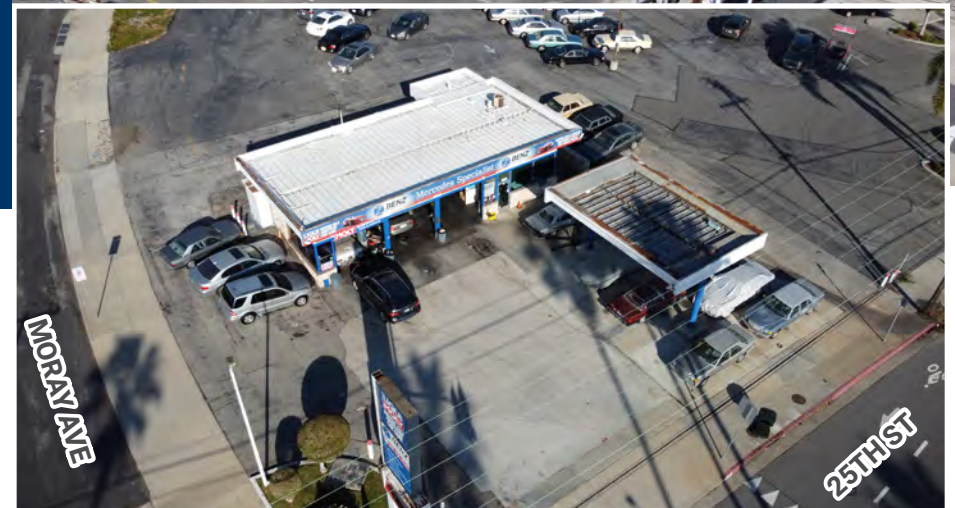

MARYL BINNEY
Lic. 01357931
Phone: 310-379-2228 ex 4
maryl@highlandpartnerscorp.com



MICHAEL GRANNIS
Lic. 01393628
Phone: 310 567 1650
mike@westpacpartners.com



AVAILABLE:
 Can build
 up to ±7,000 SF
 pad building
 Single tenant or
 multi-tenant pad

PROPERTY FEATURES

- Located in a grocery anchored shopping center at a prime intersection.
- Highly visible on the corner of 25th St. and Western Ave. with easy accessibility.
- Populated area with over 94,274 residents and a daytime population of 25,945 within a three-mile radius.

DEMOGRAPHICS (2021 EST.)



POPULATION

1 Mile	18,007
2 Miles	66,662
3 Miles	94,274
5 Miles	164,109



DAYTIME POPULATION

1 Mile	3,446
2 Miles	13,946
3 Miles	25,945
5 Miles	54,283



AVERAGE HH INCOME

1 Mile	\$136,682
2 Miles	\$111,981
3 Miles	\$121,723
5 Miles	\$120,254

Demographic Source: Applied Geographic Solutions 11/2021, TIGER Geography

SITE PLAN

CAN BUILD UP TO ±7,000 SF PAD BUILDING

TRAFFIC COUNTS



25TH ST & WESTERN AVE | ±55,374 CPD

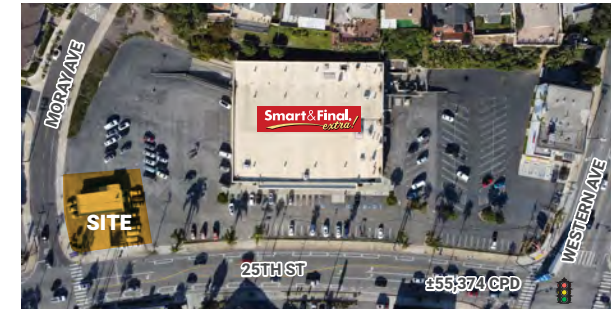
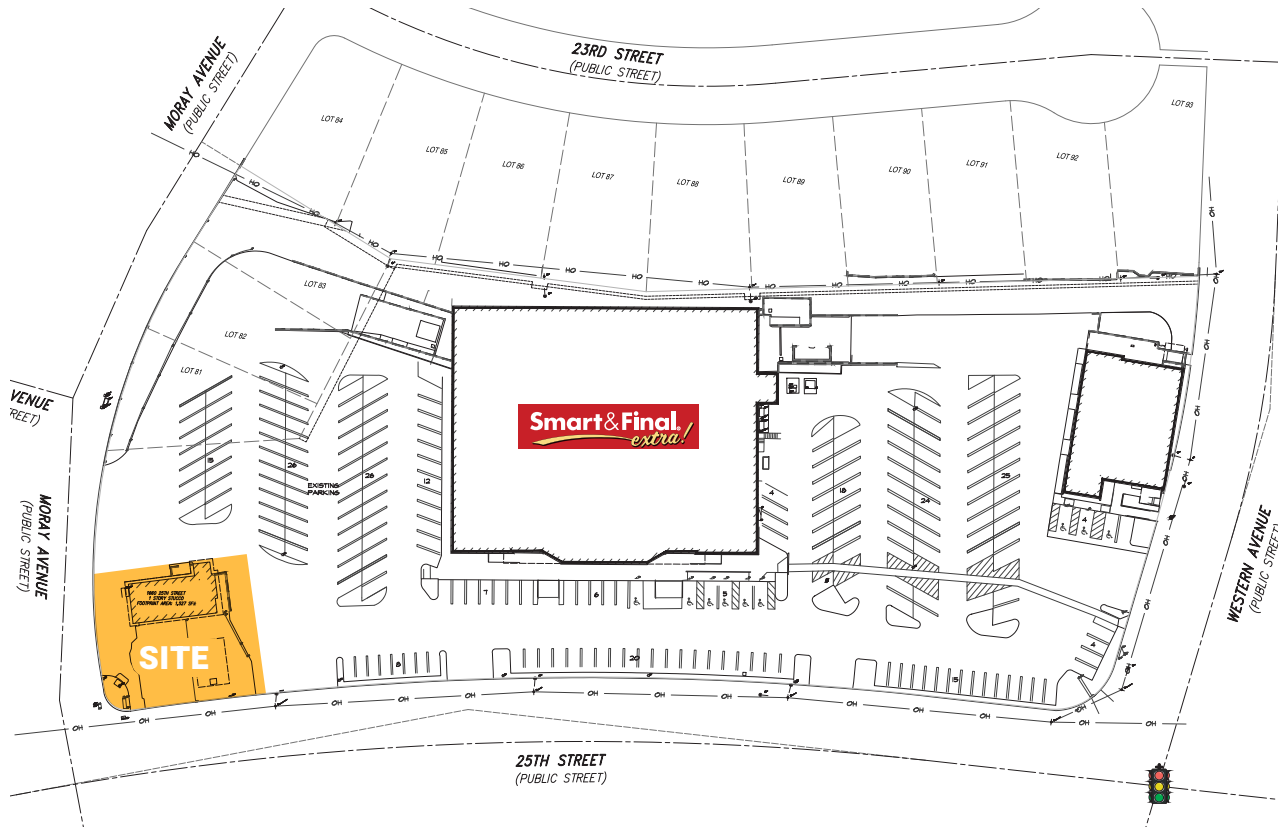



NWC 25th St & Western Ave
 1660 WEST 25th STREET
 SAN PEDRO, CA



SITE

25th ST

WESTERN AVE



±55,374 CPD



MARYL BINNEY
 Lic. 01357931
 Phone: 310-379-2228 ex 4
 maryl@highlandpartnerscorp.com

MICHAEL GRANNIS
 Lic. 01393628
 Phone: 310 567 1650
 mike@westpacpartners.com

HIGHLAND PARTNERS CORP.
 880 Apollo Street, Suite 329
 El Segundo, CA 90245
 Broker Lic. 01904030

WESTPAC PARTNERS
 1815 Via El Prado, Suite 300
 Redondo Beach, CA 90277

©2023 | Highland Partners Corp. | The information being provided by Highland Partners Corp. and/or its sources is deemed reliable. While we have no reason to doubt its accuracy, we do not guarantee it. Any information, measurements, facts and actual drawings shown are approximate, subject to change, or withdrawal without notice and should be independently verified by you and may not be relied upon as a precise representation by this office. No warranties or representations are made as to the condition of the property or any hazards contained therein nor any to be implied. Logos are for identification purposes only and may be trademarks of their respective companies.
 1660W25thSt_BRO_v01.indd | 01/23

