

# 6015

## GIANT HIGHWAY

RICHMOND, CALIFORNIA

**FOR LEASE**  
**±224,154 SF WAREHOUSE**



### CONTACTS

#### **Kevin Hatcher**

Senior Vice President  
kevin.hatcher@cbre.com  
+1 510 874 1939  
Lic. 01495631

#### **Robert Ferraro**

Executive Vice President  
bob.ferraro@cbre.com  
+1 510 874 1910  
Lic. 00949584

#### **Michael Barry**

Executive Vice President  
michael.barry@cbre.com  
+1 510 874 1926  
Lic. 00950054

**CBRE**

# PROPERTY HIGHLIGHTS

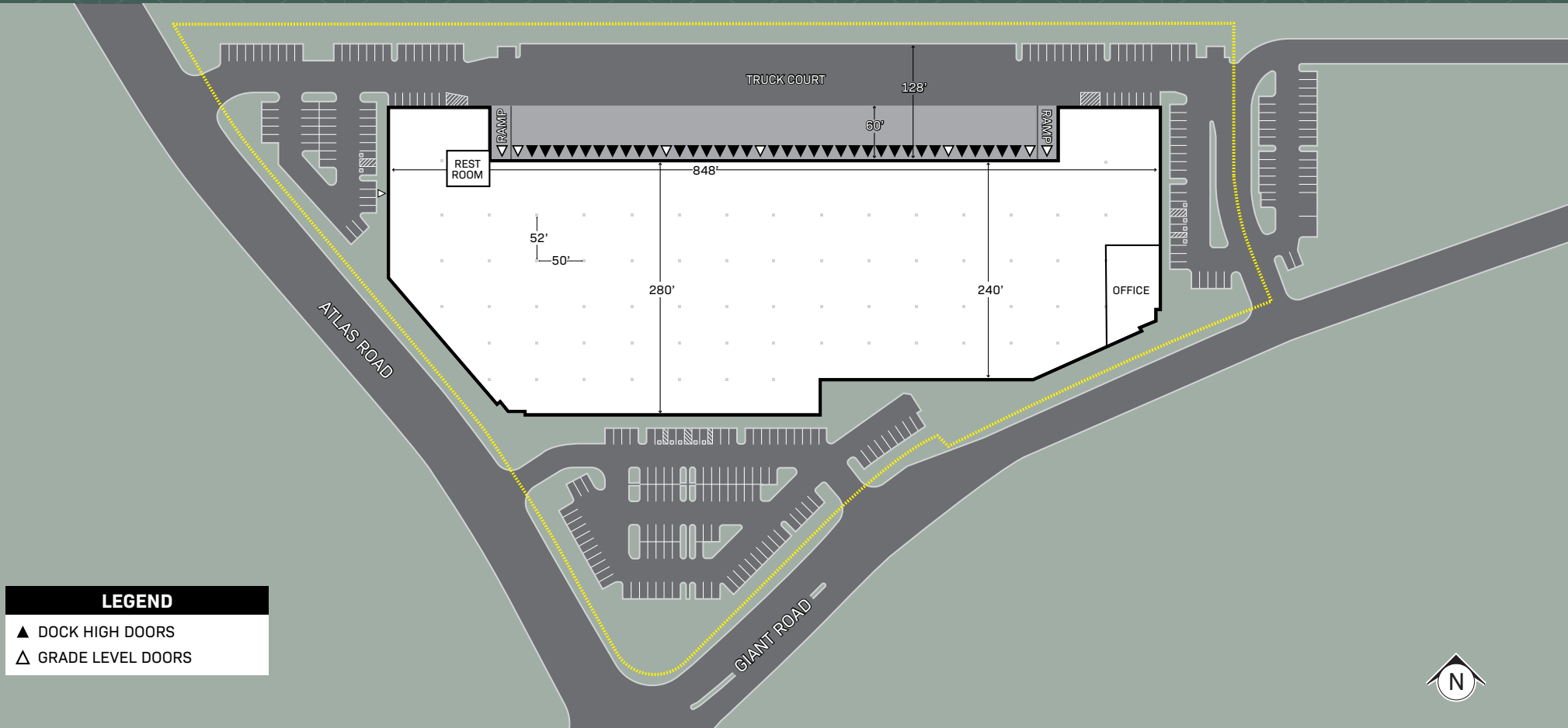

**LEGEND**

- ▲ DOCK HIGH DOORS
- △ GRADE LEVEL DOORS



±4,000 SF employee breakroom  
±1,200 SF Office w/5 Private



Parking:  
239 stalls



Dock-High Doors: **34**



Grade-Level Doors: **8**



Pit Levelers: **6**



Clear Height: **±32'**



Power: **3,000 amps, 480/277**  
volt 3-phase electrical service



Bay Spacing:  
**50' x 52'**



Truck Court:  
**128' with a 60' concrete apron**



Skylights:  
**1.5% of roof area**



Fire Sprinkler System:  
**ESFR**

# AERIAL

San Francisco

Port of Oakland

Bay Bridge

Richmond Bridge  
to San Rafael



Hilltop Mall

Access to 580  
10 min (7 miles)

Access to I-80  
5 min (2.7 miles)

Richmond Parkway

**6015**  
GIANT HIGHWAY  
RICHMOND, CALIFORNIA



WILLIAMS SONOMA  
CALIFORNIA

RH  
RESTORATION HARDWARE

goPuff

amazon



amazon

BIO-RAD





# 6015

**GIANT HIGHWAY**  
RICHMOND, CALIFORNIA

## CONTACTS

### **Kevin Hatcher**

Senior Vice President  
kevin.hatcher@cbre.com  
+1 510 874 1939  
Lic. 01495631

### **Robert Ferraro**

Executive Vice President  
bob.ferraro@cbre.com  
+1 510 874 1910  
Lic. 00949584

### **Michael Barry**

Executive Vice President  
michael.barry@cbre.com  
+1 510 874 1926  
Lic. 00950054



© 2022 CBRE, Inc. All rights reserved. This information has been obtained from sources believed reliable but has not been verified for accuracy or completeness. CBRE, Inc. makes no guarantee, representation or warranty and accepts no responsibility or liability as to the accuracy, completeness, or reliability of the information contained herein. You should conduct a careful, independent investigation of the property and verify all information. Any reliance on this information is solely at your own risk.