

1300 SE 10th Street, Stuart, FL 34996

FORMER PINE SCHOOL EDUCATIONAL CAMPUS

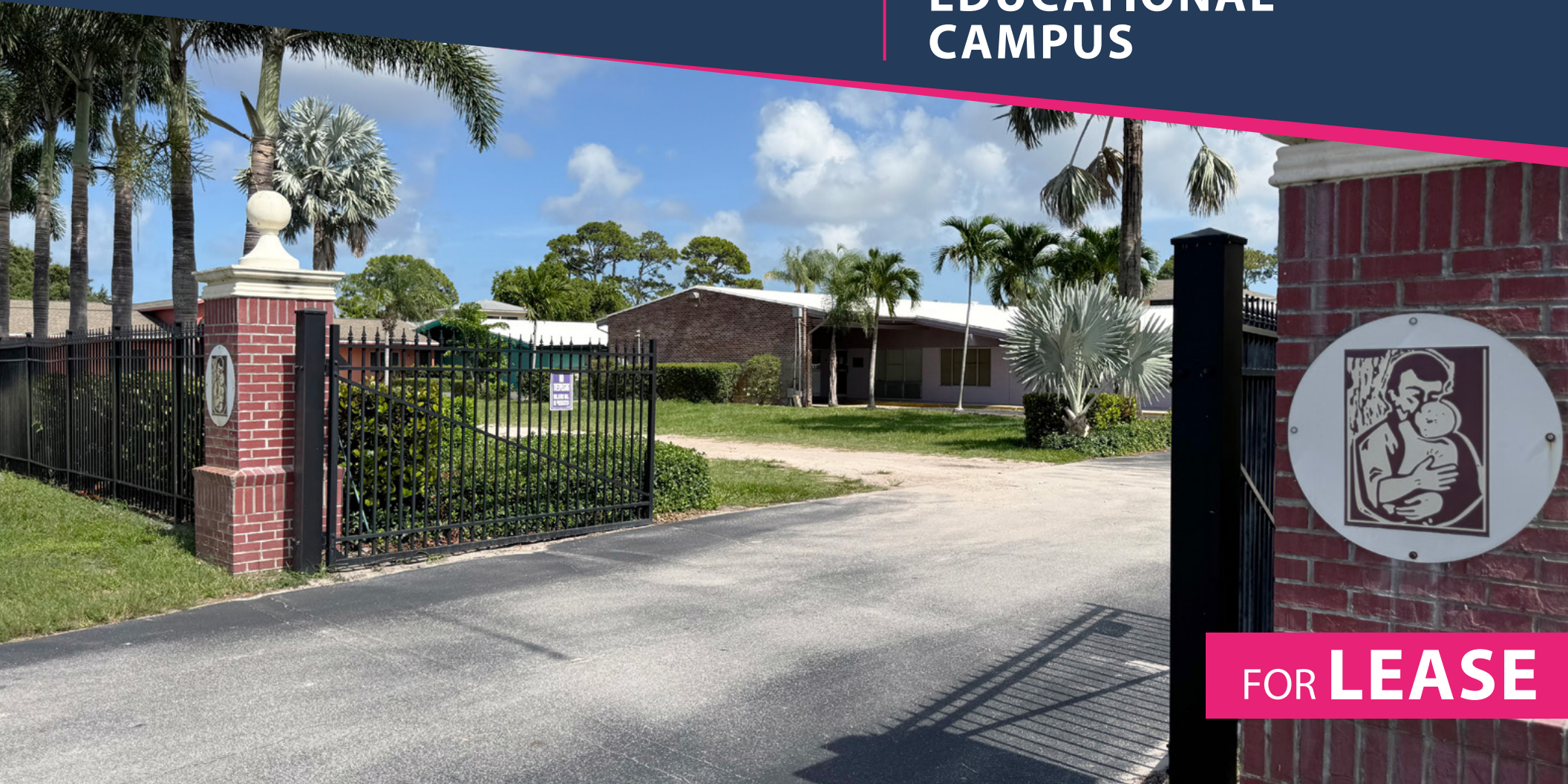

FOR **LEASE**



ALEX AYDELOTTE
Broker | Principal
O: 772.223.3646 C: 772.263.1130
E: alex@florida-commercial.net

**4,684 SF -
24,798 SF**

Stuart, FL

EXECUTIVE SUMMARY

1300 SE 10th Street, Stuart, FL 34996

FORMER PINE SCHOOL EDUCATIONAL CAMPUS

SPECS

Building Size: 24,798 SF Combined / 4 Separate Buildings
Separate Building Sizes: **Building A:** 6,783 SF / **Building B:** 7,500 SF / **Building C:** 4,684 SF / **Building D:** 5,831 SF
Price: \$12 Per SF + \$4 CAM / NNN
Land Use: Institutional - City of Stuart

PROPERTY OVERVIEW

Well-Known and Iconic Educational Campus in the Heart of Stuart! This Unique and Rare Property consists of 4 separate buildings ranging in size from 4,684 sf - 7,500 sf, including 3 Classroom Style buildings and 1 Administrative Office building. Located on a Beautiful and Tranquil parcel of land in one of Stuart's most established neighborhoods, this is an Ideal Turn-Key Opportunity for Adult Education, Small Colleges, Trade Schools, Special Needs Education, Daycare (newborn-2 yrs only as 3-5 yrs and K-12 schools are restricted), or non-profit office users. Ample Parking, Multiple Drop-off/Pick-up locations, and Outdoor Space! The entire Campus may be leased together or separately, please contact Alex Aydelotte for additional information.



ALEX AYDELLOTTE
Broker | Principal
O: 772.223.3646 **C:** 772.263.1130
E: alex@florida-commercial.net

**4,684 SF -
24,798 SF**

Stuart, FL



FC FLORIDA
COMMERCIAL
REAL ESTATE COMPANY



FC FLORIDA
COMMERCIAL
REAL ESTATE COMPANY



FC FLORIDA
COMMERCIAL
REAL ESTATE COMPANY



FC FLORIDA
COMMERCIAL
REAL ESTATE COMPANY

FC FLORIDA
COMMERCIAL
REAL ESTATE COMPANY



ALEX AYDELOTTE
Broker | Principal
O: 772.223.3646 C: 772.263.1130
E: alex@florida-commercial.net

**4,684 SF -
24,798 SF**

Stuart, FL

309 SE Osceola Street #104 • Stuart, FL 34994 • 772.223.3646 • florida-commercial.net

©Florida Commercial 2021 • This offering is subject to errors, prior to sale/lease, withdrawal, or change in price, terms or conditions without notice.



FC **FLORIDA**
COMMERCIAL
REAL ESTATE COMPANY



ALEX AYDELOTTE
Broker | Principal
O: 772.223.3646 C: 772.263.1130
E: alex@florida-commercial.net

4,684 SF -
24,798 SF

Stuart, FL

309 SE Osceola Street #104 • Stuart, FL 34994 • 772.223.3646 • florida-commercial.net

©Florida Commercial 2021 • This offering is subject to errors, prior to sale/lease, withdrawal, or change in price, terms or conditions without notice.



FC **FLORIDA**
COMMERCIAL
REAL ESTATE COMPANY



ALEX AYDELOTTE
Broker | Principal
O: 772.223.3646 C: 772.263.1130
E: alex@florida-commercial.net

4,684 SF -
24,798 SF

Stuart, FL



FC FLORIDA
COMMERCIAL
REAL ESTATE COMPANY



ALEX AYDELOTTE
Broker | Principal
O: 772.223.3646 C: 772.263.1130
E: alex@florida-commercial.net

4,684 SF -
24,798 SF

Stuart, FL



FC **FLORIDA
COMMERCIAL**
REAL ESTATE COMPANY



ALEX AYDELOTTE
Broker | Principal
O: 772.223.3646 C: 772.263.1130
E: alex@florida-commercial.net

**4,684 SF -
24,798 SF**

Stuart, FL

309 SE Osceola Street #104 • Stuart, FL 34994 • 772.223.3646 • florida-commercial.net

©Florida Commercial 2021 • This offering is subject to errors, prior to sale/lease, withdrawal, or change in price, terms or conditions without notice.

MAP & REPORT

1300 SE 10th Street, Stuart, FL 34996

FORMER PINE SCHOOL EDUCATIONAL CAMPUS



POPULATION

	1 MILE	3 MILES	5 MILES
Population	13.8K	68.4K	125K
Median age	54	53	54



HOUSEHOLDS & INCOME

	1 MILE	3 MILES	5 MILES
Total households	6,453	30.4K	55.1K
# of Employees	13.8K	68.4K	109K
Average HH income	\$58.1K	\$74.4K	\$80.5K

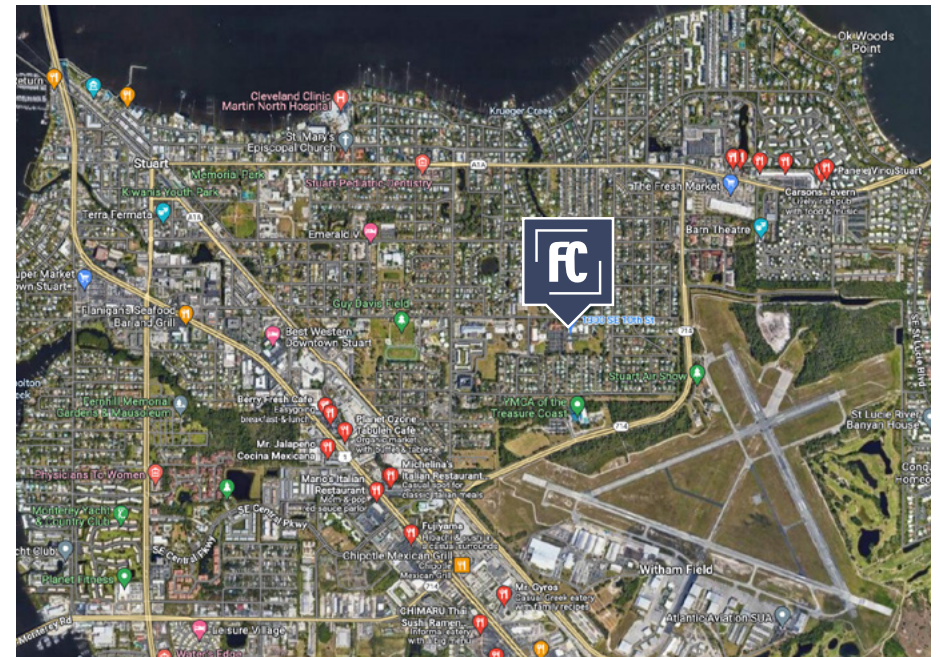

ALEX AYDELOTTE
 Broker | Principal
 O: 772.223.3646 C: 772.263.1130
 E: alex@florida-commercial.net

**4,684 SF -
 24,798 SF**

Stuart, FL

FLOOR PLANS

1300 SE 10th Street, Stuart, FL 34996

FORMER PINE SCHOOL EDUCATIONAL CAMPUS

BUILDING A

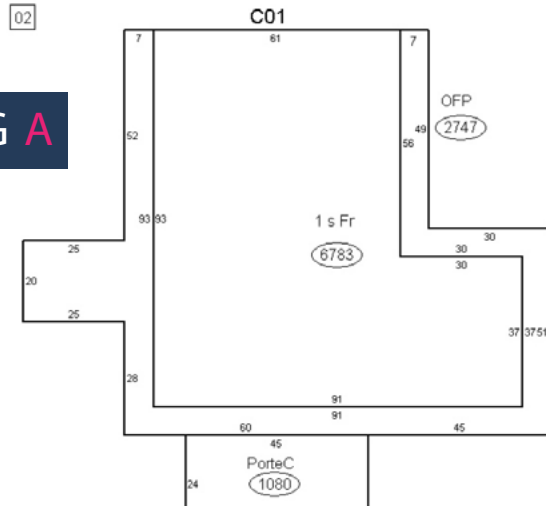

BUILDING C

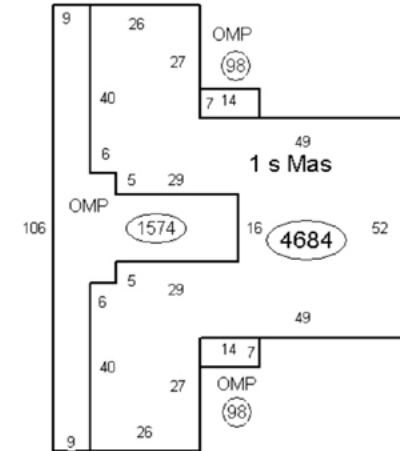

BUILDING B

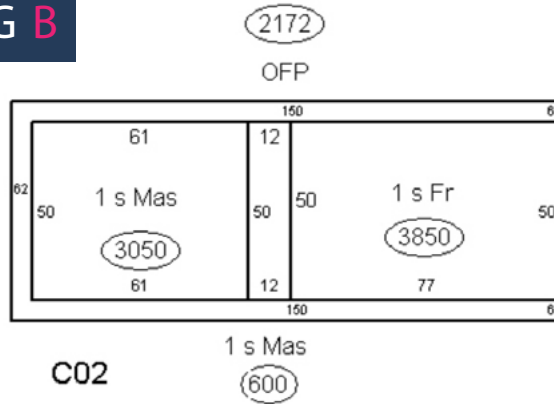

BUILDING D

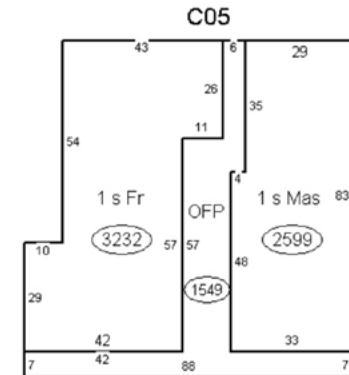

ALEX AYDELOTTE
 Broker | Principal
 O: 772.223.3646 C: 772.263.1130
 E: alex@florida-commercial.net

**4,684 SF -
 24,798 SF**

Stuart, FL