

MAPLE RIDGE NW

T-43-N • R-23-W

See Pages 94-105 For Additional Names.



MARQUETTE COUNTY

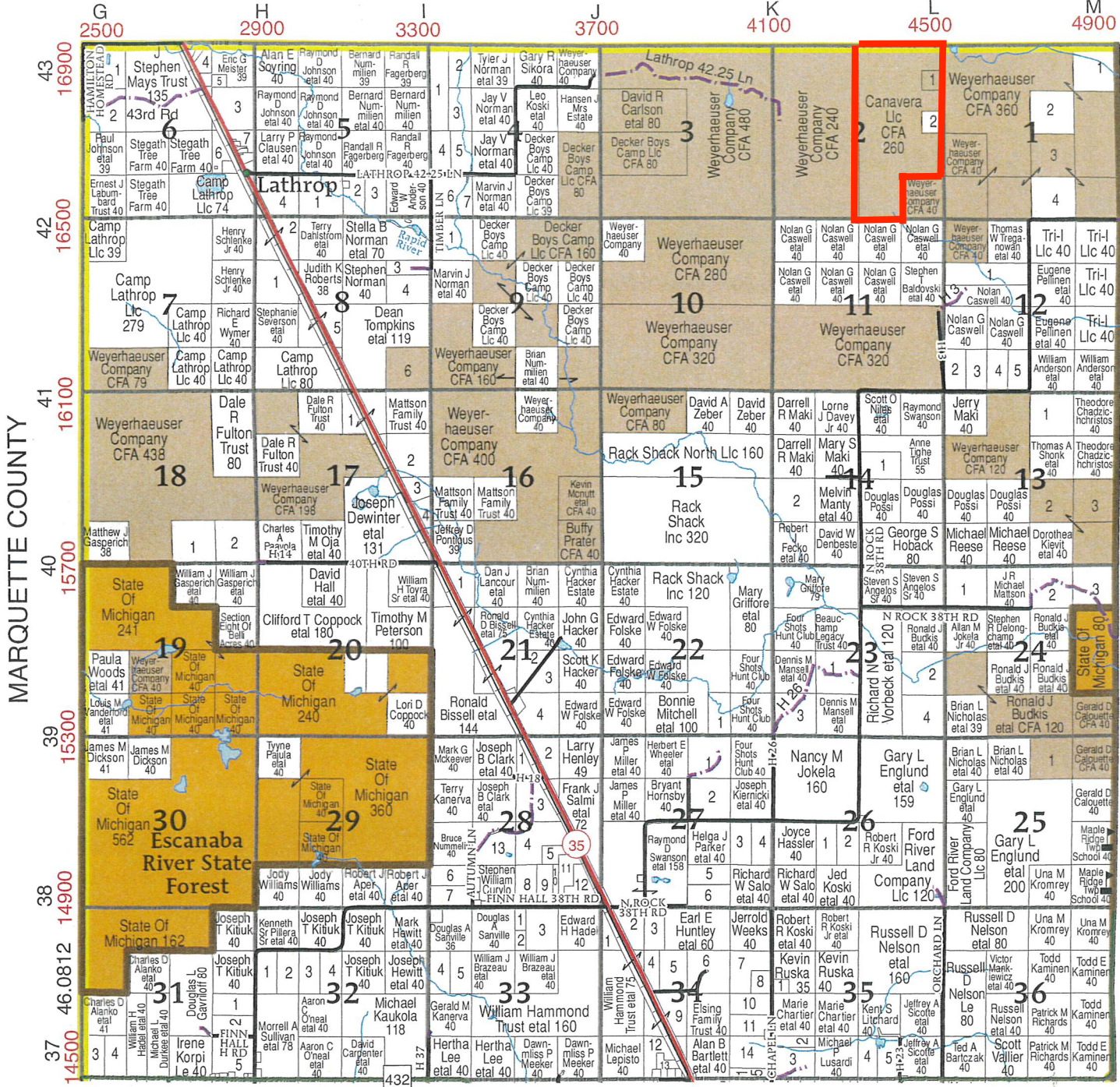

SEE PAGE 51

SEE PAGE 43

CONFIDENCE GROWS HERE.

© Farm & Home Publishers, Ltd.

GREEN TIMBER CONSULTING FORESTERS, INC.

JUSTIN MILLER, A.C.F. • MI Registered #978
Association of Consulting Foresters

- Forest Mgt. Services
- GIS Services
- Tree Farm Group
- Wildlife Food Plots

11511 US Highway 41 • Pellis, MI 49958
Phone: (906) 353-8584 • Cell: (906) 281-4832
Web: www.greentimberforestry.com • Email: info@greentimberforestry.com