

# Northbridge Centre

## OFFICE TOWER FOR SUBLEASE

515 N Flagler Drive | West Palm Beach, FL 33401

### BELOW MARKET OFFICE SPACE FOR SUBLEASE

**2,966 sf – MOVE IN READY!**

#### Suite Description

- Elevator exposure, 7 offices on the window line, 1 interior office, large reception area, windowed conference room, kitchen/breakroom and two storage rooms.

#### Property Highlights

- 21-story class A office building
- 246,508 sf off office space
- Adjacent parking structure with direct building access
- Intracoastal views
- Full service banking with ATM service
- At the base of the Flagler Memorial Bridge ("North Bridge")
- Quick ingress and egress to Palm Beach Island, Interstate 95 & Okeechobee Blvd.

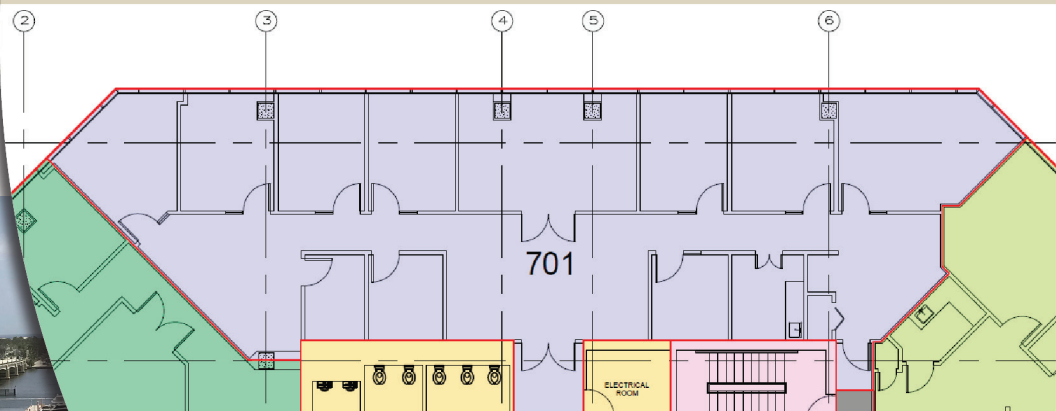

**COMMERCIAL  
FLORIDA**   
REALTY PARTNERS, LLC

[www.commfla.com](http://www.commfla.com)

For more information contact:

**561-338-9950**

**George Sacks**

C: 954-480-7695

[gsacks@commercialflorida.net](mailto:gsacks@commercialflorida.net)

**Dante Gentile**

C: 954-552-1159

[dgentile@commercialflorida.net](mailto:dgentile@commercialflorida.net)

4800 N. Federal Hwy | Suite D300 | Boca Raton, FL 33431