

EXHIBIT A1

CLARCONA OCOFEE ROAD

105' RIGHT OF WAY

EDGE OF PAVEMENT

EDGE OF PAVEMENT

EDGE OF PAVEMENT

EDGE OF PAVEMENT

CURB INLET
TOP ELEV - 91.33
N INV - 85.53
E INV - 85.24
E INV - 85.97

STONE MANHOLE
TOP ELEV - 91.99
N INV - 86.20
E INV - 85.18

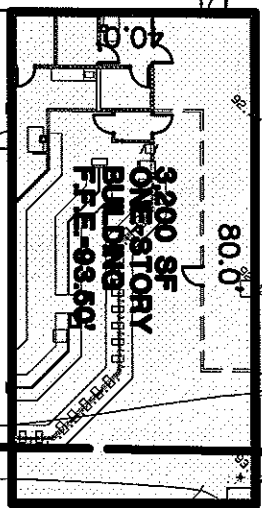
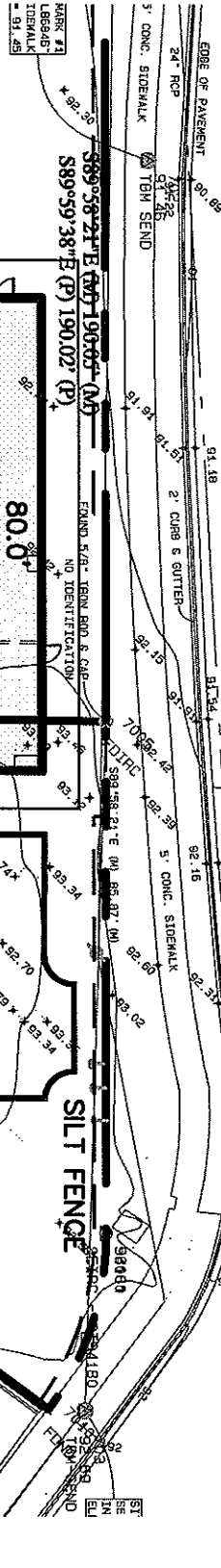

5
ROSSINGS
1:54
Y, FLORIDA
CRES
(IMPROVED)

