

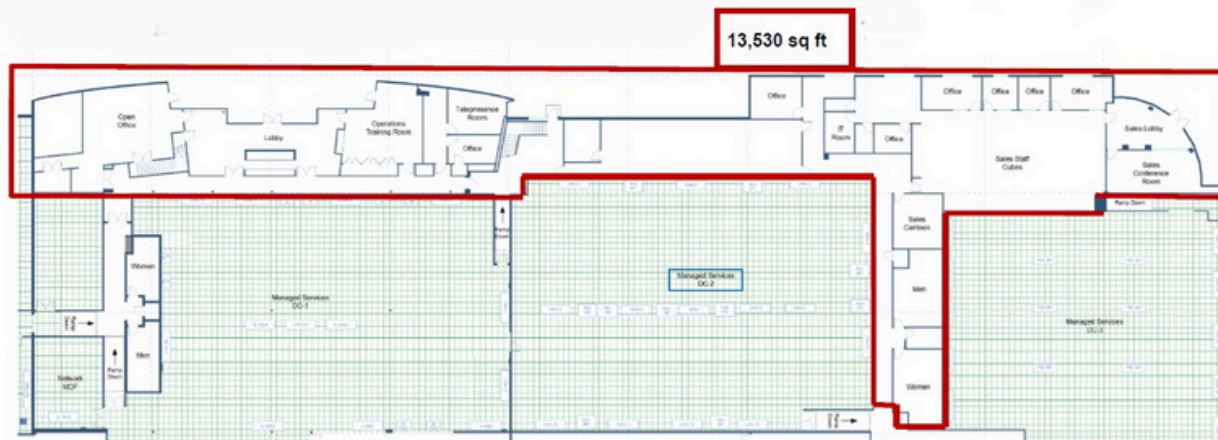

For Sublease

Office/ Flex Space
13,530 SF available



7499 E Paradise Lane, Scottsdale, AZ 85260

Property highlights

- Immediate availability
- Flexible use, two story space with extensive frontage
- Centrally located in North Scottsdale, adjacent to various retail, restaurants, and offices
- Covered (30) and uncovered (50+) parking spaces available surrounding building
- Easy access to AZ-101 Loop

Clark Bauer

Clark.Bauer@jll.com
602 418 5549

Valeria Galindo

Valeria.Galindo@jll.com
602 909 9540