



4081 Mission Oaks Boulevard, Unit A

Camarillo, California 93012

Lease Highlights

- Turn key, move-in ready offices
- 8 Exterior/Perimeter Offices with Windows
- Open Area Work Stations
- Large Conference Room
- 2 Private Restrooms
- Zoning - M-1 Light Manufacturing City of Camarillo
- Abundant Parking - 1 space per 250 SF is 17 stalls (or 1 space per 200 SF for medical uses)
- Close to Ventura "101" Freeway at Flynn Road on/off ramp
- Great Window Line - lots of glass
- Modified Gross lease. Tenant responsible for utilities and janitor service

Property Description

Creekside Executive Center is a 14-building, 27 unit professional business campus. The Business Park Association and Condominium Association address rights and responsibilities among participants.



For more information

Bill Kiefer, SIOR

O: 805.288.5467

bkiefer@naicapital.com | CalDRE #00828915

No warranty, express or implied, is made as to the accuracy of the information contained herein. This information is submitted subject to errors, omissions, change of price, rental or other conditions, withdrawal without notice, and is subject to any special listing conditions imposed by our principals. Cooperating brokers, buyers, tenants and other parties who receive this document should not rely on it, but should use it as a starting point of analysis, and should independently confirm the accuracy of the information contained herein through a due diligence review of the books, records, files and documents that constitute reliable sources of the information described herein. Logos are for identification purposes only and may be trademarks of their respective companies. NAI Capital, Inc. CAL DRE Lic. #01990696.

NAI Capital

300 Esplanade Drive, Suite 1660

Oxnard, CA 93036

805.278.1400

naicapital.com

For Lease

Creekside Executive Center

Creekside Executive Center - 4081 Mission Oaks Blvd, Suites A & B, Camarillo, CA

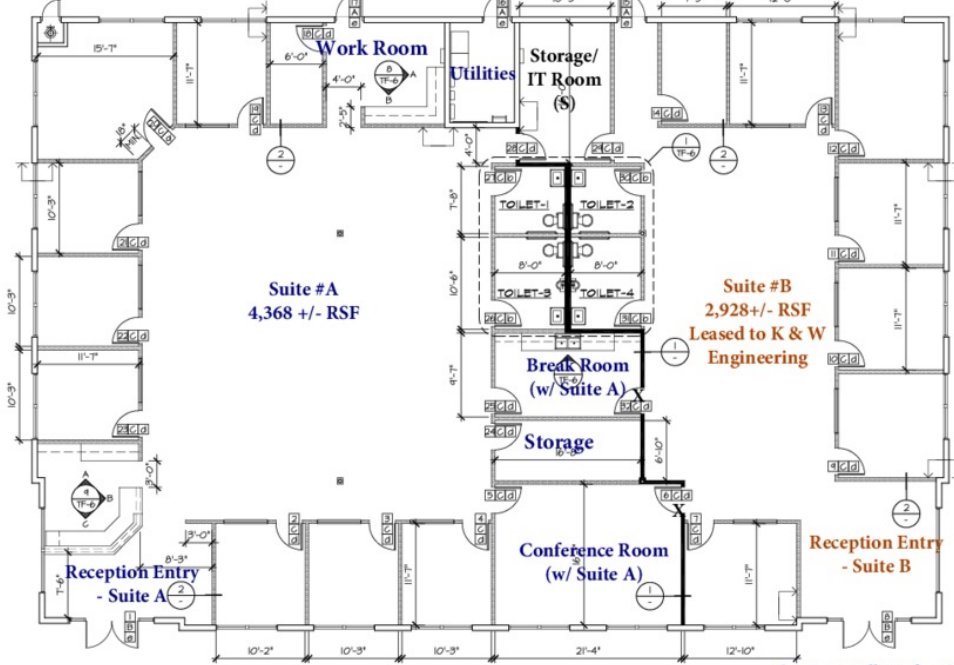

Contact: Bill Kiefer, SIOR
NAI Capital Commercial, Inc
#805-288-5467;
bkiefer@naicapital.com

Total Building area - 7,269 +/- RSF
NORTH
DIMENSION PLAN
SCALE: 1/8"=1'-0"



Bill Kiefer, SIOR
805.288.5467
bkiefer@naicapital.com
CalDRE #00828915



For Lease

Creekside Executive Center

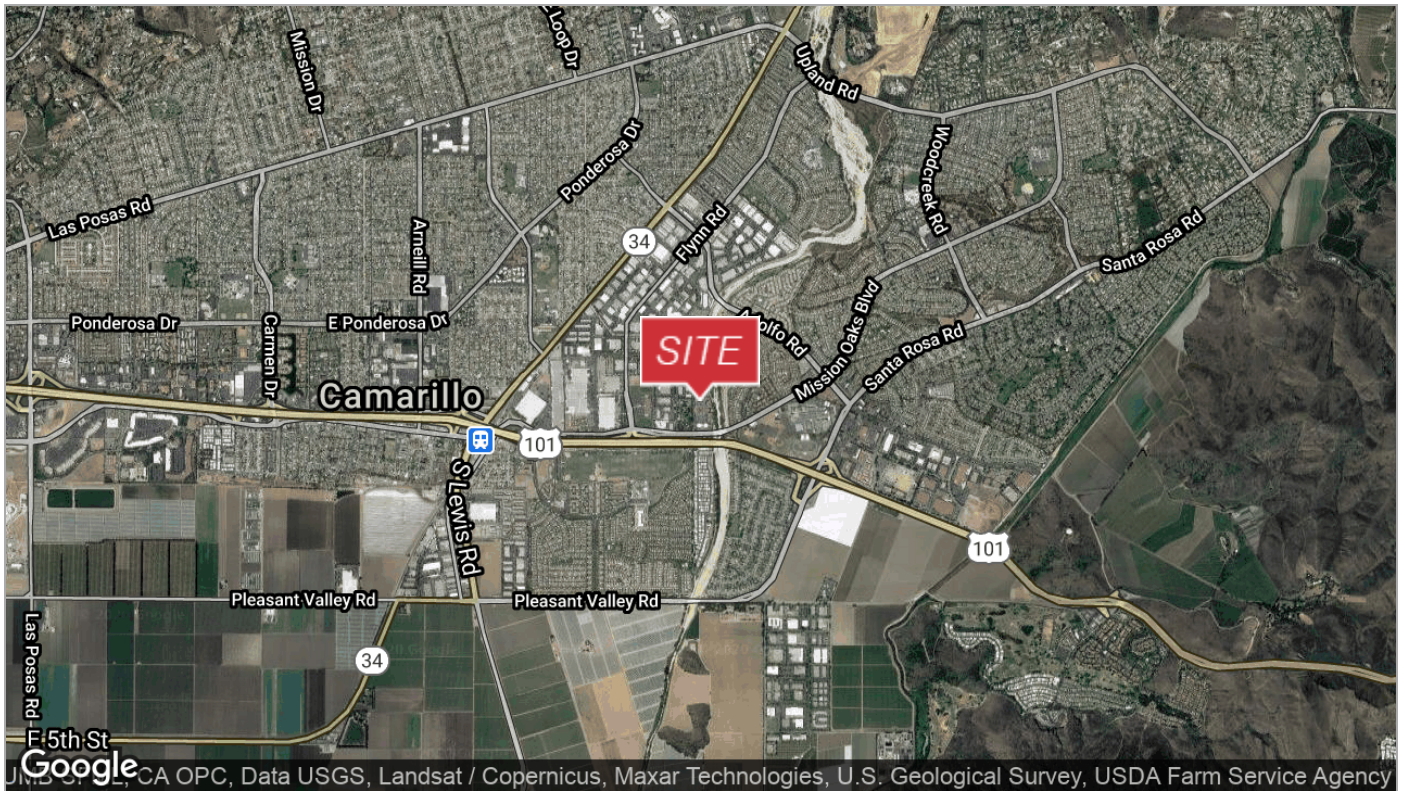
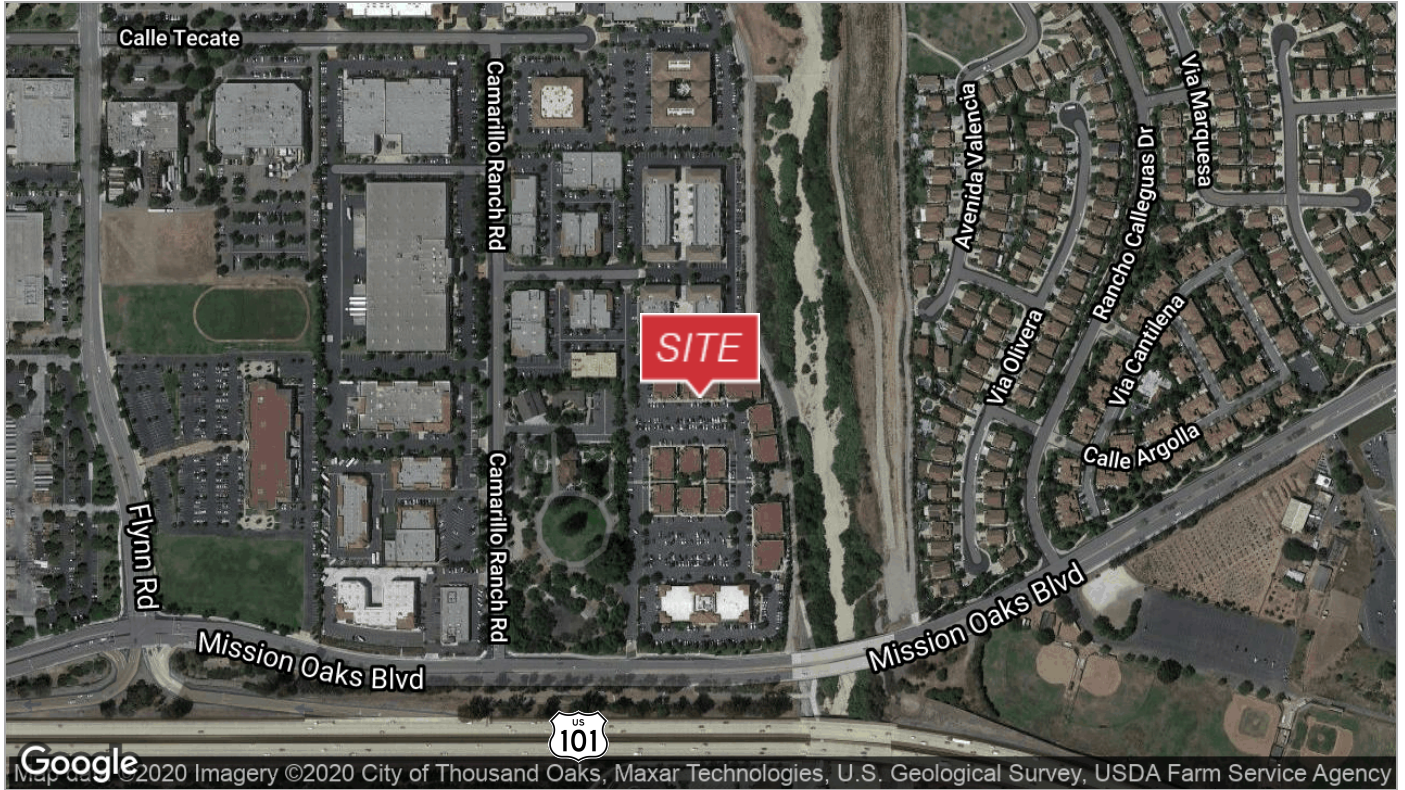

Bill Kiefer, SIOR
805.288.5467
bkiefer@naicapital.com
CalDRE #00828915