

8585

Miramar Place

FOR LEASE | ± 13,500 Total SF | Mfg and/or Contractor Services Property



WAREHOUSE & OFFICE SPACE
FOR LEASE
CONTACT ALI (949) 244-1928
OR RICARDO (858) 926-9394

8585

repmagic

EXCLUSIVELY LISTED BY

AIDAN JAMES
aidan.james@ip-cre.com
619.631.8661
Lic. #02060510

CHRIS NELSON
chris.nelson@matthews.com
949.280.6217
Lic. #02055962

CADE REMY
cade.remy@matthews.com
858.337.0599
Lic. #02209620

ZANE RIHAN
zane.rihan@ip-cre.com
858.205.7376
Lic. #02218149





PROPERTY HIGHLIGHTS



8585 Miramar Place, San Diego CA 92121



1 Grade-Level Door



± 13,500 Total SF; ± 3,000 SF 2-Story Office



2 Dock-Level Doors

Bonus mezzanine in warehouse optional.

Unique standalone manufacturing and/or contractor services property.



Clear Height: 20' - 22'



Lease Rate: Contact Broker



Concrete Parking Lot



Large Fenced and Secured Yard Area



Ample Power



IL-2-1 Zoning



Year Built: 1983



Proximity to I-15 and I-805 Freeways and Miramar Rd



HVAC in Office and Showroom

Information herein has been obtained from sources deemed reliable, however its accuracy cannot be guaranteed. The user is required to conduct their own due diligence and verification.

FLOOR PLAN

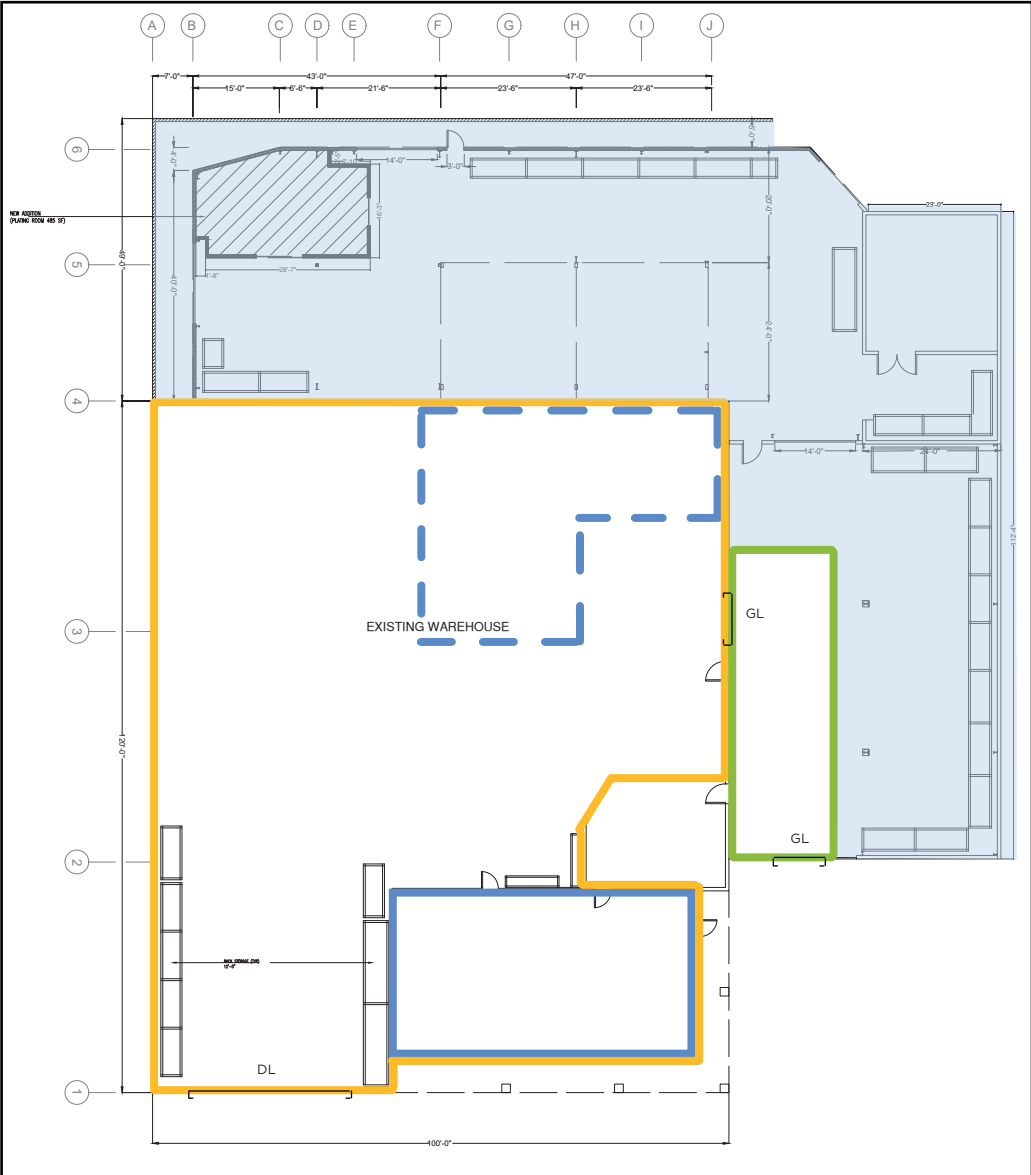

- Property
- 2-Story Office
- Bonus Mezzanine
- Shared Loading Area
- Not Offered

Information herein has been obtained from sources deemed reliable, however its accuracy cannot be guaranteed. The user is required to conduct their own due diligence and verification.

LOCATION



\$698,955
AVERAGE HOME VALUE



3,334,024
POPULATION



\$245 B
GROSS REGIONAL PRODUCT



1,165,877
HOUSEHOLDS

SAN DIEGO OVERVIEW

San Diego County's beautiful year-round weather combined with a dynamic economy makes the region one of the most desirable places to live and work in the United States. San Diego's quality of life and burgeoning economy attract residents, businesses and visitors from around the world.

Over the last two decades, the San Diego region has developed its own progressive identity as a premier tourist destination and a leader in defense development, biotechnology, sustainable energy, wireless and telecommunications technologies, and electronics manufacturing.



FOR MORE INFORMATION PLEASE CONTACT

AIDAN JAMES
aidan.james@ip-cre.com
619.631.8661
Lic. #02060510

CHRIS NELSON
chris.nelson@matthews.com
949.280.6217
Lic. #02055962

CADE REMY
cade.remy@matthews.com
858.337.0599
Lic. #02209620

ZANE RIHAN
zane.rihan@ip-cre.com
858.205.7376
Lic. #02218149

