

# OFFICE FOR LEASE

701 N SHORELINE BLVD, MOUNTAIN VIEW, CA



*±1,623, 1,803 or 3,426 SF Office For Lease on N Shoreline Blvd*

Shower, kitchen, break room, and great window line

4/1,000 parking

Close to Caltrain, Hwy 101 & 85 and many amenities

New improvements, coffee bar

Flexible floor plan

Full balcony and mature landscaping

Full Commission

**DAVE GEISSBERGER**

408.588.2338

dave.geissberger@kidder.com

LIC N° 01401887

**KIDDER.COM**

This information supplied herein is from sources we deem reliable. It is provided without any representation, warranty, or guarantee, expressed or implied as to its accuracy. Prospective Buyer or Tenant should conduct an independent investigation and verification of all matters deemed to be material, including, but not limited to, statements of income and expenses. Consult your attorney, accountant, or other professional advisor.



# SECOND FLOOR

*±1,623 SF*

SUITE 3

*±1,803 SF*

SUITE 4

*±3,426 SF*

SUITES 3 & 4 COMBINED

## DIVISIBLE FLOOR PLAN

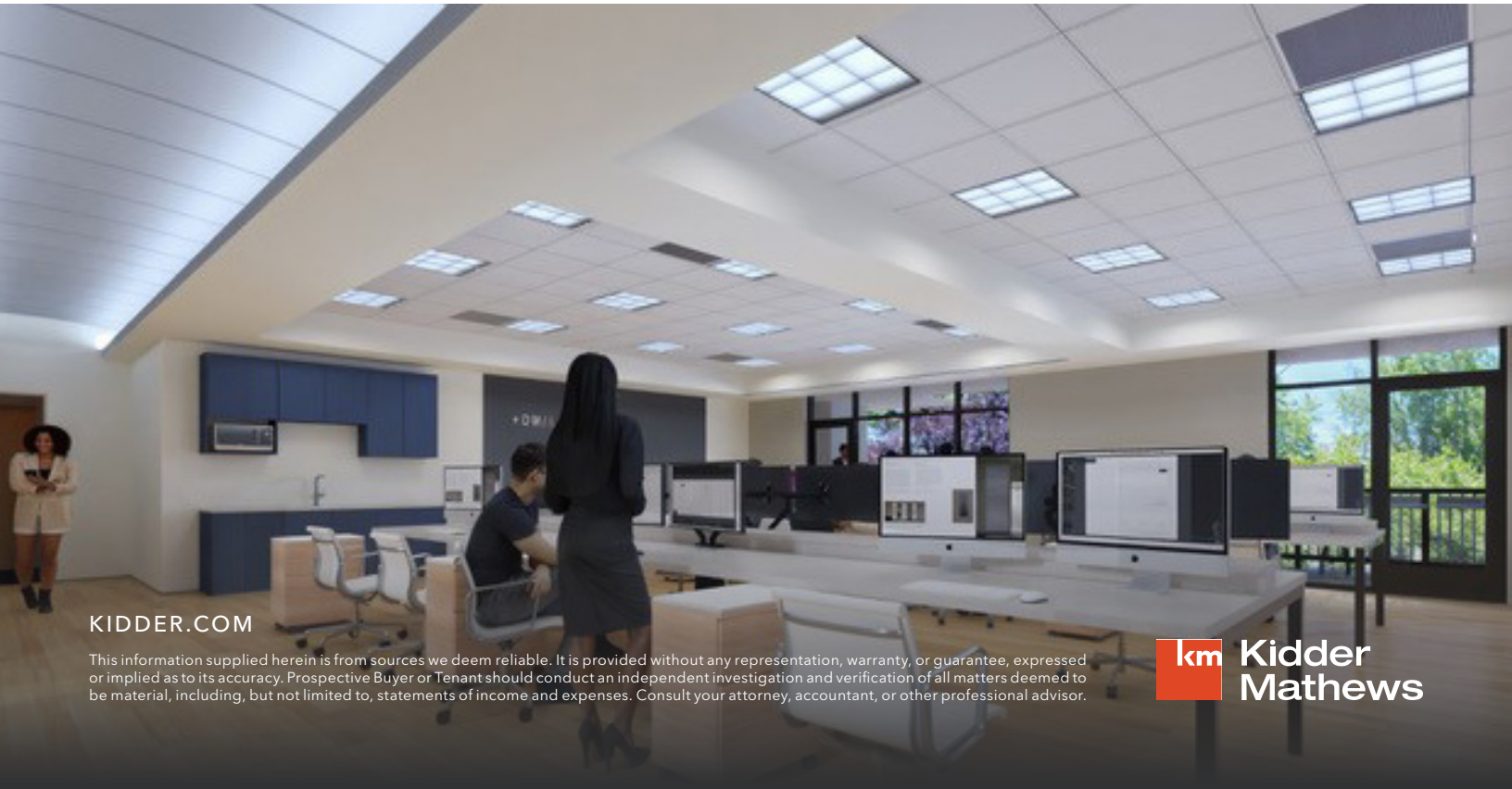
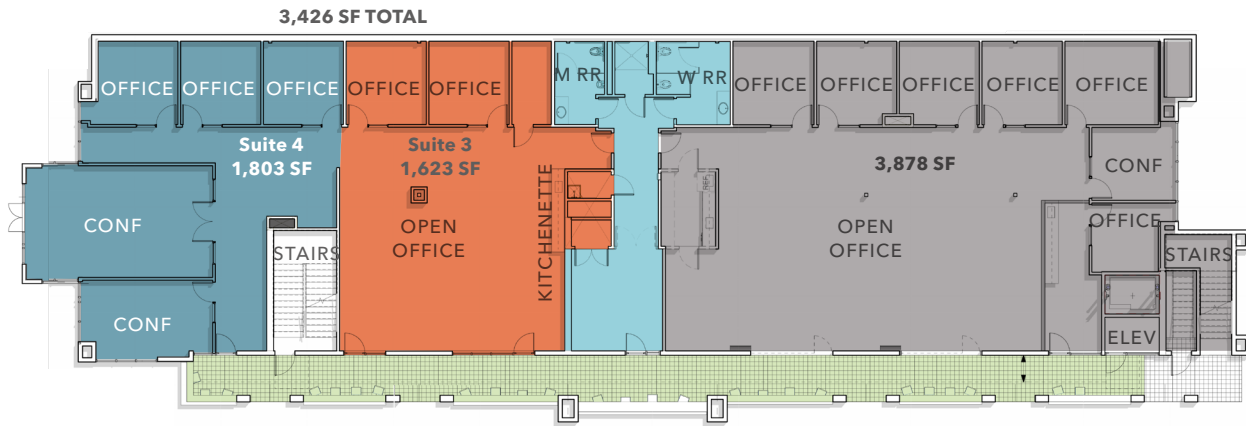

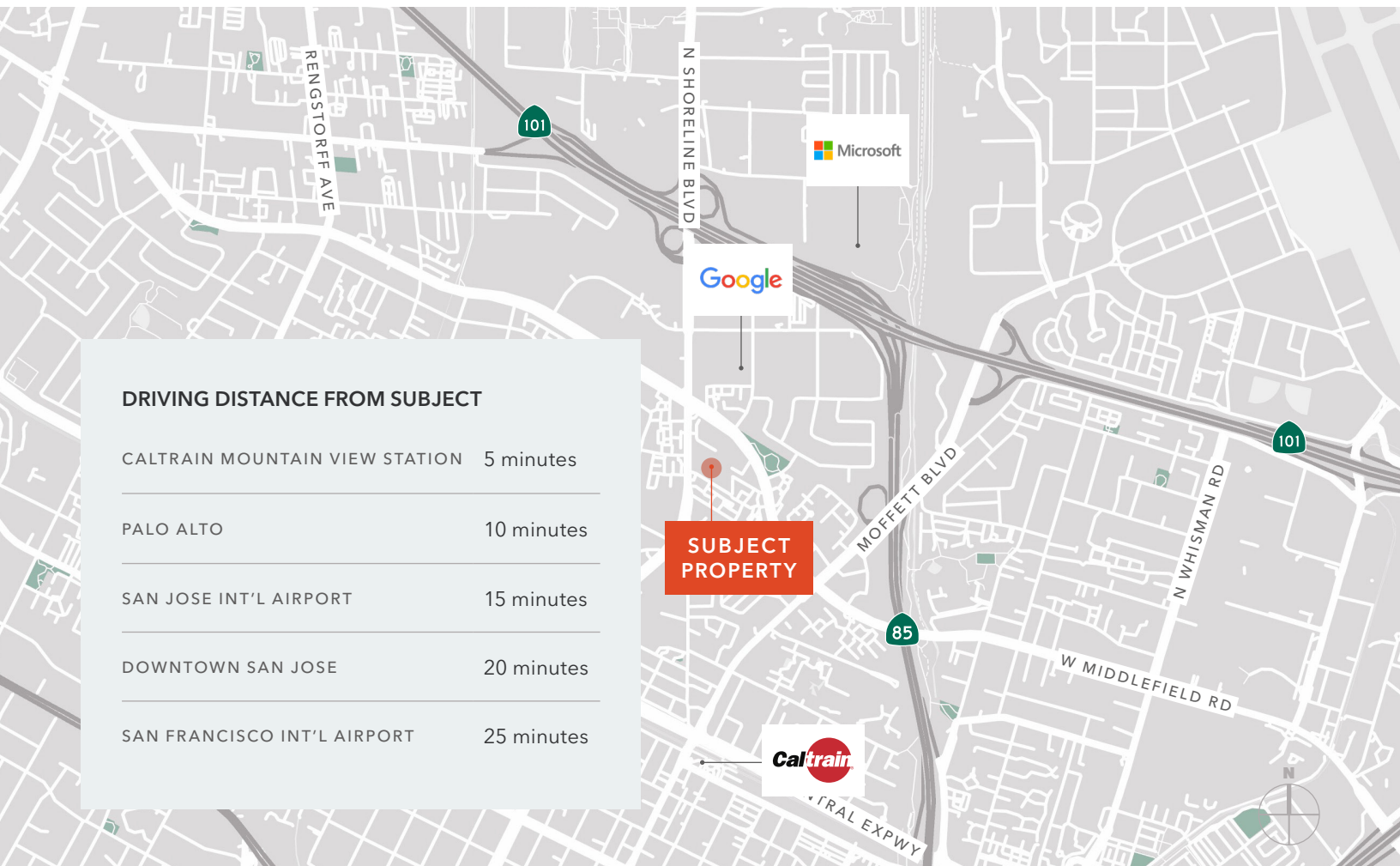

EAT + DRINK

- 01 Safeway
- 02 Momoya Sushi
- 03 Jack in the Box
- 04 Chef Zhao Bistro
- 05 Los Portales
- 06 Taqueria Tres Hermanos
- 07 Shana Thai

- 08 Chez TJ
- 09 Little Sheep Mongolian
- 10 Vaso Azzuro
- 11 Oren's Hummus
- 12 Bushido
- 13 Asian Box
- 14 Doppio Zero

- 15 Blue Line Pizza
- 16 Eureka!
- 17 Fiesta Del Mar Too
- 18 Don Giovanni
- 19 Bonchon Chicken
- 20 Crepevine
- 21 Sushi Tomi

