

2ND GENERATION RESTAURANT SPACE FOR LEASE

Rosecrans Corridor in El Segundo/Manhattan Beach

2041 Rosecrans Avenue, Suite 120, El Segundo, CA 90245

AVAILABLE: 6,948 SF + 2,148 SF EXCLUSIVE PATIO

PERFECT FOR AN OPERATOR THAT WANTS A TRADITIONAL SIT DOWN RESTAURANT

CINEMA WEST 16 SCREEN MOVIE THEATER LOCATED AT ENTRANCE TO RESTAURANT



Los Angeles
Sparks
Headquarters
and Training
Facility
Under
Construction
Scheduled to
Open 2027!
Adjacent
to Site

FOR ADDITIONAL INFORMATION, PLEASE CONTACT:

Maryl (Haire) Binney

Lic. 01357931 | Phone: 310-379-2228 ex 4
maryl@highlandpartnerscorp.com



Dave Binney

Lic. 01092524 | Phone: 310-670-1310 ex 2
dbinney@cypress.net



AVAILABLE:

2041 Rosecrans Avenue, Suite 120, Segundo, CA 90245

6,948 SF + 2,148 SF EXCLUSIVE PATIO



Located on Rosecrans, a major thoroughfare on the border of El Segundo and Manhattan Beach, accommodating numerous corporate offices, including Continental Park with 10,000+ employees.



Abundant parking with on-grade parking and parking structure.



Cinema West Movie Theater, a luxury 16-screen cinema featuring three premium-format screens, opened last summer at the entrance to the restaurant district.



Los Angeles Sparks is building a 55,000-square-foot, state-of-the-art training and practice facility in El Segundo, opening in 2027 adjacent to site.



In close proximity to the Manhattan Country Club, Top Golf, MBS Media Campus, The Bay Club, and the Los Angeles Chargers Headquarters & Training Facility, drawing customers seeking dining options in the area.



Positioned alongside established restaurants including Eddie V's, Flemings, Fogo de Chao, North Italia, and Calo Kitchen & Tequila and more!



There are approximately 1,200-1,500 residential units in 3 proposed developments on Rosecrans Avenue directly across from this site



Monument Signage on Rosecrans Ave & Signage on Nash St.

2041 Rosecrans Avenue, Suite 120, El Segundo, CA 90245

AVAILABLE:

TENANT 1 SIGNAGE 6,948 SF + 2,148 SF EXCLUSIVE PATIO



Tenant 1 Signage

- 1 Logo on East/West sides of monument sign on Rosecrans Avenue
- 3 Wall Graphic on Nash Street Building Facade
- 5 Sign on High-level Building Facade

Demographics

2025 Estimates



POPULATION

1 Mile	11,081
3 Miles	205,662
5 Miles	491,738



AVERAGE HH INCOME

1 Mile	\$284,375
3 Miles	\$190,217
5 Miles	\$161,043



DAYTIME POPULATION

1 Mile	20,339
3 Miles	109,129
5 Miles	222,539



TRAFFIC COUNTS

Rosecrans Ave: 65,769 CPD
Sepulveda Blvd: 97,751 CPD
Aviation Blvd: 60,002 CPD

Demographic Source: Applied
Geographic Solutions 05/2025,
TIGER Geography

Traffic Count Source: Inrix 2023

2ND GENERATION RESTAURANT SPACE FOR LEASE
6,948 SF + 2,148 SF EXCLUSIVE PATIO



AVAILABLE:

6,948 SF + 2,148 SF EXCLUSIVE PATIO

2041 Rosecrans Avenue, Suite 120,
El Segundo, CA 90245

SITE PLAN

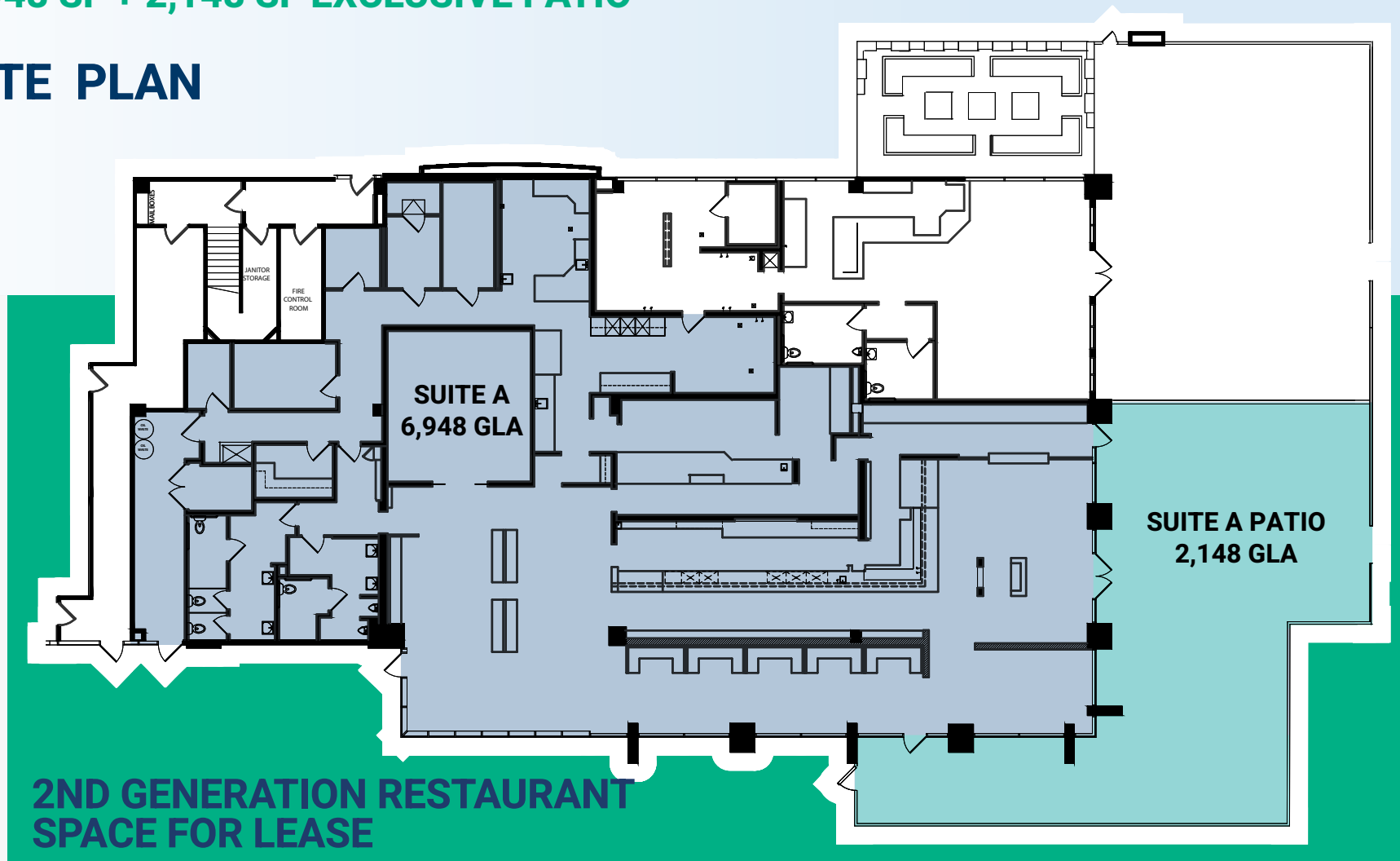

**2ND GENERATION RESTAURANT
SPACE FOR LEASE**

Maryl (Haire) Binney

Lic. 01357931

Phone: 310-379-2228 ex 4

maryl@highlandpartnerscorp.com

Highland Partners Corp.

www.highlandpartnerscorp.com

880 Apollo Street, Suite 329

El Segundo, CA 90245



Dave Binney

Lic. 01092524

Phone: 310-670-1310 ex 2

dbinney@cypress.net

Cypress Retail Group

www.cypress.net

1334 Park View Ave

Manhattan Beach, CA 90266



© 2025 | Highland Partners Corp. | The information being provided by Highland Partners Corp. and/or its sources is deemed reliable. While we have no reason to doubt its accuracy, we do not guarantee it. Any information, measurements, facts and actual drawings shown are approximate, subject to change, or withdrawal without notice and should be independently verified by you and may not be relied upon as a precise representation by this office. No warranties or representations are made as to the condition of the property or any hazards contained therein or any to be implied. Logos are for identification purposes only and may be trademarks of their respective companies. 2041RosecransAve_Ste120_BRO_v04.indd|01|12|26

2ND GENERATION RESTAURANT SPACE FOR LEASE

Rosecrans Corridor in El Segundo/Manhattan Beach

2041 Rosecrans Avenue, Suite 120, El Segundo, CA 90245



© 2025 | Highland Partners Corp. | The information being provided by Highland Partners Corp. and/or its sources is deemed reliable. While we have no reason to doubt its accuracy, we do not guarantee it. Any information, measurements, facts and actual drawings shown are approximate, subject to change, or withdrawal without notice and should be independently verified by you and may not be relied upon as a precise representation by this office. No warranties or representations are made as to the condition of the property or any hazards contained therein nor any to be implied. | Logos are for identification purposes only and may be trademarks of their respective companies. 2041 Rosecrans Ave_Ste120_BRO_v04.indd | 01/12/26

Maryl (Haire) Binney

Lic. 01357931
Phone: 310-379-2228 ex 4
maryl@highlandpartnerscorp.com

Highland Partners Corp.
www.highlandpartnerscorp.com
880 Apollo Street, Suite 329
El Segundo, CA 90245



Dave Binney

Lic. 01092524
Phone: 310-670-1310 ex 2
dbinney@cypress.net

Cypress Retail Group
www.cypress.net
1334 Park View Ave
Manhattan Beach, CA 90266

