

NOTES:  
NO RECORDS SEARCH CONTRACTED.  
SURVEY PREPARED FROM TITLE  
COMPANY SPECIFICATIONS. CLIENT  
RELIES SOLELY ON TITLE COMPANY  
SPECIFICATIONS AS TO RECORD EASEMENTS,  
RESTRICTIONS, ROADWAYS, RIGHTS-OF-WAY,  
BUILDING LINES, ENCUMBRANCES, ETC.;  
CLIENT AND TITLE COMPANY HOLD  
TLTS, INC. HARMLESS FROM RESPONSIBILITY  
FOR SAME

- Restrictions as per recorded plat unless otherwise noted
- True ground distances shown
- Bearings assumed as platted
- Vol 1959, Pg 476, OCCGC
- :25' street setback line
- :7-1/2' setback all lines
- Survey monuments reconciled with previous surveys of 4, 11, 12 & 13

Scale: 1" = 40'  
20 Feet 0 20 40 60

LAND TITLE SURVEY OF A TRACT OF LAND being Lot 1 and the North 42.51 feet of Lot 2, of PORT INDUSTRIAL SITES, a subdivision in Galveston County, Texas, according to the map or plat thereof recorded in Volume 8, Page 8 and transferred to Volume 1616, Page 175 both in the Office of the County Clerk of Galveston County, Texas.

Subject property: 8017 Harborside Drive  
Galveston County, Texas  
This survey is certified for this transaction only and may only be relied on by Blaskey 8017, LLC, Moody National Bank and South-Land Title Co., GF #GV1967030. This survey is only valid if print has original seal and signature of surveyor.  
I hereby certify that this survey was made on the ground under my direct supervision and that this plat correctly represents the facts found at the time of the survey.

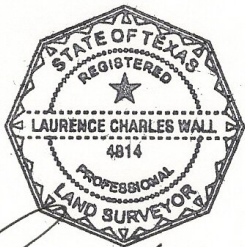

Laurence C. Wall  
RPLS #4814  
April 22, 2019