

EXCLUSIVE LISTING!

3.23 +/- Acres Land in Downtown Las Vegas 89106
Listed for \$7,900,000

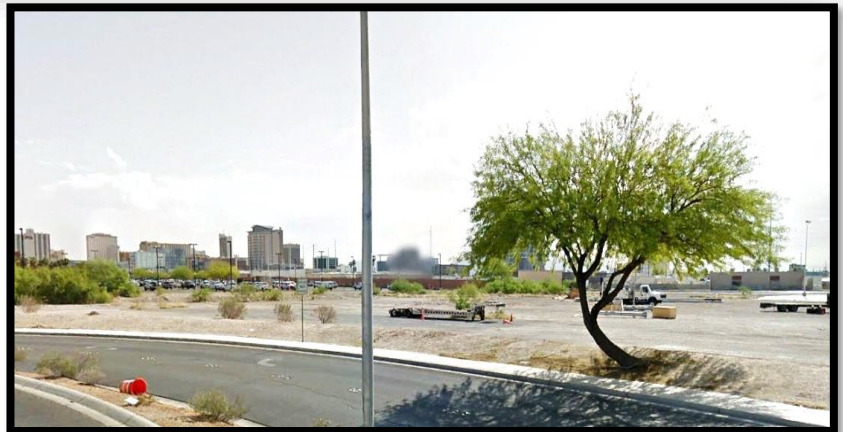

- ❖ APN # 139-33-810-007/ 008
- ❖ 3.23 +/- Acres land
- ❖ Zoned PD-Planned Development – near Downtown Las Vegas
- ❖ City of Las Vegas jurisdiction
- ❖ Close to Symphony Park, Smith Center, Premium Outlet Mall, Clark County Government Center, Arts District
- ❖ 2024/25 Taxes: \$33,464.78 + \$90.91
- ❖ Improved road with lights, sidewalks.



Mark Anthony Rua
Brokers

S.026655

Office: 702-992-7534
Cell: 702-595-6244

2855 St Rose Parkway, Suite 100, Henderson, NV 89052
markanthonyrua@gmail.com www.mrlandlasvegas.com



The information contained herein is subject to verification and no liability for errors or omissions is assumed. The price, data, and other information are subject to change or the listing may be withdrawn without notice.

3.23 +/- Acres Land in Downtown Las Vegas 89106



Mark Anthony Rua
Brokers

2855 St Rose Parkway, Suite 100, Henderson, NV 89052
markanthonyrua@gmail.com www.mrlandlasvegas.com

Office: 702-992-7534
Cell: 702-595-6244



3.23 +/- Acres Land in Downtown Las Vegas 89106

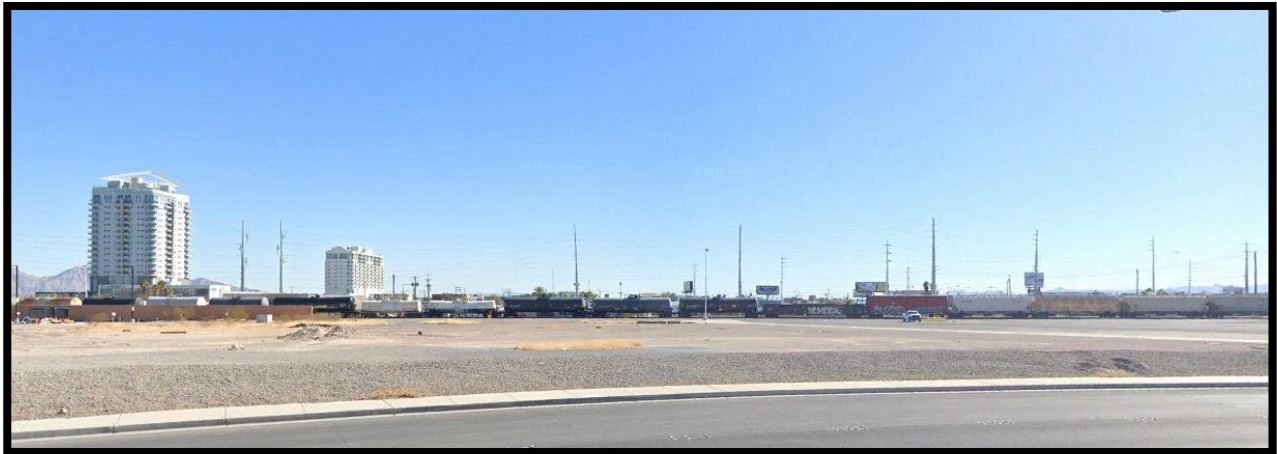

Mark Anthony Rua
Brokers

2855 St Rose Parkway, Suite 100, Henderson, NV 89052
markanthonyrua@gmail.com www.mrlandlasvegas.com

Office: 702-992-7534
Cell: 702-595-6244





3.23 +/- Acres Land in Downtown Las Vegas 89106



Mark Anthony Rua
Brokers

2855 St Rose Parkway, Suite 100, Henderson, NV 89052
markanthonyrua@gmail.com www.mrlandlasvegas.com

Office: 702-992-7534
 Cell: 702-595-6244



The information contained herein is subject to verification and no liability for errors or omissions is assumed. The price, data, and other information are subject to change or the listing may be withdrawn without notice.