

# ULANA

WARD VILLAGE





## ULANA INDUSTRIAL SPACE

Introducing a premier development opportunity in the vibrant Kakaako district! Envision your business thriving in a state-of-the-art warehouse designed to meet your specific needs.

Ulana Ward Village will feature 2 floors of prime warehouse and flex space options. Users will have the ability to customize units to meet unique business needs, with flexibilities in size range and space use. Whether you need specialized storage, a distribution center, or a creative studio, this development can be tailored to your vision. It's the ideal development for businesses in the hospitality, retail or food industries servicing the surrounding Kaka'ako, Waikiki, Ala Moana and Downtown submarkets.

Situated just minutes from Waikiki, this facility offers unbeatable access to major highways, ports, and downtown Honolulu. Located in a thriving commercial hub that ensures seamless logistics and operations with high visibility. Elevate your business and capitalize on this rare opportunity!

### FEATURES & BENEFITS

- Ground level and second floor units
- Common loading zones
- Camera and roving security
- With flexibilities in size range and space use, units are customizable to meet unique business needs
- Highly desired central location with an industrial inventory of less than 1%

### \*ULANA RETAIL SPACE

**P101 | 1,853 SF** - includes 617 SF of unbuilt Mezzanine area\*\*

**P102 | 805 SF** - includes 268 SF of unbuilt Mezzanine area\*\*

**P103 | 864 SF** - includes 288 SF of unbuilt Mezzanine area \*\*

**P104 | 2,100 SF** - includes 699 SF of unbuilt Mezzanine area\*\*

\*\* available for tenant build-out.



## IDEAL USERS

### RETAIL

- Showroom/storage of products (clothing, jewelry, etc.)
- Creative studio for manufacturing
- Indoor design / staging
- Home improvement

### FOOD

- Food prep, packaging and storage
- Satellite cold storage

### HOSPITALITY

- Janitorial
- Maintenance
- Laundry / Dry Cleaning

## PROPERTY HIGHLIGHTS

Address	820 Auahi Street Honolulu, HI
TMK	(1) 2-1-053-001:0000
Zoning	MUZ-R
Occupancy Date	Q4 2025
Available Spaces	1,794 - 10,619 SF
Base Rent	Negotiable
CAM	\$0.06 PSF/Mo
RPT	\$0.84 PSF/Mo
Term	5 - 10 Years

# Available Space

## GROUND FLOOR

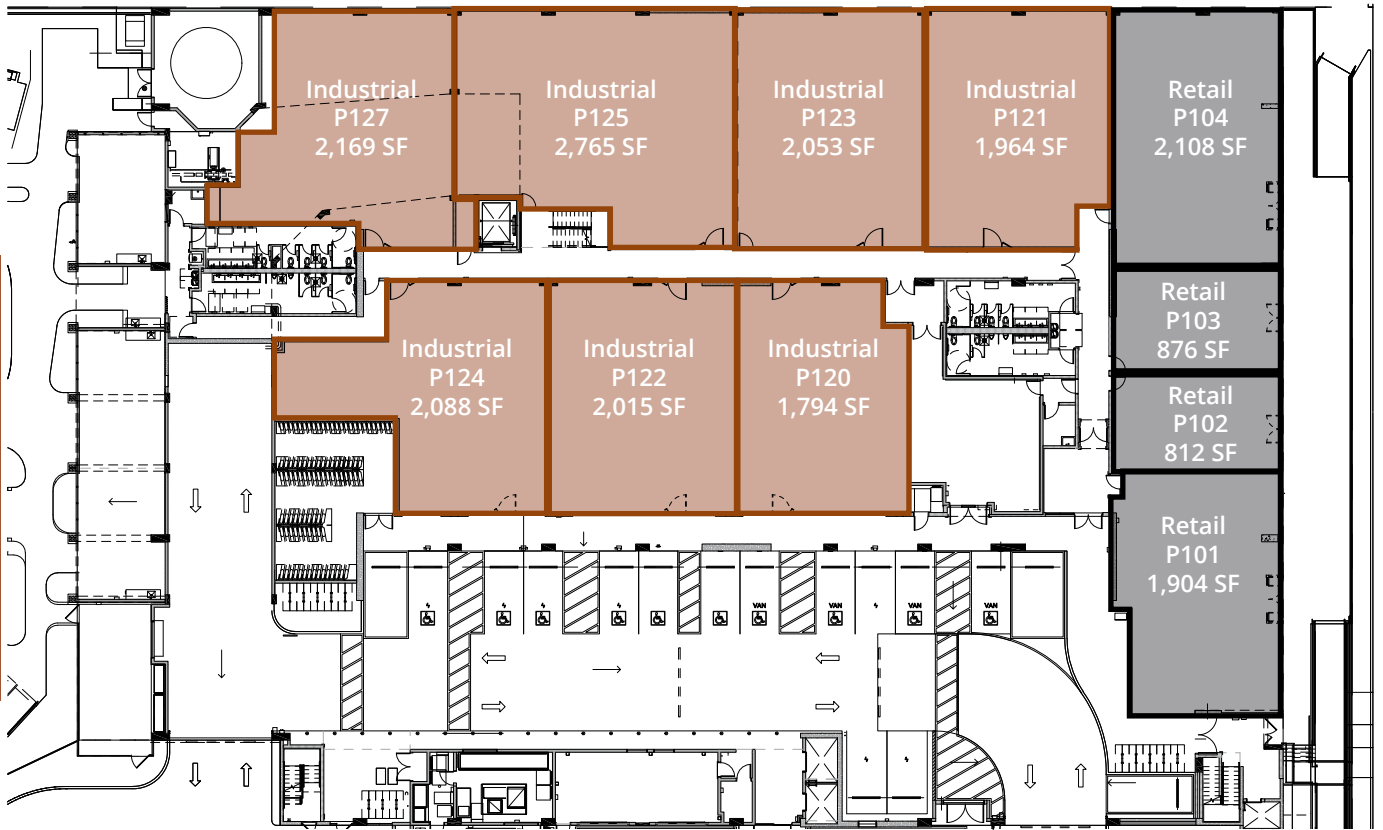

## SECOND FLOOR

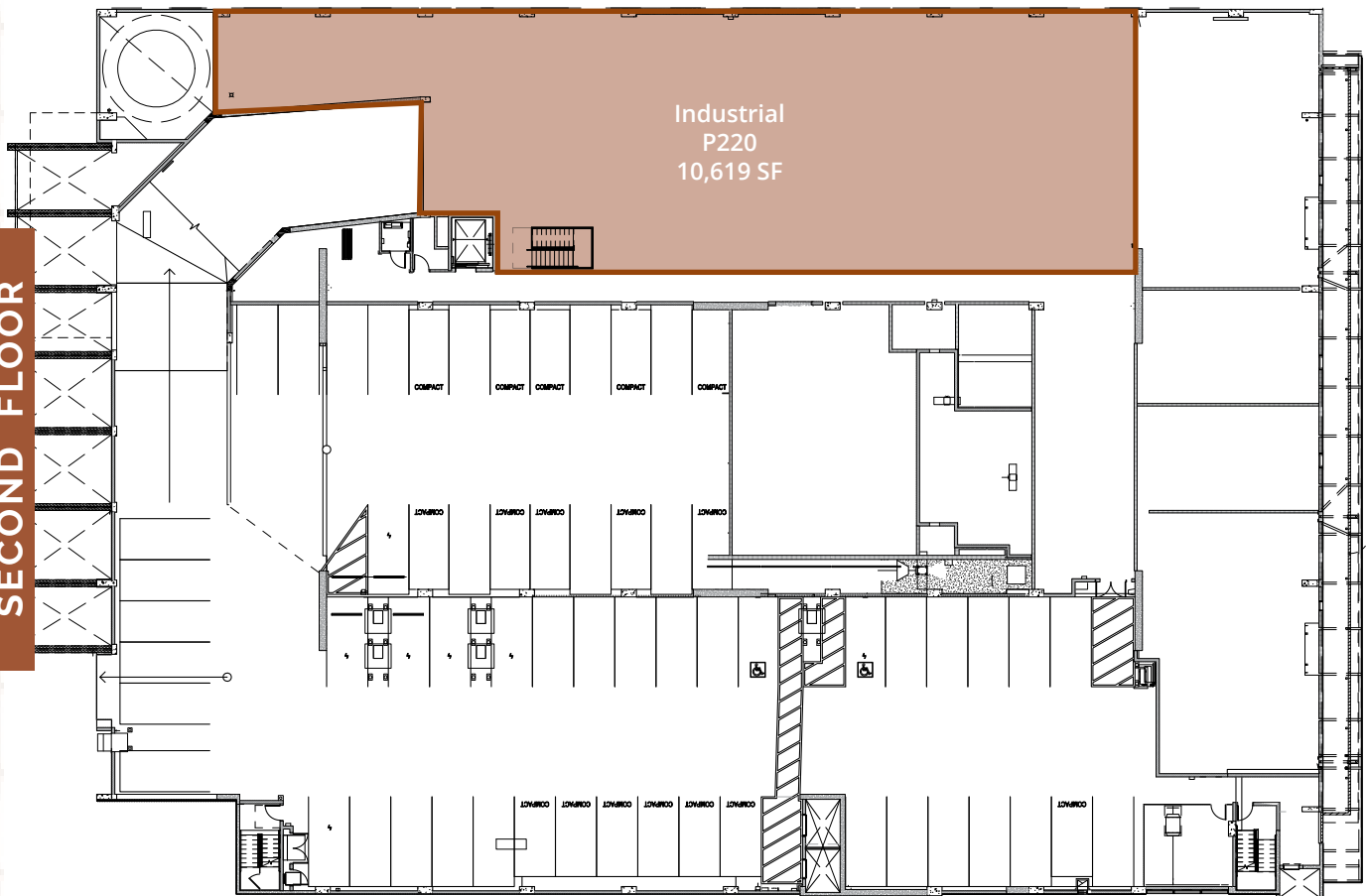



# WARD VILLAGE

*A vibrant neighborhood in the center of it all*

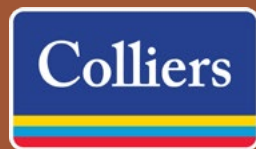
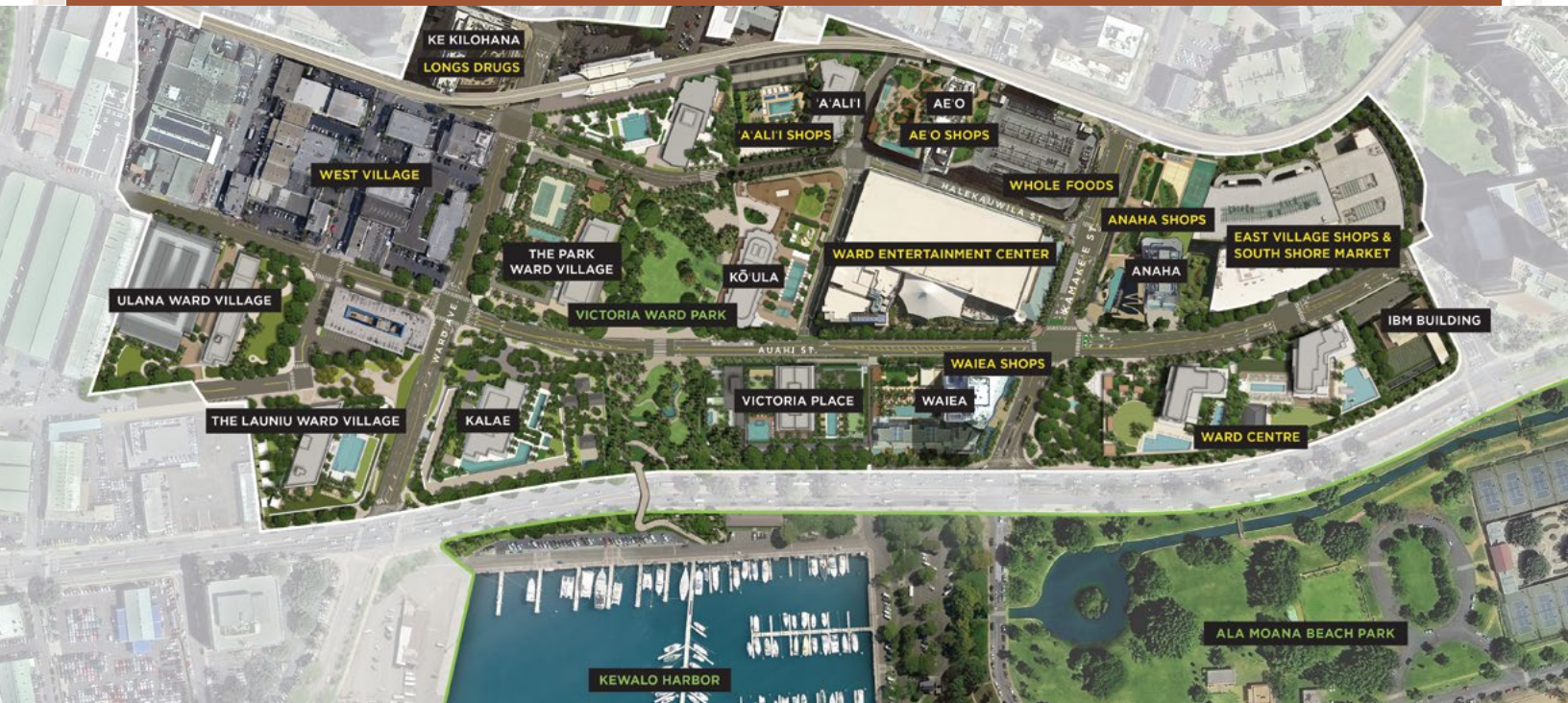

808 524 2666  
220 S. King St, Ste 1800 Honolulu, HI 96813  
colliers.com

## CONTACT US

**Emalia Pietsch (S)**

Lic# RS-70893

808 294 2053

emalia.pietsch@colliers.com

**Janna Frash (S)**

Lic# RS-80222

808 230 3794

janna.frash@colliers.com

This document/email has been prepared by Colliers for advertising and general information only. Colliers makes no guarantees, representations or warranties of any kind, expressed or implied, regarding the information including, but not limited to, warranties of content, accuracy and reliability. Any interested party should undertake their own inquiries as to the accuracy of the information. Colliers excludes unequivocally all inferred or implied terms, conditions and warranties arising out of this document and excludes all liability for loss and damages arising there from. This publication is the copyrighted property of Colliers and /or its licensor(s). © 2025. All rights reserved. This communication is not intended to cause or induce breach of an existing listing agreement.