



3959 N STEELE BLVD  
FAYETTEVILLE, AR

**FOR LEASE**

*Uptown Shoppes*

**U**  
**UPTOWN**  
FAYETTEVILLE



# OFFERING

## 3959 N STEELE BLVD | FAYETTEVILLE, AR

LEASE RATE:	\$24.00/SF + NNN
AVAILABLE RETAIL SPACE	Space 1 - 2,000 SF remaining Space 2 - 2,185 SF remaining
PROPERTY TYPE:	Retail / Office
LOCATION:	Uptown, North Fayetteville
PARKING:	On Site & Street parking
TENANT IMPROVEMENTS:	Negotiable
YEAR COMPLETED:	2018

### FEATURES

- Situated at the high-traffic intersection of E Joyce Blvd & Steele Blvd, benefiting from 24,000 VPD (vehicles per day).
- Located near MALCO Theater, which attracts 650,000 patrons annually, boosting customer exposure.
- Within a 1-mile radius, the area boasts 3,023 residents, 10,231 daytime workers, and an average household income of \$90,553.
- Surrounded by 1,357 housing units, ensuring a steady flow of local shoppers and potential clientele.







# OFFERING

3959 N STEELE BLVD | FAYETTEVILLE, AR

*Uptown Shoppes*

The center piece of North Fayetteville, Uptown Fayetteville Shoppes offers **two prime retail or office spaces** in a vibrant setting centered around a modern courtyard with an expansive property focused on community. Surrounded by top attractions like Malco Theater, Northwest Arkansas Mall, and Razorback Greenway, it provides easy access to Lake Fayetteville, Botanical Gardens, and Washington Regional Hospital.

With over **1,357 residential units nearby**, businesses benefit from strong foot traffic and seamless connections by foot, trail, or highway. Nearby major retailers include Target, Walmart, and Home Depot, along with corporate hubs like Procter & Gamble. Uptown Fayetteville Shoppes is the ideal location to explore, gather, and grow your business..





*Uptown Shoppes*

# COMMUNITY PHOTOS

3959 N STEELE BLVD | FAYETTEVILLE, AR

Uptown Fayetteville is a thriving hub for businesses, surrounded by vibrant dining, shopping, and entertainment. With easy access to major employers, top-rated schools, and the University of Arkansas, it attracts a steady flow of customers. Scenic parks, modern amenities, and a connected community make it an ideal spot to grow your business.

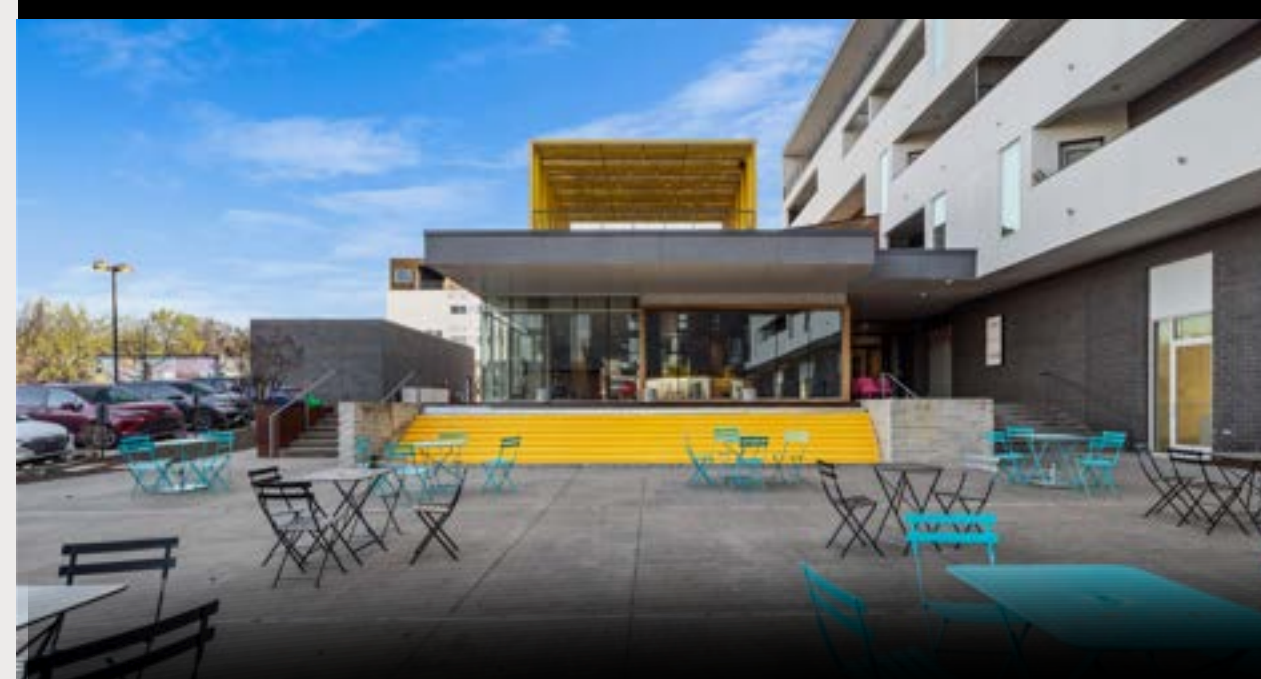



# SITE MAP

3959 N STEELE BLVD | FAYETTEVILLE, AR





# AERIAL VIEW

3959 N STEELE BLVD | FAYETTEVILLE, AR

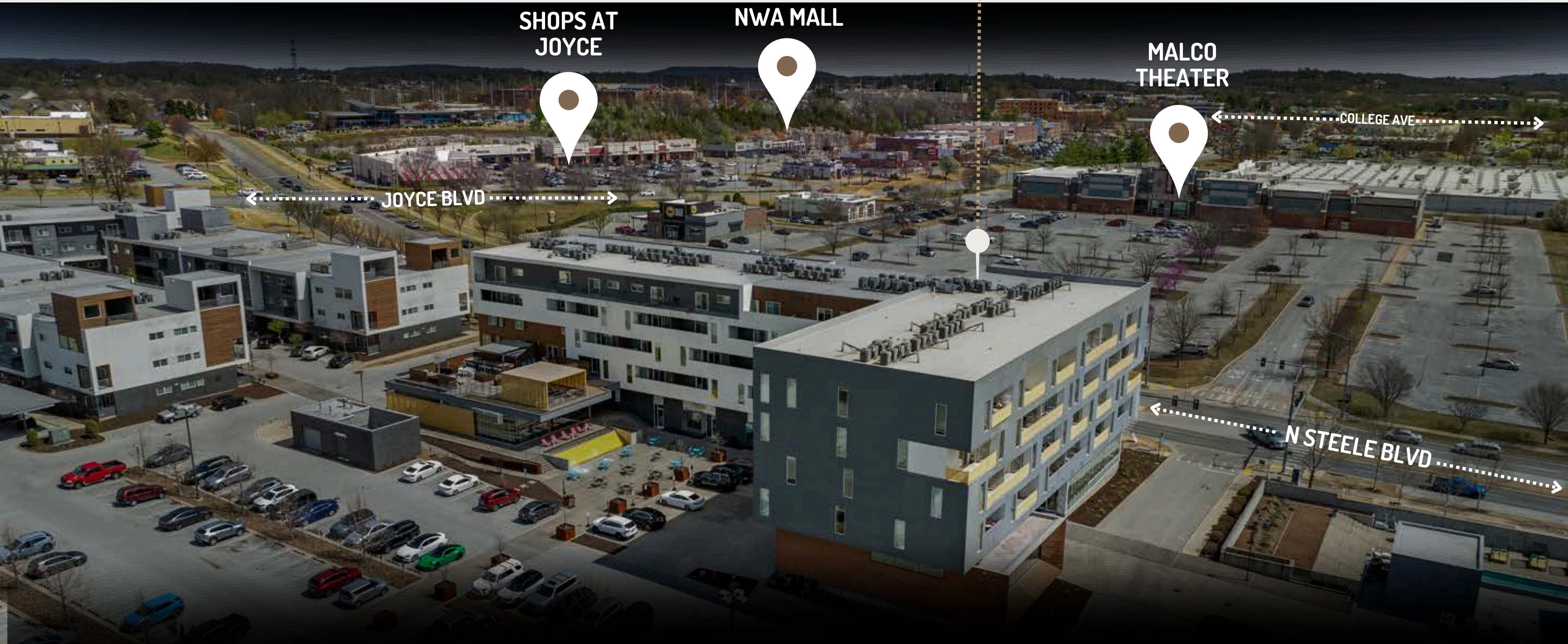

UPTOWN  
FAYETTEVILLE

SHOPS AT  
JOYCE

NWA MALL

MALCO  
THEATER

JOYCE BLVD

COLLEGE AVE

N STEELE BLVD

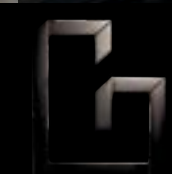



# AERIAL VIEW

3959 N STEELE BLVD | FAYETTEVILLE, AR

WALMART  
SUPERCENTER

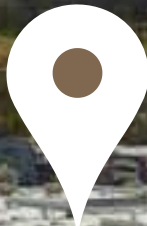

ACADEMY  
SPORTS

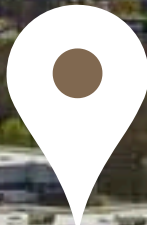

HYATT PLACE  
HOTEL

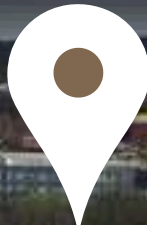

WATERMARK AT  
STEELE CROSSING

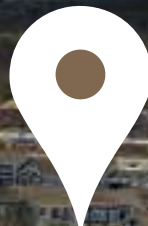

UPTOWN  
FAYETTEVILLE

TARGET

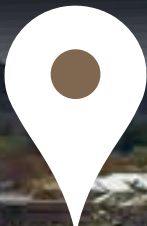

JJ'S LIVE  
MUSIC VENUE

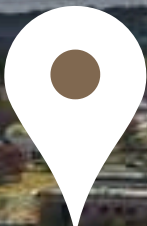

WASHINGTON  
REGIONAL  
MEDICAL  
CENTER

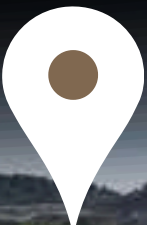



# AVAILABLE SUITES

3959 N STEELE BLVD | FAYETTEVILLE, AR

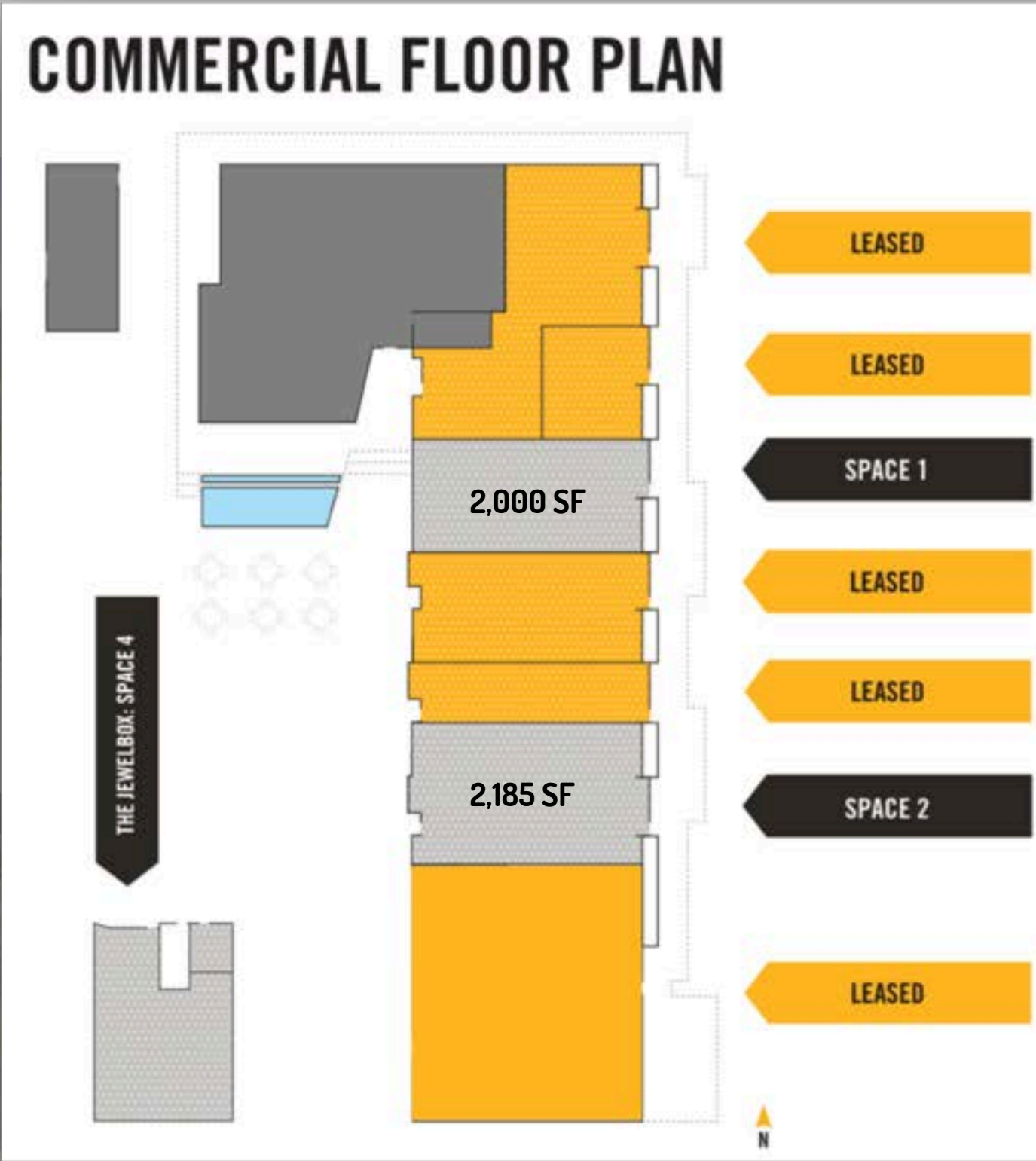





*Uptown Shoppes*



**ZACK KIFER**  
PRINCIPAL

(479) 387-2156  
KIFER@GENESISCRE.COM



**GAVIN MAGEE**  
BROKERAGE ASSOCIATE

(913) 449-6223  
GAVIN@GENESISCRE.COM



**SAID MAYORGA**  
BROKERAGE ASSOCIATE

+ 501-593-7139  
SAID@GENESISCRE.COM



**DISCLOSURE:** Genesis Commercial Real Estate has been engaged by the owner of the Property to market it for sale or lease. Information concerning the Property has been obtained from sources other than Genesis Commercial Real Estate and we make no representations or warranties, express or implied, as to the accuracy or completeness of such information. Any references to age, square footage, income, expenses and any other Property specific information are approximate. Any opinions, assumptions, estimates, or financial information contained herein are projections only and are provided for illustrative purposes and may be based on assumptions or due diligence criteria different from that used by a purchaser. Buyers should conduct their own independent investigation and inspection of the Property in evaluating a possible purchase. The information contained herein is subject to change.