

# GREENSBURG SHOPPING CENTER



E. Pittsburgh St & Highland Ave  
Greensburg, PA 15601



## Highlights

Major tenants include O'Reilly Auto Parts, Lighting Gallery and Precision Care Pharmacy

High traffic, well-established neighborhood shopping center centrally located

Property Acreage: 8 acres  
Total Square Footage: 79,383  
Parking Spaces: 350



[www.unionrealestate.com](http://www.unionrealestate.com)  
412-288-7800

**Ed Kernisky** | Senior Vice President  
[ekernisky@unionrealestate.com](mailto:ekernisky@unionrealestate.com)

**Joe Hodson** | Vice President - Commercial Leasing  
[jbhodson@unionrealestate.com](mailto:jbhodson@unionrealestate.com)

One Oxford Centre | 301 Grant Street | Suite 1250 | Pittsburgh, PA 15219

PROPERTY MANAGEMENT • BROKERAGE SERVICES • THIRD-PARTY MANAGEMENT • TENANT REPRESENTATION

All information is deemed reliable, but is not guaranteed and should be independently verified. The presentation of this information is submitted subject to errors, omissions, change of price or conditions prior to lease.



**GREENSBURG SHOPPING CENTER**  
 E. Pittsburgh Street & Highland Avenue  
 Greensburg, Westmoreland County

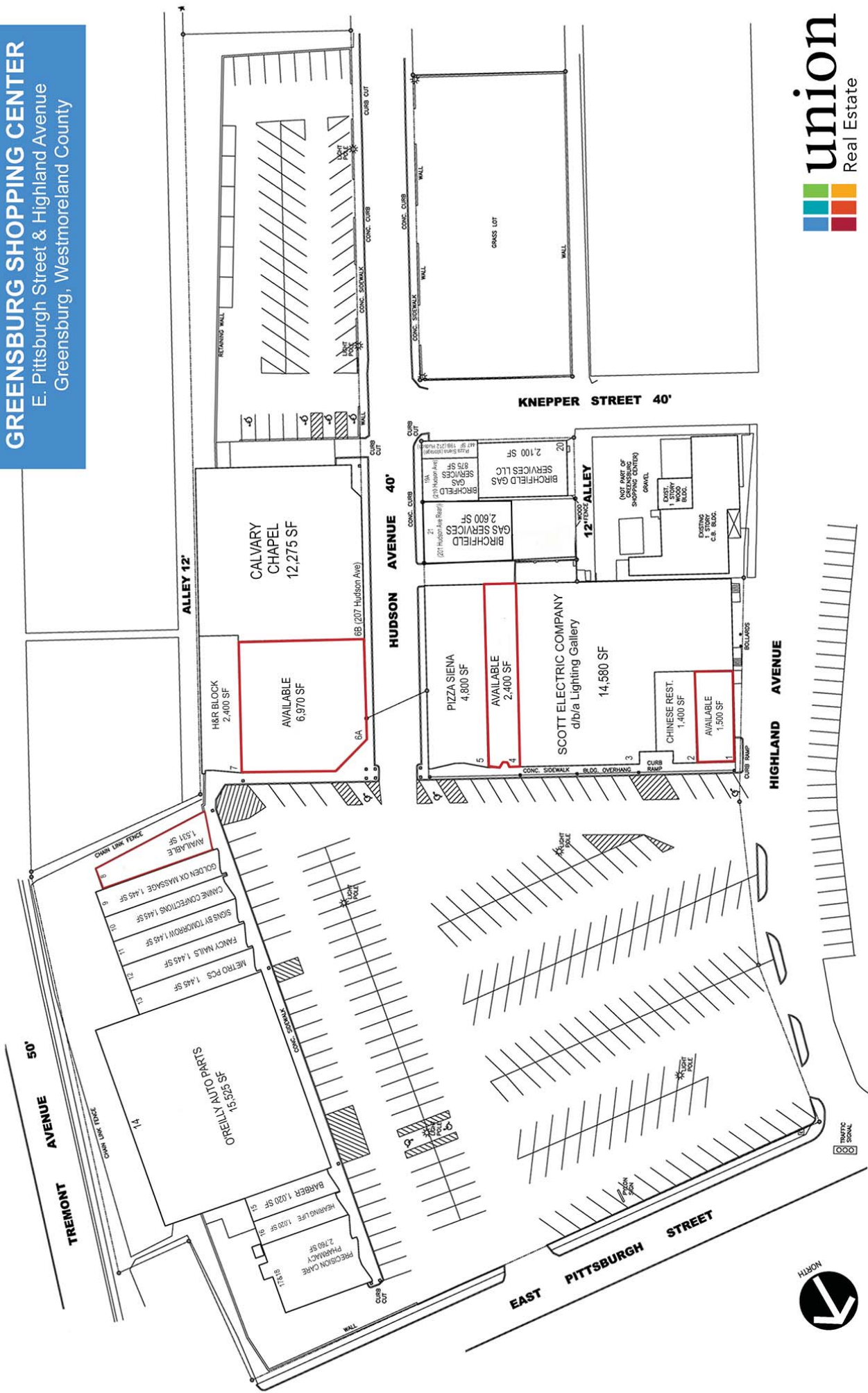

411-288-7800 | www.unionrealestate.com

