

# 1 E Uwchlan Avenue

Exton, Pennsylvania

81,400 SF Office Building  
Suites Available from 828 – 9,947 SF



## FEATURES

+ Availabilities:

- 1st Floor – 828 SF
- 3rd Floor – 2,383 SF & 5,006 SF (7,389 SF Contiguous)
- 3rd Floor – 1,485 SF & 2,544 SF (4,029 SF Contiguous)
- 4th Floor – 1,590 SF
- 4th Floor – 9,947 SF

+ Recently renovated common areas

+ 24/7 Grab & Go Food Service on the first floor

+ 4/1,000 parking ratio

+ On-Site property management

+ Less than a mile from the PA Turnpike. Routes 100, 113, 202, 401, 322 and 30 are all nearby for convenient access throughout the region.

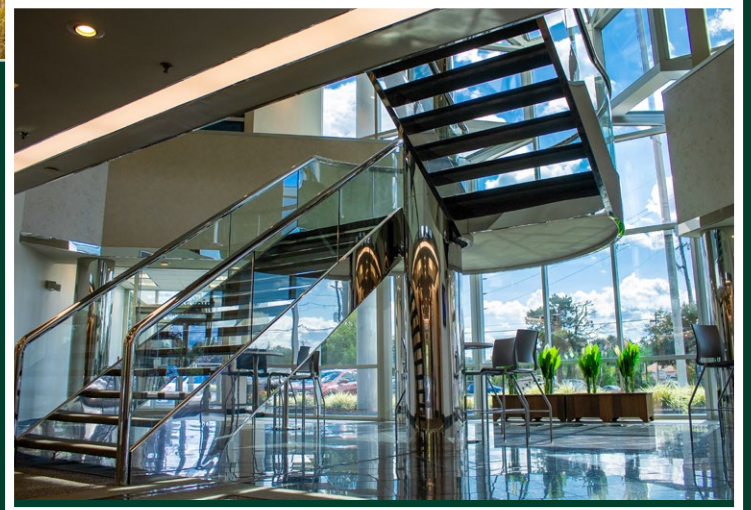



## Contact Us

**STEPHEN J. GERSBACH**  
First Vice President  
+1 610 251 5138  
steve.gersbach@cbre.com  
Licensed: PA

**TIM MORRIS**  
First Vice President  
+1 610 639 6756  
tim.morris1@cbre.com  
Licensed: PA

© 2024 CBRE, Inc. All rights reserved. This information has been obtained from sources believed reliable, but has not been verified for accuracy or completeness. You should conduct a careful, independent investigation of the property and verify all information. Any reliance on this information is solely at your own risk. CBRE and the CBRE logo are service marks of CBRE, Inc. All other marks displayed on this document are the property of their respective owners, and the use of such logos does not imply any affiliation with or endorsement of CBRE. Photos herein are the property of their respective owners. Use of these images without the express written consent of the owner is prohibited.