

FOR SUBLEASE

600 S Royal Lane
Office/Warehouse
43,782 SF AVAILABLE



600 S Royal Lane STE 150

Coppell, Texas 75019

Property Features:

- Sublease through 11/30/2024
- Approx +/-8,500 SF of Office
- 100% Sprinklered
- (5) 8' x 10' Dock Doors
- (1) Oversized Dock Door with a ramp
- 30' clear
- Easy access to 635 & 121

Tours by Appointment Only

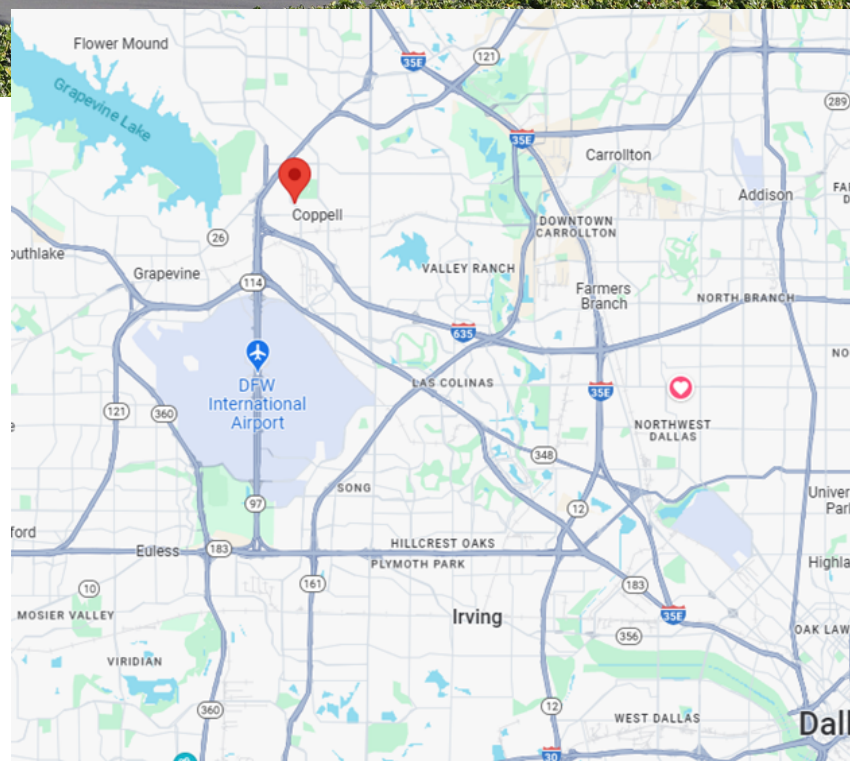

**DAVID RODIN
GARRETT GOLDSTEIN
RICH YOUNG, JR - SIOR**
972.236.7645

DAVID@RICHYOUNGCOMPANY.COM
GARRETT@RICHYOUNGCOMPANY.COM
RICHJR@RICHYOUNGCOMPANY.COM



43,728 SF
Office/Warehouse
Available

600 S Royal Lane Suite 150

Coppell, Texas 75019



THE INFORMATION CONTAINED HEREIN HAS BEEN GIVEN TO US BY THE OWNER OF THE PROPERTY OR OTHER SOURCES WE DEEM RELIABLE. WE HAVE NO REASON TO DOUBT ITS ACCURACY, BUT WE DO NOT GUARANTEE IT. ALL INFORMATION SHOULD BE VERIFIED PRIOR TO PURCHASE OR LEASE.

43,728 SF
Office/Warehouse
Available

600 S Royal Lane Suite 150

Coppell, Texas 75019

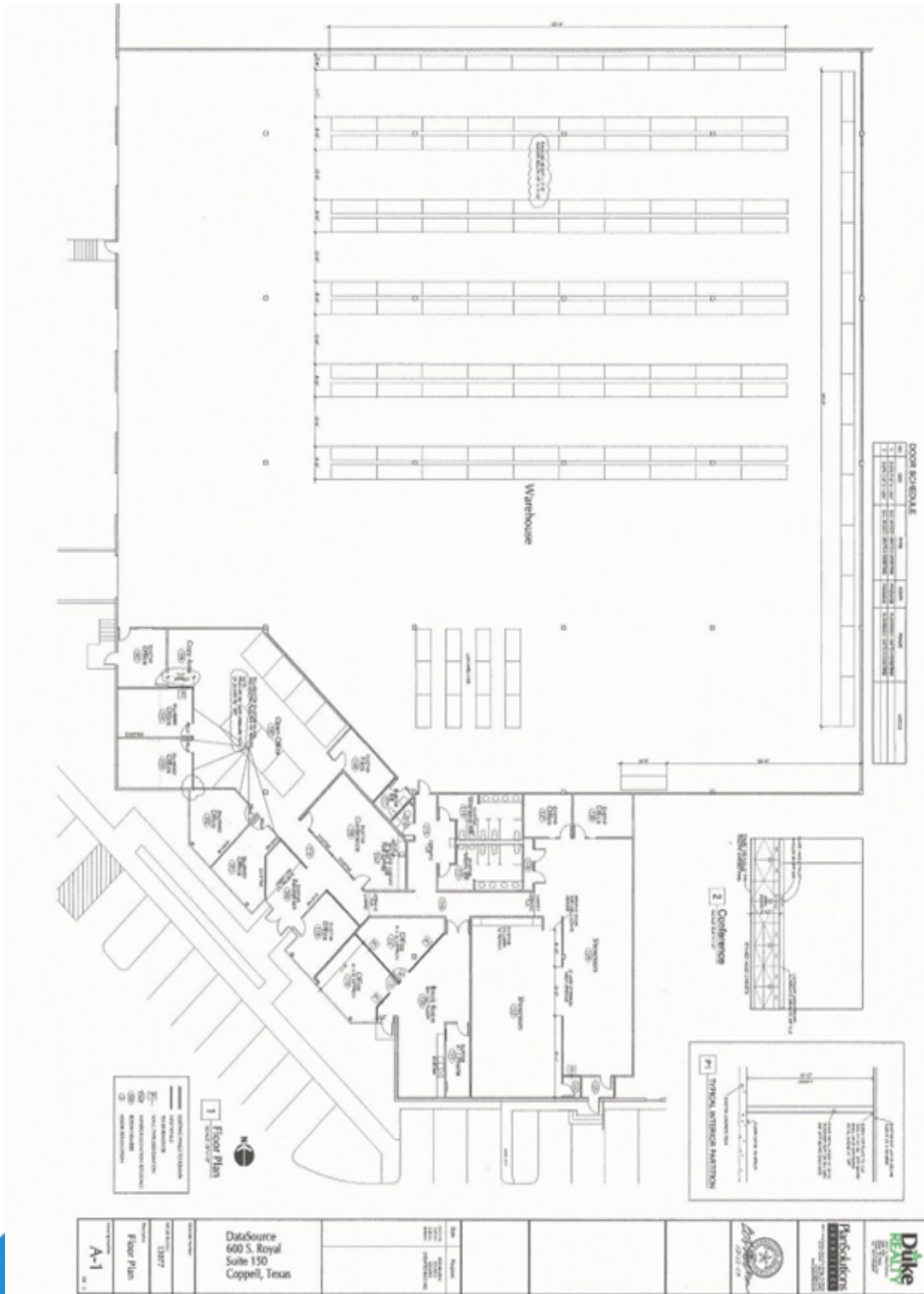

THE INFORMATION CONTAINED HEREIN HAS BEEN GIVEN TO US BY THE OWNER OF THE PROPERTY OR OTHER SOURCES WE DEEM RELIABLE. WE HAVE NO REASON TO DOUBT ITS ACCURACY, BUT WE DO NOT GUARANTEE IT. ALL INFORMATION SHOULD BE VERIFIED PRIOR TO PURCHASE OR LEASE.