

# 330 Hollie Drive

Located in North Bowles Industrial Park

330 Hollie Drive  
Martinsville, Virginia 24112  
[cbre.com/richmond](http://cbre.com/richmond)







Property Overview

Total SF	16,200 SF
SF Breakdown	15,237 SF Warehouse, 963 SF Office
Land Area	4 AC
Dock High Doors	3
Drive In Doors	1
Parking	10 Surface Spaces
Ceiling Height	13' - 14'
Column Spacing	30' x 50'
Yard	Potential for 0.5 AC
Electrical	1,000 Amps, 480v, 3 Phase
Floor	5" Reinforced Concrete
Ventilation	3 Roof Fans, 6 Louvers, 6 Air Changes Per Hour
HVAC	Warehouse: Gas-fired suspended heaters Office: Fully conditioned
Data & Internet	High-speed DSL and T-1 service available

16.2K

Available Square Feet

4AC

Land Area

I-1

Industrial Zoning



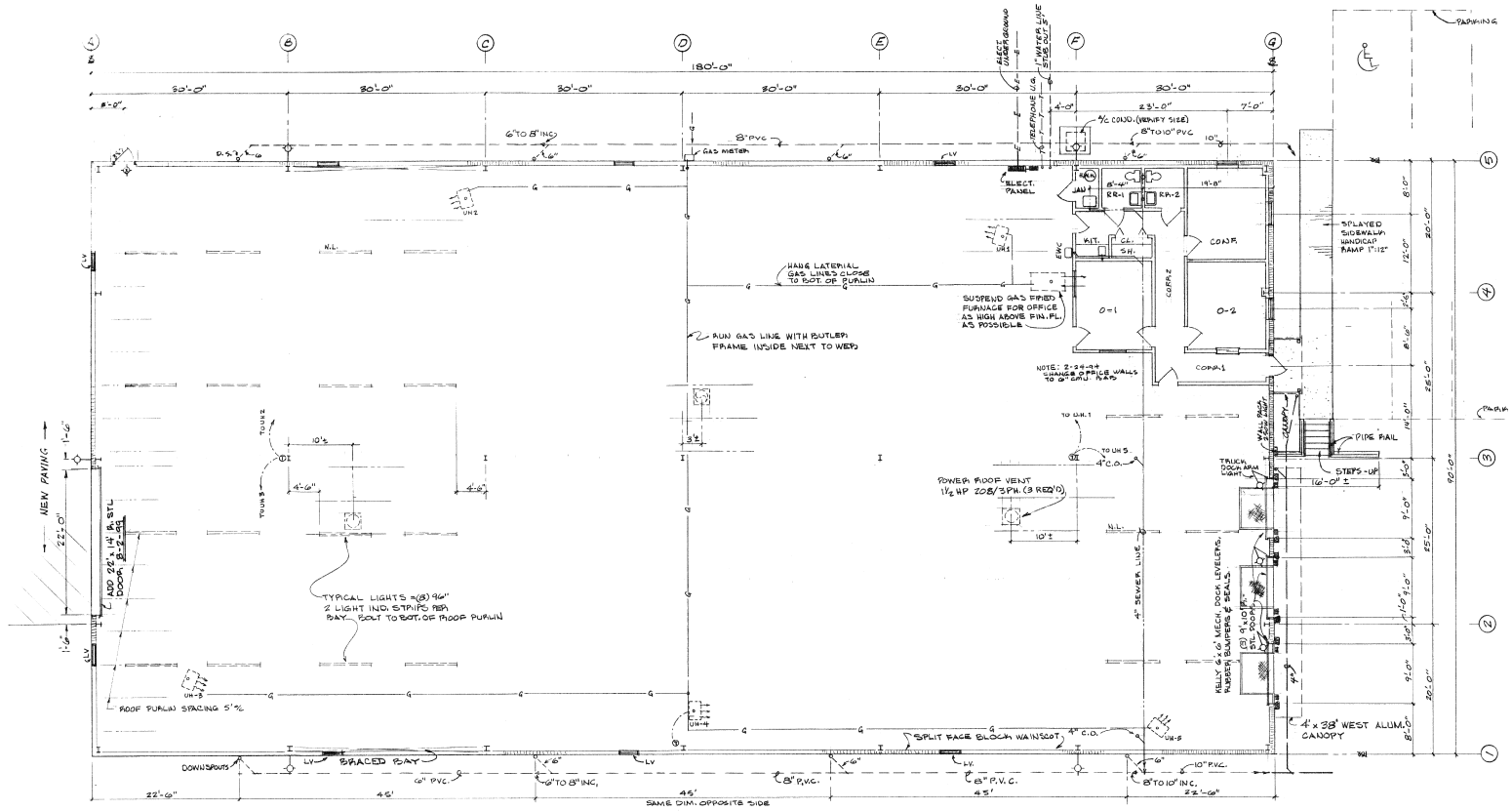

## Industrial

330 Hollie Drive | Martinsville, Virginia 24112

# For Lease

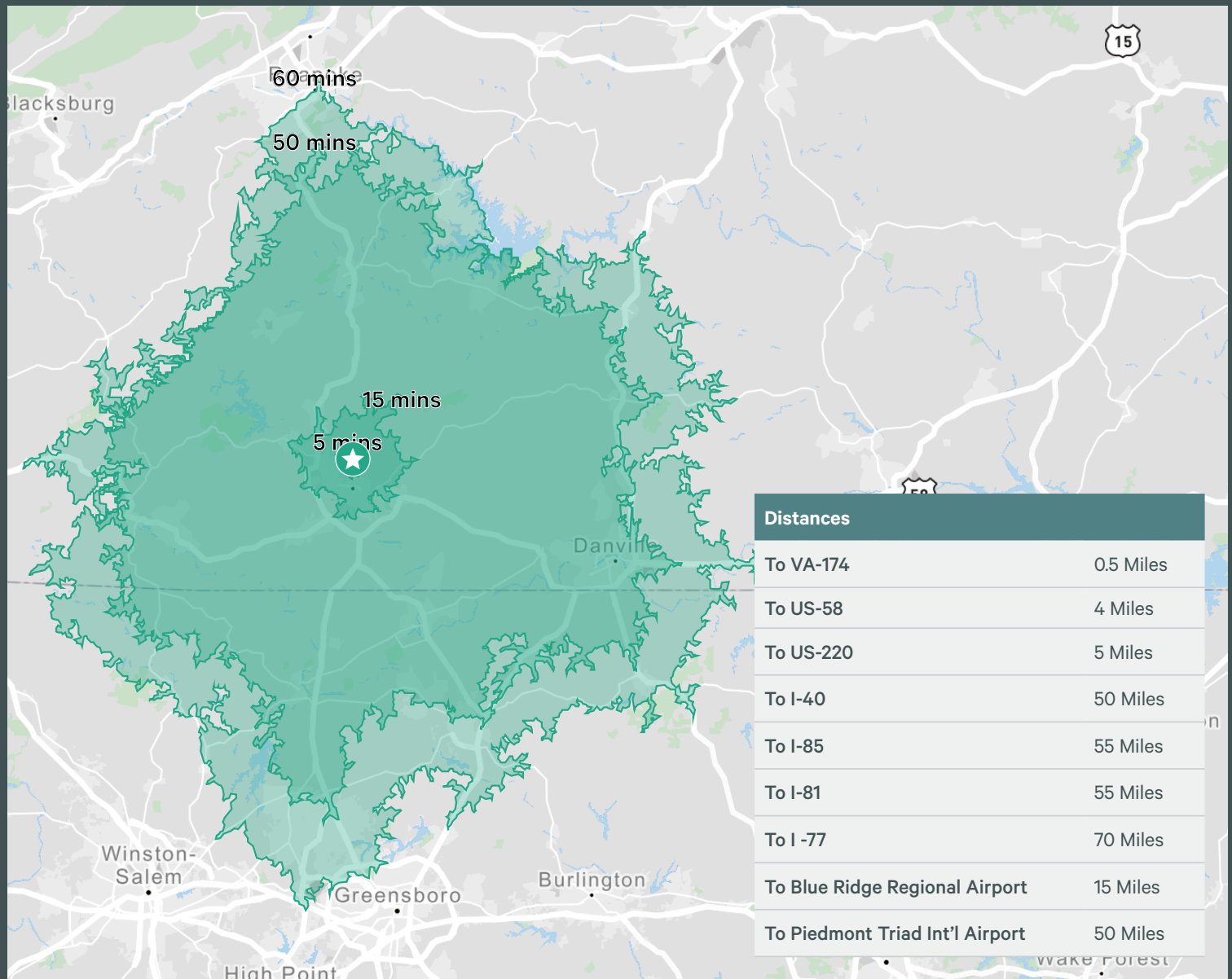

## Contact Us

### Jason Hetherington, SIOR

Senior Vice President

+1 804 401 4002

jason.hetherington@cbre.com

### Brad Lowry

Associate

+1 804 401 4007

brad.lowry@cbre.com

### Douglas O. Tice, IV

Associate

+1 804 201 2036

doug.tice@cbre.com

© 2023 CBRE, Inc. All rights reserved. This information has been obtained from sources believed reliable, but has not been verified for accuracy or completeness. You should conduct a careful, independent investigation of the property and verify all information. Any reliance on this information is solely at your own risk. CBRE and the CBRE logo are service marks of CBRE, Inc. All other marks displayed on this document are the property of their respective owners, and the use of such logos does not imply any affiliation with or endorsement of CBRE. Photos herein are the property of their respective owners. Use of these images without the express written consent of the owner is prohibited.

[www.cbre.com/richmond](http://www.cbre.com/richmond)

# CBRE