

Stadium Subdivision No. 2



Vicinity Map



Subdivision Summary

Total Property Area:	221.79 Acres
Total Residential Area:	197.45 Acres
Right-of-Way to be Dedicated:	22.40 Acres
Common Area:	1.95 Acres
Buildable Lots:	136 Lots (DA Max: 178)
Common Lots:	3 Lots
Average Lot Size:	1.45 Acres/Lot (DA Min: 1.25 acres)
Jurisdictional Agencies - Canyon County	
Fire:	Middleton Rural Fire District
Roadways:	Notus Parma Highway District
Health District:	Southwest District Health
Irrigation District:	Black Canyon Irrigation District

Summary

- The project fully meets the intent of the Development Agreement
- The Development Agreement allows for 178 lots, the project currently only has 136 lots
- The Development Agreement allows for a minimum average lot size of 1.25 acres and the average lot size is currently 1.45 acres
- The project will comply with the requirements of all jurisdictional agencies

PRICED AT \$3,750,000

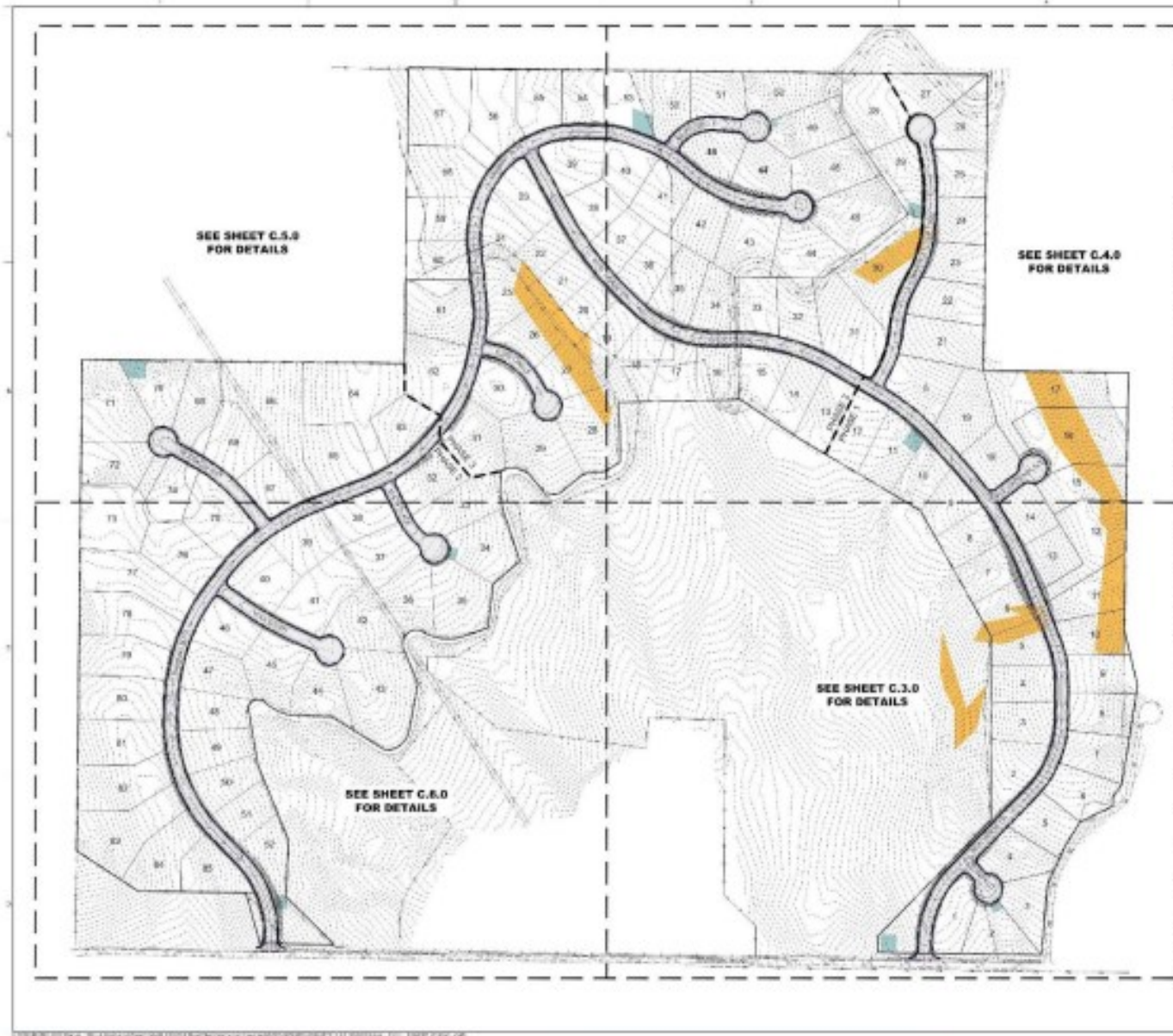

- LEGEND**
- PROPOSED CONSTRUCTION
 - EXISTING CONSTRUCTION
 - PROPOSED ROADWAY
 - EXISTING ROADWAY
 - PROPOSED DRAINAGE
 - EXISTING DRAINAGE
 - PROPOSED

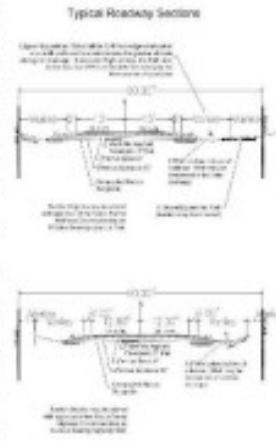

HORROCKS ENGINEERS
1775 Highway 27, Suite 110
Northridge, CA 91329
TEL: 818.708.1234
WWW.HORROCKSENG.COM

WARNING
THIS PLAN AND SPECIFICATIONS ARE THE PROPERTY OF HORROCKS ENGINEERS. NO PART OF THIS PLAN OR SPECIFICATIONS IS TO BE REPRODUCED OR TRANSMITTED IN ANY FORM OR BY ANY MEANS, ELECTRONIC OR MECHANICAL, INCLUDING PHOTOCOPYING, RECORDING, OR BY ANY INFORMATION STORAGE AND RETRIEVAL SYSTEM, WITHOUT THE WRITTEN PERMISSION OF HORROCKS ENGINEERS.

STADIUM SUBDIVISION NO. 2
GRADING AND DRAINAGE SITE KEY MAP

C.2.0

PAGE 1

Thank You Questions?

Contact: Rick McGraw

(208) 880-8889

rickmcgraw54@gmail.com

www.mcgrawgroupre.com



**COLDWELL BANKER
COMMERCIAL**

TOMLINSON