



# 615 Gold SW

Commercial Space

Albuquerque, NM - Downtown  
615 Gold Avenue SW



Available

• 13,972 SF | \$12,600/Mo



Huge Surrounding Population



Parking Lot Adjacent



Active Nightlife Area



HUB Zone qualified location

Please contact us for leasing opportunities

Demographics      1 Mile      3 mile      5 mile      Surroundings Info

Population	14,049	96,593	249,517
Med. Income	\$30,407	\$34,357	\$37,683
Day Population	34,957	104,545	196,322

- Near City Hall & Courthouse District.
- Free Surface Parking included.
- Locally owned and managed.
- A.R.T stop across the street.



### Contact

Brighton Pope  
 505.884.3578  
 Brighton.Pope@PetersonProperties.net

PetersonProperties.net  
 /petersonpropertiesllc  
 /petersonpropertiesllc  
 /peterson.properties

 Site Plan

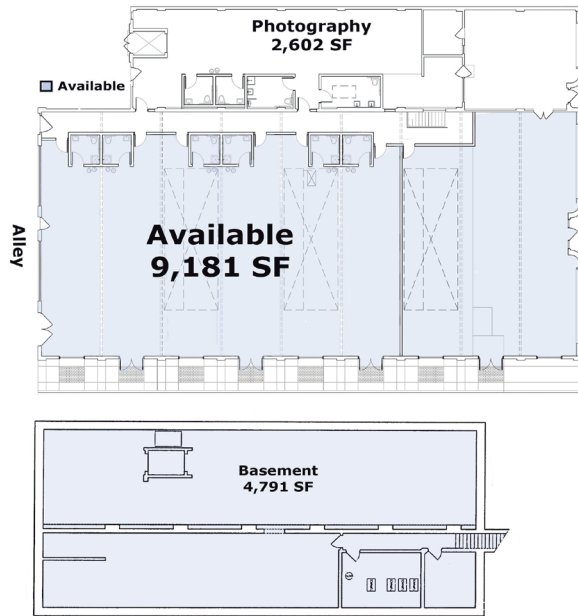

Please contact us for leasing opportunities

 Aerial Map

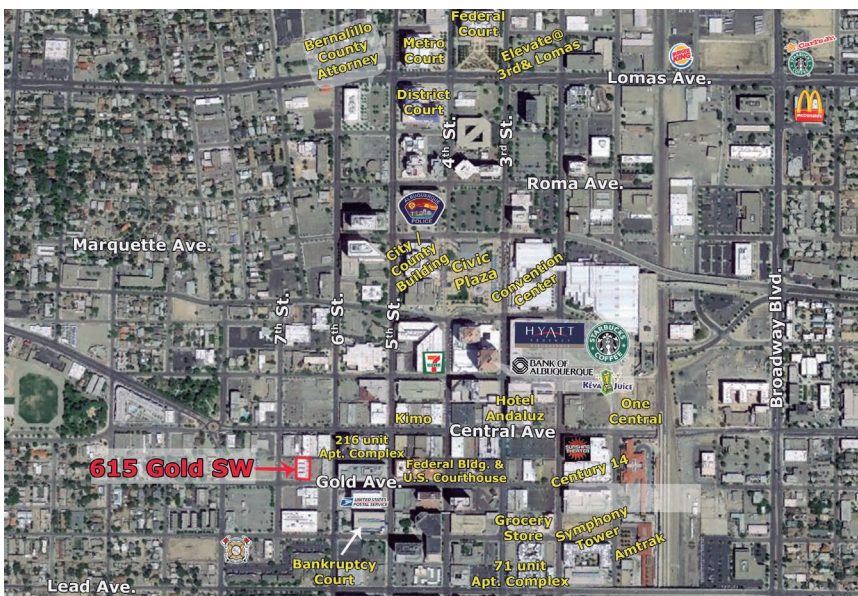

 615 Gold Ave SW  
Albuquerque, NM



Contact us

 Brighton Pope |  505.884.3578 |  Brighton.Pope@PetersonProperties.net

