

1510 HAYES AVENUE

LONG BEACH, CA 90813



13,750 SF AVAILABLE
FOR LEASE

FOR MORE INFORMATION, PLEASE CONTACT:

YOUR LOCAL MARKET EXPERTS

 **LEE &
ASSOCIATES**
COMMERCIAL REAL ESTATE SERVICES

Garrett Massaro, SIOR
Principal
BRE# 01771471
PH: 562.354.2516
E: gmassaro@leelalb.com

Brandon Carrillo
Principal
BRE# 01745362
PH: 562.354.2510
E: bcarrillo@leelalb.com

PROPERTY FEATURES

AVAILABLE SF: ±13,750 SF Bldg on ±24,000 SF Lot

RATE: \$1.35 PSF NNN + \$0.19 PSF/ month in Operating Expenses

ZONING: LBIG

APN: 7429-034-015

- ±1,300 SF of Office
- 23' - 26' Clear Height
- Freestanding Building w/ 25 Parking Spaces
- Two Oversized Ground Level Doors (16'x15' & 12'x14')
- 600 Amp / 480 V / 3 Phase Power
- Two Individual 3 Ton Bridge Cranes
- Private, Fenced Yard / Parking Lot
- Fantastic Ground Level Manufacturing Building
- Available 9/1/24



Copyright © Lee & Associates. All rights reserved. No part of this work may be reproduced or distributed without written permission of the copyright owner. The information contained in this report was gathered by Lee & Associates from sources believed to be reliable. Lee & Associates, however, makes no representation concerning the accuracy or completeness of such information and expressly disclaims any responsibility for any inaccuracy contained herein. 07.26.24

FOR MORE INFORMATION, PLEASE CONTACT:

YOUR LOCAL MARKET EXPERTS

 **LEE &
ASSOCIATES**
COMMERCIAL REAL ESTATE SERVICES

Garrett Massaro, SIOR
Principal
BRE# 01771471
PH: 562.354.2516
E: gmassaro@leelalb.com

Brandon Carrillo
Principal
BRE# 01745362
PH: 562.354.2510
E: bcarrillo@leelalb.com

FLOOR PLAN - FIRST FLOOR (NOT DRAWN TO SCALE)

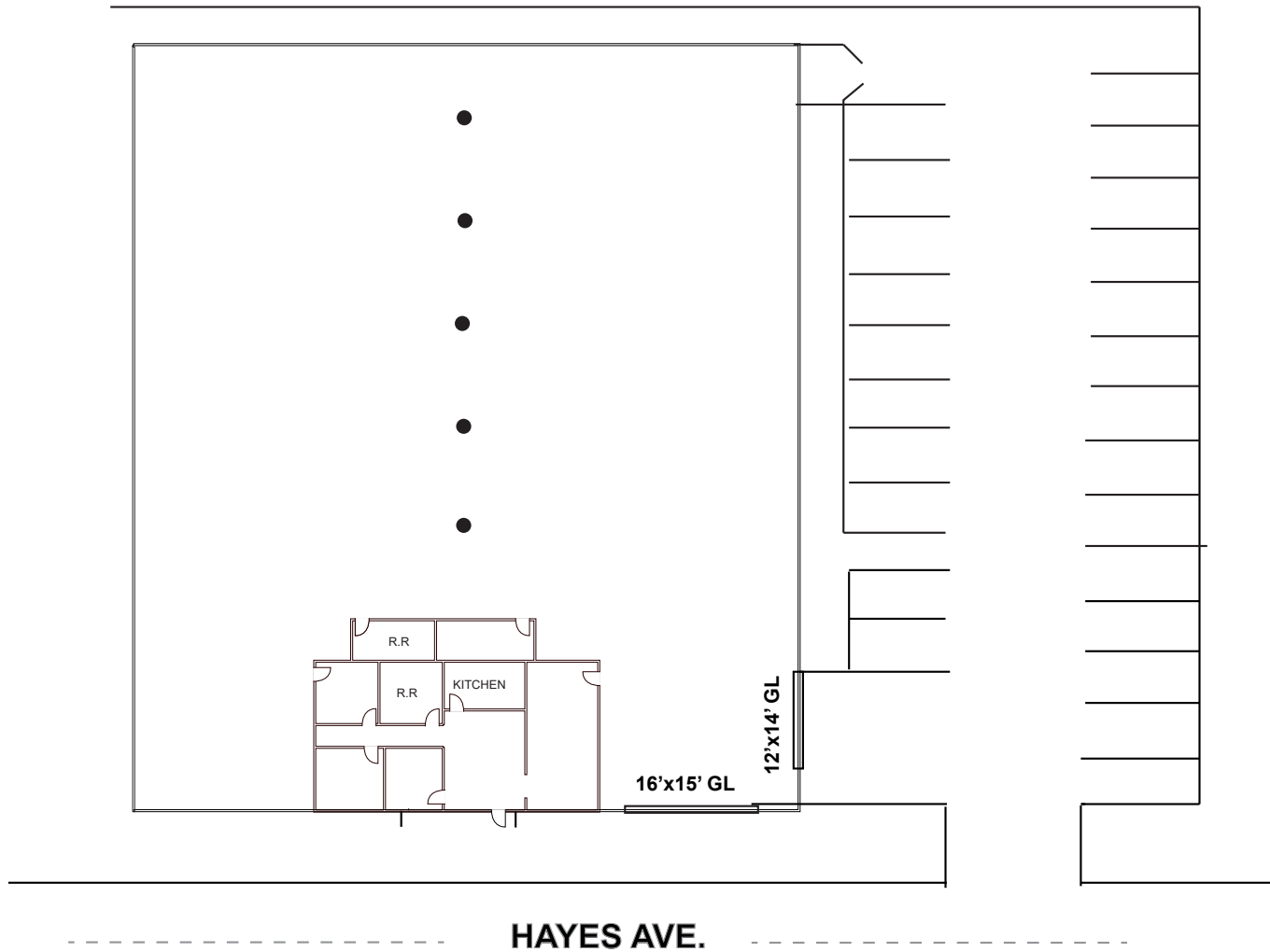

Copyright © Lee & Associates. All rights reserved. No part of this work may be reproduced or distributed without written permission of the copyright owner. The information contained in this report was gathered by Lee & Associates from sources believed to be reliable. Lee & Associates, however, makes no representation concerning the accuracy or completeness of such information and expressly disclaims any responsibility for any inaccuracy contained herein. 07.26.24

FOR MORE INFORMATION, PLEASE CONTACT:

YOUR LOCAL MARKET EXPERTS

LEE & ASSOCIATES
COMMERCIAL REAL ESTATE SERVICES

Garrett Massaro, SIOR
Principal
BRE# 01771471
PH: 562.354.2516
E: gmassaro@leelalb.com

Brandon Carrillo
Principal
BRE# 01745362
PH: 562.354.2510
E: bcarrillo@leelalb.com



Copyright © Lee & Associates. All rights reserved. No part of this work may be reproduced or distributed without written permission of the copyright owner. The information contained in this report was gathered by Lee & Associates from sources believed to be reliable. Lee & Associates, however, makes no representation concerning the accuracy or completeness of such information and expressly disclaims any responsibility for any inaccuracy contained herein. 07.26.24

FOR MORE INFORMATION, PLEASE CONTACT:

YOUR LOCAL MARKET EXPERTS

 **LEE &
ASSOCIATES**
COMMERCIAL REAL ESTATE SERVICES

Garrett Massaro, SIOR
Principal
BRE# 01771471
PH: 562.354.2516
E: gmassaro@leelalb.com

Brandon Carrillo
Principal
BRE# 01745362
PH: 562.354.2510
E: bcarrillo@leelalb.com

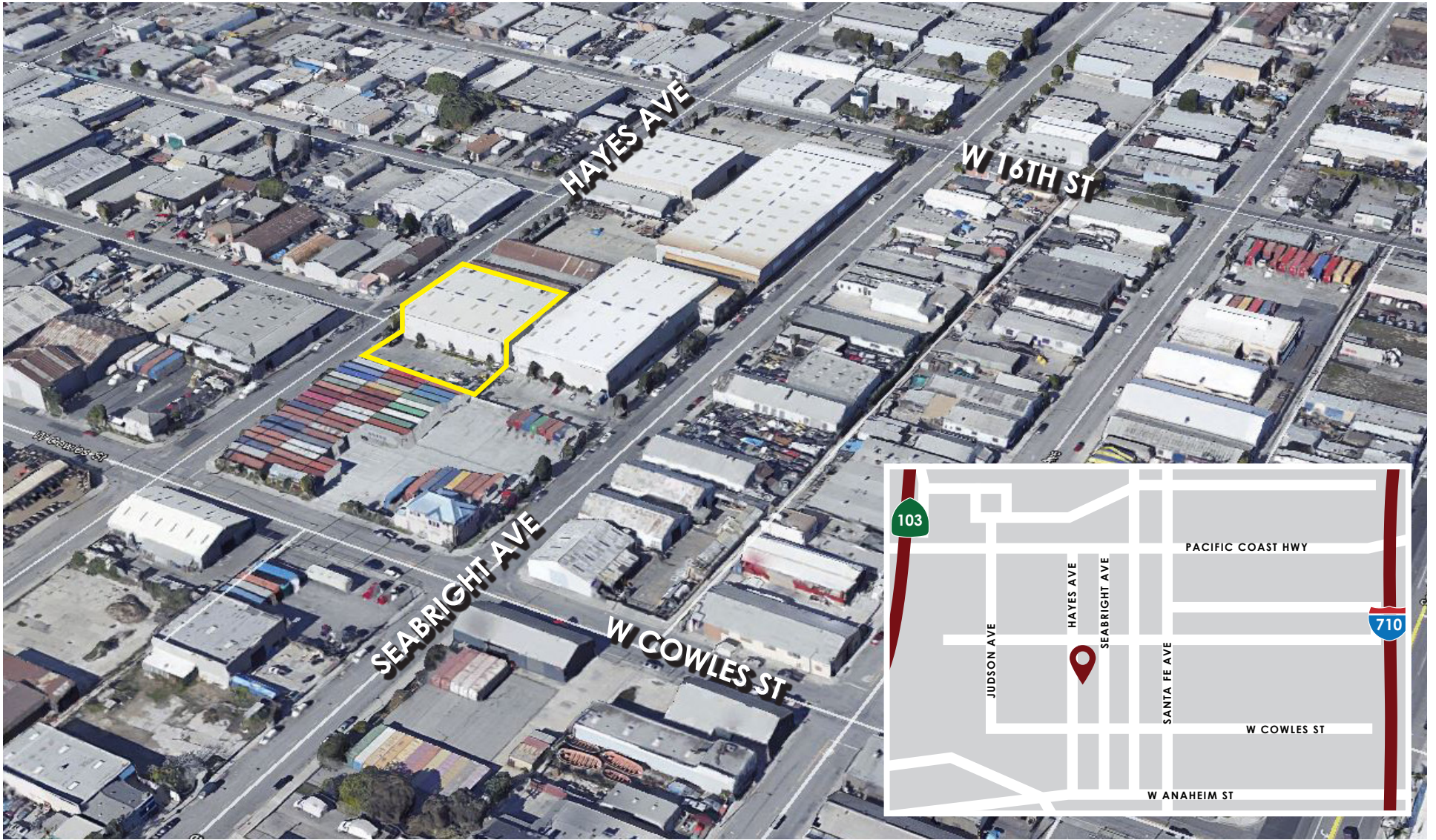

Copyright © Lee & Associates. All rights reserved. No part of this work may be reproduced or distributed without written permission of the copyright owner. The information contained in this report was gathered by Lee & Associates from sources believed to be reliable. Lee & Associates, however, makes no representation concerning the accuracy or completeness of such information and expressly disclaims any responsibility for any inaccuracy contained herein.07.26.24

FOR MORE INFORMATION, PLEASE CONTACT:

YOUR LOCAL MARKET EXPERTS



Garrett Massaro, SIOR
Principal
BRE# 01771471
PH: 562.354.2516
E: gmassaro@leelalb.com

Brandon Carrillo
Principal
BRE# 01745362
PH: 562.354.2510
E: bcarrillo@leelalb.com