

CBRE

ECHO EXCHANGE

1485 - 1489
W SUNSET BLVD

ECHO PARK, CA

SMALL RESTAURANT-READY SPACES AND MORE

FOR LEASE

PORTIA ST
SUNSET BLVD



FOR LEASE

ECHO EXCHANGE

1485 - 1489
W SUNSET BLVD

ECHO PARK, CA

FOR RETAIL LEASE INQUIRIES

ERIK KRASNEY
Senior Associate
+1 323 270 1920
Lic. 01970585
erik.krasney@cbre.com

ZACHARY CARD
First Vice President
+1 310 497 5218
Lic. 01717802
zachary.card@cbre.com

LAUREN YASHAR
Sales Assistant
+1 310 550 2511
Lic. 02206229
lauren.yashar@cbre.com



COPYRIGHT NOTICE

© 2024 CBRE, Inc. All Rights Reserved.



10,715 SF
GLA



875-4,772 SF
AVAILABLE



IMMEDIATE
DELIVERY



22 SPACES
PARKING



RESTAURANT
READY SPACES



CUB TYPE 47
LIQUOR LICENSE

FOR LEASE

1485-1489 SUNSET BLVD LOS ANGELES CA 90026

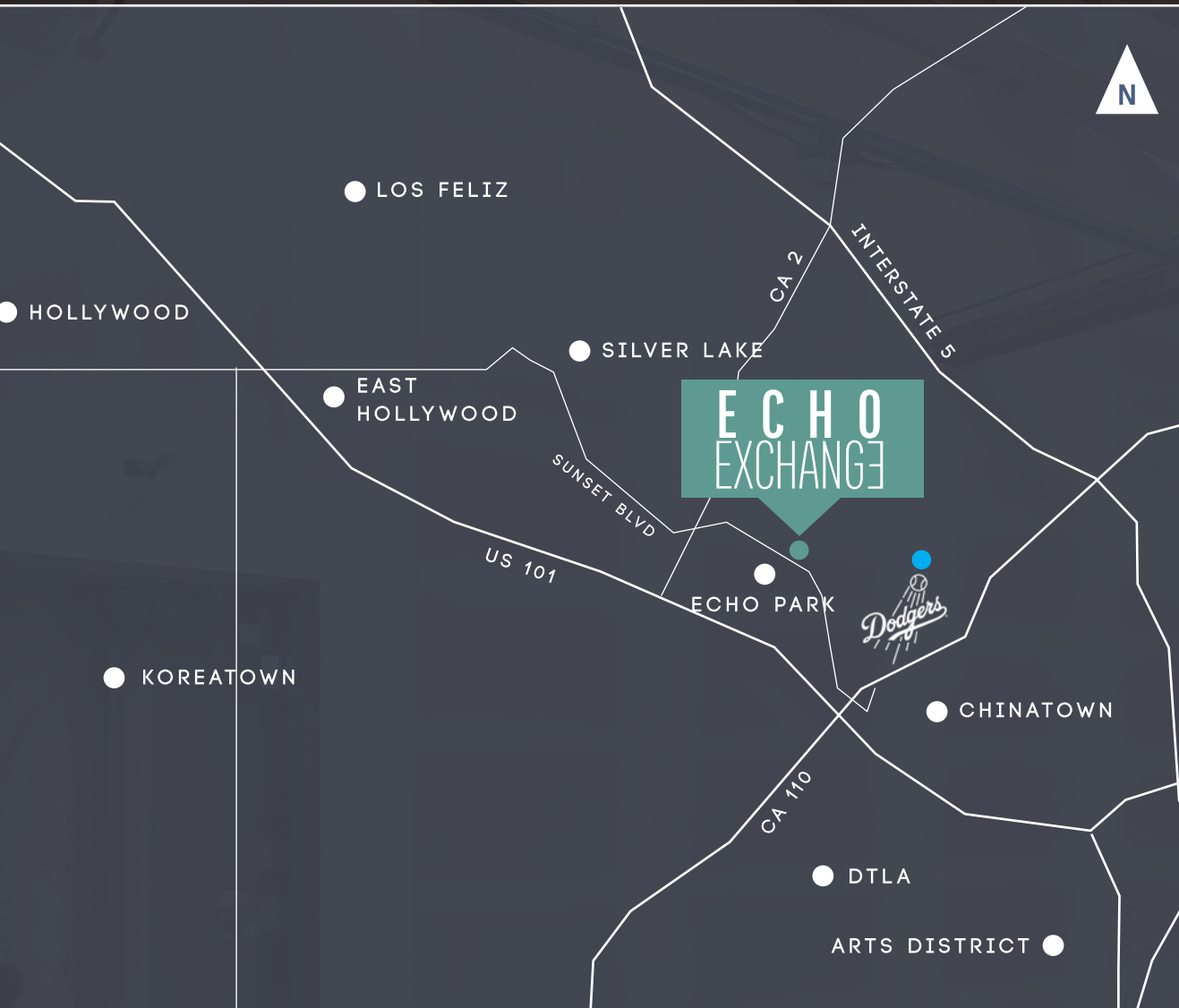

SUNSET BLVD // ECHO PARK

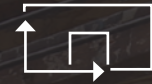

±200' ON
SUNSET BLVD
FRONTAGE



(96) WALKER'S
PARADISE
WALKSCORE



±32-34K CARS/DAY
ON SUNSET BLVD
TRAFFIC COUNTS

Echo Exchange is a newly remodeled project completed in 2022. The buildings feature a modern brick and double height storefront with an expansive glass-line and anodized aluminum.

The property's location on Sunset Boulevard consistently exhibits strong vehicle and foot traffic from residents, visitors, commuters, Dodgers fans, and nearby work force. In the established Echo Park - Silverlake market that has historically exhibited year-over-year value growth, this asset benefits from their strong immediate demographics, and proximity to several transformative development projects currently under entitlement.



PRIME RESTAURANT & RETAIL FOR LEASE ON SUNSET BLVD



ECHO
EXCHANGE

PORTIA ST

SUNSET BOULEVARD

DOWNTOWN LA

ECHO EXCHANGE

HIGHLIGHTS

- HISTORIC BUILDING RENOVATED AND FULLY MODERNIZED WITH UPGRADED BUILDING SYSTEMS
- EXPOSED BRICK AND UNIQUE WOODEN TRUSS WITH SKYLIGHTS
- HIGH CEILINGS (16"-26" IN UNITS C-K)
- ALL GLASS AND STEEL STOREFRONTS DELIVERED
- 22 SHARED PARKING SPACES + AMPLE STREET PARKING - CODE APPROVED FOR RETAIL, RESTAURANT & FITNESS USES



PORTIA STREET

SUNSET BOULEVARD



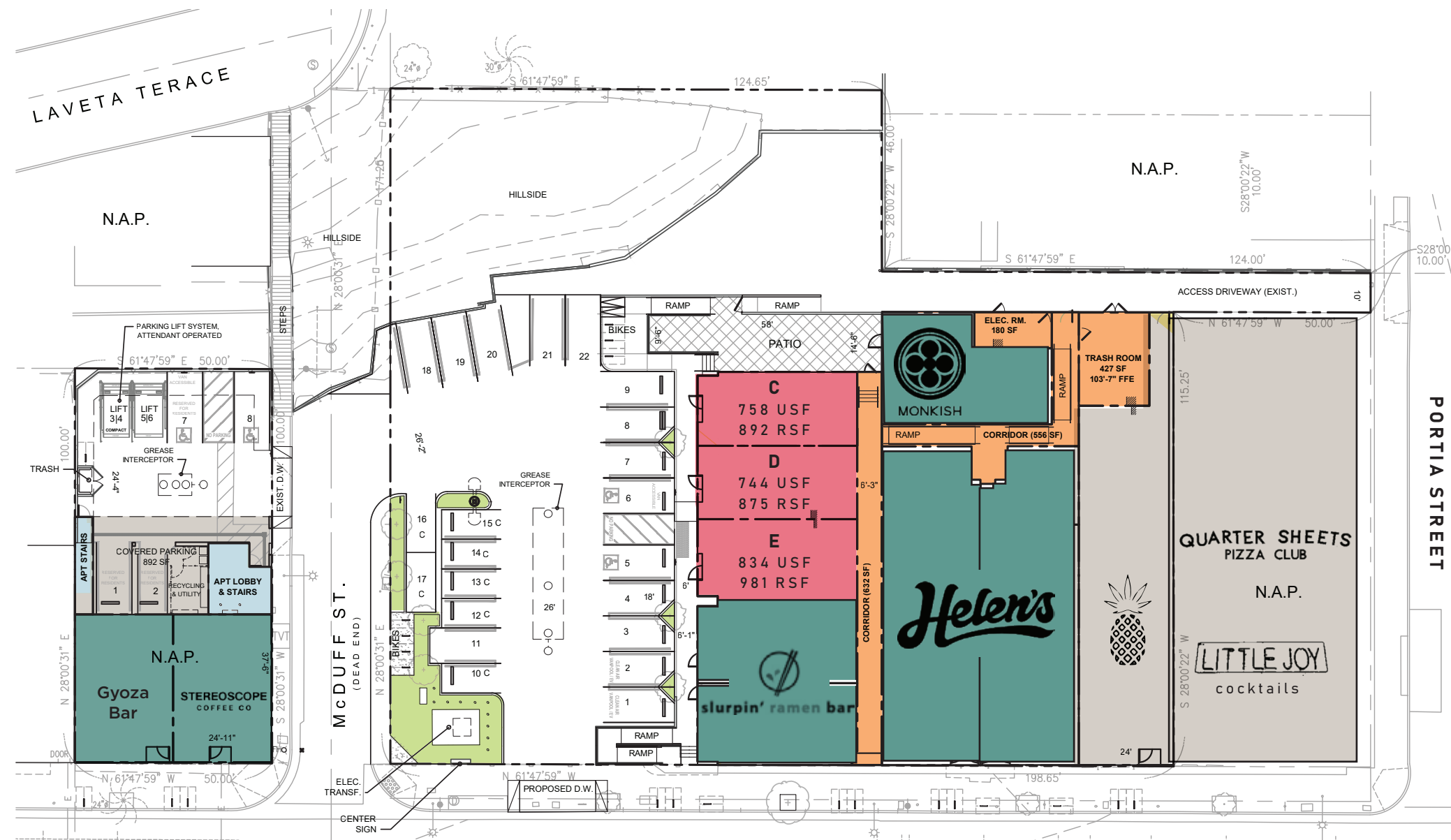

SUNSET BOULEVARD

	AVAILABLE		COMMON AREA
	LEASED		NOT A PART





LITTLE JOY

MONKISH BREWING

PIZZA

monkish BREWING CO. LOS ANGELES, CA 8 2 LITRES (87.6 FL. OZ.)

QUARTER SHEETS PIZZA

SPACE C
758 USF
892 RSF

SPACE D
744 USF
875 RSF

- COMMUNAL GREASE INTERCEPTOR
- ELECTRICAL PANELS INSTALLED
- HVAC MOUNTED ON ROOF
- NEW GLASS AND ALUMINUM STOREFRONTS
- GAS, WATER, AND SEWER STUBBED TO SPACE
- MCUB FOR TYPE 47 LIQUOR LICENSE

SLURPIN RAMEN BAR

STEREOSCOPE COFFEE

STEREOSCOPE

GYOZA BAR

QUARTER SHEETS PIZZA CLUB



MONTY'S GOOD BURGER



COSA BUONA



HONEY-HI



SAGE PLANT BASED BREWERY/BISTRO



AREA OVERVIEW // PRIME LOS ANGELES ENCLAVE

Echo Park is the jumping off point for many of the most interesting and dynamic neighborhoods in Los Angeles. With proximity to 4 major freeways: the I-5, the CA-2, the CA-110, and the US-101, Echo Park is bordered by Silver Lake, Los Feliz, Chinatown, Downtown, Hollywood, and convenient to Glendale, Koreatown and more.

Apart from marquee national destinations like Dodgers Stadium and regional draws like Echo Park Lake and Elysian Park, Sunset Blvd. continues to be a bustling draw for many of the city's top chefs and innovative retailers.

Echo Park is approaching a juncture with many large-scale developments under entitlement which will propel the neighborhood into a true live-work-play destination.

DEMOGRAPHICS (1 MILE RADIUS)

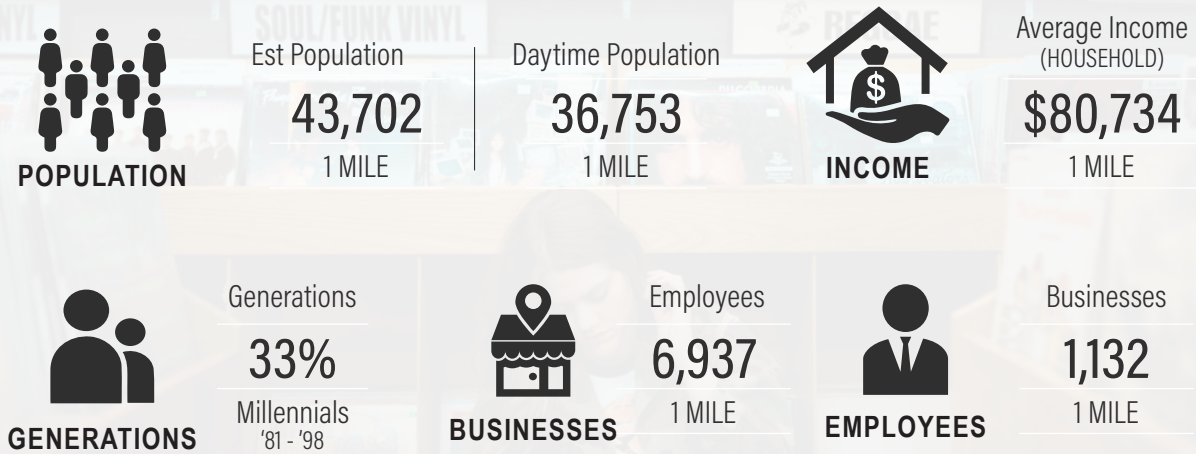

ECHO PARK HAS ARRIVED

1485 - 1489



SUNSET BLVD

ECHO PARK, CA

FOR INQUIRIES

ERIK KRASNEY
Senior Associate
+1 323 270 1920
Lic. 01970585
erik.krasney@cbre.com

ZACHARY CARD
First Vice President
+1 310 497 5218
Lic. 01717802
zachary.card@cbre.com

LAUREN YASHAR
Sales Assistant
+1 310 550 2511
Lic. 02206229
lauren.yashar@cbre.com

© 2024 CBRE, Inc. All rights reserved. This information has been obtained from sources believed reliable, but has not been verified for accuracy or completeness. Any projections, opinions, or estimates are subject to uncertainty. The information may not represent the current or future performance of the property. You and your advisors should conduct a careful, independent investigation of the property and verify all information. Any reliance on this information is solely at your own risk. CBRE and the CBRE logo are service marks of CBRE, Inc. and/or its affiliated or related companies in the United States and other countries. All other marks displayed on this document are the property of their respective owners.

