

±3,203 - ±25,609 SF Warehouse & Office

163 - 169 CAMINO DORADO | NAPA, CA



Accelerating success.

FOR LEASE



Steve Crocker

Senior Vice President
CA License No. 01476069
steve.crocker@colliers.com
+1 707 685 6395

Bret DeMartini

Executive Vice President
CA License No. 00853110
bret.demartini@colliers.com
+1 510 507 8665

Colliers

1850 Mt. Diablo Boulevard, Suite 200
Walnut Creek, CA 94596
colliers.com

Property Overview

163 – 169 CAMINO DORADO | NAPA, CA

AVAILABLE	LEASE RATE
Immediately	\$1.15 PSF/Mo. NNN

Property Specifications

Available SF:	±25,609 SF Total
Location:	Ideally located in the Napa Valley Business Park right in the hub of commerce for Napa Valley
Parking:	±2.5/1,000
Construction:	Concrete tilt-up construction
Fire Suppression:	Sprinklered
Zoning:	Industrial Park, Airport Compatibility
Viewability:	Property fronts Hwy 29 with great signage opportunities

This document has been prepared by Colliers for advertising and general information only. Colliers makes no guarantees, representations or warranties of any kind, expressed or implied, regarding the information including, but not limited to, warranties of content, accuracy and reliability. Any interested party should undertake their own inquiries as to the accuracy of the information. Colliers excludes unequivocally all inferred or implied terms, conditions and warranties arising out of this document and excludes all liability for loss and damages arising there from. This publication is the copyrighted property of Colliers and /or its licensor(s). © 2026. All rights reserved. This communication is not intended to cause or induce breach of an existing listing agreement.

Available Suites

* Suites can be leased separately

Suite 163 | ±15,446 SF

Warehouse:	±12,646 SF <ul style="list-style-type: none">Dock high loading: 1 @ ±8'W x ±10'HGrade level loading: 1 @ ±10'W x ±10'HCombo dock high/grade: 1 @ ±8'W x ±10'H±400A @ 277/480 volts <i>(to be verified)</i>±22' clear heightUnisex restroom
Office:	±2,800 SF <ul style="list-style-type: none">3 private officesReceptionBullpen areaConference roomM/W restroom

Suite 169 | ±6,960 SF

Warehouse:	±5,950 SF <ul style="list-style-type: none">Dock high loading: 1 @ ±8'W x ±10'HGrade level loading: 1 @ ±10'W x ±10'H±200A @ 277/480 volts <i>(to be verified)</i>±22' clear heightUnisex restroom
Office:	±900 SF open office with <ul style="list-style-type: none">KitchenetteUnisex restroomWindow open to warehouse area

Suite 167 | ±3,203 SF | Office

Office:	<ul style="list-style-type: none">7 private offices2 Large open offices/bullpen/creative spacesLobby, reception room with granite countertopUnisex restroom with shower upstairsFirst floor entry restroom and office/waiting room±10' - ±12' ceilingsKitchenetteBeautiful hardwood floors
---------	---

Floor Plan

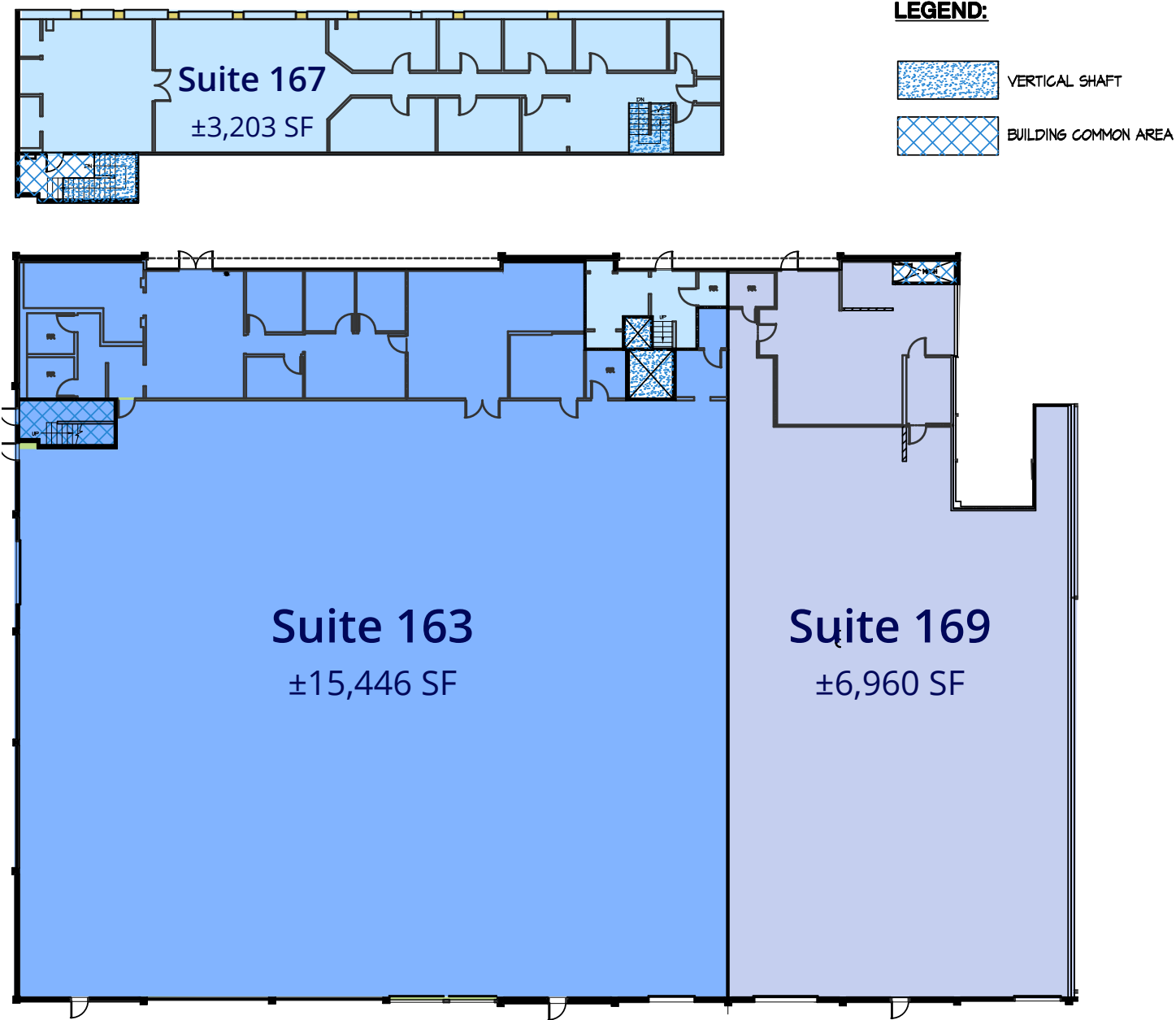

Property Photos



Building Exterior



Suite 169 | Warehouse



Suite 169 | Office



Suite 167 | Bullpen

Location Overview

