

109 CANOPY

109 S Canopy St, Lincoln, NE 68508



PROPERTY DESCRIPTION

Positioned at the South end of the Haymarket, this commercial space is ideal for retail and restaurants! Currently a blank canvas, this location offers endless potential to bring businesses to life! Canopy Park™ is a modern, mixed-use building, and is the place to be for access to Lincoln's growing urban population! Don't miss this opportunity to establish your business in a thriving area!

SPACES	LEASE RATE	SPACE SIZE
Suite 160	\$19.00 SF/yr	3,617 SF
Patio	\$9.00 SF/yr	1,734 SF
Suite 170	\$19.00 SF/yr	3,376 SF
Patio	\$9.00 SF/yr	1,668 SF
Suite 180	\$19.00 SF/yr	2,393 SF
Patio	\$9.00 SF/yr	1,479 SF

OFFERING SUMMARY

Lease Rate	\$19.00 SF/yr (NNN)
Total Available SF	9,282 SF
Lot Size	48,846 SF
Building Size	206,181 SF

DEMOGRAPHICS 0.25 MILES 0.5 MILES 1 MILE

Total Households	353	1,587	6,425
Total Population	726	3,267	16,531
Average HH Income	\$39,313	\$34,748	\$37,304



TOM GIFFORD
Broker
402.326.2413
TJGifford@SpeedwayProperties.com



KERI BOWER
Commercial Leasing Agent
402.323.3127
kabower@speedwayproperties.com



LAUREN COOK
Commercial Leasing Agent
402.323.3126
lmcook@speedwayproperties.com

109 S CANOPY ST

109 S Canopy St, Lincoln, NE 68508

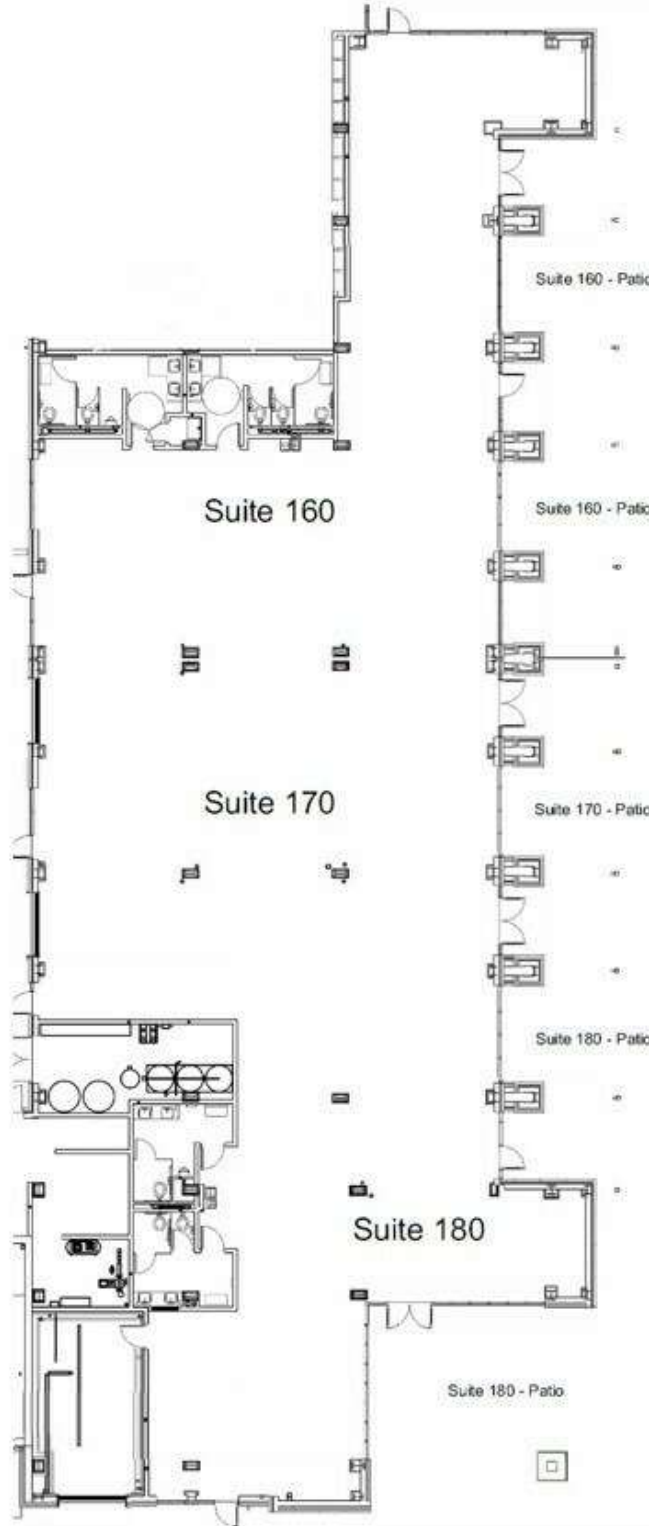

TOM GIFFORD
Broker
402.326.2413
TJGifford@SpeedwayProperties.com



KERI BOWER
Commercial Leasing Agent
402.323.3127
kabower@speedwayproperties.com



LAUREN COOK
Commercial Leasing Agent
402.323.3126
lmcook@speedwayproperties.com



Retail / Restaurant For Lease

109 S CANOPY ST

109 S Canopy St, Lincoln, NE 68508

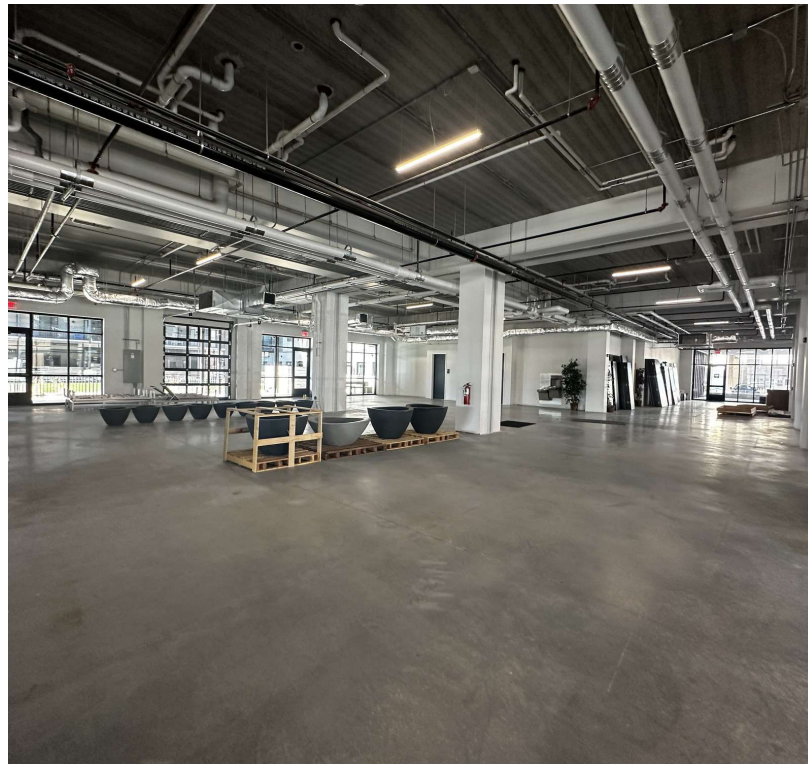

TOM GIFFORD
Broker
402.326.2413
TJGifford@SpeedwayProperties.com



KERI BOWER
Commercial Leasing Agent
402.323.3127
kabower@speedwayproperties.com



LAUREN COOK
Commercial Leasing Agent
402.323.3126
lmcook@speedwayproperties.com



SpeedwayProperties.com

109 S CANOPY ST

109 S Canopy St, Lincoln, NE 68508

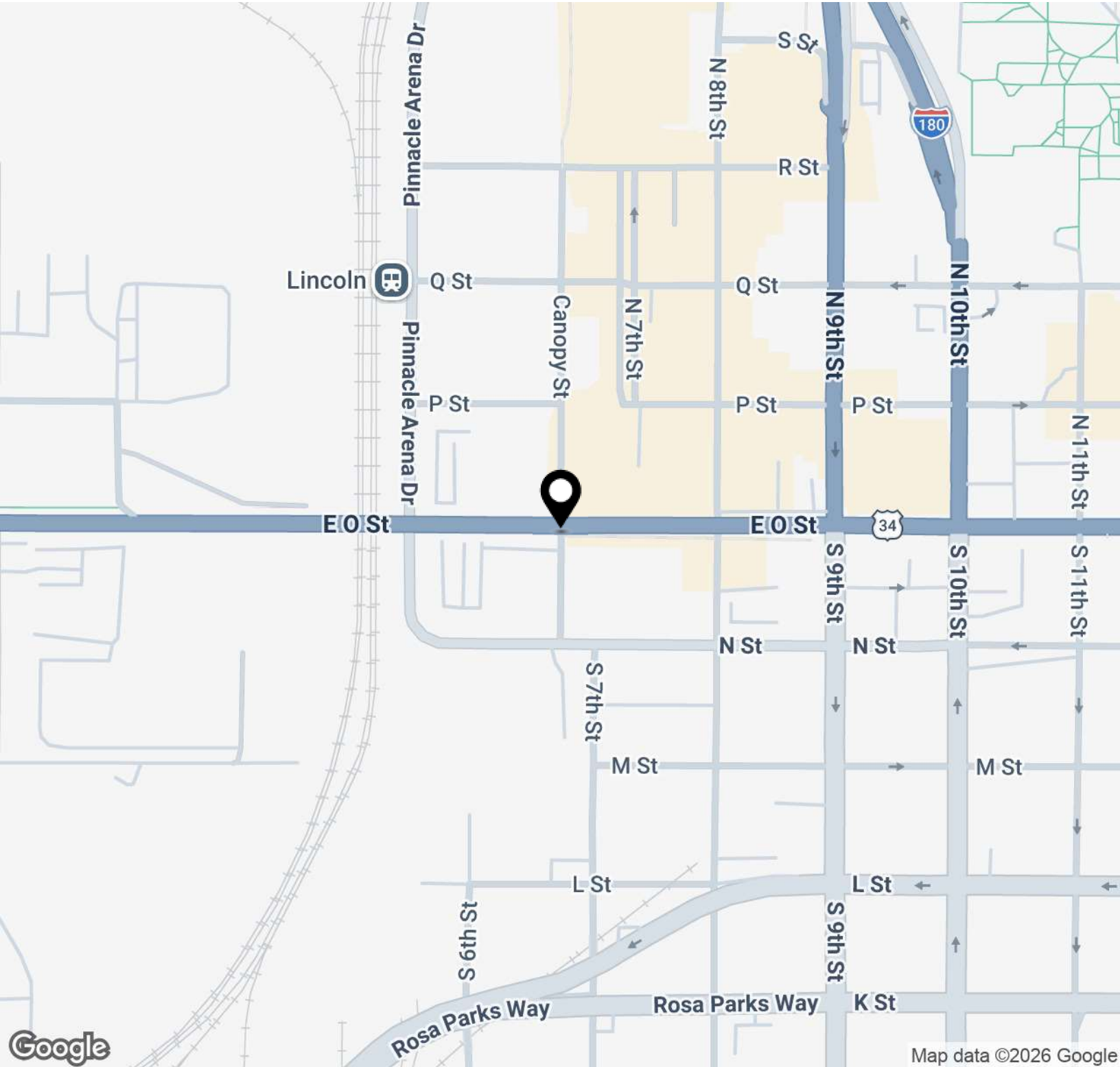

TOM GIFFORD
Broker
402.326.2413
TJGifford@SpeedwayProperties.com



KERI BOWER
Commercial Leasing Agent
402.323.3127
kabower@speedwayproperties.com



LAUREN COOK
Commercial Leasing Agent
402.323.3126
lmcook@speedwayproperties.com



109 S CANOPY ST

109 S Canopy St, Lincoln, NE 68508

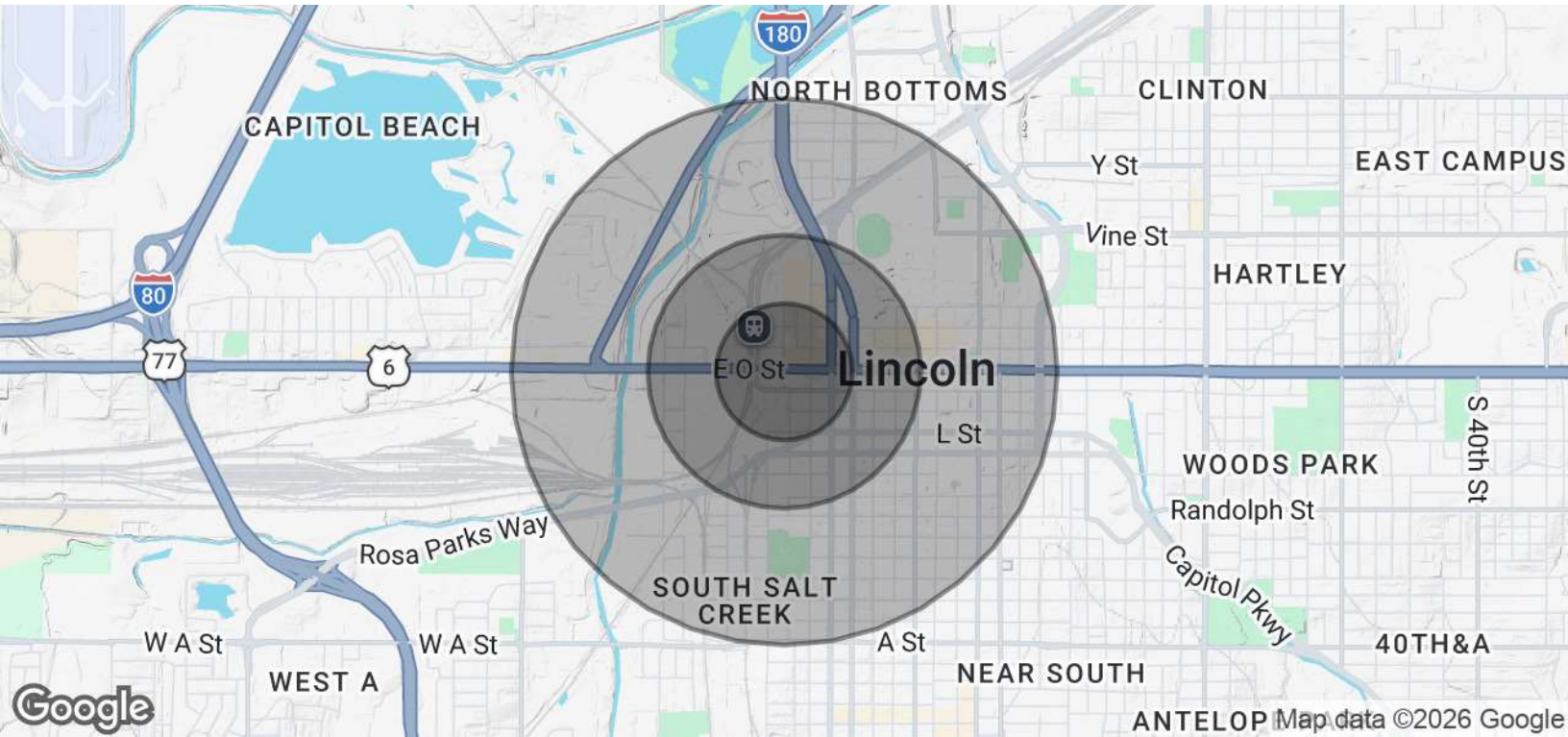

POPULATION	0.25 MILES	0.5 MILES	1 MILE
Total Population	726	3,267	16,531
Average Age	24.7	24.7	24.6
Average Age (Male)	23.9	24.3	24.9
Average Age (Female)	25.6	25.3	24.8

HOUSEHOLDS & INCOME	0.25 MILES	0.5 MILES	1 MILE
Total Households	353	1,587	6,425
# of Persons per HH	2.1	2.1	2.6
Average HH Income	\$39,313	\$34,748	\$37,304
Average House Value	\$103,191	\$111,337	\$94,473

2020 American Community Survey (ACS)



TOM GIFFORD
Broker
402.326.2413
TJGifford@SpeedwayProperties.com



KERI BOWER
Commercial Leasing Agent
402.323.3127
kabower@speedwayproperties.com



LAUREN COOK
Commercial Leasing Agent
402.323.3126
lmcook@speedwayproperties.com