

5,084 SF

Industrial Space For Lease



Prologis Park Chicago



9755 Farragut
Chicago, IL 60018 USA



LOCATION

- Conveniently located near O'Hare International Airport and the new I-294 Balmoral exit / entrance.
- Excellent access to I-294, I-90, I-290 and I-390.

FACILITY

- 11,168 sf building
- 5,084 sf available
- 2,325 sf office area
- 12' clear height
- 1 drive-in door (10' x 10')
- Open bay in warehouse
- 400 amp service
- Available: January 1, 2025

ADVANTAGES AND AMENITIES

- Walking distance to the Rosemont Entertainment District.
- Directly across the street from The Rose Hotel.

Your single-source service for efficient move-in and operations: [prologisessentials.com](https://www.prologisessentials.com)

5,084 SF

Industrial Space For Lease



Prologis Park Chicago

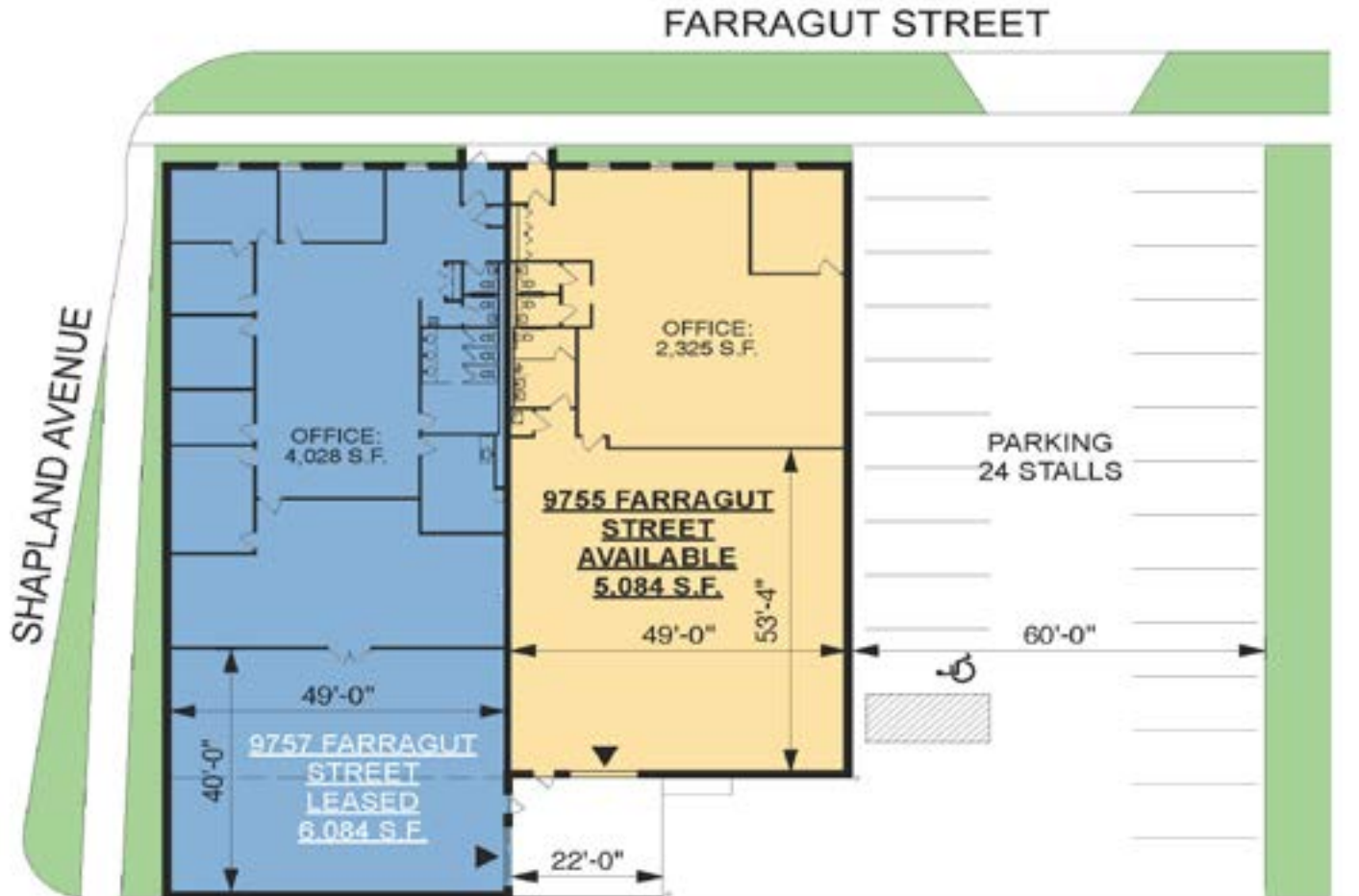

NEWMARK

Newmark
Tom Gath
thomas.gath@nmrk.com
ph +1 773 957 1415
cell +1 847 942 9438
8750 W. Bryn Mawr
Suite 350
Chicago, IL 60631 USA

Prologis
Julia Makarieva
jmakarieva@prologis.com
ph +1 847 292 3863
cell +1 224 763 9870
6250 North River Road
Suite 1100
Rosemont, IL 60018 USA