

RETAIL, MEDICAL, AND OFFICE SPACE AVAILABLE FOR LEASE
3600-3698 DELTA FAIR BLVD, ANTIOCH, CA



PRESENTED BY:

Dan Moylan
925-239-1427
dmoylan@lee-associates.com
Lic.ID#00845782

Alex Peck
925-239-1414
apeck@lee-associates.com
Lic.ID#01981426



RETAIL, MEDICAL, AND OFFICE SPACE FOR LEASE

3600-3698 DELTA FAIR BLVD, ANTIOCH

LISTING DATA:

Suite 3664: 3,940±SF AVAILABLE

Suite 3682-3690: 1,200 - 7,448±SF AVAILABLE

PROPERTY INFORMATION:

- Adjacent to Somersville Towne Center
- 1/3 Mile off Freeway Exit
- 5/1,000 Parking Ratio
- Professionally Maintained, Pride of Ownership Center

ECONOMIC DATA:

\$2.20/SF/MO GROSS



RETAIL, MEDICAL, AND OFFICE SPACE FOR LEASE

3600-3698 DELTA FAIR BLVD, ANTIOCH

SITE PLAN:



3600-3698 DELTA FAIR BLVD, ANTIOCH

SUITES 3680-3690 FLOOR PLANS

1,200 SF – 7,448 SF

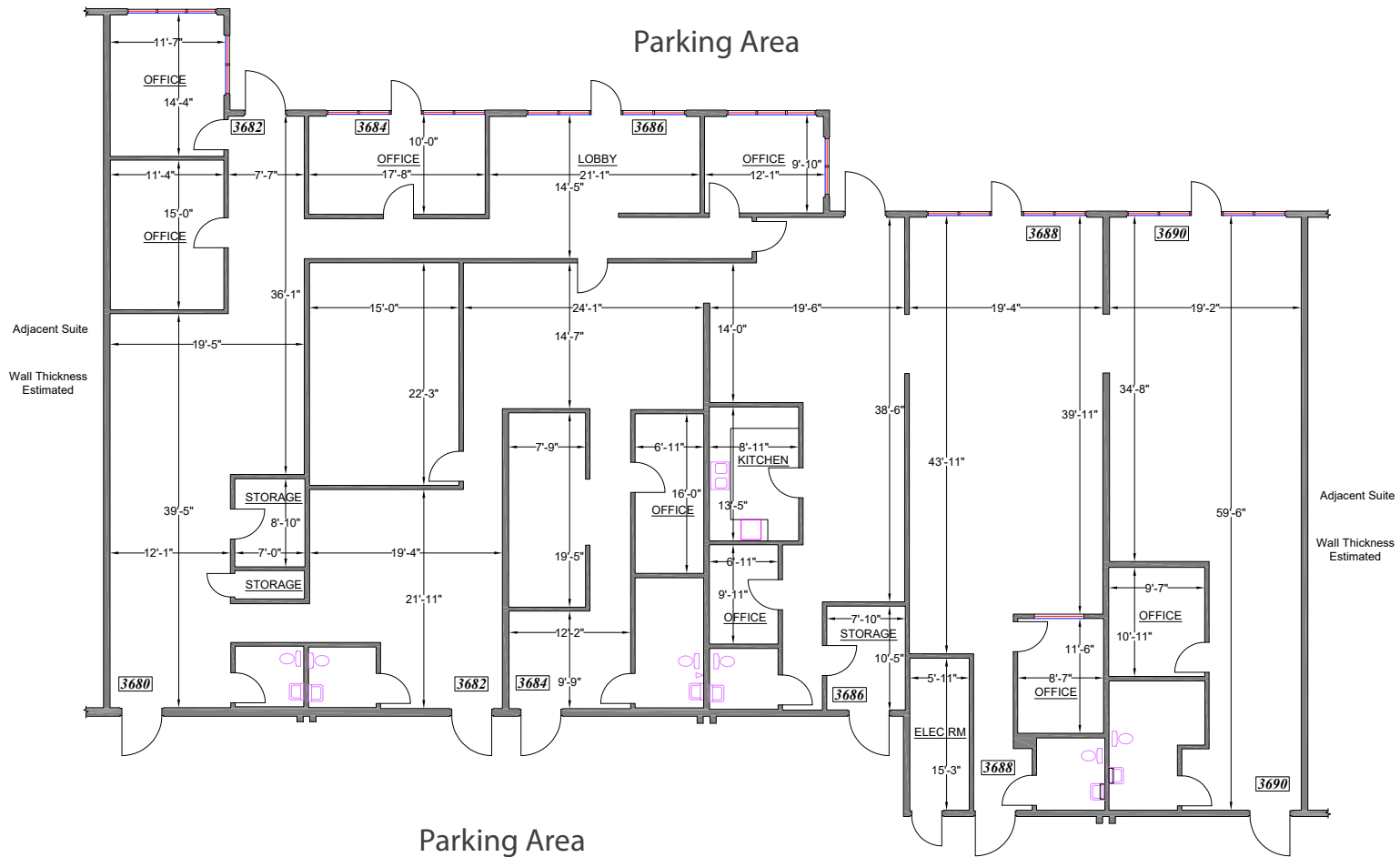

RETAIL, MEDICAL, AND OFFICE SPACE FOR LEASE

3600-3698 DELTA FAIR BLVD, ANTIOCH

LOCATION OVERVIEW

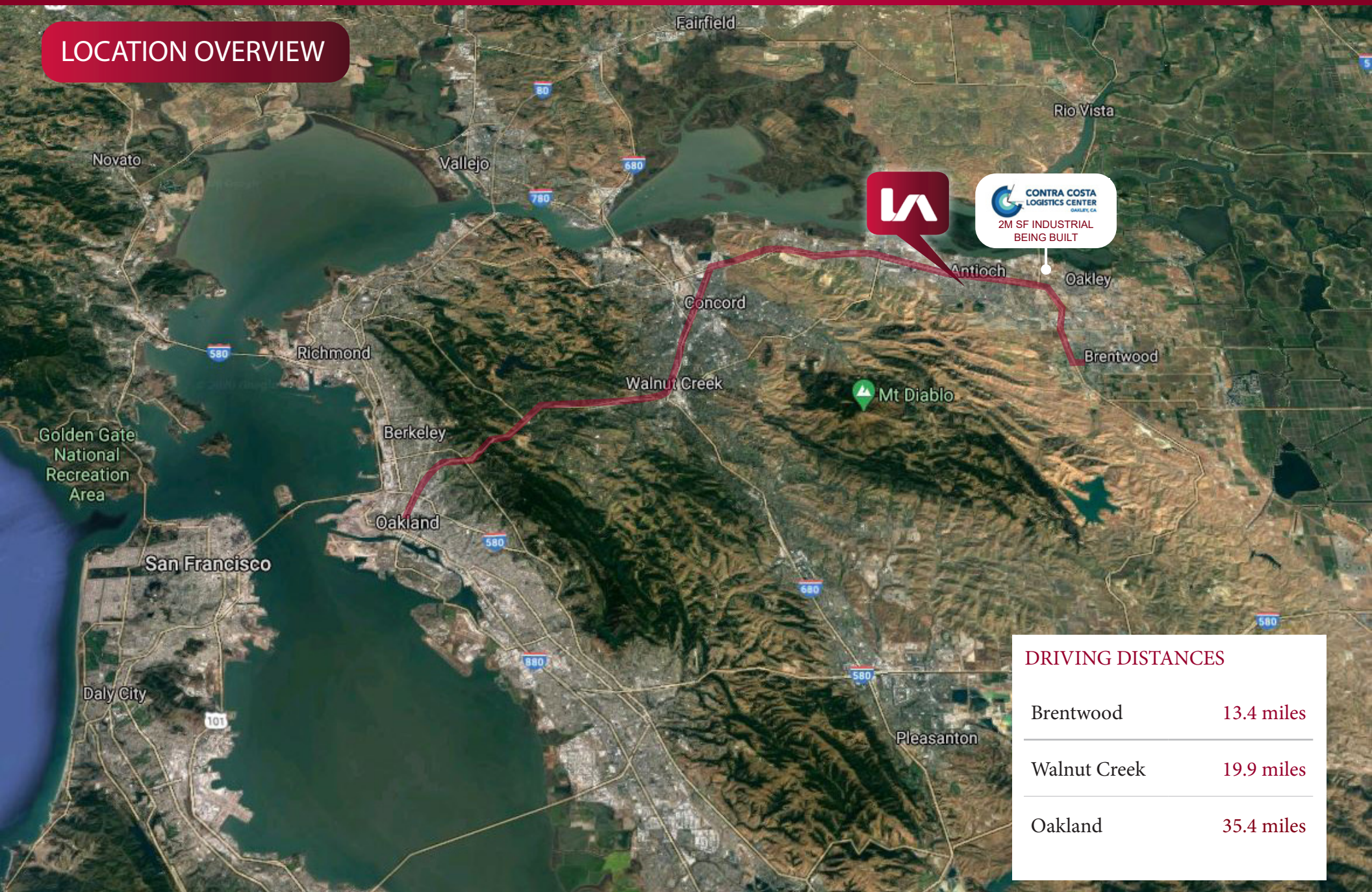

**CONTRA COSTA
LOGISTICS CENTER**
OAKLEY, CA
2M SF INDUSTRIAL
BEING BUILT

DRIVING DISTANCES

Brentwood	13.4 miles
Walnut Creek	19.9 miles
Oakland	35.4 miles



RETAIL, MEDICAL, AND OFFICE SPACE FOR LEASE

3600-3698 DELTA FAIR BLVD, ANTIOCH

NEARBY AMENITIES



RETAIL, MEDICAL, AND OFFICE SPACE FOR LEASE

3600-3698 DELTA FAIR BLVD, ANTIOCH

DEMOGRAPHICS:



	2 Miles	5 Miles	10 Miles
2020 Population	52,422	159,274	393,910
2020 Households	17,762	51,041	129,000
Median Age	34.9	35.7	36.9
Average Household Income	\$76,454	\$92,740	\$112,737
Total Consumer Spending	\$446.4M	\$1.5B	\$4.2B
Household Spending (Food & Alcohol)	\$7,210	\$7,909	\$8,543
Household Spending (Healthcare)	\$1,212	\$1,368	\$1,567